

(Attach photo here)

NRDIS- 11/19/77

MA A	A 1-2 "	17
-----------------	---------	----

FORM B - BUILDING SURVEY

MASSACHUSETTS HISTORICAL COMMISSION
Office of the Secretary, State House, Boston

2. Town Sturbridge

Street address Charlton St.

1. Is this building historically significant to:
Town _____ Commonwealth _____ Nation _____

Name Drew - Corey -- Bullock place

Building has historical connection with the following themes: (see also reverse side)

Use: original & present Residence

- Scholar _____
- Agriculture _____
- Art/Sculpture _____
- Education _____
- Government _____
- Literature _____
- Music _____
- Commerce/industry _____
- Science/invention _____
- Travel/communication _____
- Military Affairs _____
- Religion/philosophy _____
- Indians _____
- Other _____

Present owner Clarence Drew

Open to public No

Date 1929-30 Style "Dutch Colonial"

Source of date Owner (old house burned in 1929.)

Architect _____

Development of town/city
Architectural reason for inventorying: _____

OR part of Area # A 1 - 2

3. CONDITION Excellent Good Fair Deteriorated Moved Altered Added _____

4. DESCRIPTION

FOUNDATION/BASEMENT: High Regular Low Material Fieldstone, cemented

WALL COVER: Wood white clapboard Brick Stone Other _____

ROOF: Ridge Gambrel Flat Hip Mansard _____
Tower Cupola Dormer windows Balustrade Grillwork _____

CHIMNEYS: 1 2 3 4 _____ Center End Interior Irregular Cluster Elaborate

STORIES: 1 2 3 4 _____ ATTACHMENTS: Wings Ell Shed _____

PORCHES: 1 2 3 4 _____ PORTICO _____ Balcony _____

FACADE: Gable end: Front/side Ornament _____

Entrance: Side Front: Center/Side Details: _____

Windows: Spacing: Regular/Irregular Identical/Varied _____

Corners: Plain Pilasters Quoins Cornerboards _____

5. Indicate location of building in relation to nearest cross streets and other buildings

6. Footage of structure from street 30
Property has 100 feet frontage on street

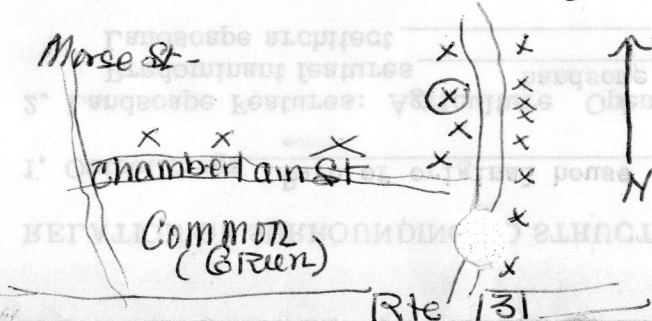

Recorder Agnes S. Wilk

For Sturbridge Historical Commission

Photo # 17, 17A Date Feb. 5, 1972

SEE REVERSE SIDE

RELATION OF SURROUNDING STRUCTURE

- 1. Outbuildings Barn of original house -- marked with date 1801 by Bicentennial Com.,
1938
- 2. Landscape Features: Agriculture Open Wooded Garden: Formal/Informal
Predominant features handsome old maples in front of house
Landscape architect _____
- 3. Neighboring Structures
Style: Colonial Federal Greek/Revival Gothic Revival Italian Villa Lombard Rom.
Venetian Gothic Mansard Richardsonian Modern
Use: Residential Commercial Religious Conditions: Excellent Good Fair Deteriorated

GIVE A BRIEF DESCRIPTION OF HISTORIC IMPORTANCE OF SITE (Refer and elaborate on theme circled on front of form)

In 1921, present owner became one of three tenants in old house then owned by the Coreys and which he later bought. After this house burned in 1929, he built the present house.

The site is of historic importance because c. 1812ff the Worcester Stafford Springs Turnpike was put through, the present Charlton St. then of commercial and industrial importance. By 1825, Benjamin Bullock, Jr., had a house and store here, and in 1845 his widow still held the property; still had it in 1850; still in family in 1898.

BIBLIOGRAPHY AND/OR REFERENCE

Information from owner.

- Atlases of Worcester County, 1850 and 1898; Map of Sturbridge & Fiskdale, 1892
- Levine, Herbert, "In Search of the Nucleated Village, Pt. I", typescript, research done for O.S.V., summer of '71: maps of 1825, 35, 45.

RESTRICTIONS Zoning, residential, act of 1965

Original Owner: _____
Deed Information: Book Number 491 Page 572, _____ Registry of Deeds
for Mrs. Bullock



House. 10/13/71



Barn. 10/13/71