

P. FISK  
USGS SOUTH  
SPUR A

In Area no. <del>15</del> = 15	Form no. 642
-----------------------------------	-----------------

✓

ION  
on



MI  
3

1. Town STURBRIDGE 168  
 Address Church St.  
 (Kirby-Bourbeau)  
 Name Kirby Estate - Alfred Denault  
Bourbeau  
 Present use Dwelling

Present owner Laurent Bourbeau

3. Description:  
 Date 1873?  
 Source Style and history  
 Style Simple Greek Revival  
 Architect \_\_\_\_\_

Exterior wall fabric Clapboards

Outbuildings (describe) Garage

Other features \_\_\_\_\_

Altered \_\_\_\_\_ Date \_\_\_\_\_

Moved \_\_\_\_\_ Date \_\_\_\_\_

5. Lot size:  
 One acre or less  Over one acre \_\_\_\_\_

Approximate frontage 192 feet

380 feet deep

Approximate distance of building from street  
10 feet

6. Recorded by Helen G. Holley

Organization Sturbridge Historical Comm

Date June 1973 RECEIVED

other buildings. Indicate north.

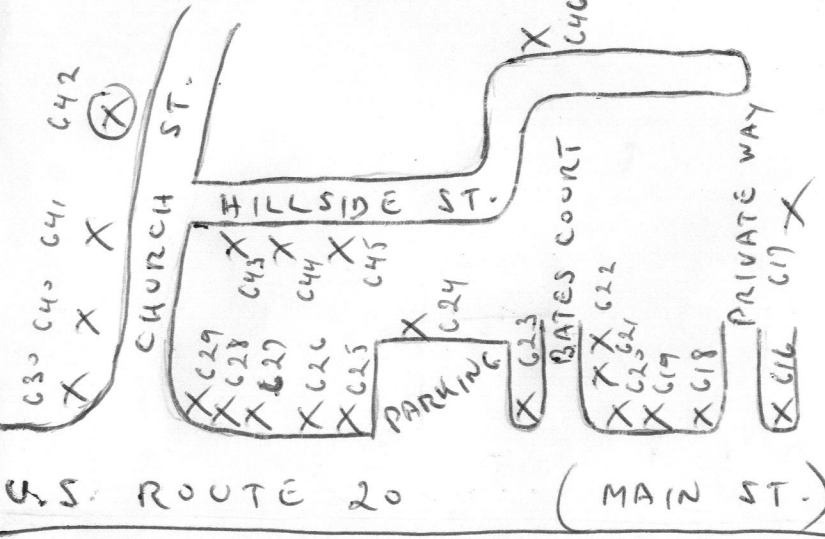

U.S. ROUTE 20 (MAIN ST.)

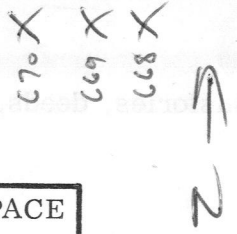

DO NOT WRITE IN THIS SPACE  
 USGS Quadrant \_\_\_\_\_  
 MHC Photo no. \_\_\_\_\_

(over)

AUG 8 1974

MASS. HIST. COMM.

Form no.	In Area no.
142	142

7. Original owner (if known) Fiske ?

Original use Dwelling

Subsequent uses (if any) and dates \_\_\_\_\_

8. Themes (check as many as applicable)

- |                       |                                     |                            |       |                         |       |
|-----------------------|-------------------------------------|----------------------------|-------|-------------------------|-------|
| Aboriginal            | _____                               | Conservation               | _____ | Recreation              | _____ |
| Agricultural          | _____                               | Education                  | _____ | Religion                | _____ |
| Architectural         | <input checked="" type="checkbox"/> | Exploration/<br>settlement | _____ | Science/<br>invention   | _____ |
| The Arts              | _____                               | Industry                   | _____ | Social/<br>humanitarian | _____ |
| Commerce              | _____                               | Military                   | _____ | Transportation          | _____ |
| Communication         | _____                               | Political                  | _____ |                         |       |
| Community development | <input checked="" type="checkbox"/> |                            |       |                         |       |

9. Historical significance (include explanation of themes checked above)

**Built by Fiskes?  
Two-family house, originally one family.**

Architect \_\_\_\_\_

Exterior wall fabric \_\_\_\_\_

Outbuildings (describe) \_\_\_\_\_

Other features \_\_\_\_\_

Altered \_\_\_\_\_ Date \_\_\_\_\_

Moved \_\_\_\_\_ Date \_\_\_\_\_

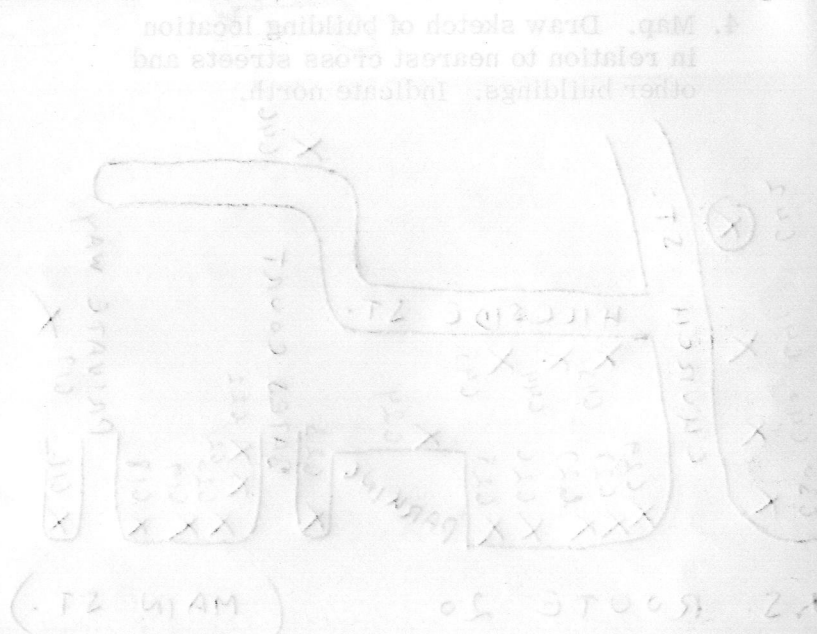

10. Bibliography and/or references (such as local histories, deeds, assessor's records, early maps, etc.)

Recorded by Heleen G. Holley

Organization Sturbridge Historical Comm

Date June 1973

DO NOT WRITE IN THIS SPACE

USGS Quadrant \_\_\_\_\_

MHC Photo no. \_\_\_\_\_

AUG 8 1974