

FORM B - BUILDING

MASSACHUSETTS HISTORICAL COMMISSION  
Office of the Secretary, State House, Boston

OCT 73

Pt. ASK  
6502 SOUTH  
SECT A

In Area no. <del>133</del> = E	Form no. 605
-----------------------------------	-----------------



Town STURBRIDGE 133

Address Hinman Street

Name Thorpe - Scott - Bousquet \*  
Anderson - Hinman - Bates

Present use Dwelling

Present owner Mr. & Mrs. Kennett Thorpe

Description:

Date 1880 - 90

Source Style and history

Style Late Victorian

4. Map. Draw sketch of building location in relation to nearest cross streets and other buildings. Indicate north.

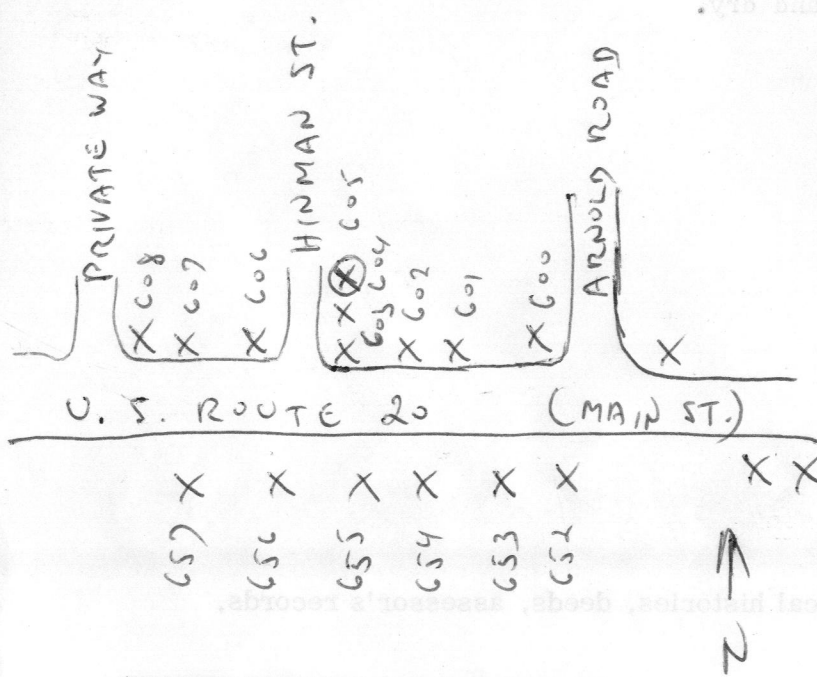

Architect \_\_\_\_\_

Exterior wall fabric Clapboard covered with aluminum siding

Outbuildings (describe) Barn

Other features \_\_\_\_\_

Altered \_\_\_\_\_ Date \_\_\_\_\_

Moved \_\_\_\_\_ Date \_\_\_\_\_

5. Lot size:

One acre or less X Over one acre \_\_\_\_\_

Approximate frontage 300 ft.

Approximate distance of building from street 50'

DO NOT WRITE IN THIS SPACE

USGS Quadrant \_\_\_\_\_

MHC Photo no. \_\_\_\_\_

6. Recorded by Helen G. Holley

Organization Sturbridge Historical Comm.

Date July 1973 RECEIVED

(over)

AUG 8 1974

MASS. HIST. COMM.

7. Original owner (if known) Emory L. Bates

Original use Dwelling

Subsequent uses (if any) and dates \_\_\_\_\_

8. Themes (check as many as applicable)

- |                       |                                     |                            |       |                         |                                     |
|-----------------------|-------------------------------------|----------------------------|-------|-------------------------|-------------------------------------|
| Aboriginal            | _____                               | Conservation               | _____ | Recreation              | _____                               |
| Agricultural          | _____                               | Education                  | _____ | Religion                | _____                               |
| Architectural         | <input checked="" type="checkbox"/> | Exploration/<br>settlement | _____ | Science/<br>invention   | <input checked="" type="checkbox"/> |
| The Arts              | _____                               | Industry                   | _____ | Social/<br>humanitarian | _____                               |
| Commerce              | _____                               | Military                   | _____ | Transportation          | _____                               |
| Communication         | _____                               | Political                  | _____ |                         |                                     |
| Community development | <input checked="" type="checkbox"/> |                            |       |                         |                                     |

9. Historical significance (include explanation of themes checked above)

This house was built by Emory L. Bates who built the high style Victorian - Italianate house now known as Simonelli's Antique Shop on Main Street for his only son and child, Arthur L. Bates when he was married. The house is exceptionally well constructed, and the barn is unusually fine. The staircase is semi-spiral with an elaborate newel post. Basement walls are thick; cellar has a dirt floor but is large and dry.



10. Bibliography and/or references (such as local histories, deeds, assessor's records, early maps, etc.)

Recorded by \_\_\_\_\_  
 Organization \_\_\_\_\_  
 Date \_\_\_\_\_

DO NOT WRITE IN THIS SPACE  
 USGS Quadrant \_\_\_\_\_  
 NHG Photo no. \_\_\_\_\_