

PROPOSED WATER SERVICE # 300 AND # 302 CLARKE RD EXT

EXISTING SEWER
 PROPOSED 1" WATER SERVICE
 PROPOSED STRAW WATTLES

PUBLIC WATER SUPPLY CONNECTION
 CLARKE ROAD EXTENSION

STATE	TOWN	SHEET NO.	TOTAL SHEETS
MA	STURBRIDGE	2	4

PROJECT NO. 808771
 C-1 CLARKE ROAD WATER MAIN PLAN

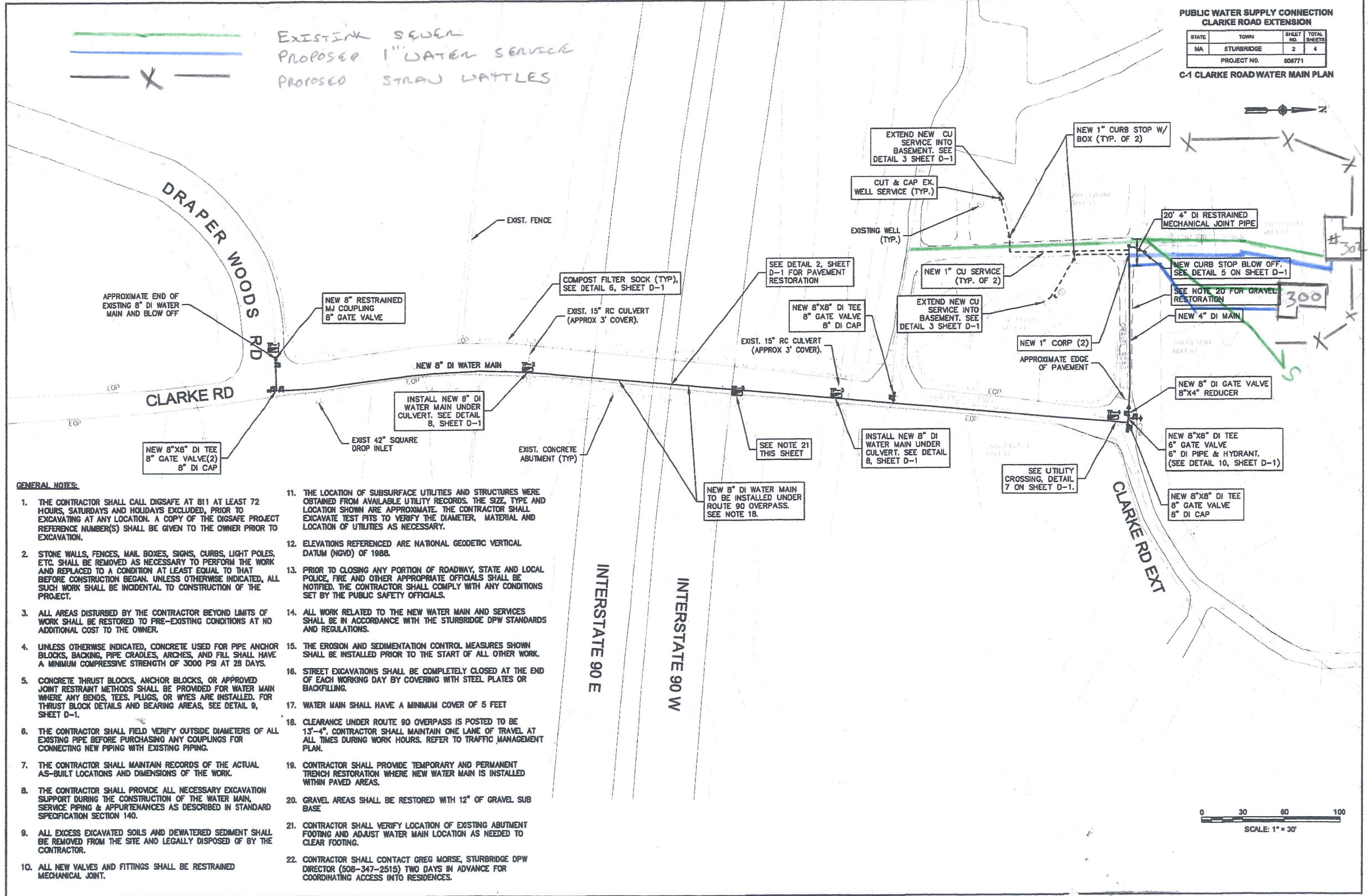

GENERAL NOTES:

1. THE CONTRACTOR SHALL CALL DIGSAFE AT 811 AT LEAST 72 HOURS, SATURDAYS AND HOLIDAYS EXCLUDED, PRIOR TO EXCAVATING AT ANY LOCATION. A COPY OF THE DIGSAFE PROJECT REFERENCE NUMBER(S) SHALL BE GIVEN TO THE OWNER PRIOR TO EXCAVATION.
2. STONE WALLS, FENCES, MAIL BOXES, SIGNS, CURBS, LIGHT POLES, ETC. SHALL BE REMOVED AS NECESSARY TO PERFORM THE WORK AND REPLACED TO A CONDITION AT LEAST EQUAL TO THAT BEFORE CONSTRUCTION BEGAN. UNLESS OTHERWISE INDICATED, ALL SUCH WORK SHALL BE INCIDENTAL TO CONSTRUCTION OF THE PROJECT.
3. ALL AREAS DISTURBED BY THE CONTRACTOR BEYOND LIMITS OF WORK SHALL BE RESTORED TO PRE-EXISTING CONDITIONS AT NO ADDITIONAL COST TO THE OWNER.
4. UNLESS OTHERWISE INDICATED, CONCRETE USED FOR PIPE ANCHOR BLOCKS, BACKING, PIPE CRADLES, ARCHES, AND FILL SHALL HAVE A MINIMUM COMPRESSIVE STRENGTH OF 3000 PSI AT 28 DAYS.
5. CONCRETE THRUST BLOCKS, ANCHOR BLOCKS, OR APPROVED JOINT RESTRAINT METHODS SHALL BE PROVIDED FOR WATER MAIN WHERE ANY BENDS, TEES, PLUGS, OR WYES ARE INSTALLED. FOR THRUST BLOCK DETAILS AND BEARING AREAS, SEE DETAIL 9, SHEET D-1.
6. THE CONTRACTOR SHALL FIELD VERIFY OUTSIDE DIAMETERS OF ALL EXISTING PIPE BEFORE PURCHASING ANY COUPLINGS FOR CONNECTING NEW PIPING WITH EXISTING PIPING.
7. THE CONTRACTOR SHALL MAINTAIN RECORDS OF THE ACTUAL AS-BUILT LOCATIONS AND DIMENSIONS OF THE WORK.
8. THE CONTRACTOR SHALL PROVIDE ALL NECESSARY EXCAVATION SUPPORT DURING THE CONSTRUCTION OF THE WATER MAIN, SERVICE PIPING & APPURTENANCES AS DESCRIBED IN STANDARD SPECIFICATION SECTION 140.
9. ALL EXCESS EXCAVATED SOILS AND DEWATERED SEDIMENT SHALL BE REMOVED FROM THE SITE AND LEGALLY DISPOSED OF BY THE CONTRACTOR.
10. ALL NEW VALVES AND FITTINGS SHALL BE RESTRAINED MECHANICAL JOINT.
11. THE LOCATION OF SUBSURFACE UTILITIES AND STRUCTURES WERE OBTAINED FROM AVAILABLE UTILITY RECORDS. THE SIZE, TYPE AND LOCATION SHOWN ARE APPROXIMATE. THE CONTRACTOR SHALL EXCAVATE TEST PITS TO VERIFY THE DIAMETER, MATERIAL AND LOCATION OF UTILITIES AS NECESSARY.
12. ELEVATIONS REFERENCED ARE NATIONAL GEODETIC VERTICAL DATUM (NGVD) OF 1988.
13. PRIOR TO CLOSING ANY PORTION OF ROADWAY, STATE AND LOCAL POLICE, FIRE AND OTHER APPROPRIATE OFFICIALS SHALL BE NOTIFIED. THE CONTRACTOR SHALL COMPLY WITH ANY CONDITIONS SET BY THE PUBLIC SAFETY OFFICIALS.
14. ALL WORK RELATED TO THE NEW WATER MAIN AND SERVICES SHALL BE IN ACCORDANCE WITH THE STURBRIDGE DPW STANDARDS AND REGULATIONS.
15. THE EROSION AND SEDIMENTATION CONTROL MEASURES SHOWN SHALL BE INSTALLED PRIOR TO THE START OF ALL OTHER WORK.
16. STREET EXCAVATIONS SHALL BE COMPLETELY CLOSED AT THE END OF EACH WORKING DAY BY COVERING WITH STEEL PLATES OR BACKFILLING.
17. WATER MAIN SHALL HAVE A MINIMUM COVER OF 5 FEET
18. CLEARANCE UNDER ROUTE 90 OVERPASS IS POSTED TO BE 13'-4". CONTRACTOR SHALL MAINTAIN ONE LANE OF TRAVEL AT ALL TIMES DURING WORK HOURS. REFER TO TRAFFIC MANAGEMENT PLAN.
19. CONTRACTOR SHALL PROVIDE TEMPORARY AND PERMANENT TRENCH RESTORATION WHERE NEW WATER MAIN IS INSTALLED WITHIN PAVED AREAS.
20. GRAVEL AREAS SHALL BE RESTORED WITH 12" OF GRAVEL SUB BASE
21. CONTRACTOR SHALL VERIFY LOCATION OF EXISTING ABUTMENT FOOTING AND ADJUST WATER MAIN LOCATION AS NEEDED TO CLEAR FOOTING.
22. CONTRACTOR SHALL CONTACT GREG MORSE, STURBRIDGE DPW DIRECTOR (508-347-2515) TWO DAYS IN ADVANCE FOR COORDINATING ACCESS INTO RESIDENCES.