

**LA QUINTA INN & SUITES / STURBRIDGE, MA**  
**PROPOSED LQUP IMPLEMENTATION**  
 (DESIGN SUBMITTAL)



CONFIRMED / DATE:

ARCHITECTURAL  
CLADDING PANEL:

**MSI**

Making Dream Surfaces Attainable

RSC DESIGNED BY:



**S'thetics**

For All Premises

S'thetics Building Systems Inc.

#2 6201 Highway 7  
Woodbridge ON  
L4H 0K7 CA

PROJECT:



LQUP @ La Quinta Inn Sturbridge  
478 Main St, Sturbridge, MA 01518

SEAL :

INSTALLER :

REVISIONS :

NO	DATE	REVISION	BY
02	02/08/2024	Proposed Site Plan Updated	TO
03	03/12/2024	Existing Site Plan Added & LFT Area Updated	TO
04	03/15/2024	Proposed Site Plan Updated	TO
05	03/18/2024	Proposed Site Plan Updated Canopy & Entrance Plan Added	TO
06	03/19/2024	Proposed Site Plan Updated	TO
07	03/25/2024	Proposed Site Plan Updated	TO

DRAWING TITLE:

DRAWN BY : TALHA ORUC      CHECKED BY : BAHAR YUCEL

SCALE :      DATE : 03/25/2024

SHEET NAME:

**COVER PAGE**  
(DS)

SHEET NUMBER:

0.0



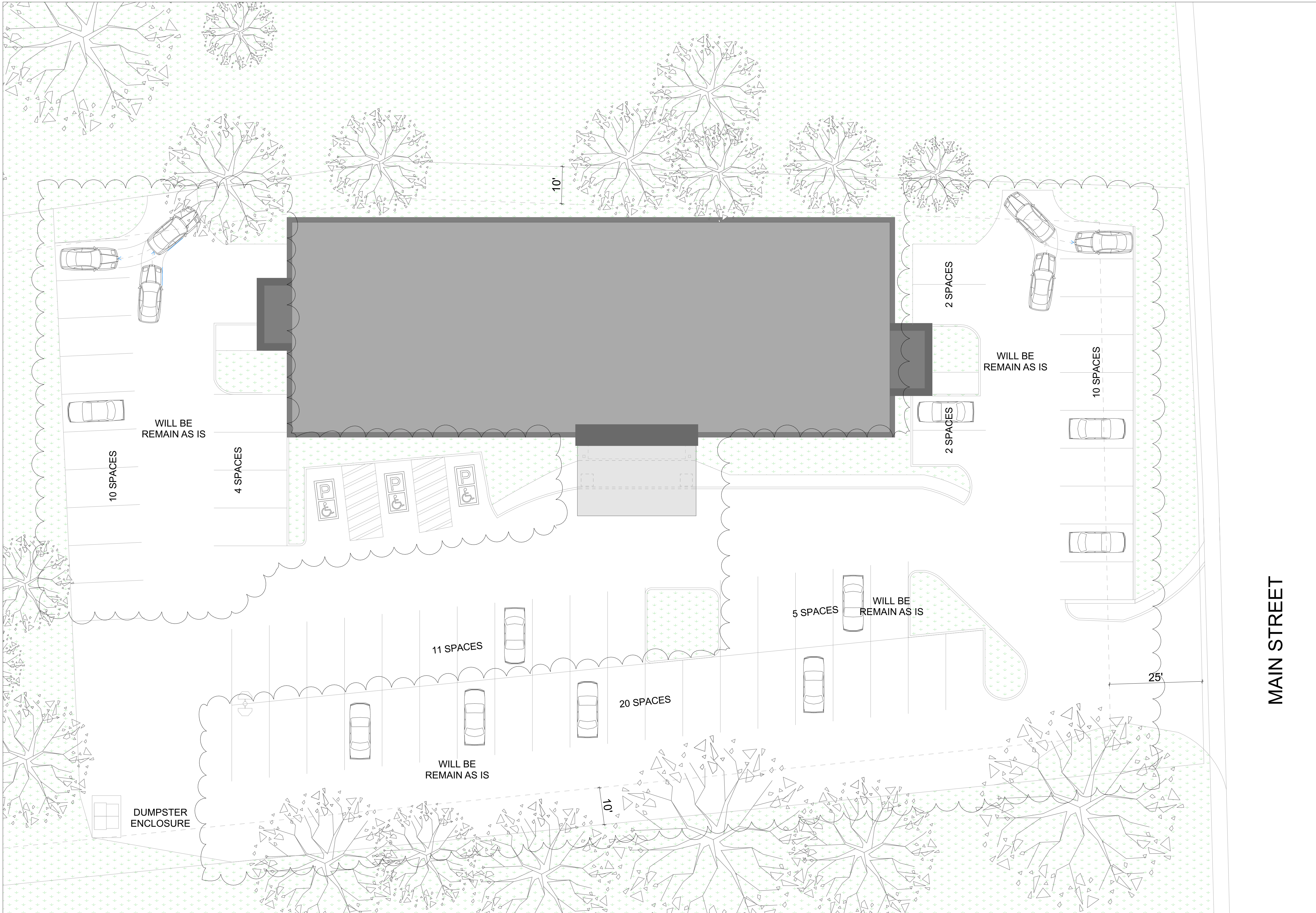

1 EXISTING SITE PLAN  
1.0

TOTAL PARKING SPOTS= 67 UNITS

ARCHITECTURAL  
CLADDING PANEL:



RSC DESIGNED BY:



S'thetics Building Systems Inc.

#2 6201 Highway 7  
Woodbridge ON  
L4H 0K7 CA

PROJECT:



LQUP @ La Quinta Inn Sturbridge  
478 Main St, Sturbridge, MA 01518

SEAL :

INSTALLER :

REVISIONS :

NO	DATE	REVISION	BY
02	02/08/2024	Proposed Site Plan Updated	TO
03	03/12/2024	Existing Site Plan Added & LFT Area Updated	TO
04	03/15/2024	Proposed Site Plan Updated	TO
05	03/18/2024	Proposed Site Plan Updated Canopy & Entrance Plan Added	TO
06	03/19/2024	Proposed Site Plan Updated	TO
07	03/25/2024	Proposed Site Plan Updated	TO

DRAWING TITLE:

DRAWN BY : TALHA ORUC	CHECKED BY : BAHAR YUCEL
SCALE :	DATE : 03/25/2024

SHEET NAME:

EXISTING SITE PLAN  
(DS)

SHEET NUMBER:

1.0



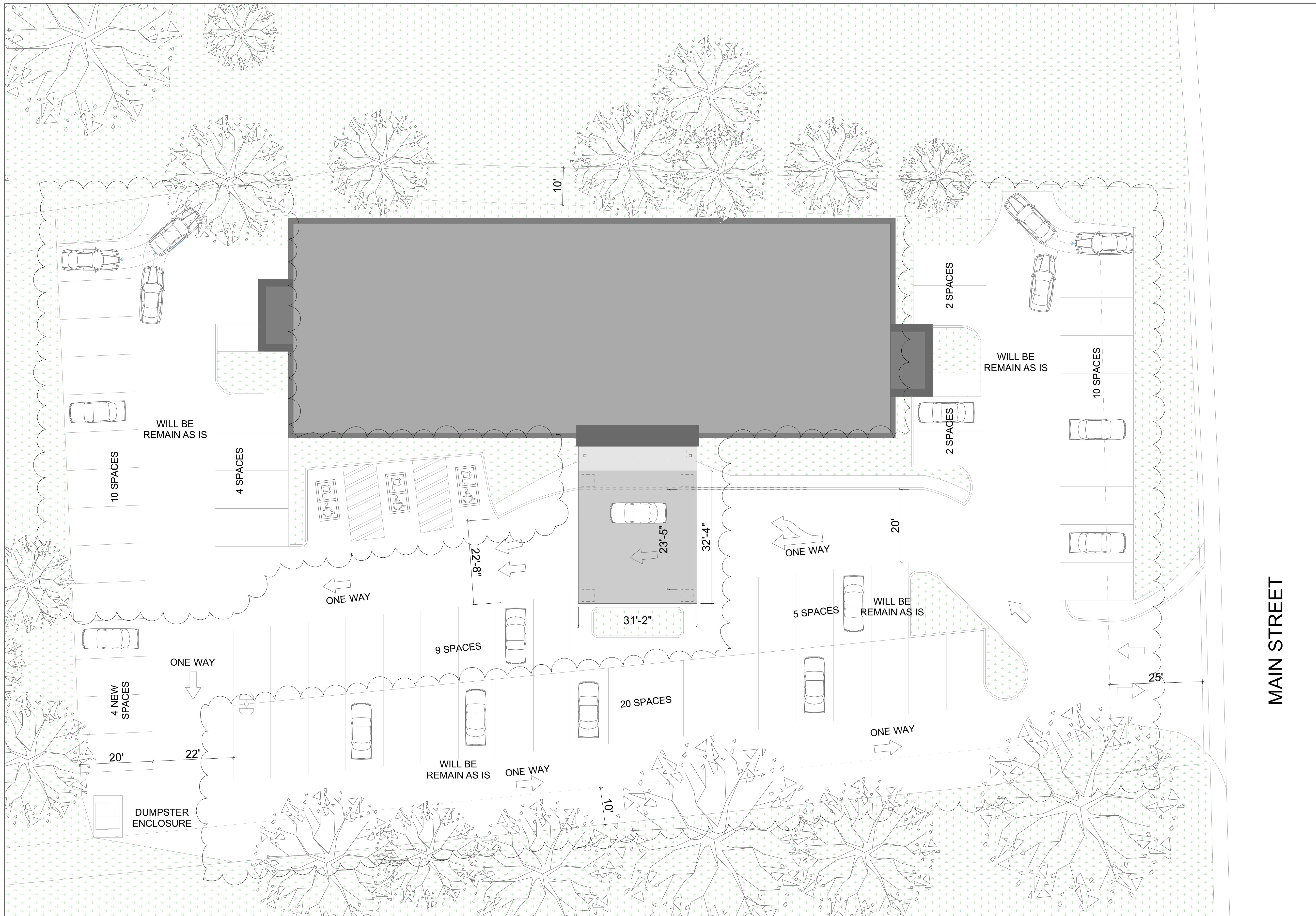

ARCHITECTURAL  
CLADDING PANEL:



RSC DESIGNED BY:



S'thetics Building Systems Inc.

#2 6201 Highway 7  
Woodbridge ON  
L4H 0K7 CA

PROJECT:



LQUP @ La Quinta Inn Sturbridge  
478 Main St, Sturbridge, MA 01518

SEAL :

INSTALLER :

REVISIONS :

NO	DATE	REVISION	BY
02	02/08/2024	Proposed Site Plan Updated	TO
03	03/12/2024	Existing Site Plan Added & LFT Area Updated	TO
04	03/15/2024	Proposed Site Plan Updated	TO
05	03/18/2024	Canopy & Entrance Plan Added	TO
06	03/19/2024	Proposed Site Plan Updated	TO
07	03/25/2024	Proposed Site Plan Updated	TO

DRAWING TITLE:

DRAWN BY : TALHA ORUC	CHECKED BY : BAHAR YUCEL
SCALE :	DATE : 03/25/2024

SHEET NAME:

PROPOSED SITE PLAN  
(DS)

SHEET NUMBER:

1.1



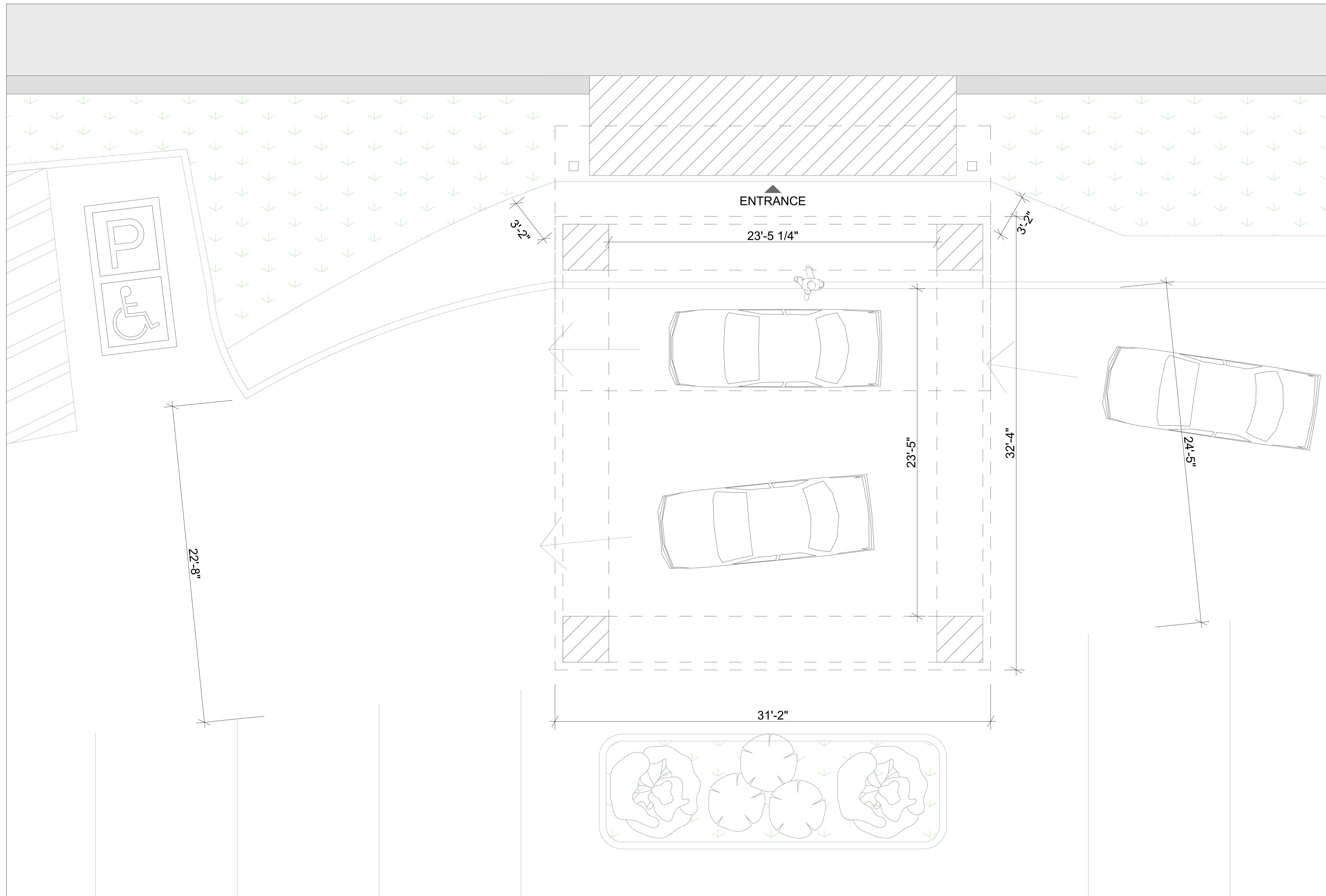

ARCHITECTURAL  
CLADDING PANEL:

**MSI**

Making Dream Surfaces Attainable

RSC DESIGNED BY:



**S'thetics**

For All Premises

S'thetics Building Systems Inc.

#2 6201 Highway 7  
Woodbridge ON  
L4H 0K7 CA

PROJECT:



LQUP @ La Quinta Inn Sturbridge  
478 Main St, Sturbridge, MA 01518

SEAL :

INSTALLER :

REVISIONS :

NO	DATE	REVISION	BY
02	02/08/2024	Proposed Site Plan Updated	TO
03	03/12/2024	Existing Site Plan Added & LFT Area Updated	TO
04	03/15/2024	Proposed Site Plan Updated	TO
05	03/18/2024	Proposed Site Plan Updated Canopy & Entrance Plan Added	TO
06	03/19/2024	Proposed Site Plan Updated	TO
07	03/25/2024	Proposed Site Plan Updated	TO

DRAWING TITLE:

DRAWN BY :  
TALHA ORUC

CHECKED BY :  
BAHAR YUCEL

SCALE :

DATE :  
03/25/2024

SHEET NAME:

**CANOPY & ENTRANCE  
PLAN  
(DS)**

SHEET NUMBER:

**1.2**

**3** CANOPY & ENTRANCE PLAN  
1.2