

GROUND-MOUNTED PHOTOVOLTAIC SYSTEM

200 HAYNES STREET
STURBRIDGE, MASSACHUSETTS

AUGUST 1, 2023

REVISED: JANUARY 31, 2024

ZONING COMPLIANCE TABLE		
CRITERIA: ARTICLE XIV – INTENSITY REGULATIONS (§300-14.2, SPECIAL USE)		
	REQUIRED	PROPOSED
MINIMUM LOT AREA	1 ACRE	13.92 ACRES
MINIMUM LOT FRONTAGE	200'	1,619.5'±
MINIMUM STREET SETBACK	50'	54.2'
MINIMUM SIDE/REAR YARD SETBACK	30'	192.3'
MAX. LOT COVERAGE (%)	30%	17.0%
MAXIMUM HEIGHT	35'	N/A
CRITERIA: ARTICLE X – SOLAR ENERGY FACILITIES (§300-10.1 – §300.10.12)		
	REQUIRED	PROPOSED
MINIMUM FRONT/SIDE/REAR YARD SETBACK	100'	100.6'
MINIMUM RESIDENTIAL LANDSCAPED BUFFER	200'	200.0'
MAX. PARCEL COVERAGE	20%	16.9%

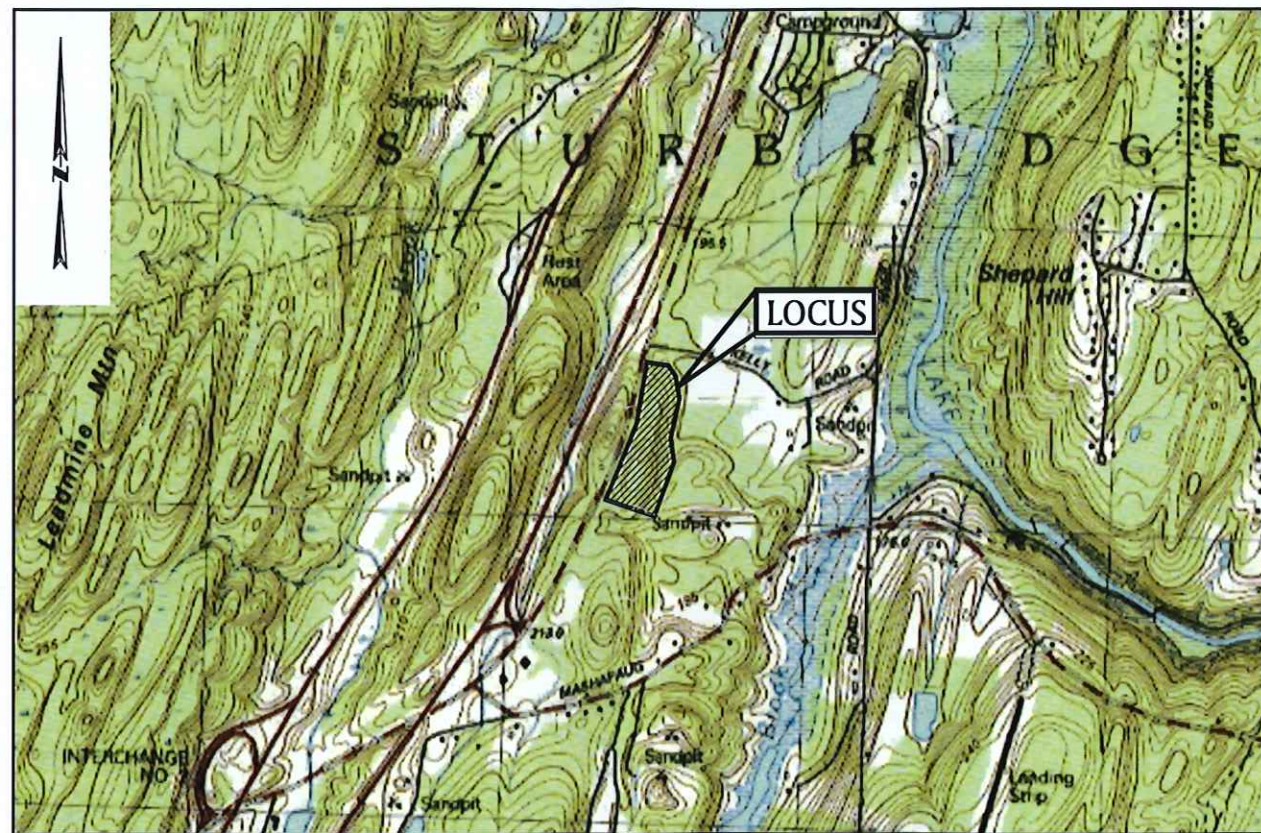

LOCUS MAP

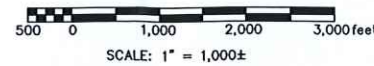

01/31/23

INDEX OF DRAWINGS

- 1 TITLE SHEET
- 2 EXISTING CONDITIONS PLAN
- 3 EROSION & SEDIMENTATION CONTROL PLAN
- 4 LAYOUT & MATERIALS PLAN
- 5 GRADING PLAN
- 6 DRAINAGE PLAN
- 7 PLANTING PLAN
- 8-9 DETAIL SHEETS

RECEIVED
FEB - 5 2024

TOWN OF STURBRIDGE
PLANNING BOARD

PREPARED FOR:

STURBRIDGE PV, LLC
2420 17TH STREET
DENVER, CO 80202

PREPARED BY:

BSC GROUP
349 Main Street - Route 28
W. Yarmouth, Massachusetts
02673
508 778 8919

ISSUED FOR PERMITTING
NOT FOR CONSTRUCTION

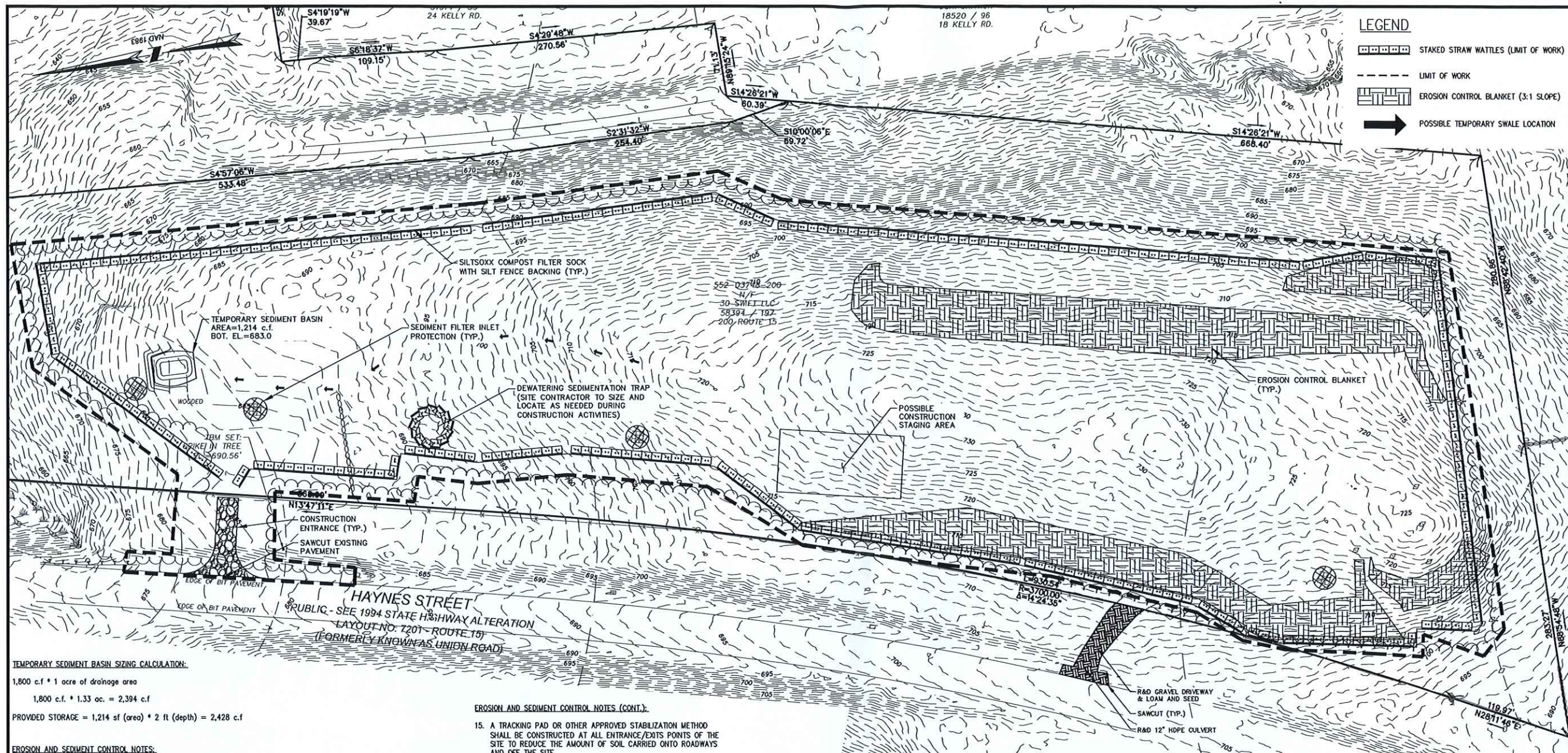

TEMPORARY SEDIMENT BASIN SIZING CALCULATION:
 1,800 c.f. * 1 acre of drainage area
 1,800 c.f. * 1.33 ac. = 2,394 c.f.
 PROVIDED STORAGE = 1,214 sf (area) * 2 ft (depth) = 2,428 c.f.

EROSION AND SEDIMENT CONTROL NOTES:

1. PRIOR TO ANY LAND DISTURBANCE ACTIVITIES COMMENCING ON THE SITE, THE DEVELOPER SHALL PHYSICALLY MARK LIMITS OF NO LAND DISTURBANCE ON THE SITE WITH TAPE, SIGNS, OR ORANGE CONSTRUCTION FENCE, SO THAT WORKERS CAN SEE THE AREAS TO BE PROTECTED. THE PHYSICAL MARKERS SHALL REMAIN IN PLACE UNTIL A CERTIFICATE OF COMPLETION HAS BEEN ISSUED.
2. APPROPRIATE EROSION AND SEDIMENT CONTROL MEASURES SHALL BE INSTALLED PRIOR TO SOIL DISTURBANCE. MEASURES SHALL BE TAKEN TO CONTROL EROSION WITHIN THE PROJECT AREA. SEDIMENT IN RUNOFF WATER SHALL BE TRAPPED AND RETAINED WITHIN THE PROJECT AREA. WETLAND AREAS AND SURFACE WATERS SHALL BE PROTECTED FROM SEDIMENT.
3. MINIMIZE TOTAL AREA OF DISTURBANCE AND PROTECT NATURAL FEATURES AND SOIL.
4. THE CONTRACTOR SHALL SEQUENCE ALL ACTIVITIES TO MINIMIZE SIMULTANEOUS AREAS OF DISTURBANCE. MASS CLEARING AND GRADING OF THE ENTIRE SITE SHALL BE AVOIDED.
5. MINIMIZE SOIL EROSION AND CONTROL SEDIMENTATION DURING CONSTRUCTION.
6. DIVERT UNCONTAMINATED WATER AROUND DISTURBED AREAS.
7. INSTALL AND MAINTAIN ALL EROSION AND SEDIMENT CONTROL MEASURES IN ACCORDANCE WITH THE MANUFACTURER'S SPECIFICATIONS AND GOOD ENGINEERING PRACTICES OR IN ACCORDANCE WITH THE 2017 EPA CONSTRUCTION GENERAL PERMIT.
8. PROTECT AND MANAGE ON AND OFF-SITE MATERIAL STORAGE AREAS (OVERBURDEN AND STOCKPILES OF DIRT, BORROW AREAS, OR OTHER AREAS USED SOLELY BY THE PERMITTED PROJECT ARE CONSIDERED A PART OF THE PROJECT).
9. COMPLY WITH APPLICABLE FEDERAL, STATE AND LOCAL LAWS AND REGULATIONS INCLUDING WASTE DISPOSAL, SANITARY OR SEWER REGULATIONS, AND AIR QUALITY REQUIREMENTS, INCLUDING DUST CONTROL.
10. SEDIMENT SHALL BE REMOVED ONCE THE VOLUME REACHES 1/4 TO 1/2 THE HEIGHT OF THE EROSION CONTROL DEVICE. SEDIMENT SHALL BE REMOVED FROM SILT FENCE PRIOR TO REACHING THE LOAD-BEARING CAPACITY OF THE SILT FENCE WHICH MAY BE LOWER THAN 1/4 TO 1/2 THE HEIGHT.
11. SEDIMENT FROM SEDIMENT TRAPS OR SEDIMENTATION PONDS SHALL BE REMOVED WHEN DESIGN CAPACITY HAS BEEN REDUCED BY 50 PERCENT.
12. BMPs TO BE USED FOR INFILTRATION AFTER CONSTRUCTION SHALL NOT BE USED AS BMPs DURING CONSTRUCTION UNLESS OTHERWISE APPROVED IN WRITING BY THE ENGINEER AND THE TOWN OF STURBRIDGE. MANY INFILTRATION TECHNOLOGIES ARE NOT DESIGNED TO HANDLE THE HIGH CONCENTRATIONS OF SEDIMENTS TYPICALLY FOUND IN CONSTRUCTION RUNOFF, AND THUS MUST BE PROTECTED FROM CONSTRUCTION RELATED SEDIMENT LOADINGS.
13. SOIL STOCKPILES MUST BE STABILIZED OR COVERED AT THE END OF EACH WORKDAY. STOCKPILE SIDE SLOPES SHALL NOT BE GREATER THAN 2:1. ALL STOCKPILES SHALL BE SURROUNDED BY SEDIMENT CONTROLS.
14. FOR ACTIVE CONSTRUCTION AREAS SUCH AS BORROW OR STOCKPILE AREAS, ROADWAY IMPROVEMENTS AND AREAS WITHIN 50 FEET OF A BUILDING UNDER CONSTRUCTION, A PERIMETER SEDIMENT CONTROL SYSTEM SHALL BE INSTALLED AND MAINTAINED TO CONTAIN SOIL.

EROSION AND SEDIMENT CONTROL NOTES (CONT.):

15. A TRACKING PAD OR OTHER APPROVED STABILIZATION METHOD SHALL BE CONSTRUCTED AT ALL ENTRANCE/EXIT POINTS OF THE SITE TO REDUCE THE AMOUNT OF SOIL CARRIED ONTO ROADWAYS AND OFF THE SITE.
16. ON THE CUT SIDE OF ROADS, DITCHES SHALL BE STABILIZED IMMEDIATELY WITH ROCK RIP-RAP OR OTHER NON-ERODIBLE LINERS, OR WHERE APPROPRIATE, VEGETATIVE MEASURES SUCH AS HYDROSEEDING OR JUTE MATTING.
17. PERMANENT SEEDING SHALL BE UNDERTAKEN IN THE SPRING FROM MARCH THROUGH MAY, AND IN LATE SUMMER AND EARLY FALL FROM AUGUST TO OCTOBER 15. DURING THE PEAK SUMMER MONTHS AND IN THE FALL AFTER OCTOBER 15, WHEN SEEDING IS FOUND TO BE IMPRACTICAL, APPROPRIATE TEMPORARY STABILIZATION SHALL BE APPLIED. PERMANENT SEEDING MAY BE UNDERTAKEN DURING THE SUMMER IF PLANS PROVIDE FOR ADEQUATE MULCHING AND WATERING.
18. ALL SLOPES STEEPER THAN 3:1 (H:V, 33.3%), AS WELL AS PERIMETER DIKES, SEDIMENT BASINS OR TRAPS, AND EMBANKMENTS MUST, UPON COMPLETION, BE IMMEDIATELY STABILIZED WITH SOIL, SEED AND ANCHORED STRAW MULCH, OR OTHER APPROVED STABILIZATION MEASURES. AREAS OUTSIDE OF THE PERIMETER SEDIMENT CONTROL SYSTEM MUST NOT BE DISTURBED.
19. TEMPORARY SEDIMENT TRAPPING DEVICES MUST NOT BE REMOVED UNTIL PERMANENT STABILIZATION IS ESTABLISHED IN ALL CONTRIBUTORY DRAINAGE AREAS.
20. ALL TEMPORARY EROSION AND SEDIMENT CONTROL MEASURES SHALL BE REMOVED AFTER FINAL SITE STABILIZATION. DISTURBED SOIL AREAS RESULTING FROM THE REMOVAL OF TEMPORARY MEASURES SHALL BE PERMANENTLY STABILIZED WITHIN 30 DAYS OF REMOVAL.
21. PROPERLY MANAGE ON-SITE CONSTRUCTION AND WASTE MATERIALS.
22. PREVENT OFF-SITE VEHICLE TRACKING OF SEDIMENTS.
23. DUST SHALL BE CONTROLLED AT THE SITE.
24. ALL PREVIOUSLY DISTURBED LAND SHALL BE STABILIZED BY APPROVED METHODS AFTER 14 DAYS IF LEFT UNDISTURBED, THIS INCLUDES STOCKPILES, CONSTRUCTION ENTRANCES, GRADED AREAS AND OTHER CONSTRUCTION ACTIVITY RELATED CLEARING.
25. IF WORK IS HALTED OVER WINTER MONTHS THE CONTRACTOR SHALL BE RESPONSIBLE FOR STABILIZING THE AREA THROUGH GROUND COVER PRACTICES.

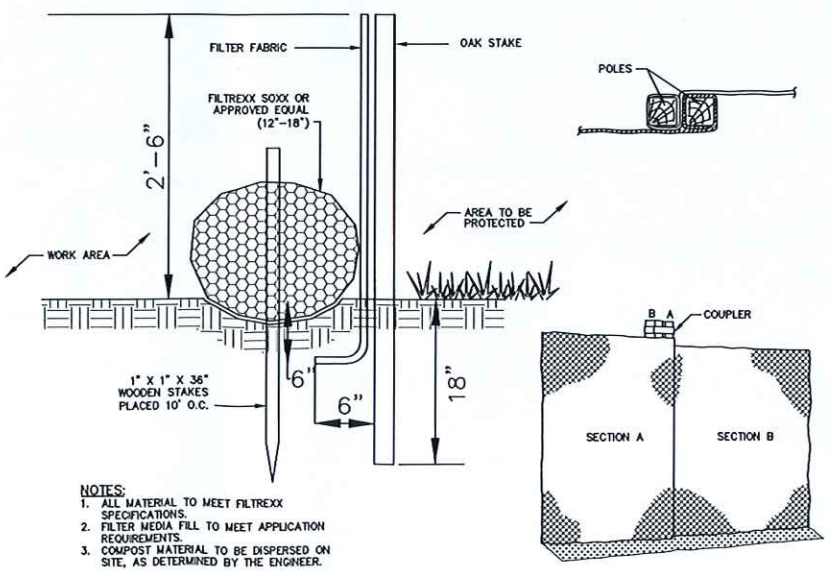

- NOTES:**
1. ALL MATERIAL TO MEET FILTREXX SPECIFICATIONS.
 2. FILTER MEDIA FILL TO MEET APPLICATION REQUIREMENTS.
 3. COMPOST MATERIAL TO BE DISPERSED ON SITE, AS DETERMINED BY THE ENGINEER.

SILTISOXX COMPOST FILTER SOCK WITH SILT FENCE BACKING
 SCALE: NONE

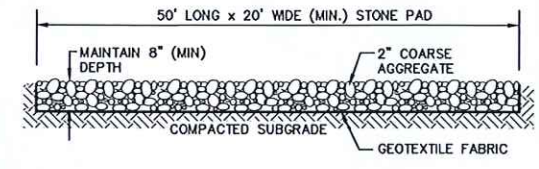

TEMPORARY CONSTRUCTION ENTRANCE
 SCALE: NONE

BRIAN G. YERGATIAN
 PROFESSIONAL ENGINEER

GROUND-MOUNTED PHOTOVOLTAIC SYSTEM
 200 HAYNES STREET
 IN
 STURBRIDGE MASSACHUSETTS (WORCESTER COUNTY)
EROSION & SEDIMENT CONTROL PLAN

AUGUST 1, 2023

REVISIONS:

NO.	DATE	DESC.
1	11/15/23	PER PEER REVIEW
2	01/16/24	PER PEER REVIEW

ISSUED FOR PERMITTING NOT FOR CONSTRUCTION

PREPARED FOR:
 STURBRIDGE PV, LLC
 2420 17TH STREET
 DENVER, CO 80202

BSC GROUP
 349 Main Street - Route 28
 West Yarmouth, Massachusetts
 02673
 508 778 8919

© 2022 BSC Group, Inc.
 SCALE: 1" = 50'



JOB NO. 5-0745.00
 SHEET 4 OF 9
 FILE: PROJECTS-YAR\5074500\5074500-SP.dwg
 DWG: DWG
 SCALE: 1" = 50'
 © 2022 BSC Group, Inc.
 508 778 8919
 02673
 349 Main Street - Route 28
 West Yarmouth, Massachusetts
BSC GROUP
 PREPARED FOR:
 STURBRIDGE P.V. LLC
 2420 17TH STREET
 DENVER, CO 80202

ISSUED FOR PERMITTING
NOT FOR CONSTRUCTION

NO.	DATE	DESC.
1	11/15/23	PER PEER REVIEW
2	01/16/24	PER PEER REVIEW

REVISIONS:
 AUGUST 1, 2023

**GROUND-MOUNTED
 PHOTOVOLTAIC
 SYSTEM**
 IN
 200 HAYNES STREET
 STURBRIDGE
 MASSACHUSETTS
 (WORCESTER COUNTY)
 LAYOUT & MATERIALS
 PLAN

BRIAN G. YERGANIAN
 PROFESSIONAL ENGINEER
 DATE

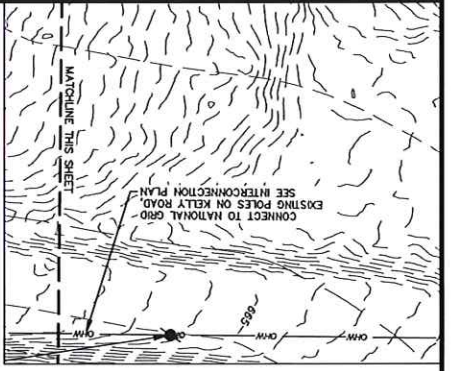

GENERAL NOTES
 1. THE AREA ENCLOSED BY CHAIN LINK FENCE IS 8.488 ACRES.
 2. CONSTRUCTION OF THE PROPOSED SITE IMPROVEMENTS REQUIRES THE CLEARING OF 8.204 ACRES OF WOODLANDS. IF NOT OTHERWISE SPECIFIED, WILL BE LOADED AND SEEDED WITH A POLLINATOR SEED MIXTURE.
 3. ALL DISTURBED AREAS WITHIN THE CHAIN LINK FENCE, IF NOT OTHERWISE SPECIFIED, WILL BE LOADED AND SEEDED WITH A POLLINATOR SEED MIXTURE.

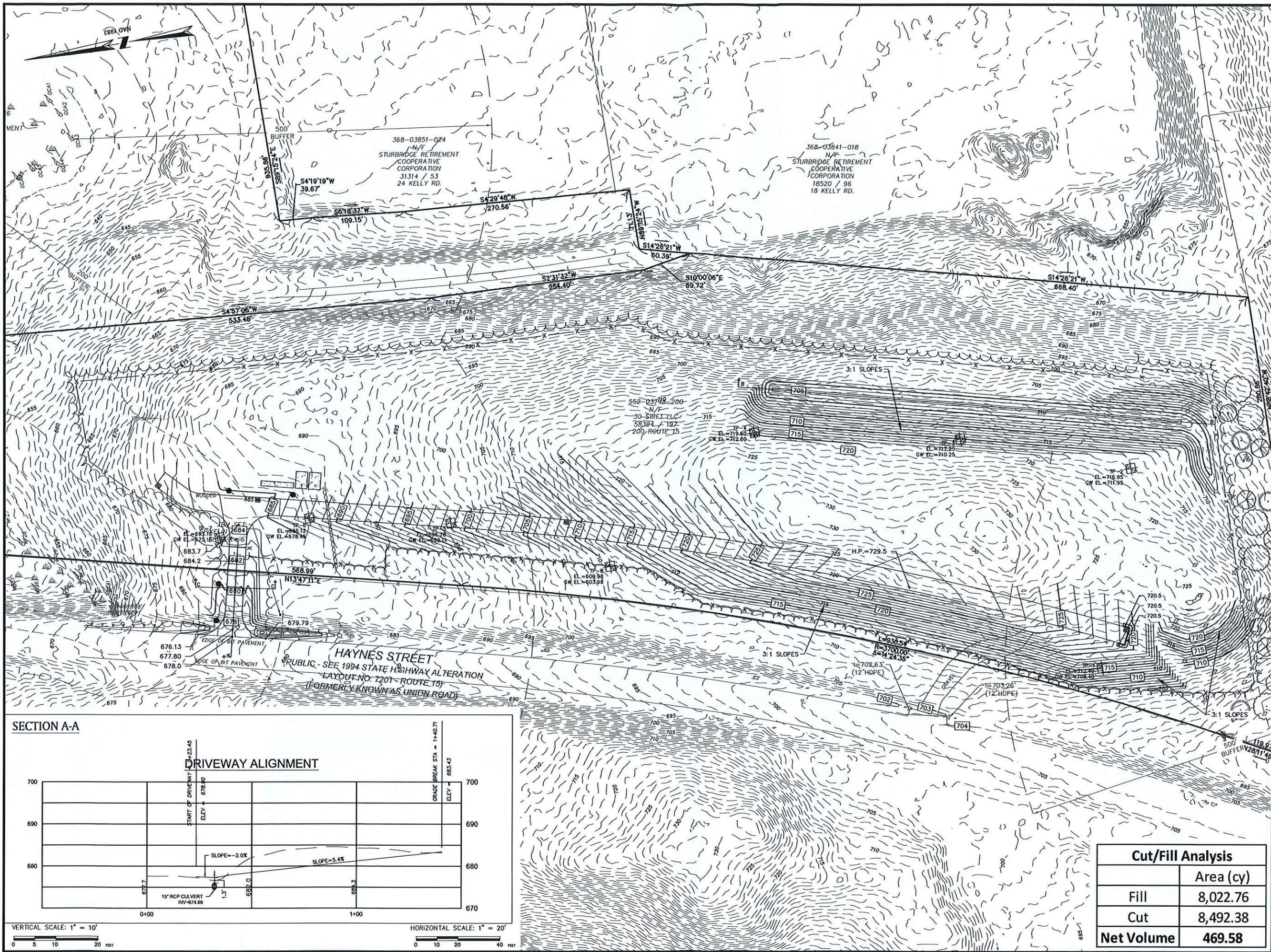

SECTION A-A

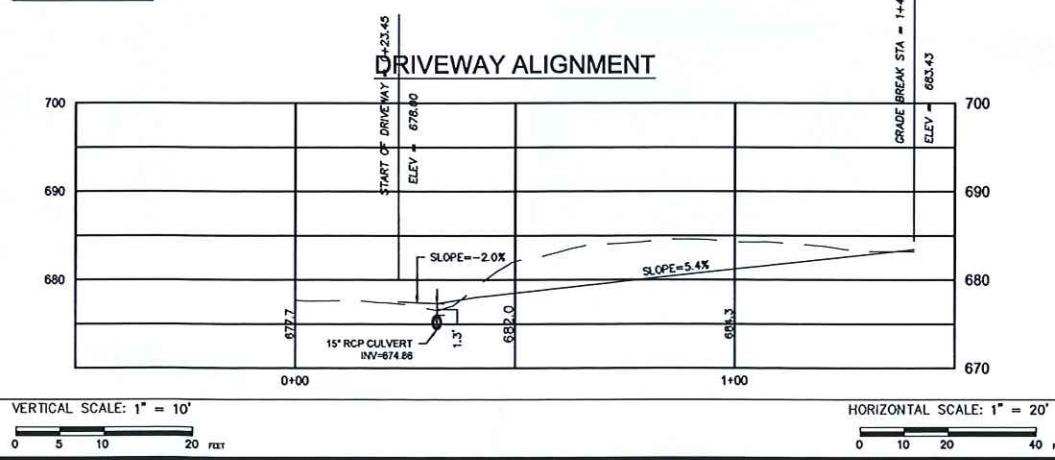

Cut/Fill Analysis	
	Area (cy)
Fill	8,022.76
Cut	8,492.38
Net Volume	469.58

BRIAN G. YERGATAN PROFESSIONAL ENGINEER DATE

GROUND-MOUNTED PHOTOVOLTAIC SYSTEM
 200 HAYNES STREET
 IN
 STURBRIDGE MASSACHUSETTS
 (WORCESTER COUNTY)

GRADING PLAN
 AUGUST 1, 2023

REVISIONS:		
NO.	DATE	DESC.
1	11/15/23	PER PEER REVIEW
2	01/16/24	PER PEER REVIEW

ISSUED FOR PERMITTING
 NOT FOR CONSTRUCTION

PREPARED FOR:
 STURBRIDGE PV, LLC
 2420 17TH STREET
 DENVER, CO 80202

BSC GROUP
 349 Main Street - Route 28
 West Yarmouth, Massachusetts
 02673
 508 778 8919

© 2022 BSC Group, Inc.
 SCALE: 1" = 50'
 0 25 50 100 FEET
 FILE: PROJECTS-YAR\5074500\C\5074500-SP.dwg
 DWG.: DWG
 JOB. NO: 5-0745.00 SHEET 5 OF 9

ISSUED FOR CONSTRUCTION
 NOT FOR PERMITTING

NO.	DATE	DESC.
1	11/15/23	PER PEER REVIEW
2	01/16/24	PER PEER REVIEW

REVISIONS:
 AUGUST 1, 2023
DRAINAGE PLAN
 IN
 200 HAYNES STREET
 STURBRIDGE
 MASSACHUSETTS
 (WORCESTER COUNTY)

BRIAN G. YERGANIAN
 PROFESSIONAL ENGINEER
 DATE

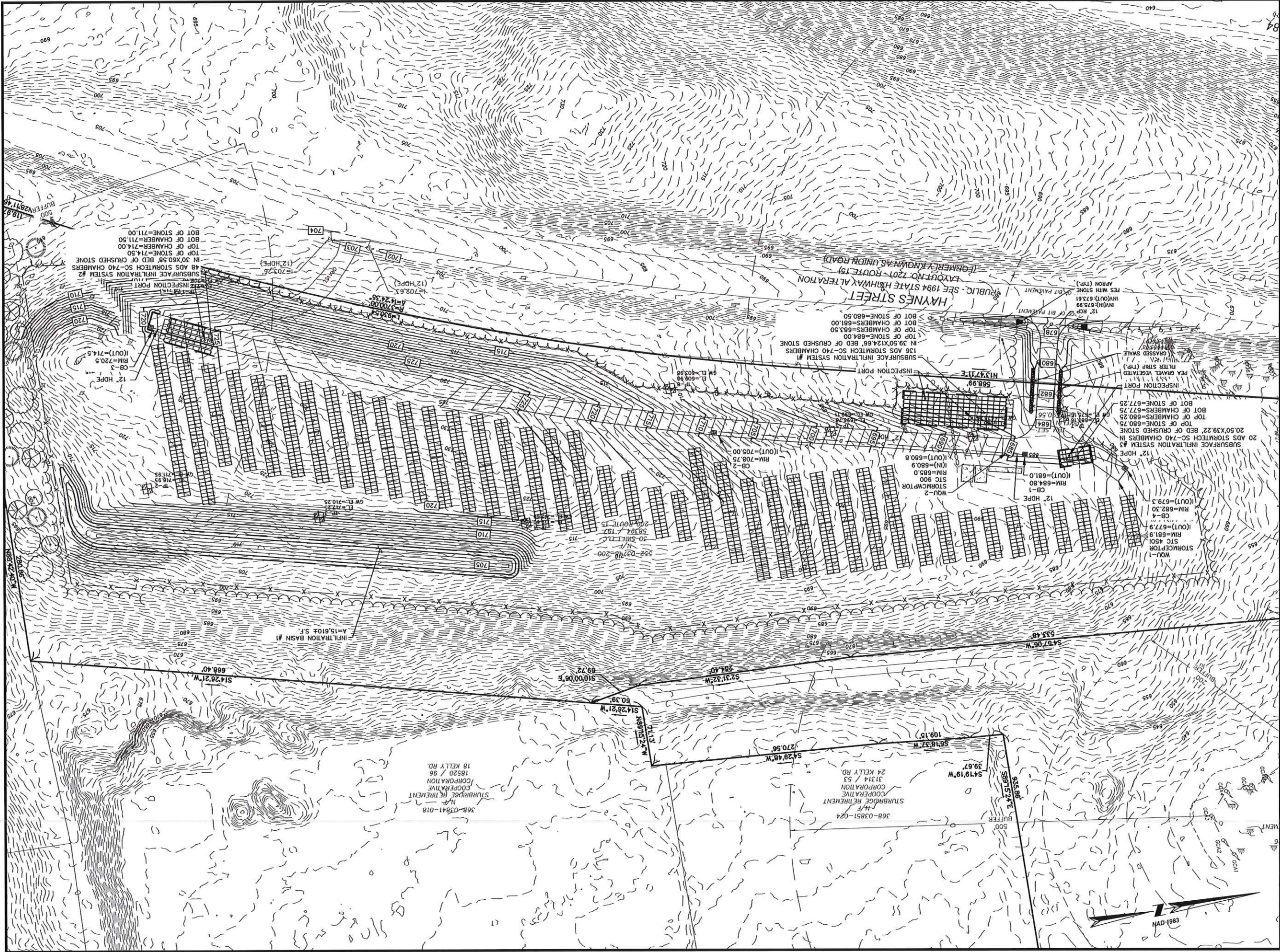

- EXAMINATION OF CONDITIONS:**
- THE CONTRACTOR SHALL BE RESPONSIBLE FOR JUDGING THE FULL EXTENT OF WORK REQUIREMENTS INVOLVED. THIS RESPONSIBILITY INCLUDES, BUT IS NOT LIMITED TO, THE FOLLOWING: TRANSPORTATION, PURCHASE, TEMPORARY STORAGE AND MAINTENANCE OF PLANTS, PLANT RE-HANDLING PRIOR TO FINAL INSTALLATION, REMOVAL AND OFF-SITE DISPOSAL OF EXISTING SOIL DETERMINED BY THE ENGINEER TO BE UNACCEPTABLE, PURCHASE, TRANSPORT, AND SUPPLY OF SOIL.
 - IMPORTED SOIL MUST BE FREE OF WEED SEEDS SUCH AS PERENNIALS, BIENNIALS, ANNUALS, AND GRASSES. IT IS ADVANTAGEOUS TO ALLOW SOIL TO SETTLE AND WEED SEEDS TO GERMINATE AND BE MOVED PRIOR TO SITE SEEDING.
 - VERIFY ALL EXISTING UTILITY LINES PRIOR TO PLANTING AND REPORT ANY CONFLICTS TO THE OWNER OR HIS REPRESENTATIVE.
- PLANTING NOTES:**
- ALL PLANT MATERIAL SHALL CONFORM TO THE MINIMUM GUIDELINES ESTABLISHED BY THE AMERICAN STANDARD FOR NURSERY STOCK PUBLISHED BY THE AMERICAN ASSOCIATION OF HURSDERMEN, INC.
 - PLANT MATERIALS SHALL BEAR SOME RELATIONSHIP TO GRADE AS THEY BORE TO GRADE IN THE NURSERY.
 - ALL TREES MOVED FOR CLEARING AND SELECTIVE PRUNING AND THINNING SHALL BE EXECUTED UNDER THE SUPERVISION OF A LICENSED ARBORIST.
 - THE CONTRACTOR SHALL CLEARLY MARK LIMITS OF CLEARING AND LIMITS OF SELECTIVE PRUNING AND THINNING FOR REVIEW BY THE A/E PRIOR TO ANY CLEARING OPERATIONS. VEGETATION THAT IS NOT USED IN HABITAT FEATURES OR REMOVED AS TIMBER PRODUCTS SHALL BE CHIPPED ON SITE AND INCORPORATED INTO TOP SOIL.
 - THE CONTRACTOR SHALL TAKE ALL MEASURES NECESSARY TO PROTECT EXISTING VEGETATION THAT IS TAGGED BY THE A/E, TO BE SHED.
 - ALL TREES TO BE SAVED SHALL BE PROTECTED WITH MARKED BOUNDS AT A MINIMUM DISTANCE OF 6', OR AS DIRECTED BY THE LANDSCAPE ARCHITECT.
 - THE A/E RESERVES THE RIGHT TO ADJUST FINAL GRADES IN THE FIELD TO SAVE EXISTING VEGETATION.
 - LOW AND SEED ALL DISTURBED AREAS UNLESS OTHERWISE INDICATED.
 - THE LANDSCAPE CONTRACTOR SHALL FURNISH TOPSOIL. TOPSOIL SHALL BE FERTILE, FRABLE, NATURAL AND PRODUCTIVE TOPSOIL OF GOOD CLAY-LOAM TYPE. IT SHALL BE FREE OF WEED SEEDS, TOPSOIL SHALL BE WITHOUT ADMIXTURE OF SURGE, AND SHALL BE REASONABLY FREE OF STONES, LUMPS, ROOTS, STICKS AND OTHER FOREIGN MATTER. TOPSOIL SHALL NOT BE MOVED OR APPLIED IN A MUDDY OR WET CONDITION.
 - STOCKPILE ROCKS, STUMPS, LOGS AND ORGANIC DEBRIS FROM SOIL SURFACE AS HABITAT AND GRADE TO AN UNEVEN SURFACE.

- MAINTENANCE PERIOD - 90 DAYS**
- THE MAINTENANCE PERIOD SHALL BEGIN IMMEDIATELY AFTER EACH PLANT IS PLANTED AND SHALL CONTINUE FOR A MINIMUM OF 90 DAYS FOLLOWING THE COMPLETION OF ALL PLANTING INSTALLATION WORK. UPON THE JOINT ACCEPTANCE OF ALL PLANTING WORK, WHOEVER IS A LONGER PERIOD OF TIME.
 - AT THE END OF THE MAINTENANCE PERIOD, THE CONTRACTOR WILL REQUEST INSPECTION BY THE OWNER'S REPRESENTATIVE AT LEAST 10 DAYS BEFORE THE ANTICIPATED DATE OF INSPECTION.
 - AT THE TIME OF INSPECTION, IF THE PLANT MATERIALS AND INFORMATION IS NOT ACCEPTABLE TO THE LANDSCAPE ARCHITECTS, THEY SHALL ISSUE A WRITTEN CERTIFICATE OF CONDITIONAL ACCEPTANCE TO THE CONTRACTOR. THE DATE OF THE INSPECTION SHALL ESTABLISH THE END OF THE MAINTENANCE PERIOD AND THE COMMENCEMENT OF THE REQUIRED ONE-YEAR ESTABLISHMENT PERIOD FOR PLANTING WORK.
 - IF IN THE LANDSCAPE ARCHITECTS' OPINION, PLANT MATERIALS AND/OR INFORMATION IS NOT ACCEPTABLE, THE MAINTENANCE PERIOD FOR ALL PLANTS SHALL BE EXTENDED UNTIL PLANT REPLACEMENTS ARE MADE OR OTHER DEFICIENCIES ARE CORRECTED. ALL DEAD AND UNSATISFACTORY PLANTS SHALL BE REMOVED PROMPTLY FROM THE PROJECT. REPLACEMENT PLANTS SHALL CONFORM TO ALL SPECIFICATIONS FOR THE ORIGINAL PLANTS AND SHALL BE PLANTED IN THE SAME MANNER.
- ESTABLISHMENT PERIOD - ONE YEAR**
- THE PURPOSE OF THE ESTABLISHMENT PERIOD IS TO NURTURE PLANTS AND SEEDS THROUGH AT LEAST ONE FULL GROWING SEASON AND ONE FULL WINTER. ALL PLANTS SHALL BE INSPECTED BY THE ENGINEER 90 DAYS AFTER THE JOINT ACCEPTANCE AND SHALL BE ALIVE AND IN SATISFACTORY GROWTH AT THE END OF THAT TIME. THE CONTRACTOR IS RESPONSIBLE FOR ARRANGING INSPECTION EARLY ENOUGH IN THE SEASON TO ALLOW ADEQUATE TIME TO PRODUCE AND INSTALL REPLACEMENT MATERIAL.
 - AT THE END OF THE ESTABLISHMENT PERIOD, EACH PLANT/ SEED TYPE SHALL SHOW HEALTHY GROWTH ON AT LEAST 75 PERCENT OF ITS TERMINAL STEMS, AS DETERMINED BY THE ENGINEER. DETERIORATION OF HEALTHY GROWTH SHALL INCLUDE, BUT IS NOT NECESSARILY LIMITED TO, WILTING, LEAVES OR TERMINAL BUDS. PLANTS FOUND TO BE UNACCEPTABLE SHALL BE REMOVED PROMPTLY FROM THE SITE AND REPLACED IMMEDIATELY OR DURING THE NEXT NORMAL PLANTING SEASON, OR RE-SEED AS PERMITTED BY THE SPECIFICATIONS.
 - THE LANDSCAPE ARCHITECT WILL INSPECT THE REPLACEMENT PLANTING WORK UPON THE REQUEST OF THE CONTRACTOR. REQUEST FOR INSPECTION SHALL BE RECEIVED BY THE LANDSCAPE ARCHITECT AT LEAST 10 DAYS BEFORE THE ANTICIPATED DATE OF INSPECTION.

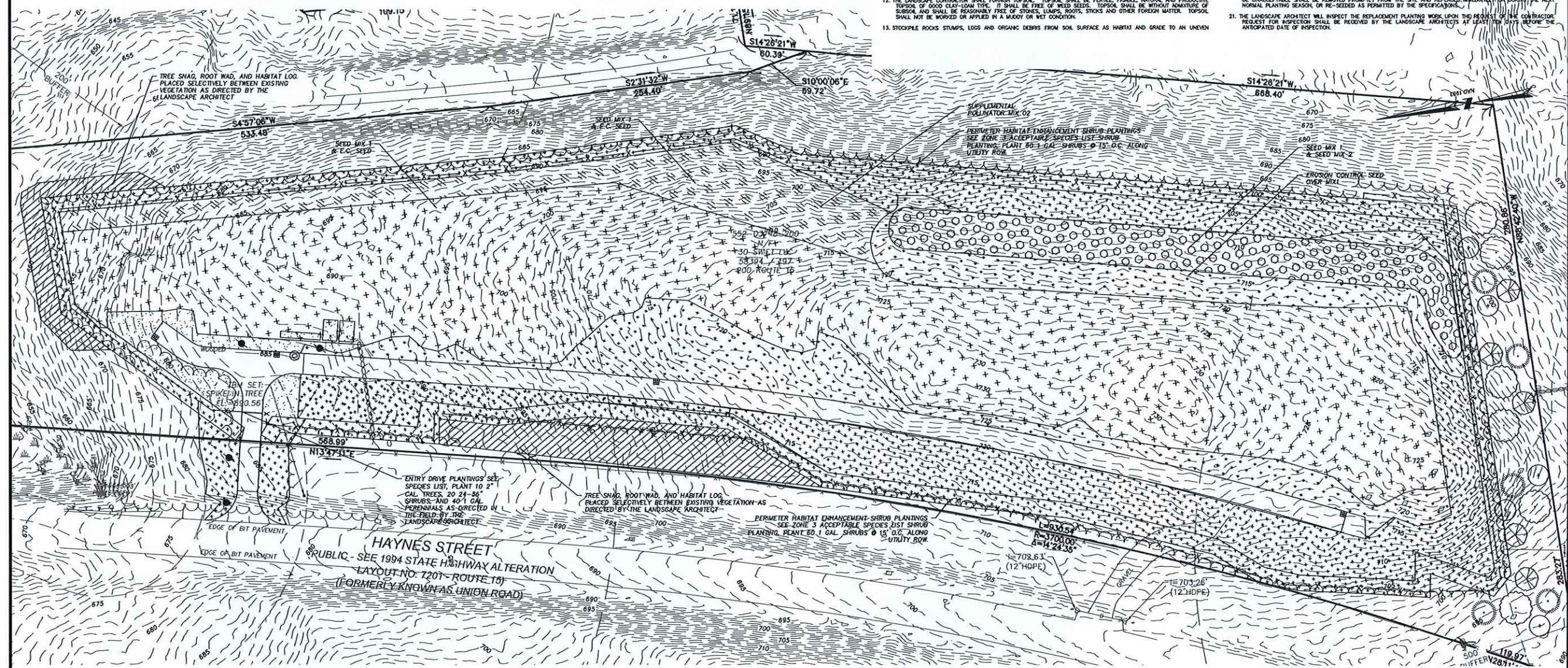

- BASE SEED MIXES**
- POLLINATOR MIXES ARE BEST SPREAD BY BROADCASTING USING A CYCLONE FERTILIZER SPREADER PRIOR TO HYDROSEEDING OR HYDROMULCHING. BROADCASTING NATIVE WINTER SEASON GRASS AND FORB SEEDS ARE IRREGULAR AND REQUIRE THE USE OF A CARRIER TO ENSURE THE MIXTURE FLOWS CORRECTLY THROUGH THE SPREADER AND THE SEED IS DISTRIBUTED EVENLY ACROSS THE FIELD.
- COVER CROP HYDROSEEDING OVER BASE SEED DURING ESTABLISHMENT**
- ALL SEEDED AREAS TO BEGAIN WITH A COVER CROP SELECTED RELATIVE TO SEASON SEED AT 20 LBS/ACRE WITH A COVER CROP. FOR A COVER CROP USE: JAPANESE MILLET (10 LBS/ACRE; 1 MAY TO 31 AUG), BARNYARD GRASS (10 LBS/ACRE; 1 MAY TO 31 AUG), OR GRAIN RYE (30 LBS/ACRE; 1 SEPT TO 30 APR).
- LOW UPLAND POLLINATOR MIX 1 UNDER ARRAY UNDER 3' PART SHADE**
- 1 LB/1000 FT.
ERWAX 612 OR EQUIVALENT
94.9% FESTUCA OVINA, (SHEEP FESCUE)
2.5% ASCLEPIAS TUBEROSA (BUTTERFLY MILKWEED)
2.0% CHAMAECRISTA FASCICULATA, (PARTRIDGE PEA)
0.3% GENOTHEIRA FRUTICOSA VAR. FRUTICOSA (SUNDROPS)
0.3% SISYRINCHUM ANGSTIFOLIUM (NARROWLEAF BLUE EYED GRASS)
- EROSION CONTROL SEED (OVER MIX 1 FOR STEEP SLOPES) UNDER 3'**
- 2 LB/1000 FT.
70% LORUM PERENNE, TETRAPLOID (PERENNIAL RYEGRASS, TETRAPLOID)
30% AVENA SATIVA, (OATS)
- POLLINATOR FRIENDLY TURF**
- 4 LB/1000 FT.
ERWAX 186
LOW GRASS MIX WITH RED AND WHITE CLOVER

- BASIN MIX 2 OUTSIDE ARRAY FULL SUN TRANSITIONAL MOISTURE**
- 1 LB/1000 FT.
ERWAX 610
37.0% SCIRPACHRYLUM SCOPARIUM (LITTLE BLUESTEM)
36.3% BOUTELOUJA CURTIPENDULA, BUTTE (SIDEOATS GRAMA, BUTTE)
4.0% CHAMAECRISTA FASCICULATA, (PARTRIDGE PEA)
4.0% COREOPSIS LANCEOLATA (LANCELEAF COREOPSIS)
4.0% ECHINACEA PURPUREA (PURPLE CONEFLOWER)
3.3% RUDBECKIA HIRTIA (BLACKEYED SUSAN)
2.3% HELIOPSIS HELIANTHODES, (OXYEY SUNFLOWER)
1.6% PENSTEMON DIGITALIS (TALL WHITE BEAR TONGUE)
1.5% ASCLEPIAS TUBEROSA (BUTTERFLY MILKWEED)
0.8% LIATRIS SPICATA (MARSH BLAZING STAR)
0.7% SENNA HESCARDIA, (WILD SENNA)
0.6% ZIZA ALUREA (GOLDEN ALEXANDERS)
0.5% ASCLEPIAS INCARNATA, (SWAMP MILKWEED)
0.5% GELM CANADENSE, (WHITE AVENS)
0.5% MONARDA FISTULOSA, (WILD BERGAMOT)
0.5% Pycnanthemum tenuifolium (NARROWLEAF MOUNTAINMINT)
0.4% ASTER LAEVIS, NY ECOTYPE (SMOOTH BLUE ASTER, NY ECOTYPE)
0.4% ASTER NOVAE-ANGIAE, (NEW ENGLAND ASTER)
0.3% BAPTISIA AUSTRALIS, SOUTHERN (BLUE FALSE INDIGO, SOUTHERN)
0.3% SISYRINCHUM ANGSTIFOLIUM (NARROWLEAF BLUE EYED GRASS)
0.2% GENOTHEIRA FRUTICOSA VAR. FRUTICOSA (SUNDROPS)
0.2% SOLIDAGO NEMORALIS, (GRAY GOLDENROD)
0.1% ASTER PRENANTHOIDES, (ZIZAG ASTER)
- POLLINATOR MIX 2 OUTSIDE ARRAY FULL SUN UNDER 4'**
- 1 LB/1000 FT.
ERWAX 146 OR EQUIVALENT
26.4% LORUM PERENNE, TETRAPLOID (PERENNIAL RYEGRASS, TETRAPLOID)
21.0% DACTYLIS GLOMERATA, POTOMAC (NORTHGRASS, POTOMAC)
18.9% POA PRATENSIS, GINGER (KENTUCKY BLUEGRASS, GINGER (PASTURE TYPE)
12.0% BROMUS BREBENTENII, FLEET (MEADOW BROME, FLEET)
5.7% TRIFOLIUM HYBRIDUM (ALBISSE CLOVER)
5.0% FESTUCA ELATIOR X LORUM PERENNE, DUO (FESTULOLUM, DUO)
4.8% TRIFOLIUM PRATENSE, MEDIUM, (RED CLOVER, MEDIUM)
2.0% LOTUS CORNICULATUS, LEO (BIRD'S FOOT TREFLOP, LEO)
1.4% CHAMAECRISTA FASCICULATA, (PARTRIDGE PEA,)
1.0% LORUM PERENNE (PERENNIAL BLUE FLAX)
0.9% COREOPSIS LANCEOLATA (LANCELEAF COREOPSIS)
0.5% CHRYSANTHEMUM LEUCANTHEMUM (OXYEY DAISY)
0.4% SOLIDAGO NEMORALIS, (GRAY GOLDENROD)
- SHADE PERIMETER POLLINATOR MIX**
- 1 LB/1000 FT.
ERWAX 132-1
29.0% PANCUM CLAUDESTRIUM, TIOGA (DEERTONGUE, TIOGA)
20.0% LORUM MULTIFLORUM (ANNUAL RYEGRASS)
20.0% LORUM PERENNE (PERENNIAL BLUE FLAX)
15.0% ELYMUS VIRGINICUS, MADISON NY ECOTYPE (VIRGINIA WILDRYE,
15.0% PANCUM VIRGATUM, SHELTER (SWITCHGRASS, SHELTER)
10.0% FESTUCA RUBRA (CREEPING RED FESCUE)
5.0% AGROSTIS PERENNANS, ALBANY PINE (AUTUMN BENTGRASS)
3.0% CAREX VULPINOIDEA, (FOX SEDGE)
3.0% CHAMAECRISTA FASCICULATA, (PARTRIDGE PEA)

TREE PLANTING LEGEND

SYMBOL	SPECIES	QUANTITY	HEIGHT
(Symbol: Circle with a vertical line)	BLACK SPRUCE TREE (PICEA MARIANA)	6	4'-6"
(Symbol: Circle with a horizontal line)	GREY BIRCH TREE (BETULA POPULIFOLIA)	5	4'-6"
(Symbol: Circle with a diagonal line)	WITCH HAZEL TREE (HAMMELIS VIRGINIANA)	5	4'-6"
(Symbol: Circle with a cross)	BOTTLEBRUSH BUCKEYE (AESCULUS PARVIFLORA)	5	4'-6"

- LEGEND**
- (Symbol: Circle with a dot) POLLINATOR MIX
 - (Symbol: Circle with a cross) EROSION CONTROL SEED OVER MIX
 - (Symbol: Circle with a vertical line) POLLINATOR MIX
 - (Symbol: Circle with a horizontal line) NESTING FEATURE FOOD AREA
 - (Symbol: Circle with a diagonal line) POLLINATOR FRIENDLY TURF SERVICE AREA
 - (Symbol: Circle with a cross) SHADE PERIMETER POLLINATOR MIX
 - (Symbol: Circle with a dot) LOW BASIN POLLINATOR MIX
- NOTE:**
PERIMETER HABITAT TREE AND SHRUB PLANTING SPECIFICATIONS PER POLLINATOR PROTECTION SPECIFICATIONS SEE SCHEMATIC PLANT LIST AND SEED SPECIFICATIONS.

BRIAN G. YERGATIAN DATE
PROFESSIONAL ENGINEER

GROUND-MOUNTED PHOTOVOLTAIC SYSTEM

200 HAYNES STREET
IN
STURBRIDGE MASSACHUSETTS (WORCESTER COUNTY)

PLANTING PLAN

AUGUST 1, 2023

REVISIONS:

NO.	DATE	DESC.
1	11/15/23	PER PEER REVIEW
2	01/16/24	PER PEER REVIEW

ISSUED FOR PERMITTING NOT FOR CONSTRUCTION

PREPARED FOR:
STURBRIDGE PV, LLC
2420 17TH STREET
DENVER, CO 80202

BSC GROUP

349 Main Street - Route 28
West Yarmouth, Massachusetts
02673
508 778 8919

© 2022 BSC Group, Inc.
SCALE: 1" = 50'
0 25 50 100 feet

MATERIAL LOCATION	DESCRIPTION	CLASSIFICATION / DENSITY REQUIREMENT	ASPHALT MATERIAL
FINAL FILL MATERIAL FOR LAYERS FROM THE TOP OF THE C-LAYER TO THE BOTTOM OF FLEXIBLE PAVEMENT OR UNPAVED SHOULD BE PLACED AS PART OF THE D LAYER.	ANY SOILWORK MATERIALS, NATIVE SOILS, OR PER ENGINEER'S PLANS.	NO	ASPHALT #5
INITIAL FILL MATERIAL FROM LAYER C STARTS FROM THE TOP OF THE EMBEDED STONE (A LAYER) TO 6" (150 mm) ABOVE THE TOP OF THE CHAMBER THAT PAVEMENT SHOULD BE A PART OF THE C LAYER.	MOST PAVEMENT SUBBASE MATERIALS CAN BE USED IN LIEU OF THIS LAYER.	ASPHALT #5 OR A-1, A-2, A-3 WELL GRADED MATERIAL AND 55% RELATIVE DENSITY FOR PROCESSED AGGREGATE	ASPHALT #5 3.057, 4.497, 5.04, 5.61, 6.17, 6.73, 7.28, 7.83, 8.38, 8.93
EMBEDDED STONE FILL SURROUNDING THE CHAMBERS FROM THE FOUNDATION STONE (A LAYER) TO THE C LAYER.	CLEAN, CRUSHED, ANGULAR STONE	NO COMPACTION REQUIRED.	ASPHALT #5 3.057, 4.497, 5.04, 5.61, 6.17, 6.73, 7.28, 7.83, 8.38, 8.93
FOUNDATION STONE: FILL BELOW CHAMBERS FROM THE FOUNDATION STONE (A LAYER) TO THE BOTTOM OF THE CHAMBER.	CLEAN, CRUSHED, ANGULAR STONE	NO COMPACTION REQUIRED.	ASPHALT #5 3.057, 4.497, 5.04, 5.61, 6.17, 6.73, 7.28, 7.83, 8.38, 8.93

ACCEPTABLE FILL MATERIALS: STORMTECH SC-740 CHAMBER SYSTEMS

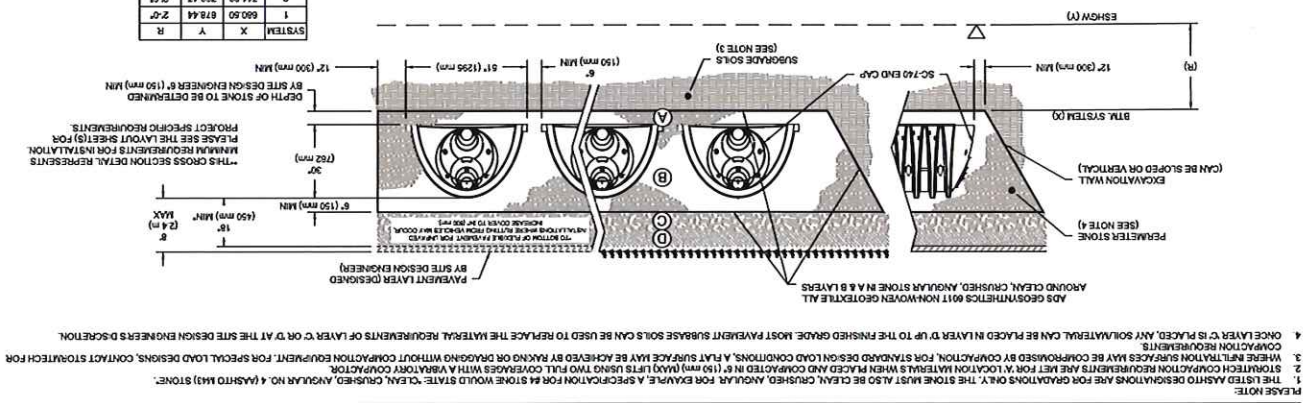

NOTES:

- CHAMBERS SHALL MEET THE REQUIREMENTS OF ASTM #2118. STORMTECH SPECIFICATION FOR POLYPROPYLENE (PP) CORNUATED WALL STORMTECH COLLECTION CHAMBERS.
- SC-740 CHAMBER SHALL BE DESIGNED FOR PROTECTIVE DESIGN OF THE EXCAVATION WALL TO PROTECT THE FOUNDATION STONE WITH CONSIDERATION FOR THE RANGE OF EXPECTED SOIL MOISTURE CONDITIONS.
- REINFORCER STONE MUST BE EXTENDED HORIZONTALLY TO THE EXCAVATION WALL AND SLOPED EXCAVATION WALLS.
- REINFORCER STONE MUST BE EXTENDED HORIZONTALLY TO THE EXCAVATION WALL AND SLOPED EXCAVATION WALLS.
- REINFORCER STONE MUST BE EXTENDED HORIZONTALLY TO THE EXCAVATION WALL AND SLOPED EXCAVATION WALLS.
- REINFORCER STONE MUST BE EXTENDED HORIZONTALLY TO THE EXCAVATION WALL AND SLOPED EXCAVATION WALLS.
- REINFORCER STONE MUST BE EXTENDED HORIZONTALLY TO THE EXCAVATION WALL AND SLOPED EXCAVATION WALLS.
- REINFORCER STONE MUST BE EXTENDED HORIZONTALLY TO THE EXCAVATION WALL AND SLOPED EXCAVATION WALLS.
- REINFORCER STONE MUST BE EXTENDED HORIZONTALLY TO THE EXCAVATION WALL AND SLOPED EXCAVATION WALLS.
- REINFORCER STONE MUST BE EXTENDED HORIZONTALLY TO THE EXCAVATION WALL AND SLOPED EXCAVATION WALLS.

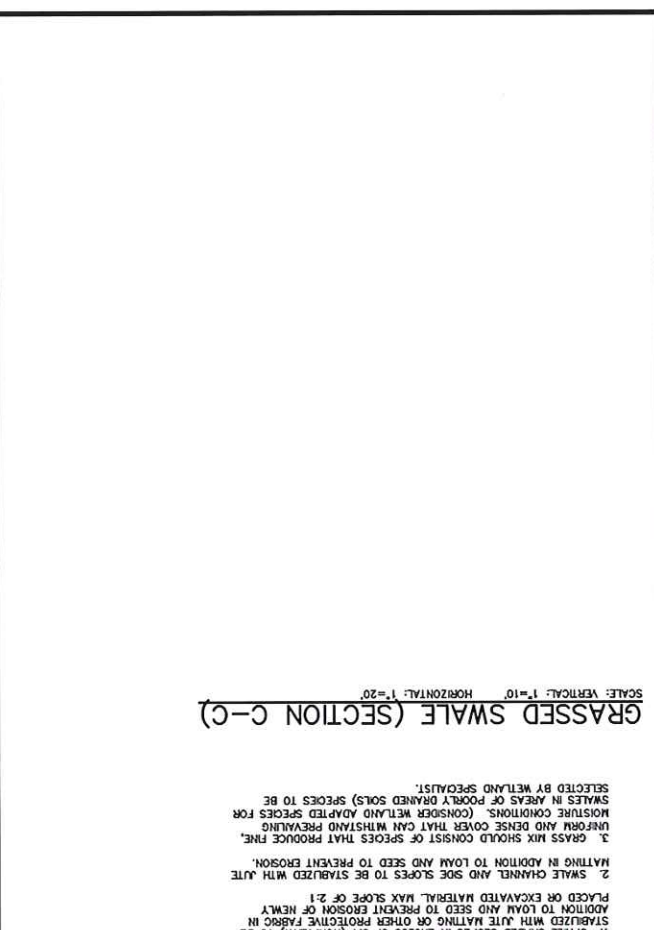
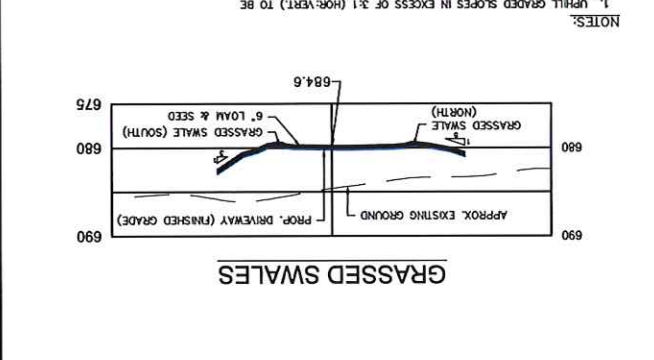
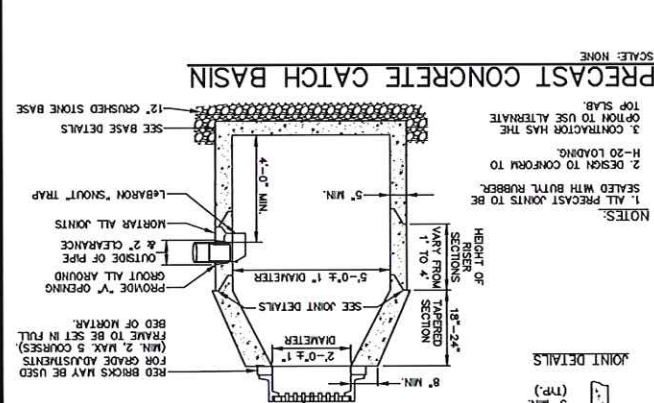
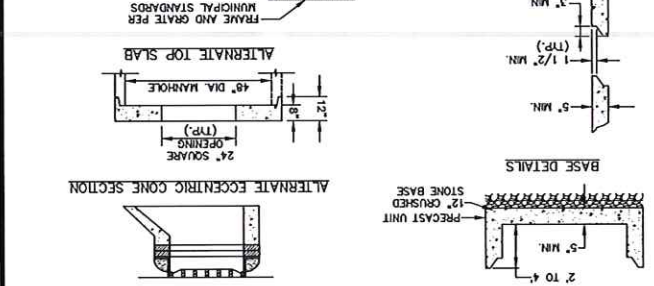
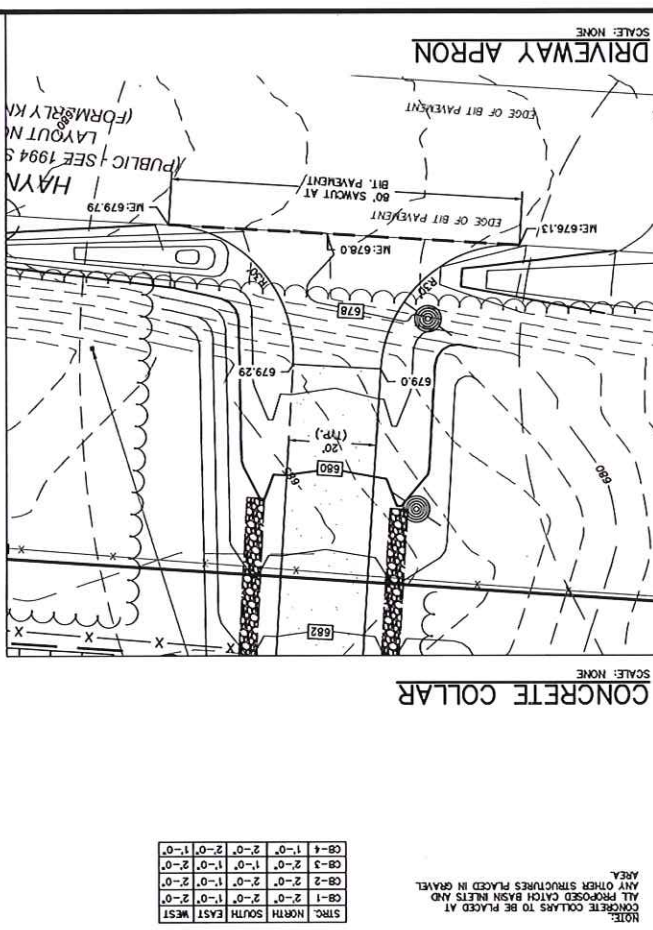
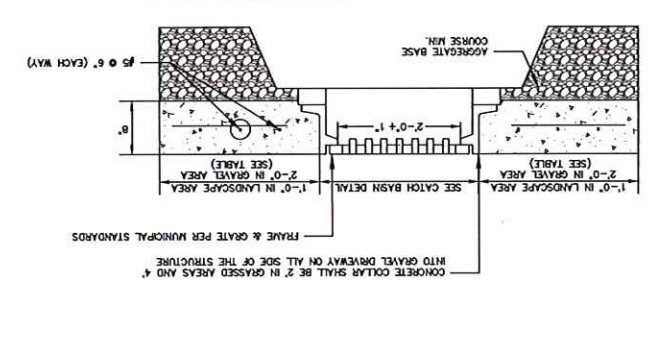
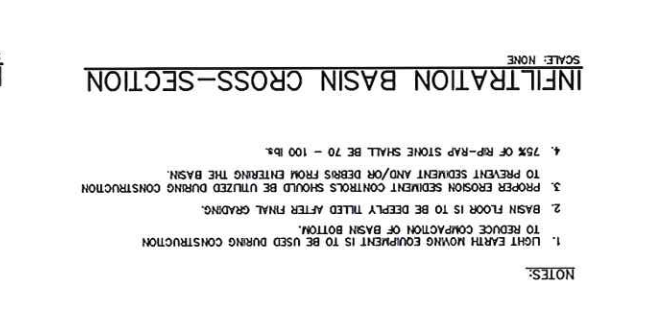
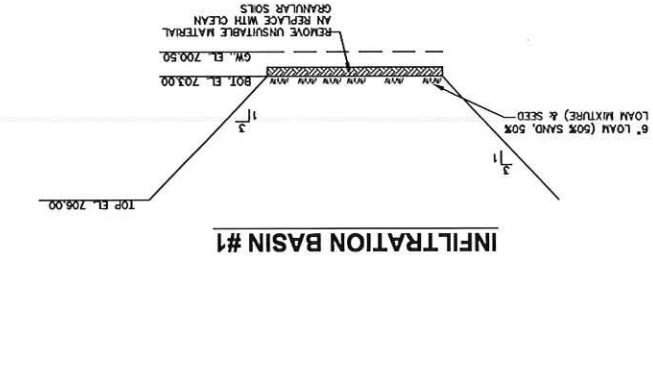
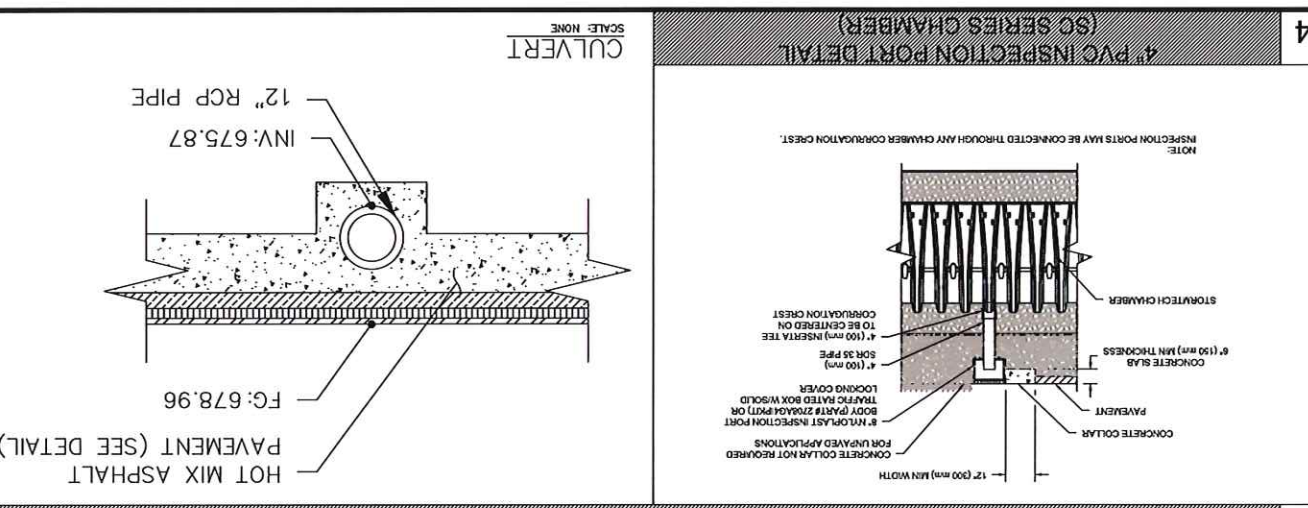
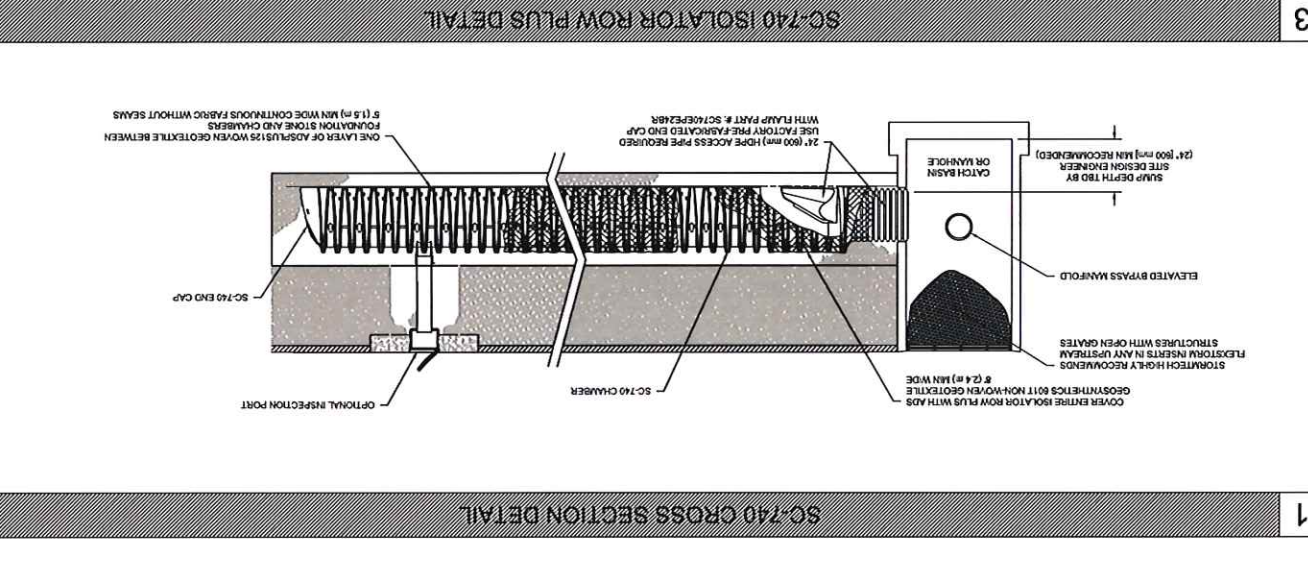

NO.	DATE	DESC.
1	11/15/23	PER PEER REVIEW
2	01/16/24	PER PEER REVIEW

DETAIL SHEET

200 HAYNES STREET

STURBRIDGE

MASSACHUSETTS

IN

PHOTOVOLTAIC

SYSTEM

PROFESSIONAL ENGINEER

BRIAN G. YERGANIAN

DATE

ISSUED FOR PERMITTING

NOT FOR CONSTRUCTION

PREPARED FOR:

STURBRIDGE P.V., LLC

2420 17TH STREET

DENVER, CO 80202

349 Main Street - Route 28

West Yarmouth, Massachusetts

02673

508 778 8919

© 2022 BSC Group, Inc.

SCALE: NOT TO SCALE

DWG: DWG

PROJECTS-YAR\5074500\C\5074500-SP.dwg

SHEET 8 OF 9

JOB NO. 5-0745.00

