



TandoStoneTM
#1 Brand of Composite Stone



Stacked Stone

tandob.com



Glacier Bay



Available Colors

Chestnut Hills



Lewiston Crest



Santa Fe



Sedona Bluff



Glacier Bay

TandoStone - Stacked Stone

features stones with low heights and random lengths for the appearance of a hand-laid, mortarless dry-stack set which gives it a contemporary, sharp edged finish.

How TandoStone stacked up against the competition

Feature / Benefit	Real Stone	Stone Veneer	TandoStone
Aesthetics	◆	◆	◆
Preferred by siding installers			◆
No harmful silica dust			◆
Fast, easy, one-person installation			◆
No breakage / minimal waste			◆
Impervious to moisture issues			◆
Perfect for ground contact & roofline applications			◆
Can be installed in any weather			◆

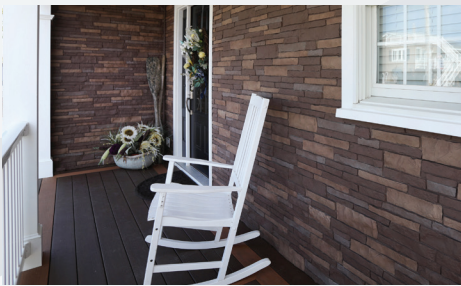
Perfect for:
Single Family

Multi-Family



Commercial

Panel Specifications

Finished Exposure: 39.68" w x 18.25" h
 Exposure: 18.25"
 Panels per box: 10
 Squares per box: ½ (50 sq ft.)

Corner Specifications

Finished Exposure: 6.5" w x 6.5" d x 21" h
 Panels per box: 6
 Linear ft. per box: 9.2

For a **FREE HD Sample**
 visit Tandobp.com



ROOF PANELS

[Home](#) » [Products](#) » [Double-Lok®](#)

CATEGORIES

Double-Lok®

DOUBLE-LOK PANEL

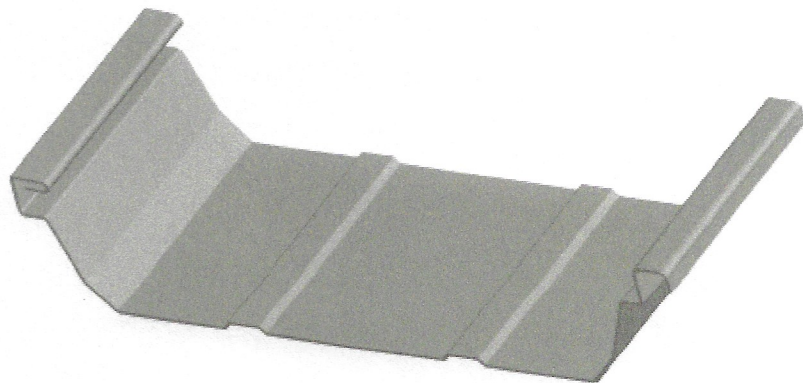

PANEL PROFILE



The Double-Lok® roof panel is a mechanically field-seamed, trapezoidal led standing seam roof system. Double-Lok is available in 18-inch and 24-inch widths Double-Lok requires a minimum slope of 1/4:12. They are ideal for industrial architectural applications.

Let's talk about your project needs!

Contact Us

SPECIFICATION

Applications:	Panel Systems, Roof Systems, Standing Seam Roof Systems
Coverage Width:	18", 24"
Minimum Slope:	¼:12
Panel Attachment:	Concealed Fastening System, Low, High, and a 2" Stand-off Clip
Gauge:	22, 24
Finishes:	Smooth (standard); Embossed (optional)
Coatings:	Galvalume Plus®, Signature® 200, Signature® 300, Signature® 300 Metallic

FEATURES & BENEFITS

Designed to cope with the forces of expansion and contraction. This is accomplished by allowing the panels to flex up and down the roof slope.

THERMOSPAN® 200

INSULATED SECTIONAL STEEL DOORS



PREMIUM THERMAL EFFICIENCY AND LOW MAINTENANCE

Wayne Dalton's Thermospan® 200 provides premium thermal efficiency and low maintenance costs, resulting in a door that costs less to own.

Thermospan® 200 are the only doors in the industry with patented, roll-formed integral struts on each section, making them the most rigid doors available.

- » PREMIUM THERMAL QUALITIES
R-VALUE: 17.50, U-VALUE: 0.057
THERMAL BREAK
- » 2 INTEGRAL STEEL STRUTS PER
SECTION FOR SUPERIOR
STRENGTH AND RIGIDITY
- » STANDARD SIZES UP TO 32'1"
HIGH AND 40'2" WIDE
- » CFC AND HCFC FREE - FULLY
ENCAPSULATED INSULATION

THERMOSPAN® 200

STANDARD FEATURES OVERVIEW

THERMAL EFFICIENCY

R-VALUE*	17.50 (3.09 W/Msq)
U-VALUE*	0.057 (.324 W/Msq)
THERMAL BREAK	Thermoplastic adhesive with rubber seal
AIR INFILTRATION	0.17 cfm/ft2

CONSTRUCTION

SECTION THICKNESS	2" (51 mm)
INTEGRAL STRUTS	Two 1-3/4" struts per section for strength and rigidity
MAX HEIGHT	32'1" (9,779 mm)
MAX WIDTH	40'2" (12,243 mm)
EXTERIOR STEEL	.015" (.35 mm)
INTERIOR PER SECTION	Roll formed with two 1-3/4" integral struts sealed with polypropylene rib caps
STANDARD SPRINGS	10,000 cycle
INTERIOR COLOR	White
EXTERIOR COLOR	White, Tan, Brown

CODES AND ASTM STANDARD CLASS

STC (ASTM E 413)	Class 22
OITC (ASTM E 1332)	Class 19
ASTM E 84	Class A
UBC 17-5	Meets
ASTM D 1929	Flash ignition = 734° F, Self ignition = 950° F

WARRANTY

TERMS	Ten (10) years against cracking, splitting, rust deterioration and delamination. One (1) year against defects in material and workmanship
-------	--

OPTIONS

- Pass door
- Vision lites
- Aluminum full-view sections
- Chain hoist operation
- Motor operation
- Sensing edges
- Photo eyes
- High cycle spring (25k, 50k, 100k)
- 3" Track option
- Solid shafts
- Perimeter weatherseal
- Special track designs
- Mullions

*Wayne Dalton uses a calculated door section R-value and U-value for our insulated doors.

For those who make thermal efficiency, durability and strength a high priority, the Thermospan® 200 is the ideal choice in sectional doors.

Wayne Dalton's Thermospan® 200 features an innovative thermal break that keeps the interior skin at room temperature, preventing condensation and frost to help resist corrosion. Flexible vinyl bulb seal and non-corrosive polymer retainer prevent water and air infiltration at the bottom of the door.

MATERIALS AND CONSTRUCTION

Continuous foamed-in-place polyurethane insulation and a non-conductive thermal break between the inner and outer skins combine to provide an R-value of 17.50 and a U-value of .057.

Features two patented 1-3/4" integral roll-formed struts per section providing the highest strength-to-weight ratio.

Virtually maintenance free due to the hot-dipped galvanized steel that is factory finished with pre-painted primer and baked on finish.

Reinforcement plates are located at all hardware attachment locations. Industry standard commercial-grade, heavy-duty, hardware also contribute to the long service life of Thermospan® 200.

FINISH OPTIONS



White embossed stucco



Tan embossed stucco



Brown embossed stucco



Thermospan® 200 is available with the TruChoice® Color System, Wayne Dalton's custom painting process that offers more than 6,000 colors. See dealer for details.

INSULATED SECTIONAL STEEL DOOR



LITE OPTIONS



Vision lites



Full-view lites

DOOR CONSTRUCTION

Joint seal — prevents air infiltration and saves energy.

Thermal break — separates inner and outer skins so virtually no heat or cold is conducted through section. Prepainted inner and outer skins for added corrosion-resistance.

NOTE: Both skins are also hot-dipped galvanized steel for further protection against corrosion.

Solid polyurethane core — provides maximum thermal efficiency and adds to quiet operation and strength.

Integral struts — Two 1-³/₄" patented, integral roll-formed struts per section increases rigidity and strength.

Two-inch nominal thickness —

Embossed pinstripping (grooves) on Thermospan® 200's embossed stucco outer skin adds strength and enhances appearance.

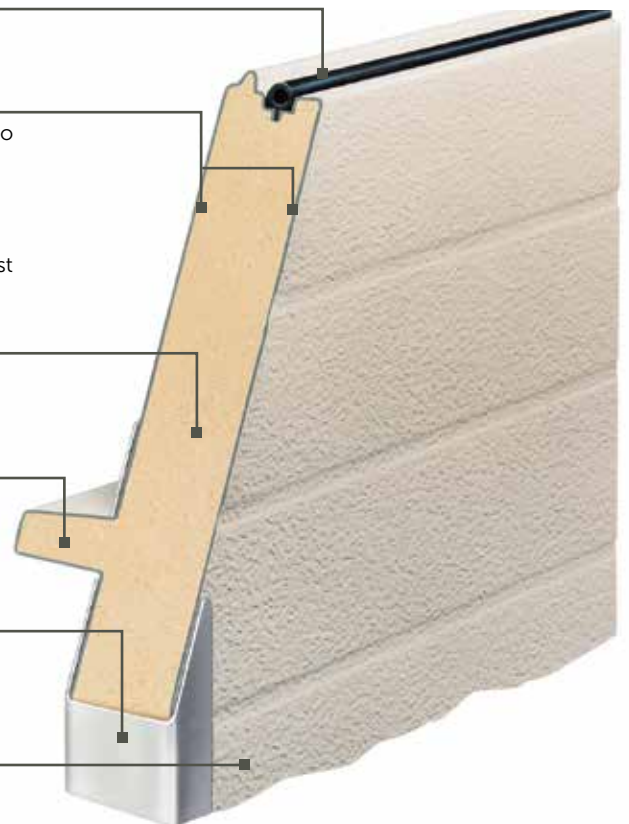

Wind load options available



GENERAL OPERATING CLEARANCES

TYPE	HEADROOM		SIDEROOM		DEPTH INTO ROOM	CENTER LINE OF SPRINGS	
	2" TRACK	3" TRACK	2" TRACK	3" TRACK	2" AND 3" TRACK	2" TRACK	3" TRACK
Standard Lift Manual 12" R	13"-17"	NA	4.5"	5.5"	Opening Height +18"	Opening Height +12"	N/A
Standard Lift Manual 15" R	15"-20"	16"-21"				Opening Height +13"	Opening Height +14"
Standard Lift Motor Oper. 12" R	15"-20"	NA			Opening Height +66"	Opening Height +12"	N/A
Standard Lift Motor Oper. 15" R	15"-20"	18"-24"				Opening Height +13"	Opening Height +14"
High Lift Manual	High Lift +12"		24" One Side		Opening Height -Lift +30"	Opening Height +Lift +6.5"	Opening Height +Lift +7.5"
High Lift Motor Oper.							
Vertical Lift Manual	Door Height +20"		4.5"	5.5"	18"	Double Door Height +13"	
Vertical Lift Motor Oper.			24" One Side				
Low Headroom Manual	6"-15"	6"-15"	6"	9"	Opening Height +20" to -26"	N/A	
Low Headroom Motor Oper.	9"-17"	9"-17"			Opening Height +66"		

PANEL/SECTION SELECTION GUIDE

DOOR WIDTH	NUMBER OF PANELS	NUMBER OF LITES
Up to 9'2"	2	2
9'3" to 12'2"	3	3
12'3" to 16'2"	4	4
16'3" to 19'2"	5	5
19'3" to 24'2"	6	6
24'3" to 28'2"	7	7
28'3" to 32'2"	8	8
32'3" to 33'11"	9	9
34'0" to 36'11"	10	10
37'0" to 38'11"	11	11
39'0" to 40'2"	12	12

DOOR HEIGHT	NUMBER OF SECTIONS
Up to 8'1"	4
8'-8" to 10'1"	5
10'5" to 12'1"	6
12'2" to 14'1"	7
14'2" to 16'1"	8
22'-2" and Up	Call Factory

NOTES:

- 1) Springs must be rear mount to achieve minimum headroom listed. Front mount torsion headroom depends on drum size, and varies over the range listed.
- 2) 8" side-room required, one side, for doors with chain hoist.
- 3) Headroom for standard lift depends on drum size, and varies over the range listed.

TRACK SELECTION GUIDE

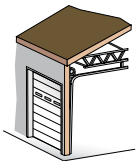

STANDARD LIFT



HIGH LIFT
break-away is standard, straight incline is available

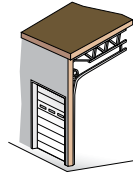

ROOF PITCH
standard or high lift

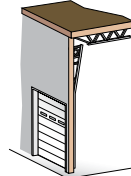

VERTICAL LIFT
break-away is standard, straight incline is available

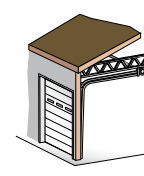

LOW HEADROOM
rear mount torsion

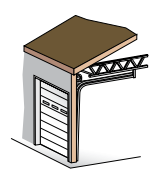

LOW HEADROOM
front mount torsion



Architect Resource Center

Visit wayne-dalton.com/architect-resource-center to find our Architect Resource Center. In this tool, you will quickly find all of the specifications, drawings and documents you need to complete your project.

Wayne Dalton
COMMERCIAL DOORS

DISTRIBUTED BY:

2501 S. State Hwy. 121 Bus., Ste 200
Lewisville, TX 75067

wayne-dalton.com



T14000 Series Storefront

Single cavity pour and debridge thermal barrier

For optimal strength and thermal performance, use Tubelite's 14000 Series Storefront Framing, a flush-glazed system for use on storefront and low-rise applications. Framing is available in standard single cavity pour and debridge thermal barrier members with 2" x 4-1/2" profiles and a 1/2" bite for use with glass or panels up to 1-1/8" thick. Extra-heavy intermediate verticals are available for high performance against strong windloads.

Reduce project labor costs with the flexibility of inside or outside glazing. Members can be assembled using screw spline or clip joinery, and framing is compatible with Tubelite Narrow, Medium and Wide Stile Doors.

Our 14000 Series Storefront products are subjected to thorough testing by an independent laboratory, ensuring that you get the highest quality storefront framing products that the industry has to offer.

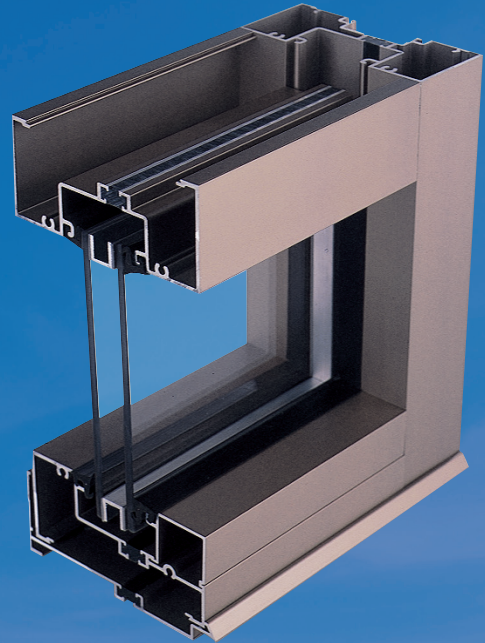

Standard Medium Stile Entrances



200 Series Curtainwall

Wendy's, Cemetery Road, Hilliard, OH

ALSO USED WITH

TUBELITE[®]
DEPENDABLE

LEADERS IN ECO-EFFICIENT STOREFRONT, CURTAINWALL AND ENTRANCE SYSTEMS

T14000 Series Storefront

Single cavity pour and debridge thermal barrier

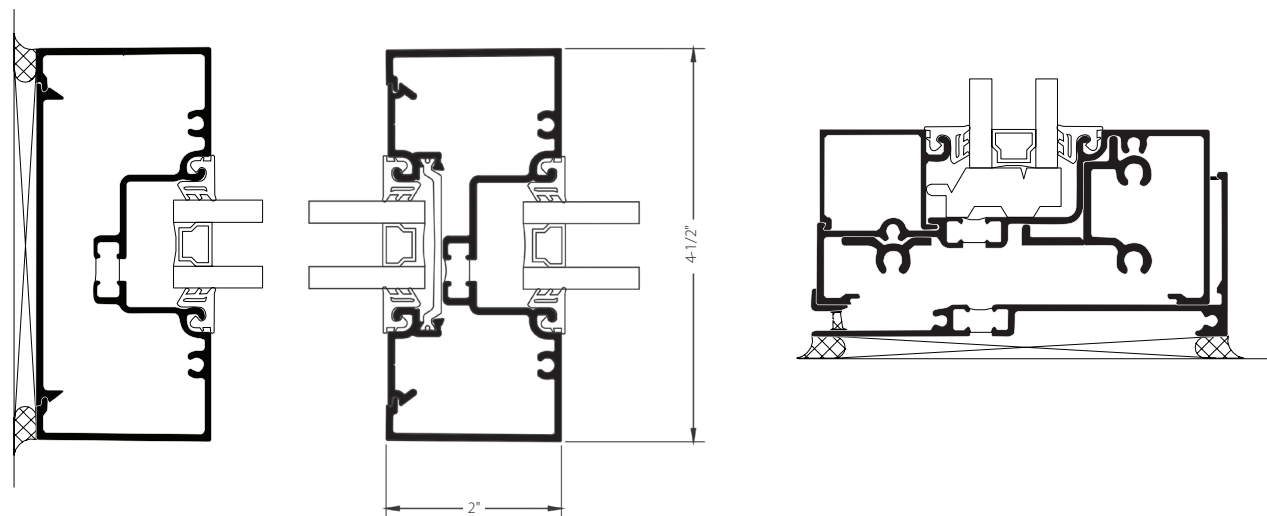

System Features:

- Standard 2" (50.8mm) sight-line on verticals and horizontals
- 4-1/2" (114.3mm) system depth
- Single cavity pour and debridge thermal barrier with Azon's Lancer® mechanical lock
- EPDM wedge type gaskets for 1" glass or panel thickness
- Glass centered in the system depth

Optional Features:

- Screw-spline or shear block connections
- Steel reinforcing if required
- Easily integrates with standard or thermal doors, operable vent windows & sun shades
- A wide variety of standard anodized and painted colors are available to complement any project with warranted protection, as well as street appeal.
- Curved Headers
- Non-thermal Framing

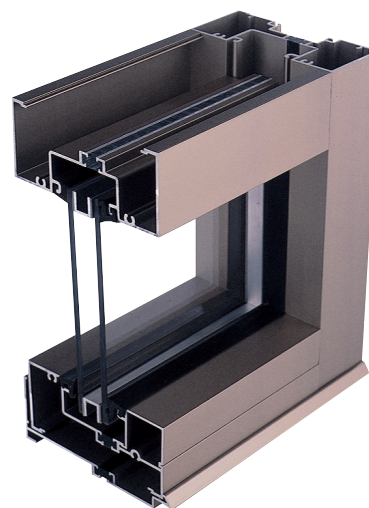

T14000 Series Product Specifications

Application: Low-rise commercial buildings: retail, office, healthcare, schools, etc.

Description: 2" x 4-1/2" center set, outside or inside flush glazed storefront

Face Width:	System Depth:	Glass:	Air Infiltration:	Water Infiltration:	Structural:	CRF:	U-Factor**:	Acoustic:
2"	4-1/2"	1" std (1/8" - 1-1/8")	0.06 CFM/Ft.2 @ 6.24 PSF	10 PSF - Static 10 PSF - Dynamic	30 PSF - Design 45 PSF - Overload	T (Thermal) 62 _f 68 _g	0.38 - Thermally Insulated 0.33 - Thermally Broken	STC 32 OITC 26

** U-Factor per NFRC 100: COG = 0.24 with warm edge spacer, 1-3/4" x 4-1/2" non-thermal frame.

Refer to the U-Value table at: www.tubeliteinc.com/products/storefront/14000-series-storefront-framing/ for other glass makeups and configurations.

DISCLAIMER: Tubelite takes no responsibility for product selection or application, including, but not limited to, compliance with building codes, safety codes, laws, merchantability or fitness for a particular purpose; and further disclaims all liability for the use, in whole or in part, of this Technical Guide in preparation of project specifications and/or other documents. Technical Guides are subject to change at any time, without notice, and at Tubelite's sole discretion. ©2017 Tubelite Inc.

080720

T14000 STOREFRONT

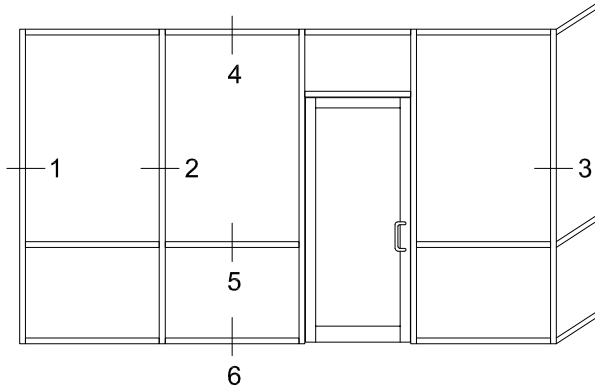

Tubelite reserves the right to change system configuration without prior notice when deemed necessary for product improvements.

Laws and building & safety codes governing the design and use of glazed entrance, window and curtain wall systems vary widely. Tubelite does not control the selection of product configurations, operating hardware or glazing materials, and assumes no responsibility thereof.

Standard Outside Glazed Details

1/4 scale

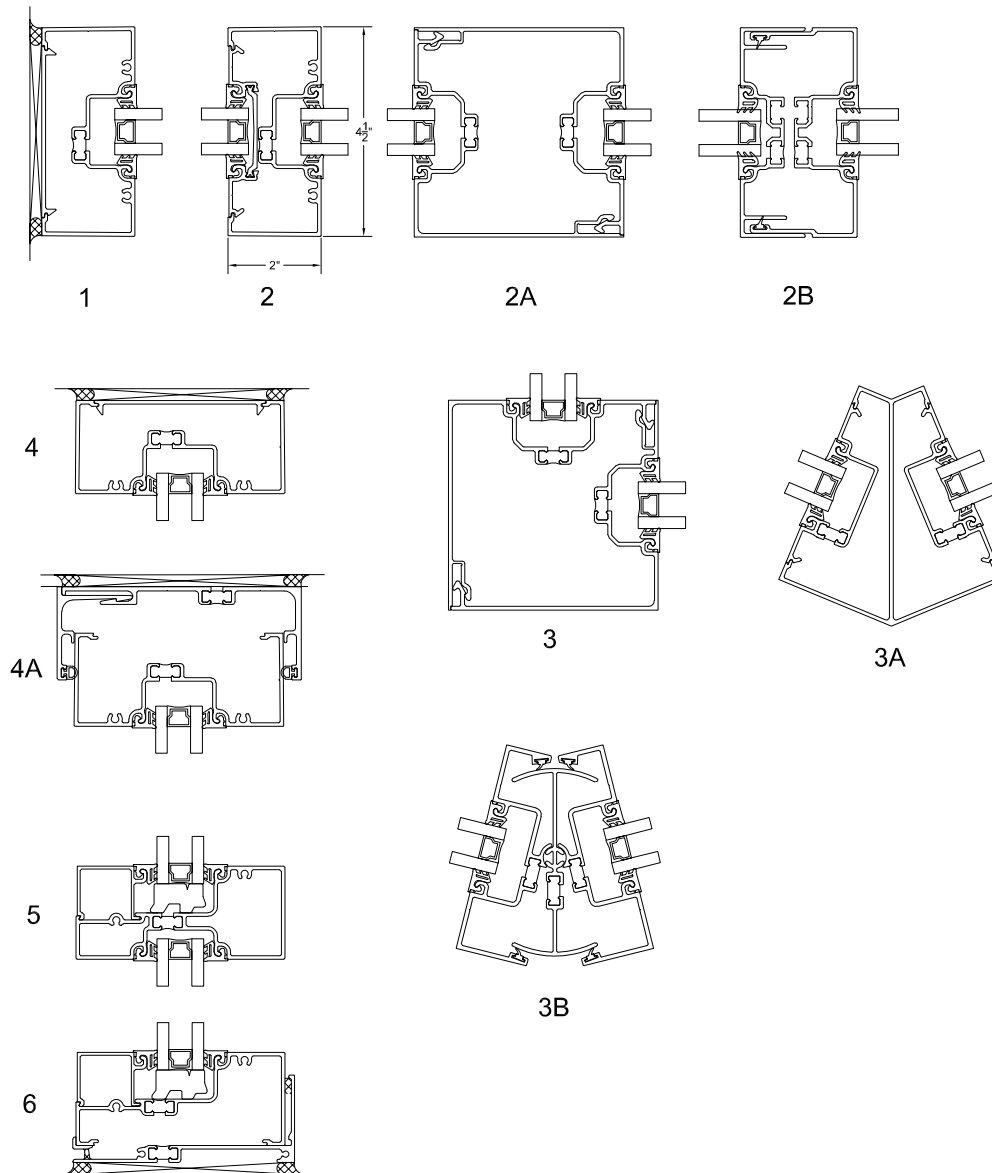

TUBELITE®
 DEPENDABLE
 LEADERS IN ECO-EFFICIENT STOREFRONT,
 CURTAINWALL AND ENTRANCE SYSTEMS

June 2020

For specific product applications, contact your Tubelite representative.

Details on this page represent standard details found on our website.

For more options, visit our website at

www.tubeliteinc.com/14000-series-storefront-framing/

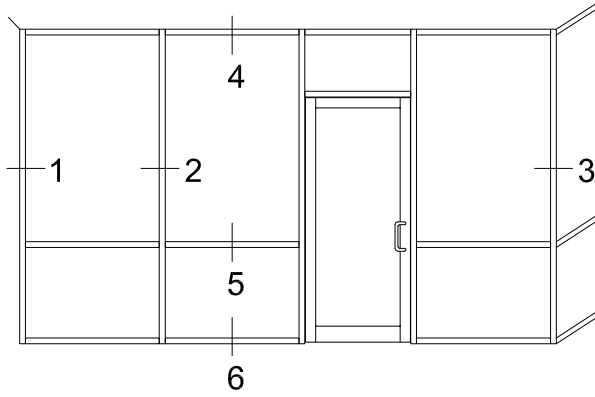

Tubelite reserves the right to change system configuration without prior notice when deemed necessary for product improvements.

Laws and building & safety codes governing the design and use of glazed entrance, window and curtain wall systems vary widely. Tubelite does not control the selection of product configurations, operating hardware or glazing materials, and assumes no responsibility thereof.

Standard Inside Glazed Details
1/4 scale

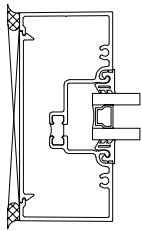

1

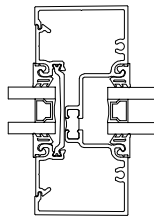

2

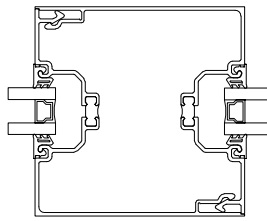

2A

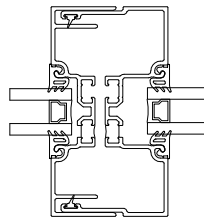

2B

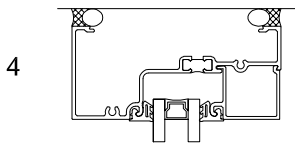

4

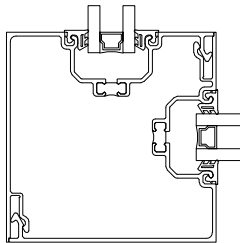

3

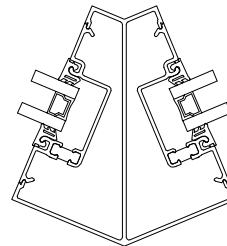

3A

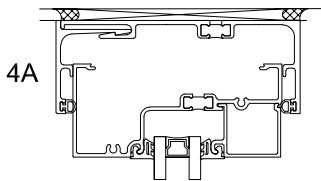

4A

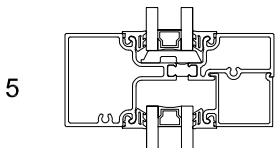

5

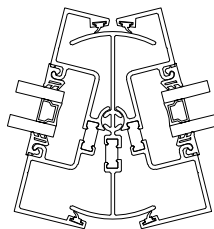

3B

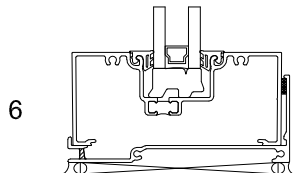

6

TUBELITE®
DEPENDABLE
LEADERS IN ECO-EFFICIENT STOREFRONT,
CURTAINWALL AND ENTRANCE SYSTEMS

June 2020

For specific product applications, contact your Tubelite representative.

Details on this page represent standard details found on our website.

For more options, visit our website at

www.tubeliteinc.com/14000-series-storefront-framing/

T14000 STOREFRONT

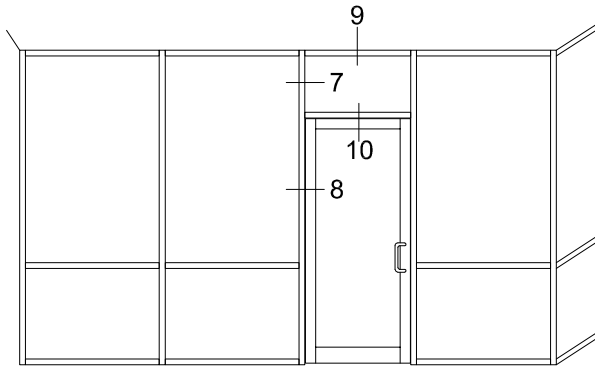

Tubelite reserves the right to change system configuration without prior notice when deemed necessary for product improvements.

Laws and building & safety codes governing the design and use of glazed entrance, window and curtain wall systems vary widely. Tubelite does not control the selection of product configurations, operating hardware or glazing materials, and assumes no responsibility thereof.

Standard Details 1/4 scale

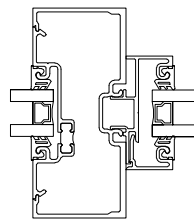

7

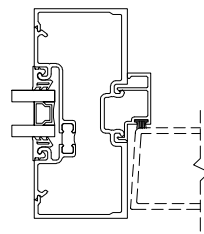

8

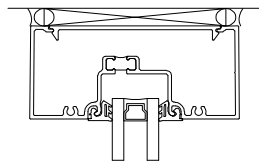

9

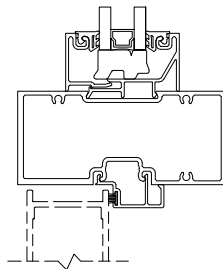

10

June 2020

TUBELITE[®]
DEPENDABLE
LEADERS IN ECO-EFFICIENT STOREFRONT,
CURTAINWALL AND ENTRANCE SYSTEMS

For specific product applications, contact your Tubelite representative.

Details on this page represent standard details found on our website.

For more options, visit our website at

www.tubeliteinc.com/14000-series-storefront-framing/



WALL PANELS

[Home](#) » [Products](#) » [AVP Wall Panel](#)

CATEGORIES

AVP Wall Panel

The AVP panel is used for wall application and features pencil ribs, providing improved aesthetics to the building design.

AVP WALL PANEL

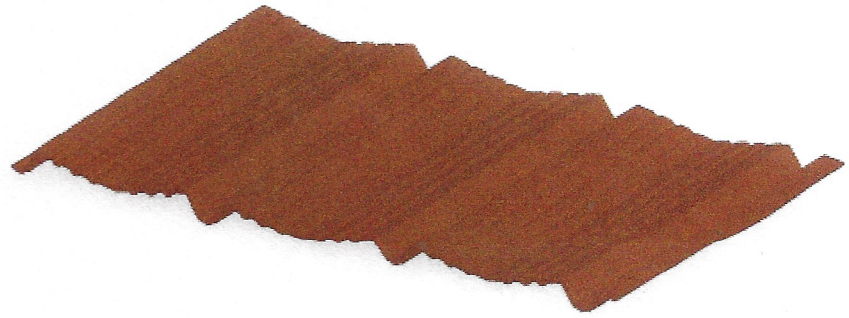

PANEL PROFILE

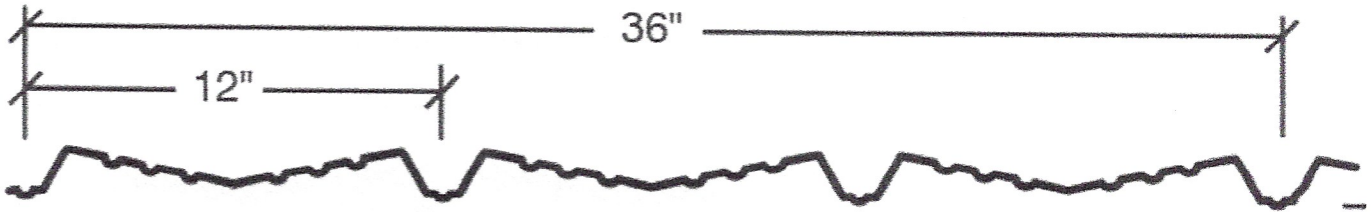

Let's talk about your project needs!

Contact Us

SPECIFICATION

Applications:

Panel Systems, Wall Systems, Exposed Fastening Systems

Gauge:	26 (standard); 22, 24, 29 (optional)
Finishes:	Smooth (standard); Embossed (optional)
Coatings:	Galvalume Plus®, Signature® 200, Signature® 300
Rib Spacing:	12" on Center
Rib Height:	1 1/8"

FEATURES & BENEFITS

The AVP panel allows for more insulation to be added behind the panel, providing greater insulating values that codes and R-Value requirements.

UL 263 internal fire rating is available.

Browse Our Project Portfolio

[View Gallery](#)

[Contact Us](#) [Careers](#) [Privacy](#) [Legal](#)

