

FORM B – BUILDING

MASSACHUSETTS HISTORICAL COMMISSION
MASSACHUSETTS ARCHIVES BUILDING
220 MORRISSEY BOULEVARD
BOSTON, MASSACHUSETTS 02125

Assessor's Number USGS Quad Area(s) Form Number

415-02433-473

Southbridge

STU.C

STU.115
STU.329

Town/City: Sturbridge

Place: (*neighborhood or village*): Snellville

Photograph



Photo 1. 473 Main Street, looking southeast.

Locus Map

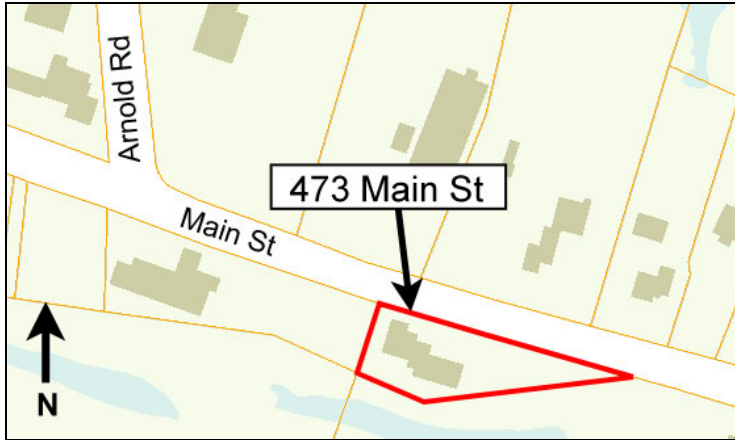

Recorded by: L. Kline, G. Pineo, E. Giacomarra; PAL

Organization: Sturbridge Historical Commission

Date (*month / year*): May 2018

Address: 473 Main Street

Historic Name: John and Lizzie Hooker House and Barn

Uses: Present: Single Family Dwelling; Doctor Office

Original: Single Family Dwelling

Date of Construction: ca. 1887

Source: WCRD 1660/119 (1887)

Style/Form: Queen Anne

Architect/Builder: Unknown

Exterior Material:

Foundation: Stone

Wall/Trim: Wood Clapboard/ Wood Trim

Roof: Slate Shingle

Outbuildings/Secondary Structures: Attached Barn

Major Alterations (*with dates*): barn altered and enlarged with modern vertical-lift garage doors, late 20th c.; entrance ramp added, early 21st c.

Condition: Good

Moved: no yes **Date:**

Acreage: .36 acre

Setting: The building occupies an irregularly shaped lot on the south side of Main Street in a mixed-use area in Snellville. A dirt driveway and parking lot are in front of the barn.

INVENTORY FORM B CONTINUATION SHEET

MASSACHUSETTS HISTORICAL COMMISSION
220 MORRISSEY BOULEVARD, BOSTON, MASSACHUSETTS 02125

STURBRIDGE

473 MAIN STREET

Area(s) Form No.

STU.C

STU.115
STU.329

Recommended for listing in the National Register of Historic Places.

If checked, you must attach a completed National Register Criteria Statement form.

ARCHITECTURAL DESCRIPTION

The John and Lizzie Hooker House (ca. 1887, STU.115) is a north-facing, Queen Anne-style, one-and-one-half-story, three-bay-by-two-bay, wood-frame building with an attached Barn (ca. 1887, STU.329) on the east side of the house connected by a one-story ell. The house has a side-gable roof and a stone foundation. A brick chimney pierces the south slope of the roof near the ridge line, and two gable wall dormers with molded wood panels in their gable peaks are on the north (facade) elevation. The barn has a cross-gable roof. The walls are clad in wood clapboard, and the roofs are covered with slate shingles. A bay window with pairs of carved brackets beneath the eaves fills the west bay of the facade, and an octagonal window opening is in the east bay of the ell. Carved brackets support the corners of the roof of the main block, and the gable eaves are ornamented with sawtooth vergeboards. A hip-roof entrance porch with a bracketed cornice spans the east bay of the north elevation. The roof is supported by carved posts and brackets. It shelters two entrances, one with half-light, double doors and the other with a nine-light modern door. An ADA-accessible ramp with wood railings switches back from the porch to a concrete path leading to the driveway and parking area. The ell has a flat-roof, engaged porch in the west bays that is supported by posts and brackets matching the main porch and shelters a nine-light, paneled modern door. The barn has two modern overhead garage doors and a hayloft door filled with diagonal vertical boards. Above the hayloft door in the gable peak is an arched window opening in a rectangular wood surround filled with two-over-two wood sash. Fenestration throughout the house consists of two-over-two, double-hung wood sash.

The John and Lizzie Hooker House and Barn is a well-preserved example of a house and barn complex constructed in the Queen Anne style in Sturbridge.

HISTORICAL NARRATIVE

The John and Lizzie Hooker House and Barn (ca. 1887, STU.115 and STU.329) is in the west part of the village of Snellville in Sturbridge. Sturbridge was settled ca. 1725 by residents of Medfield and was incorporated as a town in 1738 (MHC 1984:3–4).

In 1884, John A. Hooker (1848–1916), a machinist in the Snell auger shop, married Elizabeth (Lizzie) Snell (1848–1933), the daughter of his employer Lucius Snell, in what was the second marriage for both (Ancestry.com 2011, 2013). Three years later, in 1887, Lucinda Snell gave her daughter a building lot immediately east of the Snell's own house (the Lucius Snell House, 479 Main St. (STU.114) (WCRD 1660/119).¹ The property appears on the 1892 Bailey and 1898 Richards map as a house with ell, a wide porch along the north elevations of both, and a barn (O.H. Bailey 1892; Richards 1898). John and Elizabeth Hooker had three children: Myron, Florence, and Chester (US Census 1900).

In 1917, Lizzie, by that time a widow, sold her property to Edith S. Parker (b. 1889), wife of Charles M. Parker (b. 1884) (WCRD 2146/281). Charles owned Parker Brothers, an apple orchard in Fiskdale, with his brother Theodore (Manning 1949; US Census 1940). The Parkers owned the subject property until 1964, when Charles Parker sold it to Dean Stickney, who may have been Edith's nephew (WCRD 4488/373). Stickney owned a general contracting business in Fiskdale with William Smith (Polk 1965). The Stickneys owned the subject property until 2006, when Dean's wife, Judith Stickney, sold it to the current owner, Dr. Amarjeet Singh Gill (WCRD 39870/17). Dr. Gill operates an optometry office out of the building.

BIBLIOGRAPHY and/or REFERENCES

¹ Previous documentation indicated that the subject property was built for Marvin Hooker ca. 1860; however, directory and census research indicates that no one by that name resided in Sturbridge (Holley 1973). Additionally, the Queen Anne style did not gain popularity in the United States until at least 1880 (McAlester 2013:345).

INVENTORY FORM B CONTINUATION SHEET

MASSACHUSETTS HISTORICAL COMMISSION

220 MORRISSEY BOULEVARD, BOSTON, MASSACHUSETTS 02125

STURBRIDGE

473 MAIN STREET

Area(s) Form No.

STU.C

STU.115
STU.329

Ancestry.com. *Massachusetts, Town and Vital Records, 1620–1988*. Provo, UT: Ancestry.com Operations, Inc., 2011.
_____. *Massachusetts, Marriage Records, 1840–1915*. Provo, UT: Ancestry.com Operations Inc., 2013.
Manning, H.A. *Manning's Southbridge and Sturbridge Massachusetts Directory*. H.A. Springfield, MA: Manning Company, 1949.
Massachusetts Historical Commission (MHC). *MHC Reconnaissance Survey Town Report – Sturbridge*. On file, Massachusetts Historical Commission, Boston, MA, 1984.
McAlester, Virginia. *A Field Guide to American Houses*. New York: Alfred A. Knopf, 2013.
O.H. Bailey & Co. *Sturbridge and Fiskdale*. Boston: O.H. Bailey & Co., 1892.
R.L. Polk & Co. *Polk's Southbridge City Directory, 1965*. Boston: R.L. Polk & Co.
United States Bureau of the Census (US Census). *Twelfth Census of the United States, 1900*. (T623, 1,854 rolls). National Archives and Records Administration, Washington, D.C., ancestry.com database.
_____. *Sixteenth Census of the United States, 1940*. (T627, 4,643 rolls). National Archives and Records Administration Washington, D.C., ancestry.com database.
Worcester County Registry of Deeds (WCRD). Book/Page (Year). 1660/119 (1887), 2146/281 (1917), 4488/373 (1964).

HISTORIC IMAGES

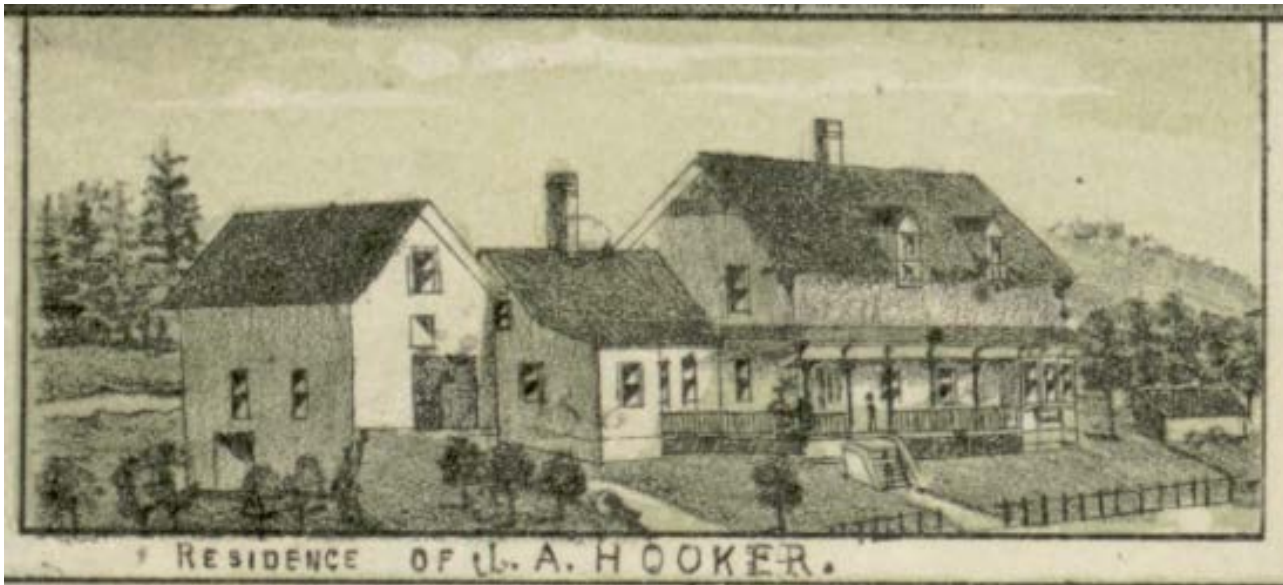

Drawing of John A. and Lizzie Hooker House (Bailey 1892).

INVENTORY FORM B CONTINUATION SHEET

MASSACHUSETTS HISTORICAL COMMISSION
220 MORRISSEY BOULEVARD, BOSTON, MASSACHUSETTS 02125

STURBRIDGE

473 MAIN STREET

Area(s) Form No.

STU.C

STU.115
STU.329

National Register of Historic Places Criteria Statement Form

Check all that apply:

- Individually eligible Eligible **only** in a historic district
- Contributing to a potential historic district Potential historic district

Criteria: **A** **B** **C** **D**

Criteria Considerations: **A** **B** **C** **D** **E** **F** **G**

Statement of Significance by Gretchen M. Pineo and Laura J. Kline, PAL, October 2018

The John and Lizzie Hooker House and Barn are eligible for listing in the National Register of Historic Places at the local level under Criterion A and C. Under Criterion A, the property is eligible in the area of Community Planning and Development for its association with the late nineteenth-century residential development of the Snellville area. Under Criterion C, the property is eligible in the area of Architecture as an intact example of a Queen Anne-style house in Sturbridge.