

FORM B – BUILDING

MASSACHUSETTS HISTORICAL COMMISSION
MASSACHUSETTS ARCHIVES BUILDING
220 MORRISSEY BOULEVARD
BOSTON, MASSACHUSETTS 02125

Assessor's Number USGS Quad Area(s) Form Number

415-02434-468

Southbridge

STU.C

STU.110,
STU.330

Town/City: Sturbridge

Place: (*neighborhood or village*): Snellville

Photograph



Address: 468 Main Street

Historic Name: Martin L. Phillips House and Barn

Uses: Present: Multiple Family Dwelling

Original: Single Family Dwelling

Date of Construction: ca.1900

Source: Holley 1973

Style/Form: Queen Anne

Architect/Builder: Unknown

Exterior Material:

Foundation: Brick

Wall/Trim: Wood Clapboard/ Wood Trim

Roof: Slate Shingle

Outbuildings/Secondary Structures: Barn

Major Alterations (*with dates*): None

Condition: Good

Moved: no yes **Date:**

Acreage: .67 acre

Setting: The building occupies a rectangular lot on the north side of Main Street in the village of Snellville. It is set back from the street and has a paved driveway on the west side.

Locus Map

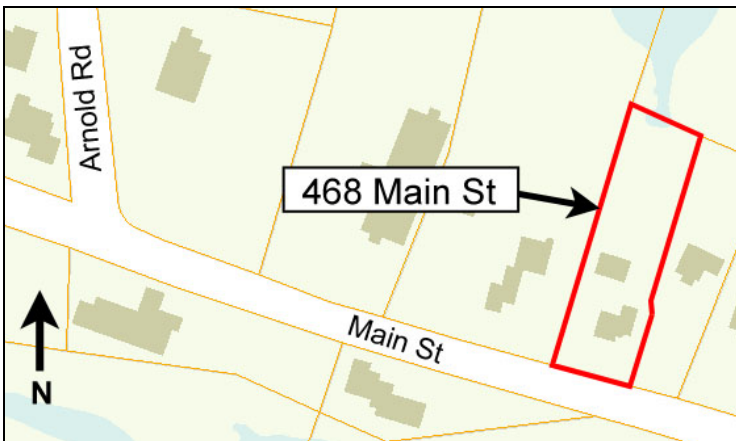

Recorded by: L. Kline, G. Pineo, E. Giacomarra; PAL

Organization: Sturbridge Historical Commission

Date (*month / year*): May 2018

INVENTORY FORM B CONTINUATION SHEET

MASSACHUSETTS HISTORICAL COMMISSION

220 MORRISSEY BOULEVARD, BOSTON, MASSACHUSETTS 02125

STURBRIDGE

468 MAIN STREET

Area(s) Form No.

STU.C

STU.110,
STU.330

Recommended for listing in the National Register of Historic Places.

If checked, you must attach a completed National Register Criteria Statement form.

ARCHITECTURAL DESCRIPTION

The Martin L. Phillips House (ca. 1900, STU.110) is a south-facing, restrained Queen Anne-style, two-and-one-half-story, three-bay side-hall, wood-frame house with a two-story ell extending from the east elevation. The house has a cross-gable roof and a brick foundation. The walls are clad with wood clapboards, and the roof is covered with slate shingles. The roof is pierced by brick chimneys in the center ridgeline of the main block and ell. A flat-roof porch supported by carved wood posts and brackets spans the first story of the south (facade) elevation and shelters the entrance in the east bay. The entrance consists of a four-panel wood door protected by a half-light storm door. A gable-roof entrance porch shelters a secondary entrance in the center of the ell's south elevation. A two-story, hip-roof, enclosed porch extends from the ell's east elevation. Fenestration consists of original two-over-one, double-hung wood sash in the house and ell and one-over-one, two-over-two, and six-over-one, double-hung wood sash in the enclosed porch.

The Martin L. Phillips Barn (ca. 1900, STU.330) is northeast of the house and accessed via a driveway. It is a rectangular, side-gable, astylistic, wood-frame building on a dry-laid stone foundation. The walls are clad with vertical board siding, and the roof is covered with slate shingles. A modern vertical-lift door is in the center of the south elevation with a hayloft door filled with vertical boards above it.

The house is a well-preserved example of a three-bay, side-hall plan, Queen Anne-style building in Sturbridge.

HISTORICAL NARRATIVE

The Martin L. Phillips House (ca. 1900, STU.110) is at the west edge of the village of Snellville in the town of Sturbridge. Sturbridge was settled ca. 1725 by residents of Medfield and was incorporated as a town in 1738 (MHC 1984:3–4).

The Phillips house is believed to have been constructed ca. 1900 on the foundation of an earlier building that burned (Holley 1973). In 1890, the property, which had belonged to Elisha M. Phillips (no direct relation to Martin), was sold at public auction by Arthur Bemis, the executor of Elisha's will. The highest bidders were Daniel Wight and John Hooker, who sold the property the following year (1891) to Susan Stone Phillips (1846–1903), wife of farmer Martin Luther Phillips (1843–1915). Martin Phillips was born in North Easton and was living in Sturbridge in 1865 when he married Susan Stone, also of Sturbridge (WCRD 1330/445, 1345/220; Find A Grave 2013a). In 1903, Susan Phillips transferred the property to her daughter Eva Stone, who in turn transferred it the same day to her father, Martin Phillips (WCRD 1761/140, 1761/141).

In 1910, Eva and her husband William lived at the property with their son Clarence and daughter-in-law Grace. Clarence worked as a filer at the nearby auger shop (US Census 1910). In 1931, Grace, by then a widow, transferred the property to her oldest daughter, Charlotte, on behalf of herself and her three other children, Laura, Clarence, and Lillian Stone (WCRD 2549/439; US Census 1930). Charlotte then transferred the property back to her mother (WCRD 2549/439). In 1939, half the property was transferred to Charlotte and her husband Ellis Smith Jr. (WCRD 2751/97). Charlotte worked as a transcriber at the American Optical Company, and her husband was a grinder in a cutlery shop (US Census 1940). The property remains in the Smith family, transferring from Charlotte to her son Ellis Smith III and daughter Eleanor van Norman (WCRD 19258/260).

BIBLIOGRAPHY and/or REFERENCES

- Find a Grave. "Martin Luther Phillips," 2013a, <https://www.findagrave.com/memorial/105577303>, accessed February 2018.
_____. "Grace Lillian George Stone," 2013b, <https://www.findagrave.com/memorial/106008986>, accessed February 2018.
_____. "Ellis Eugene Smith, Jr.," 2013c, <https://www.findagrave.com/memorial/106008986>, accessed February 2018.

INVENTORY FORM B CONTINUATION SHEET

MASSACHUSETTS HISTORICAL COMMISSION

220 MORRISSEY BOULEVARD, BOSTON, MASSACHUSETTS 02125

STURBRIDGE

468 MAIN STREET

Area(s) Form No.

STU.C

STU.110,
STU.330

Holley, Helen G. *Massachusetts Historical Commission Building Form B – Marvin Phillips House (STU.110)*. On file, Massachusetts Historical Commission, Boston, MA, 1973.

Massachusetts Historical Commission (MHC). *MHC Reconnaissance Survey Town Report – Sturbridge*. On file, Massachusetts Historical Commission, Boston, MA, 1984.

United States Bureau of the Census (US Census). *Thirteenth Census of the United States, 1910*. (T624, 1178 rolls). National Archives and Records Administration, Washington, D.C., ancestry.com database.

_____. *Fourteenth Census of the United States, 1920*. (T625, 2076 rolls). National Archives and Records Administration, Washington, D.C., ancestry.com database.

_____. *Fifteenth Census of the United States, 1930*. (T626, 2,667 rolls). National Archives and Records Administration, Washington, D.C., ancestry.com database.

_____. *Sixteenth Census of the United States, 1940*. (T627, 4,643 rolls). National Archives and Records Administration, Washington, D.C., ancestry.com database.

Worcester County Registry of Deeds (WCRD). Book/Page (Year). 1330/445 (1890), 1345/220 (1891), 1761/140 (1903), 1761/141 (1903), 2549/439 (1931), 2751/97 (1939), 19258/260 (1997).

PHOTOGRAPH



Photo 2.468 Main Street, looking northwest.

INVENTORY FORM B CONTINUATION SHEET

MASSACHUSETTS HISTORICAL COMMISSION
220 MORRISSEY BOULEVARD, BOSTON, MASSACHUSETTS 02125

STURBRIDGE

468 MAIN STREET

Area(s) Form No.

STU.C

STU.110,
STU.330

National Register of Historic Places Criteria Statement Form

Check all that apply:

- Individually eligible Eligible **only** in a historic district
- Contributing to a potential historic district Potential historic district

Criteria: **A** **B** **C** **D**

Criteria Considerations: **A** **B** **C** **D** **E** **F** **G**

Statement of Significance by Gretchen M. Pineo and Laura J. Kline, PAL, October 2018

The Martin L. Phillips House and Barn are eligible for listing in the National Register of Historic Places at the local level under Criterion A and C. Under Criterion A, the property is eligible in the area of Community Planning and Development for its association with the late nineteenth-century residential development of the Snellville area. Under Criterion C, the property is eligible in the area of Architecture as an intact example of a three-bay, side-hall plan, Queen Anne-style house in Sturbridge.