

FORM B – BUILDING

MASSACHUSETTS HISTORICAL COMMISSION
MASSACHUSETTS ARCHIVES BUILDING
220 MORRISSEY BOULEVARD
BOSTON, MASSACHUSETTS 02125

Assessor's Number USGS Quad Area(s) Form Number

415-02457-407

Southbridge

STU.C

STU.124
STU.332

Town/City: Sturbridge

Place: (*neighborhood or village*): Snellville

Photograph



Address: 407 Main Street

Historic Name: George E. Richards House and Barn

Uses: Present: Restaurant

Original: Single Family Dwelling; Hotel or Inn

Date of Construction: ca. 1874

Source: WCRD 936/413; marriage date; visual inspection

Style/Form: Italianate

Architect/Builder: possibly George E. Richards

Exterior Material:

Foundation: Stone

Wall/Trim: Wood Clapboard/ Wood trim

Roof: Asphalt shingle

Outbuildings/Secondary Structures: Barn (1892)

Major Alterations (*with dates*): addition built and barn renovated, 1987; deck built, 1997; vinyl windows, late 20th century

Condition: Good

Moved: no yes **Date:**

Acreage: 1.71 acres

Setting: The building occupies a triangular-shaped lot on the south side of Main Street. It is set slightly back from the street in a mixed-use area in Snellville.

Locus Map

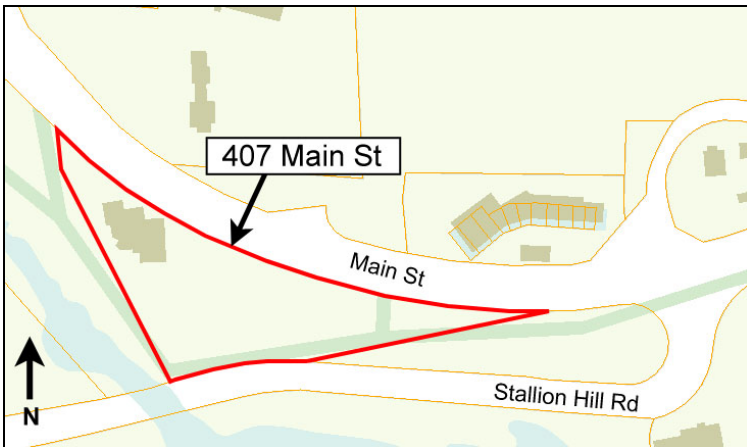

Recorded by: L. Kline, G. Pineo, E. Giacomarra; PAL

Organization: Sturbridge Historical Commission

Date (*month / year*): May 2018

INVENTORY FORM B CONTINUATION SHEET

MASSACHUSETTS HISTORICAL COMMISSION

220 MORRISSEY BOULEVARD, BOSTON, MASSACHUSETTS 02125

STURBRIDGE

407 MAIN STREET

Area(s) Form No.

STU.C

STU.124
STU.332

Recommended for listing in the National Register of Historic Places.

If checked, you must attach a completed National Register Criteria Statement form.

ARCHITECTURAL DESCRIPTION

The George E. Richards House (ca. 1874, STU.124) is a northwest-facing, Italianate, two-and-one-half-story, three-bay-by-two-bay, wood-frame building with a two-bay-by-two-bay ell on the east elevation. A narrow, one-story, two-bay addition projects from the west elevation of the main block. A large Barn (1892, STU.332) is connected to the southeast corner of the ell, and a two-story addition spans the south elevation of the house and ell. A square, two-story tower with a pyramidal roof sits at a 45-degree angle to the southwest corner of the rear addition. The main house and attached barn both have end-gable roofs with bracketed cornices, and the ell and addition have side-gable roofs. The roofs are covered with asphalt shingles, the walls are clad with wood clapboards, and the foundation is stone. The main house and the ell have brick chimneys, and the barn has an octagonal cupola. A one-story porch supported by square wood columns with scrollwork brackets wraps around the ell's north and east elevations. A one-bay-wide entry porch shelters the main entrance in the east bay of the northwest (facade) elevation of the main block. The entrance consists of a wood door with a pair of narrow, arched lights in the upper half and four small panels in the bottom half. Secondary entrances are fully glazed, wood-frame doors in the west bay of the ell's northwest elevation, the west bay of the barn's northwest elevation, and the center bay of the barn's northeast elevation. A wide, non-historic porch wraps around the southeast corner of the barn. A bay window with a bracketed cornice is west of the main entrance. Fenestration consists of symmetrically spaced, one-over-one and two-over-two, double-hung vinyl replacement sash in the main block and ell and large, modern casement and picture windows in the barn.

In 1987, an addition was constructed, and the barn was renovated. In 1997, a deck was built around the southeast corner of the barn, and vinyl replacement windows were installed in the late twentieth century.

The Richards House is a well-preserved example of an Italianate-style house in Sturbridge.

HISTORICAL NARRATIVE

The George E. Richards House and Barn (ca. 1874 and 1892, STU.124 and STU.332) are at the east edge of the village of Snellville in the town of Sturbridge. Sturbridge was settled ca. 1725 by residents of Medfield, and Sturbridge was incorporated as a town in 1738 (MHC 1984:3–4).

In 1874, George Emery Richards (1845–1921) purchased from Festus Wight a parcel of land bounded approximately by Stallion Hill Road and what is now called Main Street (WCRD 936/413). The building first appears on the 1892 bird's-eye map of Sturbridge and then on the parcel labeled Richards on the 1898 Richards map; it is possible that the current barn replaced an earlier barn (Bailey 1892; Richards 1898; WCRD 546/35). George Richards was a carpenter and later a machinist in the auger shop at the nearby Snell Manufacturing Company. He married Louisa M. Janes (b. 1854) in 1874, and the couple lived at the subject property with their daughter Grace (b. 1888). He also owned a small rental property, originally located opposite the entrance to Old Sturbridge Village at 380 Main Street and later moved to 413 Main Street (STU.80) (US Census 1880, 1900).

The Richards family owned the subject property until 1922, when Louise, by then a widow living in New York City, sold it to Don W. Simmons (WCRD 2261/411; ancestry.com 2013a). Simmons quickly sold it to Henry and Rose L'Heureux, who owned the property for about eight years before selling it to Robert and Victoria Lazzerin and moved to 558 Main Street in Fiskdale (WCRD 2305/200, 2635/16; Manning 1949). Robert Lazzerin was an Italian immigrant who worked as a loom fixer at the Ames Worsted Company in Southbridge (Ancestry.com 2010, 2013b). The Lazzerins owned the property until 1985, when their son Robert E. Lazzerin Jr. sold it to George F. Sullivan, Thomas J. Sullivan, and Steven E. Daly. The three men owned it for about ten years before selling it to the Sturbridge Corporation, or Old Sturbridge Village (WCRD 9133/146, 16318/387). Town of Sturbridge building permits indicate that an addition was constructed and the barn renovated, possibly for commercial use, during the ownership of Daly and the Sullivans. Under the Sturbridge Corporation's ownership, a deck was built. The building, currently owned by Marin Realty Inc., remains in commercial use, with a restaurant and coffee shop occupying most of the former residence and barn (WCRD 52762/63).

INVENTORY FORM B CONTINUATION SHEET

MASSACHUSETTS HISTORICAL COMMISSION

220 MORRISSEY BOULEVARD, BOSTON, MASSACHUSETTS 02125

STURBRIDGE

407 MAIN STREET

Area(s) Form No.

STU.C

STU.124
STU.332

BIBLIOGRAPHY and/or REFERENCES

- Ancestry.com. *U.S., World War II Draft Registration Cards, 1942* [database on-line]. Lehi, UT, USA: Ancestry.com Operations, Inc., 2010.
- _____. *Massachusetts, Death Index, 1901-1980*. Provo, UT: Ancestry.com Operations, Inc., 2013a.
- _____. *Massachusetts, Mason Membership Cards, 1733-1990*. Provo, UT: Ancestry.com Operations, Inc., 2013b.
- Bailey, O. H. & Co. *Sturbridge and Fiskdale*. Boston: O.H. Bailey & Co., 1892. On file, Norman B. Leventhal Map Center, Boston, MA.
- Beers, F.W. *Atlas of Worcester County, Massachusetts*. New York: F.W. Beers & Co., 1870.
- Long, Wolfgang. *Massachusetts Historical Commission Building Form B – Red Barn Tourist Home, 407 Main Street, Sturbridge (STU.124)*. On file, Massachusetts Historical Commission, Boston, MA, 1973.
- Massachusetts Historical Commission (MHC). *MHC Reconnaissance Survey Town Report – Sturbridge*. On file, Massachusetts Historical Commission, Boston, MA, 1984.
- O.H. Bailey & Co. *Sturbridge and Fiskdale*. Boston: O.H. Bailey & Co., 1892.
- Richards, L.J. *Topographical Atlas of Worcester County*. Philadelphia: L.J. Richards & Co., 1898.
- Sturbridge Building Department. Building Permits. On file, Town of Sturbridge Building Department, Sturbridge, MA.
- United States Bureau of the Census (US Census). *Tenth Census of the United States, 1880*. (T9 1454 rolls). National Archives and Records Administration, Washington, D.C., ancestry.com database.
- _____. *Twelfth Census of the United States, 1900*. (T623, 1854 rolls). National Archives and Records Administration, Washington, D.C., ancestry.com database.
- Worcester County Registry of Deeds (WCRD). Book/Page (Year). 936/413 (1874), 2261/411 (1922), 2305/200 (1923), 2635/16 (1935), 9133/146 (1985), 16318/387 (1994), 52762/63 (2014).

PHOTOGRAPH



Photo 2. George Richards House, 407 Main Street, looking west.

INVENTORY FORM B CONTINUATION SHEET

MASSACHUSETTS HISTORICAL COMMISSION
220 MORRISSEY BOULEVARD, BOSTON, MASSACHUSETTS 02125

STURBRIDGE

407 MAIN STREET

Area(s) Form No.

STU.C

STU.124
STU.332

HISTORIC IMAGE

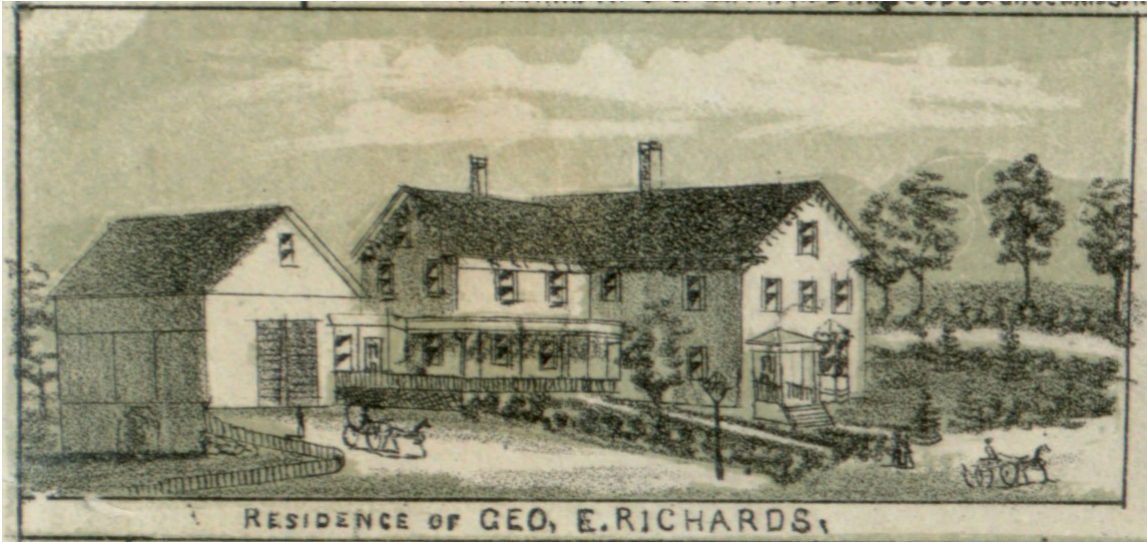

1892 image of the George E. Richards House and Barn, 407 Main Street (Bailey 1892).

INVENTORY FORM B CONTINUATION SHEET

MASSACHUSETTS HISTORICAL COMMISSION
220 MORRISSEY BOULEVARD, BOSTON, MASSACHUSETTS 02125

STURBRIDGE

407 MAIN STREET

Area(s) Form No.

STU.C

STU.124
STU.332

National Register of Historic Places Criteria Statement Form

Check all that apply:

- Individually eligible Eligible **only** in a historic district
- Contributing to a potential historic district Potential historic district

Criteria: **A** **B** **C** **D**

Criteria Considerations: **A** **B** **C** **D** **E** **F** **G**

Statement of Significance by Gretchen M. Pineo and Laura J. Kline, PAL, October 2018

The George E. Richards House and Barn is eligible for listing in the National Register of Historic Places at the local level under Criterion A and C. Under Criterion A, the property is eligible in the area of Community Planning and Development for its association with the residential development of the Snellville area in the late nineteenth century. Under Criterion C, the property is eligible in the area of Architecture as an intact example of a three-bay, side-hall plan, Italianate-style house.