

FORM B – BUILDING

Assessor's Number USGS Quad Area(s) Form Number

415-02924-271 Southbridge STU.A STU.35
NRDIS 11/9/1977

MASSACHUSETTS HISTORICAL COMMISSION
MASSACHUSETTS ARCHIVES BUILDING
220 MORRISSEY BOULEVARD
BOSTON, MASSACHUSETTS 02125

Town/City: Sturbridge

Place: (*neighborhood or village*): Sturbridge Center

Photograph



Address: 275 Main Street

Historic Name: Chamberlain House

Uses: Present: Inn

Original: Single Family Dwelling

Date of Construction: 1918

Source: Newcomb and Wilkin 1972

Style/Form: Colonial Revival

Architect/Builder: Edwin T. Chapin

Exterior Material:

Foundation: Stone

Wall/Trim: Wood Clapboard/Wood Trim

Roof: Slate Shingle

Outbuildings/Secondary Structures: None

Major Alterations (*with dates*): two-story addition to south, 2014/2015; vinyl sash, late 20th century/early 21st century

Condition: Good

Moved: no yes **Date:**

Acreage: .6 acres

Setting: The building occupies a roughly L-shaped lot on the south side of Main Street in a mostly residential neighborhood east of the Sturbridge Town Common. It is set back from the road and is currently part of the Publick House inn complex.

Locus Map

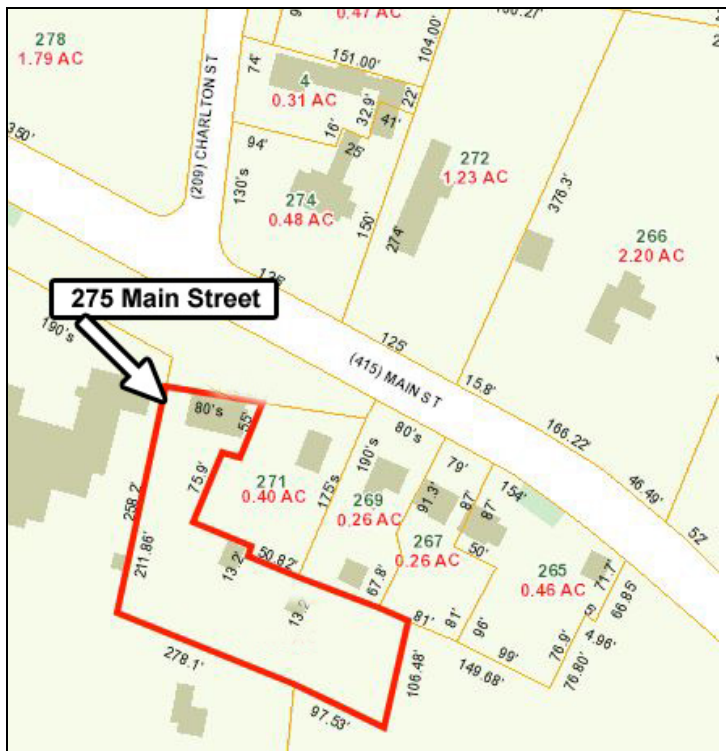

Recorded by: L. Kline, G. Pineo, E. Giacomarra; PAL

Organization: Sturbridge Historical Commission

Date (*month / year*): May 2018

INVENTORY FORM B CONTINUATION SHEET

STURBRIDGE

275 MAIN STREET

MASSACHUSETTS HISTORICAL COMMISSION

Area(s) Form No.

220 MORRISSEY BOULEVARD, BOSTON, MASSACHUSETTS 02125

STU.A

STU.35

 Recommended for listing in the National Register of Historic Places.*If checked, you must attach a completed National Register Criteria Statement form.*

ARCHITECTURAL DESCRIPTION

The Chamberlain House (1918, STU.35) is a north-facing, Colonial Revival-style, two-story, four-bay-by-three-bay, wood-frame building with a stone foundation and a gable-on-hip roof. A two-story, four-bay-by-two-bay, gable-roof ell projects from the south elevation of the main block. A large, two-story addition projects from the south elevation of the ell. The walls are clad with wood clapboards, and the roof is covered with slate shingles. An external chimney is centered on the west elevation, and a second chimney pierces the roof between the main block and the ell. A wide entry porch, topped with a pair of gable pediments joined by a shed roof and supported by simple pillars, spans nearly the full width of the north (facade) elevation. The porch shelters two evenly spaced entrances filled with modern doors with oval lights. Secondary entrances in the west elevations are spaced between the main block and the ell and the ell and the addition. The north entrance is sheltered by a shed overhang, and the south entrance is sheltered by a gable portico supported by simple columns. A bay window projects from the north bay of the east elevation. Fenestration consists of six-over-six, double-hung vinyl sash.

In the late twentieth or early twenty-first century, the windows were replaced with vinyl units. The two-story addition was constructed in 2014/2015.

The Chamberlain House is a well-preserved example of an early twentieth-century Colonial Revival-style house in Sturbridge.

HISTORICAL NARRATIVE

The Chamberlain House (1918, STU.35) is in the center of Sturbridge, south of the Sturbridge Town Common. The area was settled ca. 1725 by residents of Medfield, and Sturbridge was incorporated as a town in 1738 (MHC 1984:3–4).

About 1805, Henry Mellen's store occupied the current site of the Chamberlain House (1918, STU.35) on the south side of the Sturbridge Town Common (Levine 1971). The area was settled ca. 1725 by residents of Medfield, and Sturbridge was incorporated in 1738 (MCH 1984:3–4; Levine 1971). A house was constructed on the property by 1825 by Major Alvan Allen (1797–1859), who likely inherited the property from his uncle, Captain Simeon Allen, a cordwainer (Levine 1971).

In 1849, Allen sold the property to John N. Chamberlain, a trader, and moved to nearby Charlton (WCRD 449/17; Find A Grave 2018b). Chamberlain's family retained possession of the property into the twentieth century. In 1918, the family demolished the Allen house and constructed the present building at 275 Main Street, possibly designed by Worcester architect Edwin T. Chapin (Drew Allis Company 1918; Newcomb and Wilkin 1972). The building is believed to be a copy of the western portion of 6 Chamberlain Avenue (STU.14) with a house facing the street and a replica of a store at the rear (Newcomb and Wilkin 1972). Alvin H. Chamberlain, one of the family members who owned the property (along with nearby 283 Main Street, STU.38), was a superintendent at the Snell Manufacturing Company in Sturbridge (see Wight-Snell Manufacturing Area, STU.N) (Meek 1922). The Chamberlains sold the property in 1976 to the Mid-State Restaurant Corporation, which retained it until 2003. Resurrection Real Estate, which also owns The Publick House (277 Main Street, STU.O) and 283 Main Street, purchased the property in 2003 (WCRD 5917/362, 31465/52). In 2014/2015, the building was expanded with a two-story south addition; it is now used as lodging for the Publick House inn complex.

Edwin T. Chapin (1871–1959)

Edwin T. Chapin was born in 1871 in Worcester, Massachusetts, to Ellen Newbury Chapin and Edwin Chapin. He lived in Worcester with his wife Flora and practiced architecture in Worcester and the central Massachusetts region (Ancestry.com 1871; US Census 1940). Chapin designed numerous houses, apartments, and religious buildings in Worcester, including the Sharaai Torah Synagogue, 32 Providence Street (WOR.1256), and the Oliver Dean House, 3 Germain St (WOR.284). He also designed

INVENTORY FORM B CONTINUATION SHEET

STURBRIDGE

275 MAIN STREET

MASSACHUSETTS HISTORICAL COMMISSION

Area(s) Form No.

220 MORRISSEY BOULEVARD, BOSTON, MASSACHUSETTS 02125

STU.A

STU.35

buildings in surrounding Massachusetts towns, such as the Starrett Memorial United Methodist Church, 40 Island Street (ATH.156), in Athol and the Douglas Town Hall, 331 Main Street (DOU.301), in Douglas.

The Chamberlain House was listed in the National Register of Historic Places on November 9, 1977, as part of the Sturbridge Common Historic District.

BIBLIOGRAPHY and/or REFERENCES

- Ancestry.com. 1871. "Massachusetts, Town and Vital Records, 1620-1988." Provo, UT: Ancestry.com Operations, Inc.
- Beers, F.W. *Atlas of Worcester County Massachusetts*. New York: F.W. Beers & Co., 1870.
- Drew Allis Company. *The Worcester House Directory and Family Address Book* No. XLV. Worcester: Drew Allis Company, 1918.
- Find a Grave. "Charles F. Clarke," 2017, <https://www.findagrave.com/memorial/181704352>, accessed February 2018.
- _____. "Elisha Allen," 2008, <https://www.findagrave.com/memorial/24979545/elisha-allen>, accessed May 2018a.
- _____. "Alvan Allen," 2011, <https://www.findagrave.com/memorial/64400367>, accessed May 2018b.
- Levine, Herbert J. *In Pursuit of a Nucleated Village: Sturbridge, Massachusetts, Settlement to 1850*. Typed manuscript, on file, Old Sturbridge Village, Sturbridge, MA, 1971.
- Massachusetts Historical Commission (MHC). *MHC Reconnaissance Survey Town Report: Sturbridge*. On file, Massachusetts Historical Commission, Boston, MA, 1984.
- Meek, Alice R. *The Southbridge and Sturbridge Directory*. Salem, MA: Henry M. Meek Publishing Co., 1922.
- Newcomb, Kathleen, and Agnes Wilkin. *Massachusetts Historical Commission Building Form B – 275 Main Street (STU.35)*. On file, Massachusetts Historical Commission, Boston, MA, 1972.
- Richards, L.J. *Topographical Atlas of Worcester County*. Philadelphia: L.J. Richards & Co., 1898.
- Sturbridge Assessor. Property records, <http://images.vgsi.com/cards/SturbridgeMACards/415-/M415--0B2924--L275-U-.pdf>, accessed May 2018.
- United States Bureau of the Census (US Census). *Thirteenth Census of the United States, 1910*. (T624, 1178 rolls). National Archives and Records Administration, Washington, D.C., ancestry.com database.
- _____. *Sixteenth Census of the United States, 1940*. (T627, 4,643 rolls). National Archives and Records Administration, Washington, D.C., ancestry.com database.
- Walling, H. F. *Map of the Worcester County, Massachusetts*. New York: Wm. E. Baker & Co., 1857.
- Worcester County Registry of Deeds (WCRD) Book/Page (Year): 449/17 (1849); 5917/362 (1976); 31465/52 (2003).