



Town of Sturbridge

DESIGN REVIEW COMMITTEE

DESIGN REVIEW COMMITTEE NOTICE OF DECISION SIGN

Applicant: Sturbridge Orthodontics
Joel Perry
Graphics Unlimited LLC
559 Main Street
Pomfrey, CT 06258
Phone: 860-928-1407

Property Owner: Symphony on Main LLC
8 Turner Lane
Sturbridge, MA 01055

Parcel Information: Assessor's Map 415-35E42-076

Zoning Designation: Commercial Tourist District

Property Location: 76 Main Street

Description of Request: The applicant requests design approval for a new sign to be erected at 76 Main Street.

Date of Meeting: October 16, 2017

Meeting Details:

Committee Members Present: Chris Castendyk, Chris Wilson and Elaine Cook

Applicant for Permanent Sign Request:

Applicant seeks design approval for a new free standing sign on the building at 76 Main Street. The sign will be double-sided featuring the business logo, scalloped corners and a raised carved address number applique supported by painted posts with decorative federal post caps located in the front yard area of the property.

At the meeting of October 16, 2017, there was a motion by Elaine Cook to approve the building sign with the strong recommendation for landscaping at the 76 Main Street location. The motion was seconded by Chris Wilson and voted 3 – 0.

The applicant shall be aware that this approval is for the design only. A permit to erect the sign must be obtained from the Building Inspector.

Chris Castendyk (PLD)
Chris Castendyk, Vice Chair

10/17/17
Date

cc: Building Inspector



For Use by Permitting Coordinator:

Date Received: _____

Determination of Completeness: _____

Additional Information Received: _____

Application Withdrawn: _____

**TOWN OF STURBRIDGE
APPLICATION FOR PERMANENT SIGN
REVISED 2/07/11**

APPROVED

OCT 16 2017

DESIGN REVIEW
COMMITTEE

Site: 76 Main Street

Location (Street Number and Street Name)

Section 1. Applicant/Owner/Agent Information:

A. Applicant:

Business Name: Sturbridge Orthodontics

Applicant Name: Joel Perry for Ferdinand Sabelis

Address: Graphics Unlimited LLC 30 Putnam Road
P.O. Box 262 Pomfret, CT 06258

Phone: 860-928-1407 Fax: 860-928-1407

Email: Sales@gusigns.com

B. Property Owner:

Name: Symphanyonmain LLC

Address: 8 Turner Lane
Sturbridge, MA

Phone: 617-413-7315 Fax: N/A

Email: fsabelis@gmail.com

RECEIVED
OCT 02 2017

C. Agent Information:

Business Name: Graphics Unlimited LLC
Agent: Joel Perry
Address: PO Box 262 30 Putnam Rd
Pomfret, CT 06258
Phone: 860-928-1407 Fax: 860-928-1407
Email: sales@gusigns.com

Section 2. Basic Site and Project Information:

A. Assessor's Parcel Identification Numbers: 415-35E42-076

B. Proposed Sign Information:

Please provide a general description of the sign and location of the sign (attach additional sheets if necessary):

Free standing 3' x 7' double sided sign featuring
business logo, scalloped corners and a raised
carved address number appliqué supported by
painted posts with decorative federal post caps
located in the front yard area of the property.

C. Note any current zoning or general bylaw non conformance associated with the property or the application:

none

D. Note any special permit or variances granted or denied or in process at this time:

none

Section 3. Required Application Submittals: The applicant shall submit one original set and six copies of the application and final drawings and one set of materials at the time the application is submitted to the Town Planner. The following information must be submitted with the application for a sign permit for new signs and changes to existing signs: (At its discretion, the DRC may substitute some requirements with a site visit).

- A Site Plan showing property lines, setback areas, access points, traffic flow and a scaled site plan showing property lines, appropriate front, side, and rear yard setbacks as identified in the Zoning bylaw, pedestrian and vehicular access and existing buildings and significant site objects and features, and the existing and proposed sign locations shall also be shown.
- A drawing of the proposed structure or sign, including color and type of surface materials, showing front elevations, rear elevations, and side elevations, where there are not adjoining buildings. The drawing should accurately convey the design of the sign including lettering styles, size, and composition. The location, font, and contrasting color of the street number shall be easily read by emergency personnel and patrons/visitors.
- A description of the materials, colors, and lighting, (if the sign is to be lit), to be used in the modification of an existing sign or construction of a new sign. The presentation of photographs showing the existing signs to be modified would be helpful. Samples of the colors of the proposed sign and materials to be used for the construction of the signs and supports shall also be submitted.
- Scale drawings of the proposed sign, (whether the modifications of an existing sign, or the provision of a new sign) shall be submitted, including a plan view and an architectural elevation of each side. One architectural elevation will suffice if all sides are identical. All drawings shall include dimensions indicating the length, width, and height of the proposed signage as appropriate to the information conveyed by plan or elevation. Applicants shall review the Town of Sturbridge Zoning Bylaw for detailed information on zoning limitations and requirements relative to their signage situation prior to designing any new proposed signs. The Bylaw may be accessed on line at the following link:
http://www.town.sturbridge.ma.us/Public_Documents/SturbridgeMA_PlanningDocuments/Zoning%20Bylaw%202010?FCItemID=S02B54AC5

- Planting plan, with descriptions of materials. Planting plan identifying the proposed plant material and quantity of each by location on plan; an overall plant list, which at a minimum identifies total quantities of each plant used; botanical and common name for each plant, and size of the plant material at time of installation. *N/A*
- Photographs of existing signage on the site and the building will aid the DRC in making its decision and are required as a submittal.

Section 4. Required Signatures:

A. Applicant:

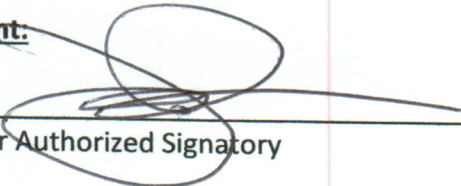

 Applicant or Authorized Signatory

9-27-17

 Date

B. Property Owner: I hereby grant permission for the applicant to apply for and erect the signs as proposed on the above referenced property.

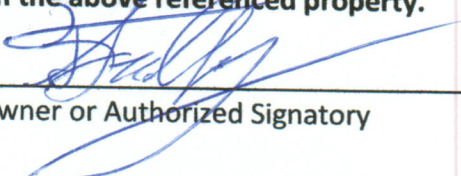

 Owner or Authorized Signatory

9/28/17

 Date

C. Agent: If someone is representing the applicant or the owner, the applicant must designate such representative below:

Name of Representative: Joel Perry

Address of Representative: PO Box 262
Pomfret, CT 06258

Phone: 860-928-1407 Fax: 860-928-1407

Email: _____

Relationship of representative to owner or applicant: Sign fabricator - installer
for client

Finance Director/Tax Collector: I certify that the taxes are current for the above property (applicant must obtain this signature prior to submission of this application)

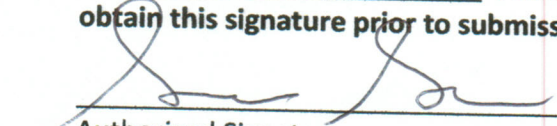

Authorized Signatory

10-2-2017

Date

Award Winning Designers and Fabricators of Quality Signs Since 1988

GRAPHICS UNLIMITED PROPOSAL # 45897 SEPTEMBER 21, 2017

COPYRIGHT 2017 GRAPHICS UNLIMITED LLC ALL RIGHTS RESERVED



Sign measures 39.5" x 84" double sided, non illuminated
1" PVC with scalloped corners, printed vinyl graphics
Address number applique 13" x 20" with carved number
Decorative posts are painted PVC with colonial style caps
All mounting brackets and hardware color matched
Cost of complete sign installed with tax \$ 2,565.40
Permits and meeting additional. TBD.

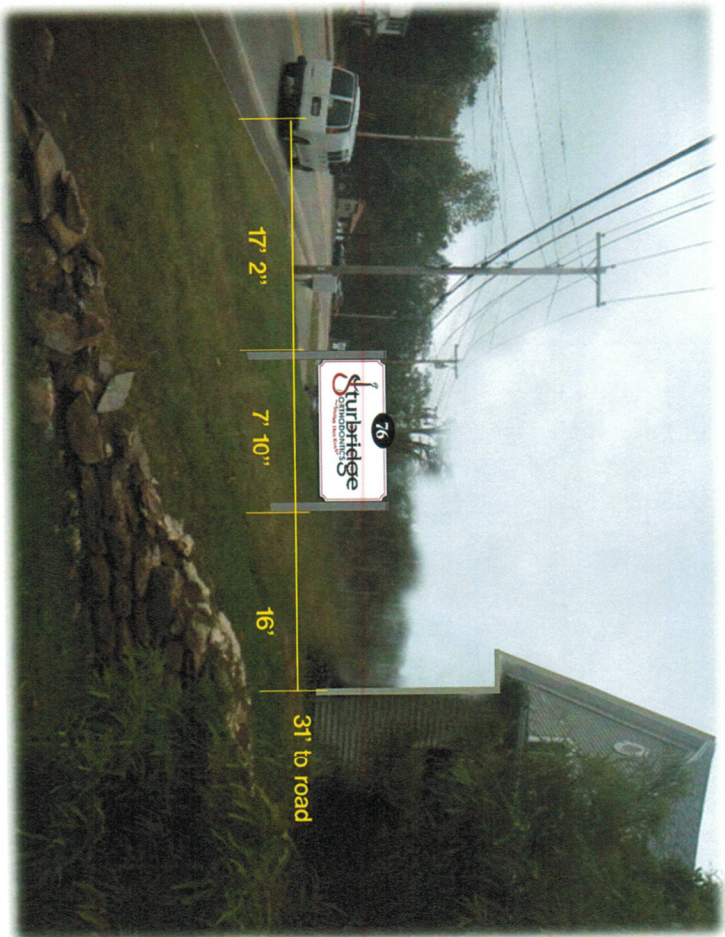

POMFRET CT 860-928-1407
ROUTE 44 30 Putnam Road P.O. BOX 282 06238
SALES @ GUSIGNS.COM

DUDLEY, MA 508-948-1541
7 West Main Street
01571
graphicsunlimited@verizon.net



GU SIGNS .com



Existing signs measure: heading east
5' x 6' single sided sign on posts



heading west 3' x 5'
single sided on building

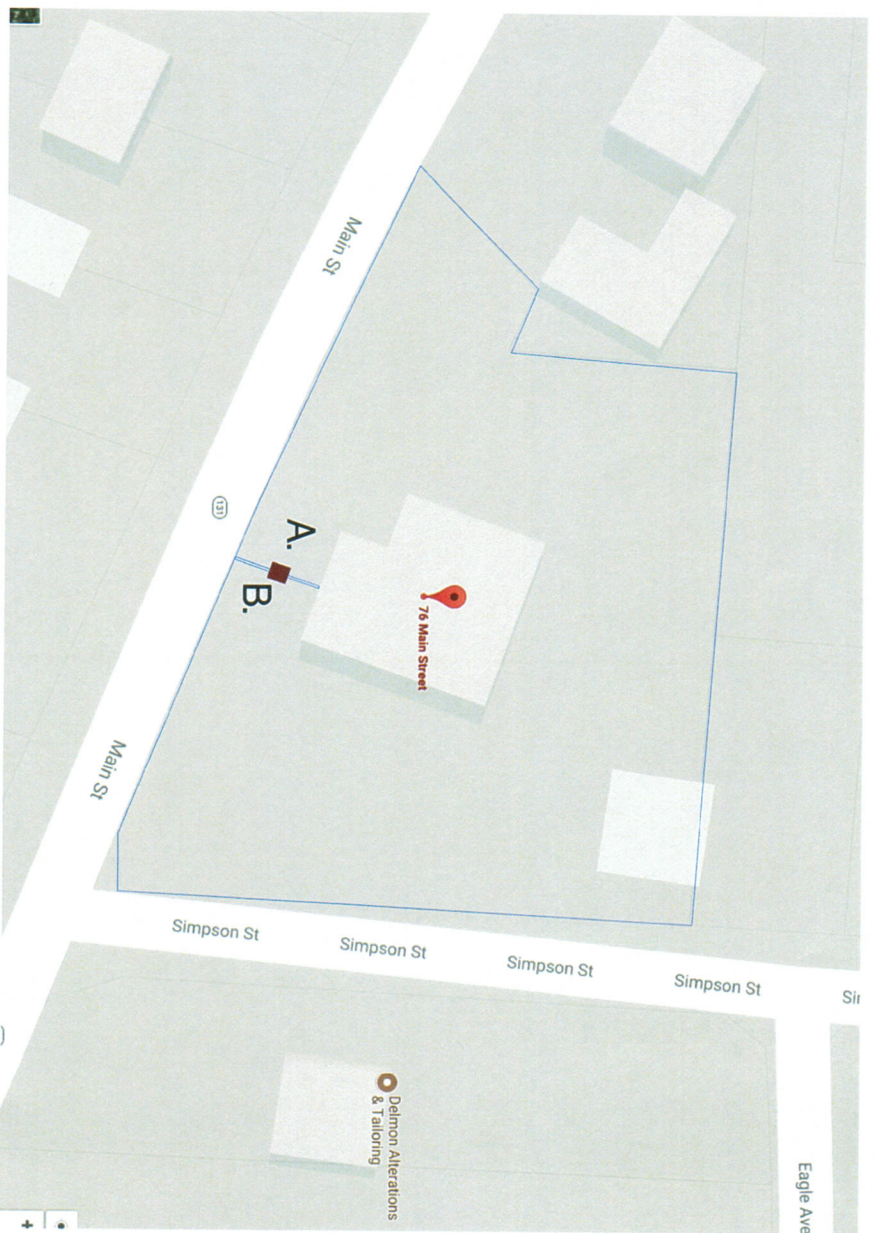

plot plan

- A. Building 31' set back off the road
- B. Sign 17' 2" set back off the road

No line of sight obstructions in either direction for over 2,000'

POWHEAT CT 860-928-1407
ROUTE 44 30 Putnam Road P.O. BOX 282 06258
SALES @ CUSIONS.COM

DUDLEY, MA 508-948-1541
7 West Main Street 01571
graphicsunlimited@verizon.net



GU SIGNS.com