



**Town of Sturbridge
Conservation Commission
Notice of Intent Application Coversheet/Checklist**

Date **10.9.23**

in all white cells completely

Parcel		Applicant name	DAN ST. ONGE
Address	62 MT DAN ROAD	Address	62 MT DAN ROAD
Assessors		Email	d9STONGE@gmail.com
Map/Plat	9 62	Phone	860-573-9045
Book & Page			
Owner name	DAN ST. ONGE	Representative	MARK LAVIGNE
Address	62 MT DAN ROAD	Address	554 HOWE ST. E. BROOKFIELD 01515
Email	d9stonge@gmail.com	Email	MARK@GENDFX.COM
Phone	860-573-9045	Phone	508-450-1362

DFil

Wetland type		sf/cf affected		Relevant Perf. Standards	10. _____
Wetland type		sf/cf affected		Relevant Perf. Standards	10. _____
Wetland type		sf/cf affected		Relevant Perf. Standards	10. _____

Components of a Complete NOI Application

State Form: NOI Form 3	Included? <input checked="" type="checkbox"/> Yes <input type="checkbox"/> No
Engineered Plan	Included? <input type="checkbox"/> Yes <input checked="" type="checkbox"/> No
Proof of Mailing to DEP	Included? <input checked="" type="checkbox"/> Yes <input type="checkbox"/> No
Narrative	Included? <input checked="" type="checkbox"/> Yes <input type="checkbox"/> No
Proof that all relevant perf. standards are met	Included? <input type="checkbox"/> Yes <input type="checkbox"/> No
TOPO Map identifying locus with scale	Included? <input checked="" type="checkbox"/> Yes <input type="checkbox"/> No
FIRM Map identifying locus with scale	Included? <input checked="" type="checkbox"/> Yes <input type="checkbox"/> No
Natural Heritage Map with WH, PH, & VP data	Included? <input type="checkbox"/> Yes <input checked="" type="checkbox"/> No Included? <input type="checkbox"/>
Delineation lines (backup material)	Included? <input type="checkbox"/> Yes <input checked="" type="checkbox"/> No
Tax Form	Included? <input checked="" type="checkbox"/> Yes <input type="checkbox"/> No
Fees	
★ Fee Transmittal form	Included? <input checked="" type="checkbox"/> Yes <input type="checkbox"/> No
★ Filing Fee Worksheet	Included? <input checked="" type="checkbox"/> Yes <input type="checkbox"/> No
★ Town portion of state filing fee	Included? <input checked="" type="checkbox"/> Yes <input type="checkbox"/> No
★ Sturbridge local filing fee \$ _____	Included? <input checked="" type="checkbox"/> Yes <input type="checkbox"/> No
Abutter Information	
★ Certified abutters list (within 200')	Included? <input checked="" type="checkbox"/> Yes <input type="checkbox"/> No
★ Abutter notification form	Included? <input checked="" type="checkbox"/> Yes <input type="checkbox"/> No
★ Affidavit & proof -- bring to hearing	<i>Present them at the hearing</i>
Other Attachments, e.g.	
Confirmation of submission to NHESP	Included? <input type="checkbox"/> Yes <input type="checkbox"/> No <input checked="" type="checkbox"/> Not Applicable
Planting Plan	Included? <input type="checkbox"/> Yes <input type="checkbox"/> No <input checked="" type="checkbox"/> Not Applicable
Floodplain analysis	Included? <input type="checkbox"/> Yes <input type="checkbox"/> No <input checked="" type="checkbox"/> Not Applicable
Stormwater analysis	Included? <input type="checkbox"/> Yes <input type="checkbox"/> No <input checked="" type="checkbox"/> Not Applicable

Components of a Complete NOI Application



Massachusetts Department of Environmental Protection
Bureau of Resource Protection - Wetlands

Provided by MassDEP:

WPA Form 3 - Notice of Intent

Massachusetts Wetlands Protection Act M.G.L. c. 131, §40

MassDEP File Number

Document Transaction Number

City/Town

Important:
When filling out forms on the computer, use only the tab key to move your cursor - do not use the return key.



Note:
Before completing this form consult your local Conservation Commission regarding any municipal bylaw or ordinance.

A. General Information

1. Project Location (Note: electronic filers will click on button to locate project site):

62 MT. DAN ROAD
a. Street Address
Sturbridge
b. City/Town
01518
c. Zip Code
42.14571
d. Latitude
72.12496
e. Longitude
9
f. Assessors Map/Plat Number
62
g. Parcel /Lot Number

2. Applicant:

DAN
a. First Name
ST. ONGE
b. Last Name
62 MT DAN ROAD
c. Organization
d. Street Address
Sturbridge
e. City/Town
MA.
f. State
01518
g. Zip Code
860.573.9095
h. Phone Number
i. Fax Number
dstonog@gmail.com
j. Email Address

3. Property owner (required if different from applicant):

Check if more than one owner

a. First Name
b. Last Name
c. Organization
d. Street Address
e. City/Town
f. State
g. Zip Code
h. Phone Number
i. Fax Number
j. Email address

4. Representative (if any):

MARK
a. First Name
LAUIGNE
b. Last Name
GROUND EFFECTS LLC
c. Company
554 Howe St.
d. Street Address
E. Brookfield
e. City/Town
MA.
f. State
01515
g. Zip Code
508 450 1362
h. Phone Number
i. Fax Number
MARK@GRNDFX.COM
j. Email address

5. Total WPA Fee Paid (from NOI Wetland Fee Transmittal Form):

588.00
a. Total Fee Paid
281.50
b. State Fee Paid
306.50
c. City/Town Fee Paid



WPA Form 3 - Notice of Intent

MassDEP File Number

Massachusetts Wetlands Protection Act M.G.L. c. 131, §40

Document Transaction

City/Town

A. General Information (continued)

6. General Project Description:

7a. Project Type Checklist: (Limited Project Types see Section A. 7b.)

- 1. Single Family Home
- 2. Residential Subdivision
- 3. Commercial/Industrial
- 4. Dock/Pier
- 5. Utilities
- 6. Coastal engineering Structure
- 7. Agriculture (e.g., cranberries, forestry)
- 8. Transportation
- 9. Other

7b. Is any portion of the proposed activity eligible to be treated as a limited project (Including Ecological Restoration Limited Project) subject to 310 CMR 10.24 (coastal) or 310 CMR 10.53 (Inland)?

1. Yes No

If yes, describe which limited project applies to this project. (See 310 CMR 10.24 and 10.53 for a complete list and description of limited project types.)

2. Limited Project Type

If the proposed activity is eligible to be treated as an Ecological Restoration Limited Project (310 CMR 10.24(8), 310 CMR 10.53(4)), complete and attach Appendix A: Ecological Restoration Limited Project Checklist and Signed Certification.

8. Property recorded at the Registry of Deeds for:

a. County

b. Certificate # (if registered land)

c. Book

d. Page Number

B. Buffer Zone & Resource Area Impacts (temporary & permanent)

- 1. Buffer Zone Only - Check if the project is located only in the Buffer Zone of a Bordering Vegetated Wetland, Inland Bank, or Coastal Resource Area.
- 2. Inland Resource Areas (see 310 CMR 10.54-10.58; if not applicable, go to Section B.3, Coastal Resource Areas).

Check all that apply below. Attach narrative and any supporting documentation describing how project will meet all performance standards for each of the resource areas altered, including standards requiring consideration of alternative project design or location.



Massachusetts Department of Environmental Protection
 Bureau of Resource Protection - Wetlands
WPA Form 3 - Notice of Intent
 Massachusetts Wetlands Protection Act M.G.L. c. 131, §40

Provided by MassDEP:
 MassDEP File Number _____
 Document Transaction _____
 City/Town _____

B. Buffer Zone & Resource Area Impacts (temporary & permanent) (cont'd)

For all projects affecting other Resource Areas, please attach a narrative explaining how the resource area was delineated.

Resource Area	Size of Proposed Alteration	Proposed Replacement (l)
a. <input checked="" type="checkbox"/> Bank	<u>3'</u> 1. linear feet	<u>3'</u> 2. linear feet
b. <input type="checkbox"/> Bordering Vegetated Wetland	1. square feet	2. square feet
c. <input type="checkbox"/> Land Under Waterbodies and Waterways	1. square feet 3. cubic yards dredged	2. square feet

Resource Area	Size of Proposed Alteration	Proposed Replacement (l)
d. <input type="checkbox"/> Bordering Land Subject to Flooding	1. square feet 3. cubic feet of flood storage lost	2. square feet 4. cubic feet replaced
e. <input type="checkbox"/> Isolated Land Subject to Flooding	1. square feet 2. cubic feet of flood storage lost	3. cubic feet replaced
f. <input type="checkbox"/> Riverfront Area	1. Name of Waterway (If available) - specify coastal or inland	

2. Width of Riverfront Area (check one):

- 25 ft. - Designated Densely Developed Areas only
- 100 ft. - New agricultural projects only
- 200 ft. - All other projects

3. Total area of Riverfront Area on the site of the proposed project: _____ square feet

4. Proposed alteration of the Riverfront Area:

a. total square feet _____ b. square feet within 100 ft. _____ c. square feet between 100 ft. and _____

5. Has an alternatives analysis been done and is it attached to this NOI? Yes

6. Was the lot where the activity is proposed created prior to August 1, 1996? Yes

3. Coastal Resource Areas: (See 310 CMR 10.25-10.35)

Note: for coastal riverfront areas, please complete Section B.2.f. above.



Massachusetts Department of Environmental Protection
Bureau of Resource Protection - Wetlands

Provided by MassDEP:

WPA Form 3 – Notice of Intent

Massachusetts Wetlands Protection Act M.G.L. c. 131, §40

MassDEP File Number _____

Document Transaction Number _____

City/Town _____

B. Buffer Zone & Resource Area Impacts (temporary & permanent) (cont'd)

Check all that apply below. Attach narrative and supporting documentation describing how the project will meet all performance standards for each of the resource areas altered, including standards requiring consideration of alternative project design or location.

Online Users:
 Include your document transaction number (provided on your receipt page) with all supplementary information you submit to the Department.

<u>Resource Area</u>	<u>Size of Proposed Alteration</u>	<u>Proposed Replacement (if any)</u>
a. <input type="checkbox"/> Designated Port Areas	Indicate size under Land Under the Ocean, below	
b. <input type="checkbox"/> Land Under the Ocean	_____	
	1. square feet	

	2. cubic yards dredged	
c. <input type="checkbox"/> Barrier Beach	Indicate size under Coastal Beaches and/or Coastal Dunes below	
d. <input type="checkbox"/> Coastal Beaches	_____	_____
	1. square feet	2. cubic yards beach nourishment
e. <input type="checkbox"/> Coastal Dunes	_____	_____
	1. square feet	2. cubic yards dune nourishment
	<u>Size of Proposed Alteration</u>	<u>Proposed Replacement (if any)</u>
f. <input type="checkbox"/> Coastal Banks	_____	
	1. linear feet	
g. <input type="checkbox"/> Rocky Intertidal Shores	_____	
	1. square feet	
h. <input type="checkbox"/> Salt Marshes	_____	_____
	1. square feet	2. sq ft restoration, rehab., creation
i. <input type="checkbox"/> Land Under Salt Ponds	_____	
	1. square feet	

	2. cubic yards dredged	
j. <input type="checkbox"/> Land Containing Shellfish	_____	
	1. square feet	
k. <input type="checkbox"/> Fish Runs	Indicate size under Coastal Banks, inland Bank, Land Under the Ocean, and/or inland Land Under Waterbodies and Waterways, above	

	1. cubic yards dredged	
l. <input type="checkbox"/> Land Subject to Coastal Storm Flowage	_____	
	1. square feet	

4. Restoration/Enhancement
 If the project is for the purpose of restoring or enhancing a wetland resource area in addition to the square footage that has been entered in Section B.2.b or B.3.h above, please enter the additional amount here.

a. square feet of BVW

b. square feet of Salt Marsh

5. Project Involves Stream Crossings

a. number of new stream crossings

b. number of replacement stream crossings



Massachusetts Department of Environmental Protection
Bureau of Resource Protection - Wetlands

WPA Form 3 – Notice of Intent

Massachusetts Wetlands Protection Act M.G.L. c. 131, §40

Provided by MassDEP:

MassDEP File Number _____

Document Transaction Number _____

City/Town _____

C. Other Applicable Standards and Requirements

- This is a proposal for an Ecological Restoration Limited Project. Skip Section C and complete Appendix A: Ecological Restoration Limited Project Checklists – Required Actions (310 CMR 10.11).

Streamlined Massachusetts Endangered Species Act/Wetlands Protection Act Review

1. Is any portion of the proposed project located in **Estimated Habitat of Rare Wildlife** as indicated on the most recent Estimated Habitat Map of State-Listed Rare Wetland Wildlife published by the Natural Heritage and Endangered Species Program (NHESP)? To view habitat maps, see the *Massachusetts Natural Heritage Atlas* or go to http://maps.massgis.state.ma.us/PRI_EST_HAB/viewer.htm.

a. Yes No

If yes, include proof of mailing or hand delivery of NOI to:

**Natural Heritage and Endangered Species Program
Division of Fisheries and Wildlife
1 Rabbit Hill Road
Westborough, MA 01581**

b. Date of map _____

If yes, the project is also subject to Massachusetts Endangered Species Act (MESA) review (321 CMR 10.18). To qualify for a streamlined, 30-day, MESA/Wetlands Protection Act review, please complete Section C.1.c, and include requested materials with this Notice of Intent (NOI); OR complete Section C.2.f, if applicable. *If MESA supplemental information is not included with the NOI, by completing Section 1 of this form, the NHESP will require a separate MESA filing which may take up to 90 days to review (unless noted exceptions in Section 2 apply, see below).*

- c. Submit Supplemental Information for Endangered Species Review.

1. Percentage/acreage of property to be altered:

(a) within wetland Resource Area

_____ percentage/acreage

(b) outside Resource Area

_____ percentage/acreage

2. Assessor's Map or right-of-way plan of site

2. Project plans for entire project site, including wetland resource areas and areas outside of wetlands jurisdiction, showing existing and proposed conditions, existing and proposed tree/vegetation clearing line, and clearly demarcated limits of work **

(a) Project description (including description of impacts outside of wetland resource area & buffer zone)

(b) Photographs representative of the site

* Some projects not in Estimated Habitat may be located in Priority Habitat, and require NHESP review (see <https://www.mass.gov/mass-endangered-species-act-mesa-regulatory-review>).

Priority Habitat includes habitat for state-listed plants and strictly upland species not protected by the Wetlands Protection Act.

** MESA projects may not be segmented (321 CMR 10.16). The applicant must disclose full development plans even if such plans are not required as part of the Notice of Intent process.



WPA Form 3 – Notice of Intent

Massachusetts Wetlands Protection Act M.G.L. c. 131, §40

MassDEP File Number

Document Transaction N

City/Town

C. Other Applicable Standards and Requirements (cont'd)

(c) MESA filing fee (fee information available at <https://www.mass.gov/how-to/how-to-f-a-mesa-project-review>).
Make check payable to "Commonwealth of Massachusetts - NHESP" and **mail to NHESP** at above address

Projects altering 10 or more acres of land, also submit:

(d) Vegetation cover type map of site

(e) Project plans showing Priority & Estimated Habitat boundaries

(f) OR Check One of the Following

1. Project is exempt from MESA review.
Attach applicant letter indicating which MESA exemption applies. (See 321 CMR 11.03(1) <https://www.mass.gov/service-details/exemptions-from-review-for-projectsactivities-priority-habitat>; the NOI must still be sent to NHESP if the project is within estimated habitat pursuant to 310 CMR 10.37 and 10.59.)

2. Separate MESA review ongoing. a. NHESP Tracking # _____ b. Date submitted to N _____

3. Separate MESA review completed.
Include copy of NHESP "no Take" determination or valid Conservation & Management Permit with approved plan.

3. For coastal projects only, is any portion of the proposed project located below the mean high water line or in a fish run?
a. Not applicable – project is in inland resource area only b. Yes No

If yes, include proof of mailing, hand delivery, or electronic delivery of NOI to either:

South Shore - Cohasset to Rhode Island border, and the Cape & Islands:

North Shore - Hull to New Hampshire border:

Division of Marine Fisheries -
Southeast Marine Fisheries Station
Attn: Environmental Reviewer
836 South Rodney French Blvd.
New Bedford, MA 02744
Email: dmf.envreview-south@mass.gov

Division of Marine Fisheries -
North Shore Office
Attn: Environmental Reviewer
30 Emerson Avenue
Gloucester, MA 01930
Email: dmf.envreview-north@mass.gov

Also if yes, the project may require a Chapter 91 license. For coastal towns in the Northeast Region, please contact MassDEP's Boston Office. For coastal towns in the Southeast Region, please cc MassDEP's Southeast Regional Office.

c. Is this an aquaculture project? d. Yes No

If yes, include a copy of the Division of Marine Fisheries Certification Letter (M.G.L. c. 130, § 57)



Massachusetts Department of Environmental Protection
Bureau of Resource Protection - Wetlands

Provided by MassDEP:

WPA Form 3 – Notice of Intent

Massachusetts Wetlands Protection Act M.G.L. c. 131, §40

MassDEP File Number

Document Transaction Number

City/Town

C. Other Applicable Standards and Requirements (cont'd)

Online Users:
Include your document transaction number (provided on your receipt page) with all supplementary information you submit to the Department.

4. Is any portion of the proposed project within an Area of Critical Environmental Concern (ACEC)?
a. Yes No If yes, provide name of ACEC (see instructions to WPA Form 3 or MassDEP Website for ACEC locations). **Note:** electronic filers click on Website.
b. ACEC
5. Is any portion of the proposed project within an area designated as an Outstanding Resource Water (ORW) as designated in the Massachusetts Surface Water Quality Standards, 314 CMR 4.00?
a. Yes No
6. Is any portion of the site subject to a Wetlands Restriction Order under the Inland Wetlands Restriction Act (M.G.L. c. 131, § 40A) or the Coastal Wetlands Restriction Act (M.G.L. c. 130, § 105)?
a. Yes No
7. Is this project subject to provisions of the MassDEP Stormwater Management Standards?
a. Yes. Attach a copy of the Stormwater Report as required by the Stormwater Management Standards per 310 CMR 10.05(6)(k)-(q) and check if:
1. Applying for Low Impact Development (LID) site design credits (as described in Stormwater Management Handbook Vol. 2, Chapter 3)
2. A portion of the site constitutes redevelopment
3. Proprietary BMPs are included in the Stormwater Management System.
b. No. Check why the project is exempt:
1. Single-family house
2. Emergency road repair
3. Small Residential Subdivision (less than or equal to 4 single-family houses or less than or equal to 4 units in multi-family housing project) with no discharge to Critical Areas.

D. Additional Information

- This is a proposal for an Ecological Restoration Limited Project. Skip Section D and complete Appendix A: Ecological Restoration Notice of Intent – Minimum Required Documents (310 CMR 10.12).

Applicants must include the following with this Notice of Intent (NOI). See instructions for details.

Online Users: Attach the document transaction number (provided on your receipt page) for any of the following information you submit to the Department.

1. USGS or other map of the area (along with a narrative description, if necessary) containing sufficient information for the Conservation Commission and the Department to locate the site. (Electronic filers may omit this item.)
2. Plans identifying the location of proposed activities (including activities proposed to serve as a Bordering Vegetated Wetland [BVW] replication area or other mitigating measure) relative to the boundaries of each affected resource area.



Massachusetts Department of Environmental Protection
Bureau of Resource Protection - Wetlands
WPA Form 3 – Notice of Intent
 Massachusetts Wetlands Protection Act M.G.L. c. 131, §40

Provided by MassDEP:

MassDEP File Number _____
 Document Transaction Number _____
 City/Town _____

D. Additional Information (cont'd)

3. Identify the method for BVW and other resource area boundary delineations (MassDEP BVW Field Data Form(s), Determination of Applicability, Order of Resource Area Delineation, etc.), and attach documentation of the methodology.

4. List the titles and dates for all plans and other materials submitted with this NOI.

Cantilevered Dock Proposal L-P-1
a. Plan Title

MARK LAUIGNE
b. Prepared By

AS NOTED ON PLAN
c. Signed and Stamped by

d. Final Revision Date

e. Scale

f. Additional Plan or Document Title

g. Date

5. If there is more than one property owner, please attach a list of these property owners not listed on this form.

6. Attach proof of mailing for Natural Heritage and Endangered Species Program, if needed.

7. Attach proof of mailing for Massachusetts Division of Marine Fisheries, if needed.

8. Attach NOI Wetland Fee Transmittal Form

9. Attach Stormwater Report, if needed.

E. Fees

1. Fee Exempt: No filing fee shall be assessed for projects of any city, town, county, or district of the Commonwealth, federally recognized Indian tribe housing authority, municipal housing authority, or the Massachusetts Bay Transportation Authority.

Applicants must submit the following information (In addition to pages 1 and 2 of the NOI Wetland Fee Transmittal Form) to confirm fee payment:

9314
2. Municipal Check Number

10.9.23
3. Check date

9313
4. State Check Number

10.9.23
5. Check date

MARK
6. Payor name on check: First Name

GROUND EFFECTS LLC LAUIGNE
7. Payor name on check: Last Name

STURBRIDGE WETLANDS PROTECTION BY-LAW AND REGULATIONS

WETLANDS FILING FEE CALCULATION WORKSHEET

Application Type	Qty	Town Filing Fee	TOTAL
Notice of Intent (NOI):			
Residential – Single Family: Accessory (Deck, Shed, Pool Septic)	<u>1</u>	\$150	<u>150.-</u>
Shoreline Work	<u>1</u>	\$150	<u>150.-</u>
New Construction	_____	\$300	_____
Residential – Other: Subdivision/Multi-Unit	_____	\$750	_____
Commercial/Industrial: New	_____	\$1500	_____
Redevelopment	_____	\$1000	_____
Limited Project (as defined in SWB & WPA)	_____	Equal to full WPA fee	_____
Alterations – located within Riverfront Area	_____	Additional 50% of Fee	_____
Application filed after Enforcement Order		Double the Municipal fee	_____
Request for Amended Order of Conditions	_____	50% of initial fee	_____
Request for Determination of Applicability (RDA):			
No Wetland Boundary Confirmation Residential:	_____	\$100	_____
No Wetland Boundary Confirmation All Other:	_____	\$200	_____
For Wetland Boundary Confirmation File ANRAD or NOI			
Abbreviated Notice of Resource Area Delineation (ANRAD):			
Residential – Single Family:	_____	\$100	_____
All Other: Base Review	_____	\$300	_____
Resource Area Boundary			



Town of Sturbridge

Barbara A. Barry, Finance Director

Department/Board/Committee: FINANCE

Please verify outstanding tax/fee status for the following property owner:

Property Owner: DAW ST. OUGE

Property Location: 62 MT DAW ROAD

The license/permit may be released.

The license/permit may not be released.

for Meghan Tuxen
Finance Director

9/27/03
Date

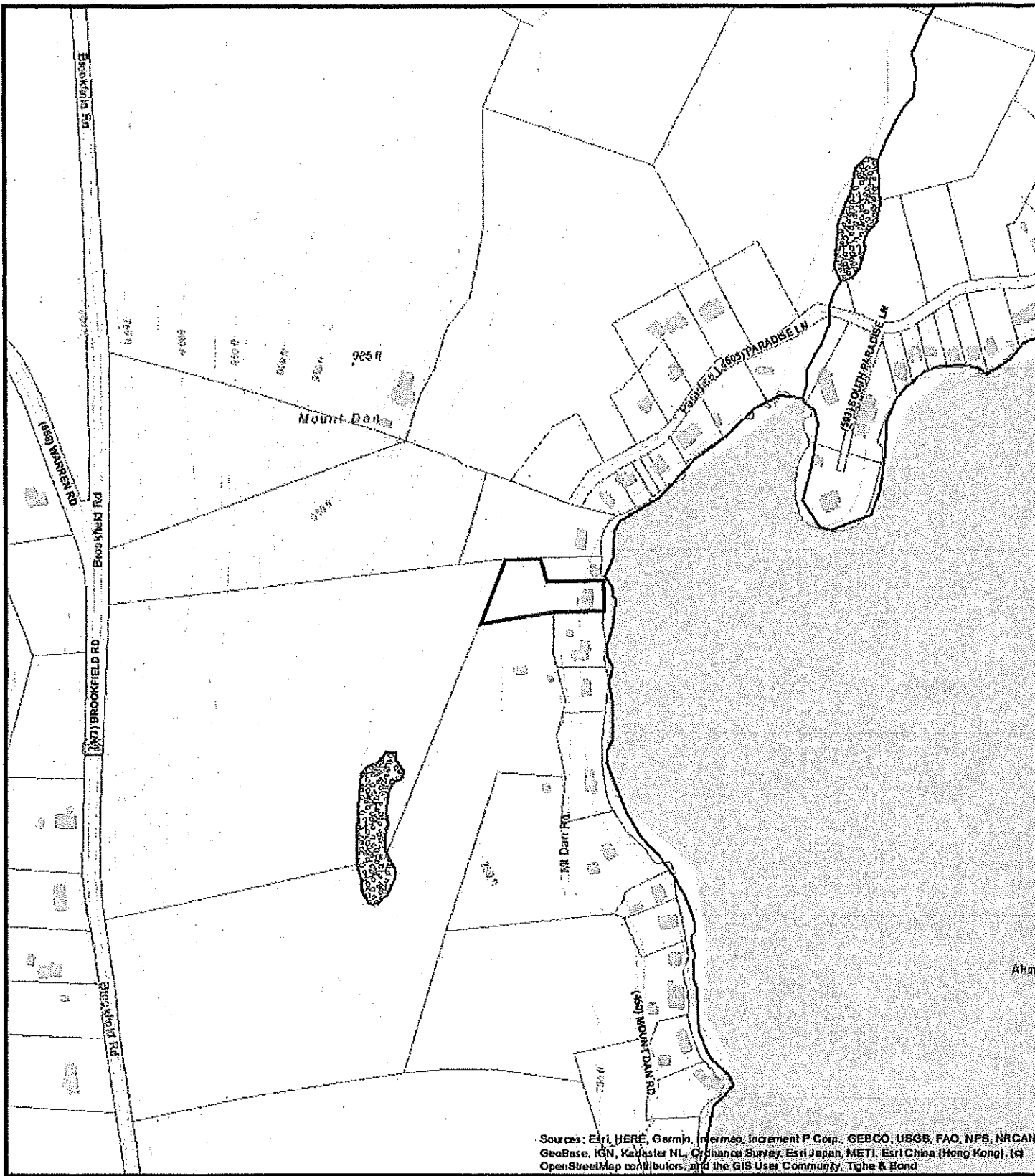

62 Mt. Dan Rd.

10/5/2023 11:19:37 AM

Scale: 1"=376'

Scale is approximate

The information depicted on this map is for planning purposes only. It is not adequate for legal boundary definition, regulatory interpretation, or parcel-level analyses.

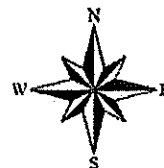



Proposed Project : Singular Cantilevered Dock

Project Location : 62 Mt. Dan Road on Big Alum Lake

Project Owner : Dan & Shannon St Onge

Notification: A Chapter 91 Simplified waterways license has been applied for and a Pre App number has been assigned by the Ma. DEP, it is 23-ww-PRE-0128 APP.

Project general description:

A single cantilevered dock 32' long x 8' wide. The main structure is made of steel I beams set in a concrete counterweight, this is the primary structure that supports the dock. The counterweight will be set behind and below the existing wall. When completed, the original surface conditions will be reconstructed and the counterweight will not be seen, no trees or plants will be removed to complete the project. The boulder next to the tree stump will remain as is, the short section of stone wall attached to the boulder will be removed to allow for the steel beam installation. The top two stone steps will be removed to allow for the steel beams and counterweight. The steel beams will be set in the concrete and pass over the remaining existing stone. The deck will be constructed of composite decking. All required erosion control methods including silt fence, straw wattle and hydraulic booms will be installed and inspected before construction begins. There will be a designated location on the property which all erosion control materials will be stored in addition to the installed materials incase any are needed. Work to commence during annual lake draw down.



Town of Sturbridge

Conservation Commission

Notification to Abutters

under the MA Wetlands Protection Act and the Town of Sturbridge Wetland Bylaw Regulations

In accordance with the second paragraph of Massachusetts General Laws, Chapter 131, § 40, as well as the Town of Sturbridge Wetland Bylaw, you are hereby notified of the following permit application for work within a wetland resource area and/or within the 200-foot buffer zone to a resource area:

- A. The name of the applicant is: DAN ST. ONGE
- B. The address of the lot(s) where the activity is proposed is: 62 MT DAN ROAD
- C. The nature of the activity proposed includes: CANTILEVERED DOCK
- D. The applicant has filed the following in accordance with the Wetlands Protection Act (MGL c. 131, § 40), and/or the Town of Sturbridge Wetland Bylaws.
- Notice of Intent seeking permission to conduct work within a wetland, water body or resource area
 - Request for Determination seeking permission to conduct work within a buffer zone to a wetland, waterbody or resource area
 - Abbreviated Notice of Resource Area Delineation seeking to confirm the wetland resource area boundaries.
 - Request to amend an existing Order of Conditions for DEP File #300-_____

**The Public Hearing for this application will be held in person and remotely via GoTo Meeting
at the Center Office Building, 301 Main Street, 2nd Floor**

Date and Time of Hearing: _____

Public Hearing can be accessed remotely:

- From your computer using: _____ or
- From your phone: +1 872 240 3212, followed by the access code _____

Please note that while an option for remote attendance and/or participation is being provided to the public, the meeting/hearing will not be suspended or terminated if technological problems interrupt the virtual broadcast, unless otherwise required by law. Members of the public with particular interest in any specific item on this agenda should make plans for in-person vs. virtual attendance accordingly. Please note that meetings can also be watched either online via the Town's on demand video broadcast or on cable television on channel 191, however, there is no public participation through these options.

PLEASE NOTE: Copies of the application and related materials including agendas and staff notes can be found here:

- <https://www.sturbridge.gov/conservation-commission/pages/meeting-calendar-and-documents>

You may contact the Sturbridge Conservation Commission Office (508) 347-2506 or the Department of Environmental Protection Central Regional Office at 508-792-7650 with questions in regards to the application process or the Wetlands Protection Act.

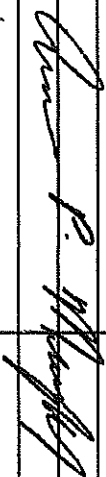
Parcel ID	Owner	Owner Address	Owner City	State	Zip	Property Address
450-00945-066	BUCHANAN JEFFREY D TR	66 MT DAN ROAD	FSKDALE	MA	01518	66 MT DAN ROAD
505-09E42-068	BUCHANAN JEFFREY D TRUSTEE	66 MT DAN ROAD	FSKDALE	MA	01518	68 PARADISE LANE
505-09E42-067	CRAWFORD NANCY B & CAROL A	1119 BROOKER HOLLOW RD	RICHMONDVILLE	NY	12149	67 PARADISE LANE
450-00945-060	FAXON THOMAS H	P O BOX 28	FSKDALE	MA	01518	60 MT DAN ROAD
173-00943-238	FAXON THOMAS H	P O BOX 28	FSKDALE	MA	01518	238 BROOKFIELD ROAD
450-00945-058	FAXON THOMAS K	58 MT DAN ROAD	FSKDALE	MA	01518	58 MT DAN ROAD
173-00943-258	FEARING JOHN L	64 PROSPECT HILL ROAD	BRIMFIELD	MA	01010	258 BROOKFIELD ROAD
173-00943-250	HORR MICHAEL J	1065 CREEKSIDE DRIVE	OGDEN	UT	84404	250 BROOKFIELD ROAD
450-00945-064	ST ONGE ELAINE R (LT)	39 RANDY LANE	WETHERSFIELD	CT	06109	64 MT DAN ROAD
	BOARD OF ASSESSORS					
Above persons listed are record owners as they appear on the most recent applicable tax list.						
Assessors are not responsible for errors or omissions. RE: M.G.L. - Chapter 40A, Section 11						
Abutters List -	Conservation Commission - 200'					
	RE: 62 MT DAN ROAD					
Certified Copy						
Assessor:						
Date:	9/28/2023					



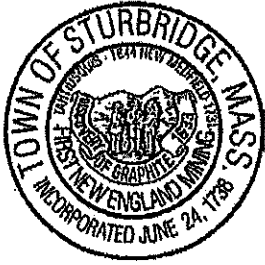

Town of Sturbridge

Barbara A. Barry, Finance Director

Department/Board/Committee: FINNANCE

Please verify outstanding tax/fee status for the following property owner:

Property Owner: DAW ST. OUGE

Property Location: 62 MT DAW ROAD

The license/permit may be released.

The license/permit may not be released.

for Meghan Turch
Finance Director

9/27/23
Date

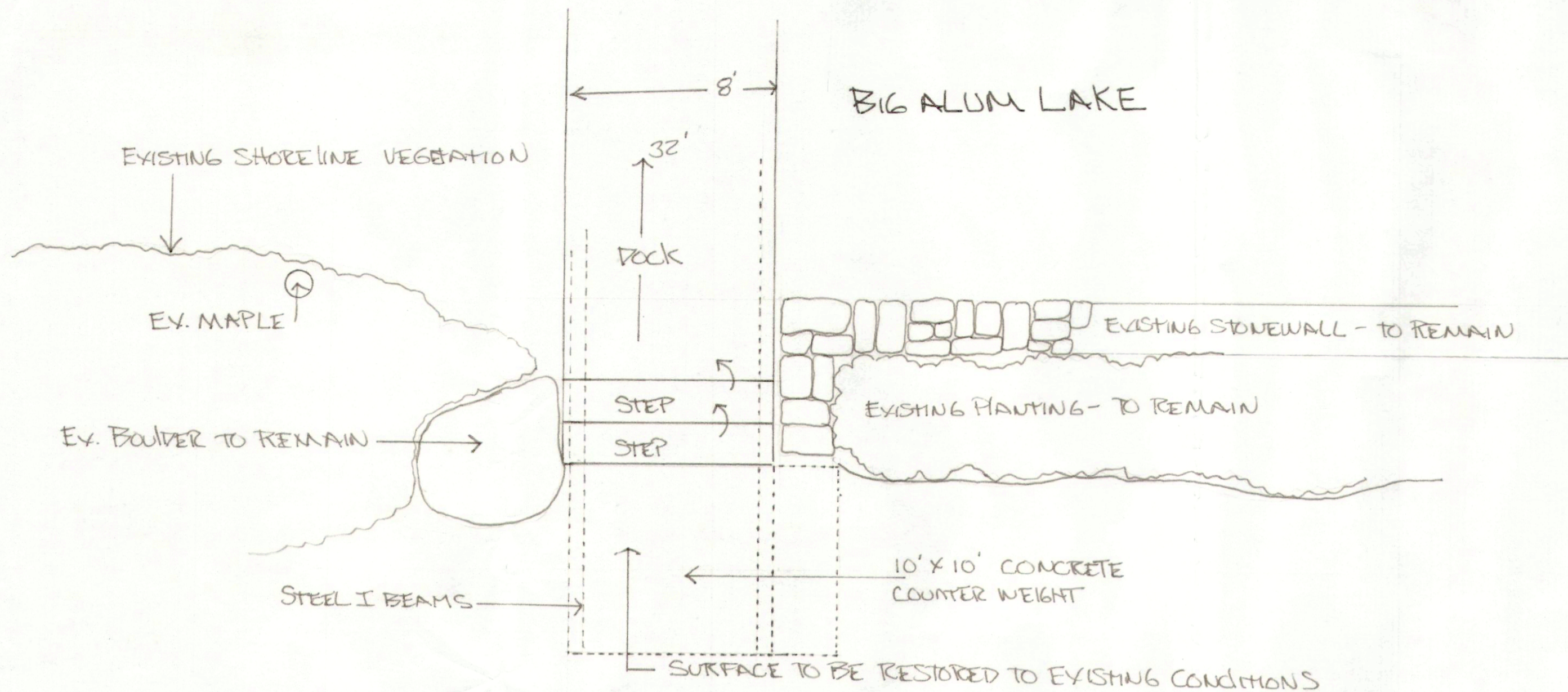

BEAM / COUNTERWEIGHT LAYOUT
SCALE 1/4" = 1'

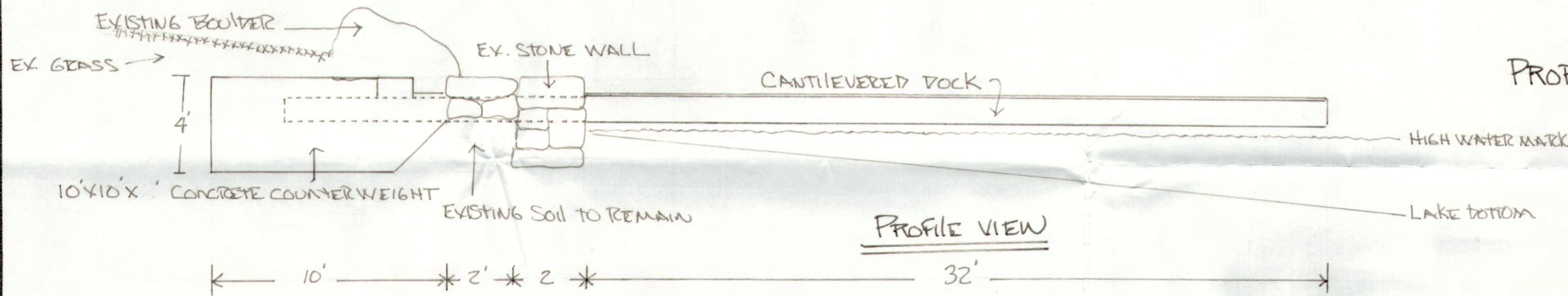

PROPOSED CANTILEVERED DOCK
SCALE 1/4" = 1'

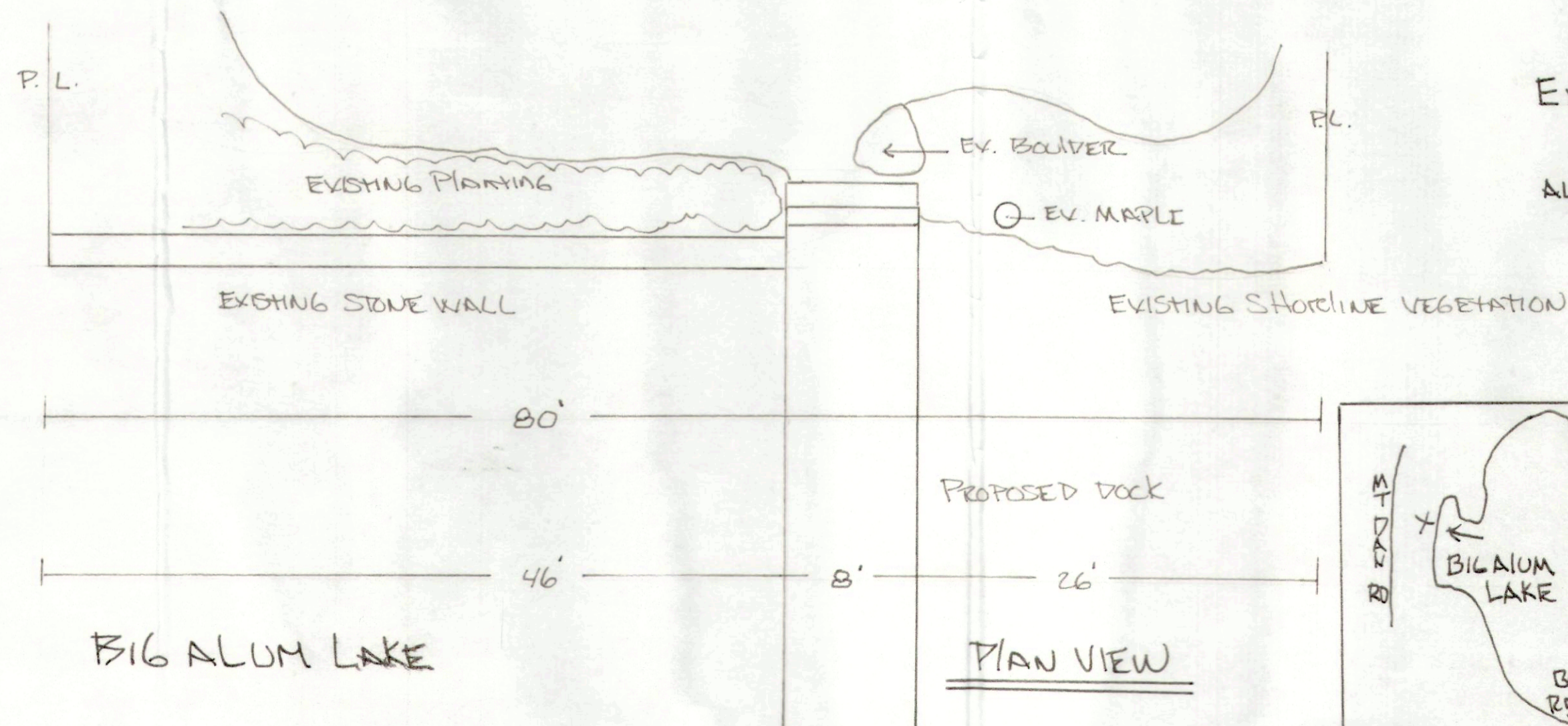

EXISTING CONDITIONS / PROPOSED DOCK
SCALE 1/8" = 1'
ALL TO REMAIN OR PUT BACK TO ORIGINAL STATE

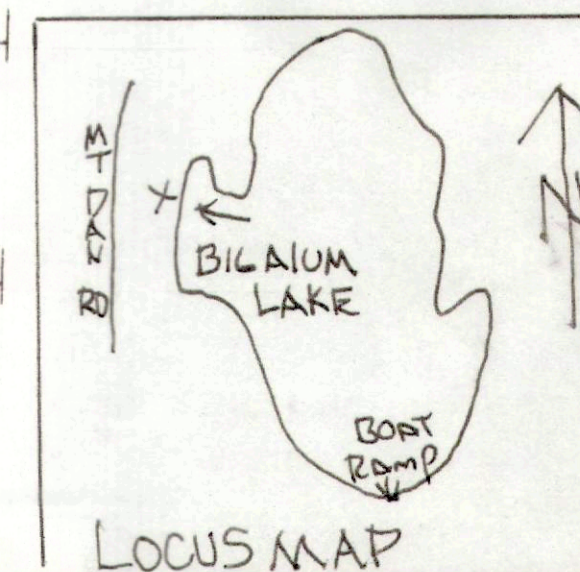

62 MTDAN ROAD ST. ONGE		APPROVED BY:	
SCALE: AS NOTED	DATE: 9-28-23	DRAWN BY: AMZ	REVISED:
CANTILEVERED DOCK PROPOSAL		DRAWING NUMBER	
GROUND EFFECTS LLC		L-P-1	