



Town of Sturbridge

Conservation Commission

Notice of Intent Application Checklist – Form B

Applicant / Property Owner MARA MUMHEIMER
Representative _____
Project Location 26 MOUNT DAN ROAD, STURBRIDGE
Assessor's Information Map _____
Date NOI filed with Conservation _____
Date NOI filed with MA DEP Central Region _____

- Complete most recent WPA Form 3 (Notice of Intent Application) and necessary attachments (2 copies)
- Plans and calculations clearly describing the location and nature of the work including all necessary Stormwater documents if applicable (2 copies)
- An 8.5 x 11 color section of the USGS Quadrangle (topo) identifying the locus and with a scale
- An 8.5 x 11 copy of the most recent Natural Heritage Map with WH, PH and VP data identifying the locus and with a scale
- An 8.5 x 11 copy of the FIRM Map identifying the locus and with a scale
- Confirmation that a copy of the NOI was sent to NHESP (if applicable)
- Copy of the Certified Abutters List (to include all abutters within 200-feet of the subject property) and a copy of the completed Abutter Certification Form
- Signed Affidavit of Service for Abutter Notification
- Completed Local Filing Fee Worksheet and NOI Wetland Transmittal Form
- Filing fee checks, one of the town's portion of the state fee and one for the local fee – both made out to the Town of Sturbridge (See Local Filing Fee Worksheet)
- Copy of State filing fee check made out to the Commonwealth of MA (1 copy)
- Tax Form signed by the Sturbridge Tax Collector, notifying the Conservation Commission that the property taxes are paid-to-date (1 copy)
- Confirmation that a copy of the NOI was sent to DEP

This Check list is to be filled out and submitted to the Sturbridge Conservation Commission at the time of filing the Notice of Intent Application.

Please contact me if you have any questions (508)-347-2506 or via email at rgendreau@town.sturbridge.ma.us.

Conservation Agent

Town Hall
308 Main Street
Sturbridge, MA 01566

508-347-2506
(F) 508-347-5886



Massachusetts Department of Environmental Protection
 Bureau of Resource Protection - Wetlands

Provided by MassDEP:

WPA Form 3 – Notice of Intent

Massachusetts Wetlands Protection Act M.G.L. c. 131, §40

MassDEP File Number

Document Transaction Number

City/Town

Important:
 When filling out forms on the computer, use only the tab key to move your cursor - do not use the return key.



Note:
 Before completing this form consult your local Conservation Commission regarding any municipal bylaw or ordinance.

A. General Information

1. Project Location (**Note:** electronic filers will click on button to locate project site):

26 MT. DAN ROAD STURBRIDGE 01566
 a. Street Address b. City/Town c. Zip Code

Latitude and Longitude:

450-01415-026
 d. Latitude e. Longitude
 f. Assessors Map/Plat Number g. Parcel /Lot Number

2. Applicant:

Evan Silverberg
 a. First Name b. Last Name

43 Pine Meadow Ln
 c. Organization

Sturbridge
 d. Street Address

MA 01566
 e. City/Town f. State g. Zip Code

774-200-4881 evansilverberg2013@icloud.com
 h. Phone Number i. Fax Number j. Email Address

3. Property owner (required if different from applicant): Check if more than one owner

MARK NUNHEIMER
 a. First Name b. Last Name

45 JOHN MYRICK CIRCLE
 c. Organization

BREWSTER
 d. Street Address

MASS 02631
 e. City/Town f. State g. Zip Code

h. Phone Number i. Fax Number j. Email address

4. Representative (if any):

Evan Silverberg
 a. First Name b. Last Name

43 Pine Meadow Ln
 c. Company

Sturbridge
 d. Street Address

MA 01566
 e. City/Town f. State g. Zip Code

774-200-4881 evansilverberg2013@icloud.com
 h. Phone Number i. Fax Number j. Email address

5. Total WPA Fee Paid (from NOI Wetland Fee Transmittal Form):

37.50 62.50 50.00
 a. Total Fee Paid b. State Fee Paid c. City/Town Fee Paid

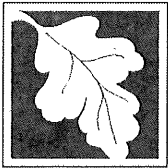

WPA Form 3 – Notice of Intent

Massachusetts Wetlands Protection Act M.G.L. c. 131, §40

MassDEP File Number

Document Transaction Number

City/Town

A. General Information (continued)

6. General Project Description:

STONE WALL REPAIR

7a. Project Type Checklist: (Limited Project Types see Section A. 7b.)

- | | |
|---|---|
| 1. <input type="checkbox"/> Single Family Home | 2. <input type="checkbox"/> Residential Subdivision |
| 3. <input type="checkbox"/> Commercial/Industrial | 4. <input checked="" type="checkbox"/> Dock/Pier |
| 5. <input type="checkbox"/> Utilities | 6. <input type="checkbox"/> Coastal engineering Structure |
| 7. <input type="checkbox"/> Agriculture (e.g., cranberries, forestry) | 8. <input type="checkbox"/> Transportation |
| 9. <input type="checkbox"/> Other | |

7b. Is any portion of the proposed activity eligible to be treated as a limited project (including Ecological Restoration Limited Project) subject to 310 CMR 10.24 (coastal) or 310 CMR 10.53 (inland)?

1. Yes No If yes, describe which limited project applies to this project. (See 310 CMR 10.24 and 10.53 for a complete list and description of limited project types)

2. Limited Project Type

If the proposed activity is eligible to be treated as an Ecological Restoration Limited Project (310 CMR 10.24(8), 310 CMR 10.53(4)), complete and attach Appendix A: Ecological Restoration Limited Project Checklist and Signed Certification.

8. Property recorded at the Registry of Deeds for:

Worcester

a. County

b. Certificate # (if registered land)

c. Book

d. Page Number

B. Buffer Zone & Resource Area Impacts (temporary & permanent)

- Buffer Zone Only – Check if the project is located only in the Buffer Zone of a Bordering Vegetated Wetland, Inland Bank, or Coastal Resource Area.
- Inland Resource Areas (see 310 CMR 10.54-10.58; if not applicable, go to Section B.3, Coastal Resource Areas).

Check all that apply below. Attach narrative and any supporting documentation describing how the project will meet all performance standards for each of the resource areas altered, including standards requiring consideration of alternative project design or location.



Massachusetts Department of Environmental Protection
 Bureau of Resource Protection - Wetlands

WPA Form 3 – Notice of Intent

Massachusetts Wetlands Protection Act M.G.L. c. 131, §40

Provided by MassDEP:

MassDEP File Number _____

Document Transaction Number _____

City/Town _____

B. Buffer Zone & Resource Area Impacts (temporary & permanent) (cont'd)

For all projects affecting other Resource Areas, please attach a narrative explaining how the resource area was delineated.

Resource Area	Size of Proposed Alteration	Proposed Replacement (if any)
a. <input checked="" type="checkbox"/> Bank	<u>15</u> 1. linear feet	<u>15</u> 2. linear feet
b. <input type="checkbox"/> Bordering Vegetated Wetland	1. square feet	2. square feet
c. <input type="checkbox"/> Land Under Waterbodies and Waterways	1. square feet 3. cubic yards dredged	2. square feet

Resource Area	Size of Proposed Alteration	Proposed Replacement (if any)
d. <input type="checkbox"/> Bordering Land Subject to Flooding	1. square feet 3. cubic feet of flood storage lost	2. square feet 4. cubic feet replaced
e. <input type="checkbox"/> Isolated Land Subject to Flooding	1. square feet 2. cubic feet of flood storage lost	3. cubic feet replaced
f. <input type="checkbox"/> Riverfront Area	1. Name of Waterway (if available)	

2. Width of Riverfront Area (check one):

- 25 ft. - Designated Densely Developed Areas only
- 100 ft. - New agricultural projects only
- 200 ft. - All other projects

3. Total area of Riverfront Area on the site of the proposed project: _____ square feet

4. Proposed alteration of the Riverfront Area:

a. total square feet _____ b. square feet within 100 ft. _____ c. square feet between 100 ft. and 200 ft. _____

5. Has an alternatives analysis been done and is it attached to this NOI? Yes No

6. Was the lot where the activity is proposed created prior to August 1, 1996? Yes No

3. Coastal Resource Areas: (See 310 CMR 10.25-10.35)

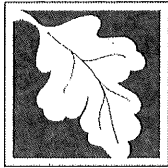

Massachusetts Department of Environmental Protection
 Bureau of Resource Protection - Wetlands

WPA Form 3 – Notice of Intent

Massachusetts Wetlands Protection Act M.G.L. c. 131, §40

Provided by MassDEP:

 MassDEP File Number

 Document Transaction Number

 City/Town

B. Buffer Zone & Resource Area Impacts (temporary & permanent) (cont'd)

Check all that apply below. Attach narrative and supporting documentation describing how the project will meet all performance standards for each of the resource areas altered, including standards requiring consideration of alternative project design or location.

Online Users:
 Include your document transaction number (provided on your receipt page) with all supplementary information you submit to the Department.

<u>Resource Area</u>	<u>Size of Proposed Alteration</u>	<u>Proposed Replacement (if any)</u>
a. <input type="checkbox"/> Designated Port Areas	Indicate size under Land Under the Ocean, below	
b. <input type="checkbox"/> Land Under the Ocean	_____ 1. square feet	
	_____ 2. cubic yards dredged	
c. <input type="checkbox"/> Barrier Beach	Indicate size under Coastal Beaches and/or Coastal Dunes below	
d. <input type="checkbox"/> Coastal Beaches	_____ 1. square feet	_____ 2. cubic yards beach nourishment
e. <input type="checkbox"/> Coastal Dunes	_____ 1. square feet	_____ 2. cubic yards dune nourishment
	<u>Size of Proposed Alteration</u>	<u>Proposed Replacement (if any)</u>
f. <input type="checkbox"/> Coastal Banks	_____ 1. linear feet	
g. <input type="checkbox"/> Rocky Intertidal Shores	_____ 1. square feet	
h. <input type="checkbox"/> Salt Marshes	_____ 1. square feet	_____ 2. sq ft restoration, rehab., creation
i. <input type="checkbox"/> Land Under Salt Ponds	_____ 1. square feet	
	_____ 2. cubic yards dredged	
j. <input type="checkbox"/> Land Containing Shellfish	_____ 1. square feet	
k. <input type="checkbox"/> Fish Runs	Indicate size under Coastal Banks, inland Bank, Land Under the Ocean, and/or inland Land Under Waterbodies and Waterways, above	
	_____ 1. cubic yards dredged	
l. <input type="checkbox"/> Land Subject to Coastal Storm Flowage	_____ 1. square feet	
4. <input type="checkbox"/> Restoration/Enhancement	If the project is for the purpose of restoring or enhancing a wetland resource area in addition to the square footage that has been entered in Section B.2.b or B.3.h above, please enter the additional amount here.	
	_____ a. square feet of BVW	_____ b. square feet of Salt Marsh
5. <input type="checkbox"/> Project Involves Stream Crossings		
	_____ a. number of new stream crossings	_____ b. number of replacement stream crossings



WPA Form 3 – Notice of Intent

Massachusetts Wetlands Protection Act M.G.L. c. 131, §40

Provided by MassDEP:

MassDEP File Number _____

Document Transaction Number _____

City/Town _____

C. Other Applicable Standards and Requirements

- This is a proposal for an Ecological Restoration Limited Project. Skip Section C and complete Appendix A: Ecological Restoration Notice of Intent – Required Actions (310 CMR 10.11).

Streamlined Massachusetts Endangered Species Act/Wetlands Protection Act Review

1. Is any portion of the proposed project located in **Estimated Habitat of Rare Wildlife** as indicated on the most recent Estimated Habitat Map of State-Listed Rare Wetland Wildlife published by the Natural Heritage and Endangered Species Program (NHESP)? To view habitat maps, see the *Massachusetts Natural Heritage Atlas* or go to http://www.mass.gov/dfwele/dfw/nhosp/regulatory_review/priority_habitat/online_viewer.htm.

- a. Yes No **If yes, include proof of mailing or hand delivery of NOI to:**

**Natural Heritage and Endangered Species Program
Division of Fisheries and Wildlife
1 Rabbit Hill Road
Westborough, MA 01581**

- b. Date of map _____

If yes, the project is also subject to Massachusetts Endangered Species Act (MESA) review (321 CMR 10.18). To qualify for a streamlined, 30-day, MESA/Wetlands Protection Act review, please complete Section C.1.C, and include requested materials with this Notice of Intent (NOI); OR complete Section C.1.d, if applicable. *If MESA supplemental information is not included with the NOI, by completing Section 1 of this form, the NHESP will require a separate MESA filing which may take up to 90 days to review (unless noted exceptions in Section 2 apply, see below).*

1c. Submit Supplemental Information for Endangered Species Review*

1. Percentage/acreage of property to be altered:

(a) within wetland Resource Area _____
percentage/acreage

(b) outside Resource Area _____
percentage/acreage

2. Assessor's Map or right-of-way plan of site

2. Project plans for entire project site, including wetland resource areas and areas outside of wetlands jurisdiction, showing existing and proposed conditions, existing and proposed tree/vegetation clearing line, and clearly demarcated limits of work **

(a) Project description (including description of impacts outside of wetland resource area & buffer zone)

(b) Photographs representative of the site

* Some projects **not** in Estimated Habitat may be located in Priority Habitat, and require NHESP review (see <http://www.mass.gov/dfwele/dfw/nhosp/nhosp.htm>, regulatory review tab). Priority Habitat includes habitat for state-listed plants and strictly upland species not protected by the Wetlands Protection Act.

** MESA projects may not be segmented (321 CMR 10.16). The applicant must disclose full development plans even if such plans are not required as part of the Notice of Intent process.



WPA Form 3 – Notice of Intent

Massachusetts Wetlands Protection Act M.G.L. c. 131, §40

MassDEP File Number _____

Document Transaction Number _____

City/Town _____

C. Other Applicable Standards and Requirements (cont'd)

(c) MESA filing fee (fee information available at http://www.mass.gov/dfwele/dfw/nhesp/regulatory_review/ mesa/ mesa_fee_schedule.htm). Make check payable to "Commonwealth of Massachusetts - NHESP" and **mail to NHESP** at above address

Projects altering 10 or more acres of land, also submit:

(d) Vegetation cover type map of site

(e) Project plans showing Priority & Estimated Habitat boundaries

(f) OR Check One of the Following

1. Project is exempt from MESA review.
Attach applicant letter indicating which MESA exemption applies. (See 321 CMR 10.14, http://www.mass.gov/dfwele/dfw/nhesp/regulatory_review/ mesa/ mesa_exemptions.htm; the NOI must still be sent to NHESP if the project is within estimated habitat pursuant to 310 CMR 10.37 and 10.59.)

2. Separate MESA review ongoing. a. NHESP Tracking # _____ b. Date submitted to NHESP _____

3. Separate MESA review completed.
Include copy of NHESP "no Take" determination or valid Conservation & Management Permit with approved plan.

3. For coastal projects only, is any portion of the proposed project located below the mean high water line or in a fish run?

a. Not applicable – project is in inland resource area only

b. Yes No If yes, include proof of mailing or hand delivery of NOI to either:

South Shore - Cohasset to Rhode Island, and the Cape & Islands:

North Shore - Hull to New Hampshire:

Division of Marine Fisheries -
Southeast Marine Fisheries Station
Attn: Environmental Reviewer
1213 Purchase Street – 3rd Floor
New Bedford, MA 02740-6694

Division of Marine Fisheries -
North Shore Office
Attn: Environmental Reviewer
30 Emerson Avenue
Gloucester, MA 01930

Also if yes, the project may require a Chapter 91 license. For coastal towns in the Northeast Region, please contact MassDEP's Boston Office. For coastal towns in the Southeast Region, please contact MassDEP's Southeast Regional Office.



Massachusetts Department of Environmental Protection
 Bureau of Resource Protection - Wetlands
WPA Form 3 – Notice of Intent
 Massachusetts Wetlands Protection Act M.G.L. c. 131, §40

Provided by MassDEP:

MassDEP File Number

Document Transaction Number

City/Town

C. Other Applicable Standards and Requirements (cont'd)

Online Users:
 Include your document transaction number (provided on your receipt page) with all supplementary information you submit to the Department.

4. Is any portion of the proposed project within an Area of Critical Environmental Concern (ACEC)?
 a. Yes No If yes, provide name of ACEC (see instructions to WPA Form 3 or MassDEP Website for ACEC locations). **Note:** electronic filers click on Website.
 b. ACEC _____
5. Is any portion of the proposed project within an area designated as an Outstanding Resource Water (ORW) as designated in the Massachusetts Surface Water Quality Standards, 314 CMR 4.00?
 a. Yes No
6. Is any portion of the site subject to a Wetlands Restriction Order under the Inland Wetlands Restriction Act (M.G.L. c. 131, § 40A) or the Coastal Wetlands Restriction Act (M.G.L. c. 130, § 105)?
 a. Yes No
7. Is this project subject to provisions of the MassDEP Stormwater Management Standards?
 a. Yes. Attach a copy of the Stormwater Report as required by the Stormwater Management Standards per 310 CMR 10.05(6)(k)-(q) and check if:
 1. Applying for Low Impact Development (LID) site design credits (as described in Stormwater Management Handbook Vol. 2, Chapter 3)
 2. A portion of the site constitutes redevelopment
 3. Proprietary BMPs are included in the Stormwater Management System.
 b. No. Check why the project is exempt:
 1. Single-family house
 2. Emergency road repair
 3. Small Residential Subdivision (less than or equal to 4 single-family houses or less than or equal to 4 units in multi-family housing project) with no discharge to Critical Areas.

D. Additional Information

- This is a proposal for an Ecological Restoration Limited Project. Skip Section D and complete Appendix A: Ecological Restoration Notice of Intent – Minimum Required Documents (310 CMR 10.12).

Applicants must include the following with this Notice of Intent (NOI). See instructions for details.

Online Users: Attach the document transaction number (provided on your receipt page) for any of the following information you submit to the Department.

1. USGS or other map of the area (along with a narrative description, if necessary) containing sufficient information for the Conservation Commission and the Department to locate the site. (Electronic filers may omit this item.)
2. Plans identifying the location of proposed activities (including activities proposed to serve as a Bordering Vegetated Wetland [BVW] replication area or other mitigating measure) relative to the boundaries of each affected resource area.



WPA Form 3 – Notice of Intent

Massachusetts Wetlands Protection Act M.G.L. c. 131, §40

MassDEP File Number

Document Transaction Number

City/Town

D. Additional Information (cont'd)

3. Identify the method for BVW and other resource area boundary delineations (MassDEP BVW Field Data Form(s), Determination of Applicability, Order of Resource Area Delineation, etc.), and attach documentation of the methodology.

4. List the titles and dates for all plans and other materials submitted with this NOI.

a. Plan Title

b. Prepared By

c. Signed and Stamped by

d. Final Revision Date

e. Scale

f. Additional Plan or Document Title

g. Date

5. If there is more than one property owner, please attach a list of these property owners not listed on this form.

6. Attach proof of mailing for Natural Heritage and Endangered Species Program, if needed.

7. Attach proof of mailing for Massachusetts Division of Marine Fisheries, if needed.

8. Attach NOI Wetland Fee Transmittal Form

9. Attach Stormwater Report, if needed.

E. Fees

1. Fee Exempt: No filing fee shall be assessed for projects of any city, town, county, or district of the Commonwealth, federally recognized Indian tribe housing authority, municipal housing authority, or the Massachusetts Bay Transportation Authority.

Applicants must submit the following information (in addition to pages 1 and 2 of the NOI Wetland Fee Transmittal Form) to confirm fee payment:

2. Municipal Check Number

3. Check date

4. State Check Number

5. Check date

6. Payor name on check: First Name

7. Payor name on check: Last Name

3933

10/11/2020

3932

10/11/2020

Evan

Silverberg



WPA Form 3 – Notice of Intent

Massachusetts Wetlands Protection Act M.G.L. c. 131, §40

Provided by MassDEP:

MassDEP File Number

Document Transaction Number

City/Town

F. Signatures and Submittal Requirements

I hereby certify under the penalties of perjury that the foregoing Notice of Intent and accompanying plans, documents, and supporting data are true and complete to the best of my knowledge. I understand that the Conservation Commission will place notification of this Notice in a local newspaper at the expense of the applicant in accordance with the wetlands regulations, 310 CMR 10.05(5)(a).

I further certify under penalties of perjury that all abutters were notified of this application, pursuant to the requirements of M.G.L. c. 131, § 40. Notice must be made by Certificate of Mailing or in writing by hand delivery or certified mail (return receipt requested) to all abutters within 100 feet of the property line of the project location.

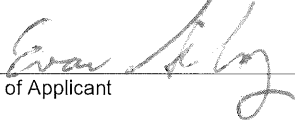
	<i>10/1/2020</i>
1. Signature of Applicant	2. Date
3. Signature of Property Owner (if different)	4. Date
5. Signature of Representative (if any)	6. Date

For Conservation Commission:

Two copies of the completed Notice of Intent (Form 3), including supporting plans and documents, two copies of the NOI Wetland Fee Transmittal Form, and the city/town fee payment, to the Conservation Commission by certified mail or hand delivery.

For MassDEP:

One copy of the completed Notice of Intent (Form 3), including supporting plans and documents, one copy of the NOI Wetland Fee Transmittal Form, and a **copy** of the state fee payment to the MassDEP Regional Office (see Instructions) by certified mail or hand delivery.

Other:

If the applicant has checked the "yes" box in any part of Section C, Item 3, above, refer to that section and the Instructions for additional submittal requirements.

The original and copies must be sent simultaneously. Failure by the applicant to send copies in a timely manner may result in dismissal of the Notice of Intent.



Massachusetts Department of Environmental Protection
 Bureau of Resource Protection - Wetlands
NOI Wetland Fee Transmittal Form
 Massachusetts Wetlands Protection Act M.G.L. c. 131, §40

Important: When filling out forms on the computer, use only the tab key to move your cursor - do not use the return key.



A. Applicant Information

1. Location of Project:

26 MOUNT DAN ROAD STURBRIDGE
 a. Street Address b. City/Town

c. Check number d. Fee amount

2. Applicant Mailing Address:

MARA MUNHEIMER
 a. First Name b. Last Name

OWNER
 c. Organization

45 SOUTH MYRICK CIRCLE
 d. Mailing Address

BREWSTER MASS 02631
 e. City/Town f. State g. Zip Code

h. Phone Number i. Fax Number j. Email Address

3. Property Owner (if different):

a. First Name b. Last Name

c. Organization

d. Mailing Address

e. City/Town f. State g. Zip Code

h. Phone Number i. Fax Number j. Email Address

B. Fees

Fee should be calculated using the following process & worksheet. **Please see Instructions before filling out worksheet.**

Step 1/Type of Activity: Describe each type of activity that will occur in wetland resource area and buffer zone.

Step 2/Number of Activities: Identify the number of each type of activity.

Step 3/Individual Activity Fee: Identify each activity fee from the six project categories listed in the instructions.

Step 4/Subtotal Activity Fee: Multiply the number of activities (identified in Step 2) times the fee per category (identified in Step 3) to reach a subtotal fee amount. Note: If any of these activities are in a Riverfront Area in addition to another Resource Area or the Buffer Zone, the fee per activity should be multiplied by 1.5 and then added to the subtotal amount.

Step 5/Total Project Fee: Determine the total project fee by adding the subtotal amounts from Step 4.

Step 6/Fee Payments: To calculate the state share of the fee, divide the total fee in half and subtract \$12.50. To calculate the city/town share of the fee, divide the total fee in half and add \$12.50.

To calculate filing fees, refer to the category fee list and examples in the instructions for filling out WPA Form 3 (Notice of Intent).

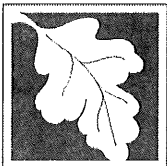

Massachusetts Department of Environmental Protection
 Bureau of Resource Protection - Wetlands
NOI Wetland Fee Transmittal Form
 Massachusetts Wetlands Protection Act M.G.L. c. 131, §40

B. Fees (continued)

Step 1/Type of Activity	Step 2/Number of Activities	Step 3/Individual Activity Fee	Step 4/Subtotal Activity Fee
Ret wall on shore	1	4x 15	(860) \$100

Step 5/Total Project Fee: \$100

Step 6/Fee Payments:

DEP
STURD

Total Project Fee: \$100

a. Total Fee from Step 5

- State share of filing Fee: 37.50

b. 1/2 Total Fee less \$12.50

City/Town share of filling Fee: \$62.50

c. 1/2 Total Fee plus \$12.50

C. Submittal Requirements

a.) Complete pages 1 and 2 and send with a check or money order for the state share of the fee, payable to the Commonwealth of Massachusetts.

Department of Environmental Protection
 Box 4062
 Boston, MA 02211

b.) **To the Conservation Commission:** Send the Notice of Intent or Abbreviated Notice of Intent; a **copy** of this form; and the city/town fee payment.

To MassDEP Regional Office (see Instructions): Send a copy of the Notice of Intent or Abbreviated Notice of Intent; a **copy** of this form; and a **copy** of the state fee payment. (E-filers of Notices of Intent may submit these electronically.)

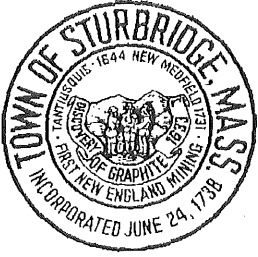

Town of Sturbridge

Conservation Commission

Filing Fee Worksheet

Under M.G.L. c 131, § 40 and the Town of Sturbridge Wetland Bylaw

Applicant MAIR MUNDI MAIR

Applicant Representative _____

Project location 26 MOUNT DAM ROAD STURBRIDGE

TOTAL STATE FEE REQUIRED FOR PROJECT

(Only subject to NOI and ANRAD filings—See Wetland Fee Transmittal Form):

State Fee Category(s) 100

Total State Fee for project (include Riverfront Area adjustment if applicable) 100

State share of State Fee 37.50

Local share of State Fee 62.50

TOTAL ADDITIONAL LOCAL FEE REQUIRED FOR PROJECT*:

(See Sturbridge Wetland Bylaw Regulations Section 4.17)

Standard NOI Fee = 50.00 ✓ (check if applicable) 50 - STURBRIDGE

Standard RDA Fee = \$25.00 _____ (check if applicable)

Standard ANRAD Fee = \$00.10 per foot for resource area delineation _____ (check if applicable).
feet _____ x \$00.10 = \$ _____

Standard DELINEATION Fee = \$00.10 per foot for resource area delineation _____ (for all projects).
feet _____ x \$00.10 = \$ _____

(for all projects that do not include an approved wetland delineation boundary by the Commission within 3 years prior to application submittal)

REPLICATION Monitoring Fee = \$200.00 _____ (check if applicable)
(for all projects that include wetland alteration and wetland replication)

CUMULATIVE TOTAL FEES:

Total State Fee: 37.50 DEP

Total Town Share of State Fee: 62.50 TOWN

Total Local Fee: 50.00 Sturbridge 2 CHKS

*Please Note:

For each NOI and ANRAD filing, please submit two (2) checks to the Town of Sturbridge, one for the town's portion of the state fee and one for the local fee(s). RDA filings only have a Local Fee at this time.

The advertising fee is not included in the calculation. The Applicant will pay the Southbridge News directly.

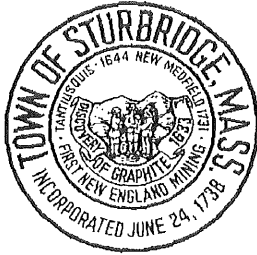

Town of Sturbridge

Conservation Commission

STURBRIDGE CONSERVATION COMMISSION AFFIDAVIT OF SERVICE

Under the Massachusetts Wetlands Protection Act and the Town of Sturbridge Wetland Bylaws I, _____, hereby certify under the pains and penalties of perjury that on (date) _____, I gave notification to abutters in compliance with the second paragraph of the Massachusetts General Laws Chapter 131, § 40, and the DEP Guide to Abutter Notification as well as the Town of Sturbridge Wetland Bylaws, in connection with the following matter:

- A Notice of Intent OR
- A Request for Determination OR
- An Abbreviated Notice of Resource Area Delineation

that was filed under the Massachusetts Wetlands Protection Act and the Town of Sturbridge Bylaws, by _____ with the Sturbridge Conservation Commission on (date) _____ for the property located at _____.

The form of the Notification and a list of abutters to whom it was given and their addresses are included in the application file.

(signature of applicant) (date)

(name of applicant-printed or typed)

ASSESSOR - ABOTTERS LIST
- labels
- cert of mail

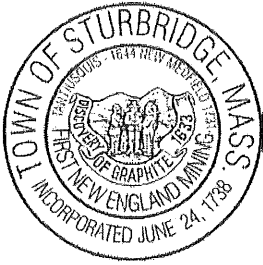

Town of Sturbridge

Barbara A. Barry, Finance Director

Department/Board/Committee: Conservation

Please verify outstanding tax/fee status for the following property owner:

Property Owner: MARK NUPHEIMER

Property Location: 26 MOUNT DAN ROAD

STURBRIDGE

The license/permit may be released.

The license/permit may not be released.

Barbara A. Barry
For the Finance Director

10/01/2020
Date

MARIA RUNHEIMER
26 MT DAN ROAD
BIG ALUM LAKE

35' OF STONE WALL TO BE REPOINTED

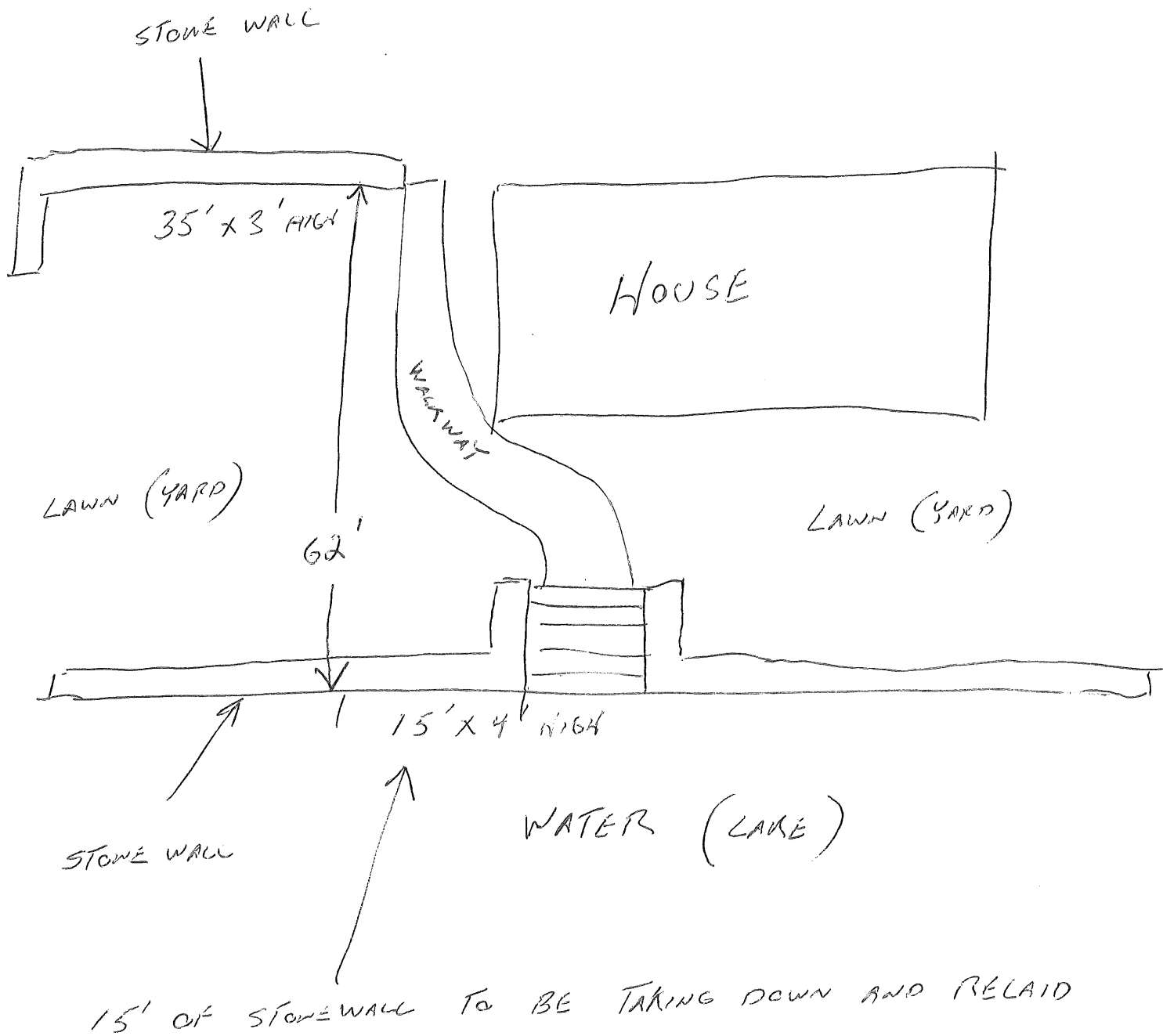



Town of Sturbridge

Conservation Commission

Notification to Abutters under the MA Wetlands Protection Act and the Town of Sturbridge Wetland Bylaw Regulations

(certificates of mailing, certified mail, or hand-delivery with abutter signature required as proof of notification)

In accordance with the second paragraph of Massachusetts General Laws, Chapter 131, § 40, as well as the Town of Sturbridge Wetland Bylaws, you are hereby notified of the following permit application for work within a wetland resource area and/or within the 200-foot buffer zone to a resource area:

- A. The name of the applicant is: Evan Silverburg
- B. The address of the lot(s) where the activity is proposed is: 26 MP Dan Road
- C. The nature of the activity proposed includes: Retain Wall Repair/Replace
- D. The applicant has filed the following in accordance with the Wetlands Protection Act (MGL c. 131, § 40), and/or the Town of Sturbridge Wetland Bylaws.
- Notice of Intent seeking permission to conduct work within a wetland, water body or resource area
- Request for Determination seeking permission to conduct work within a buffer zone to a wetland, waterbody or resource area
- Abbreviated Notice of Resource Area Delineation seeking to confirm the wetland resource area boundaries.
- Request to amend an existing Order of Conditions for DEP File #300-_____
- E. Copies of the application may be examined on the Sturbridge Conservation Commission webpage under Recent Filings on the Town of Sturbridge Website www.sturbridge.gov. For additional questions regarding availability contact us at (508)347-2506
- F. Copies of the application may be obtained from either the applicant: _____ or the applicant's representative: _____, by calling telephone # 774 200 4851 on the following days of the week: M-F between the hours of 10am and 2pm

The Public Hearing for this application will be held virtually from Sturbridge Town Hall, Veterans Hall, 308 Main Street, 2nd Floor on OCT 20 at 7:00 pm.

Pursuant to Governor Baker's March 12, 2020 Order Suspending Certain Provisions of the Open Meeting law, G.L. c. 30A Section 18, and the Governor's March 15, 2020 Order imposing strict limitations on the number people that may gather in one place, this meeting of the Sturbridge Conservation Commission will be conducted via remote participation to the greatest extent possible. Specific information and the general guidelines for remote participation can be found on the Town's website at <https://www.sturbridge.gov/town-administrator/pages/how-access-virtual-meeting>. For this meeting, members of the public who wish to listen and or watch the meeting may do so either online via the Town's on demand video broadcast, on cable television on channel 191, or dial into the meeting at 774-304-1455, enter 1428# for the meeting number and 12345 for the access code. (This phone number is only active for the public during public meetings). No in-person attendance of members of the public will be permitted, but every effort will be made to ensure that the public can adequately access the proceedings in real time, via technological means. In the event that we are unable to do so, despite best efforts, we will post of the Town's website an audio or video recording, transcript, or other comprehensive record of the proceedings as soon as possible after the meeting.

PLEASE NOTE: Notice of this Public Hearing will be published as follows:

- In The Southbridge Evening News at least five days in advance of the hearing
- In the Town Hall at the Town Clerks office, not less than 48 hours in advance of the hearing
- On the Town's Meeting Calendar not less than 48 hours in advance of the hearing (www.town.sturbridge.ma.us)
- On the Conservation Commission webpage not less than 48 hours in advance of the hearing

You may contact the Sturbridge Conservation Commission Office (508) 347-2506 or the Department of Environmental Protection Central Regional Office at 508-792-7650 with questions in regards to the Notice of Intent application process or the Wetlands Protection Act.

Town Hall
308 Main Street
Sturbridge, MA 01566

508-347-2506
(f) 508-347-5886