



Store #222  
400 Route 15  
Sturbridge, MA 01566

Permit Drawing  
04.24.20  
E.0



# SITE LAYOUT | ARCHITECTURAL PLANVIEW

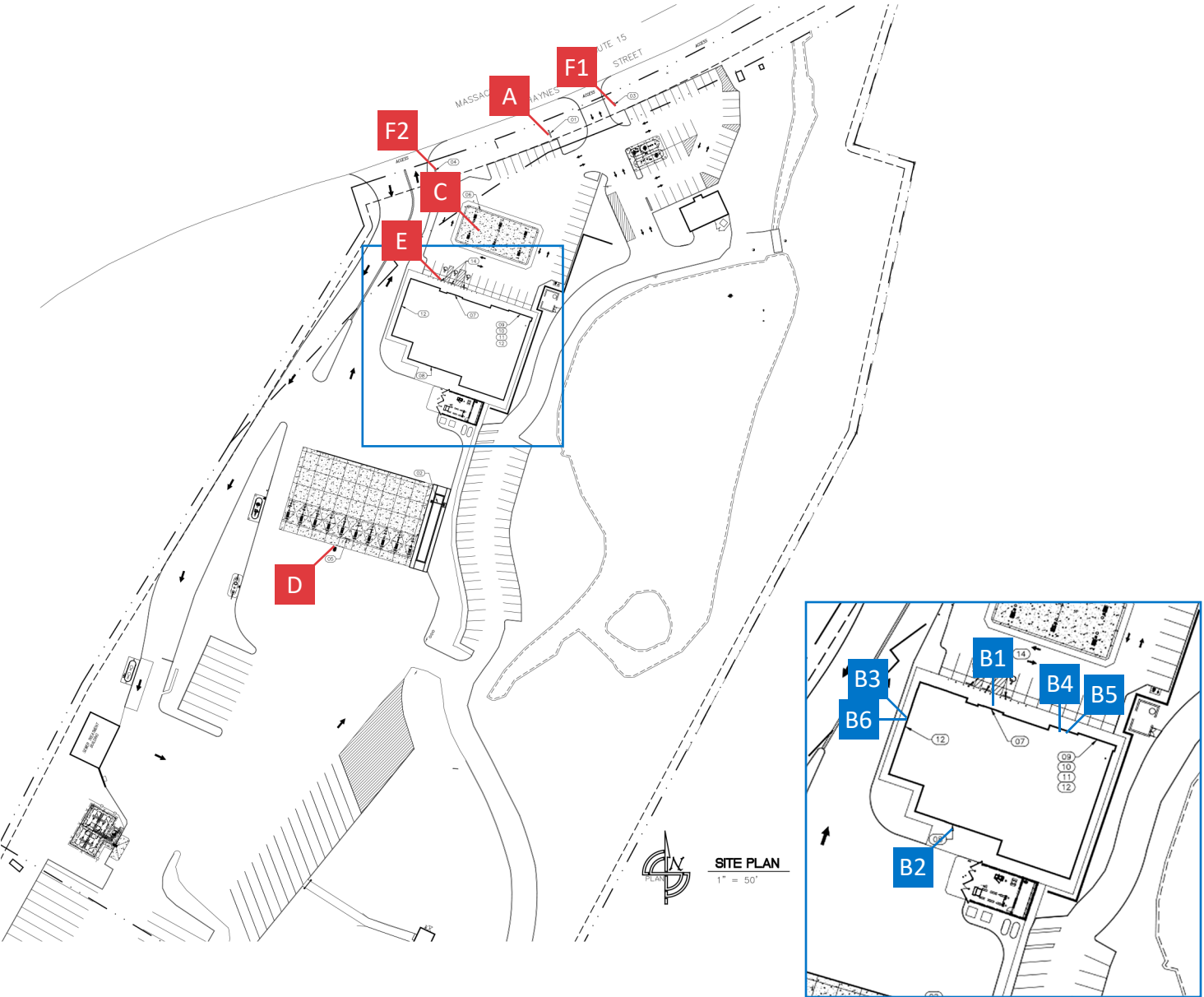

- A Single Pole System
- B Building Branding
- C Auto Products
- D Truck Products
- E Parking Signs
- F Directionals

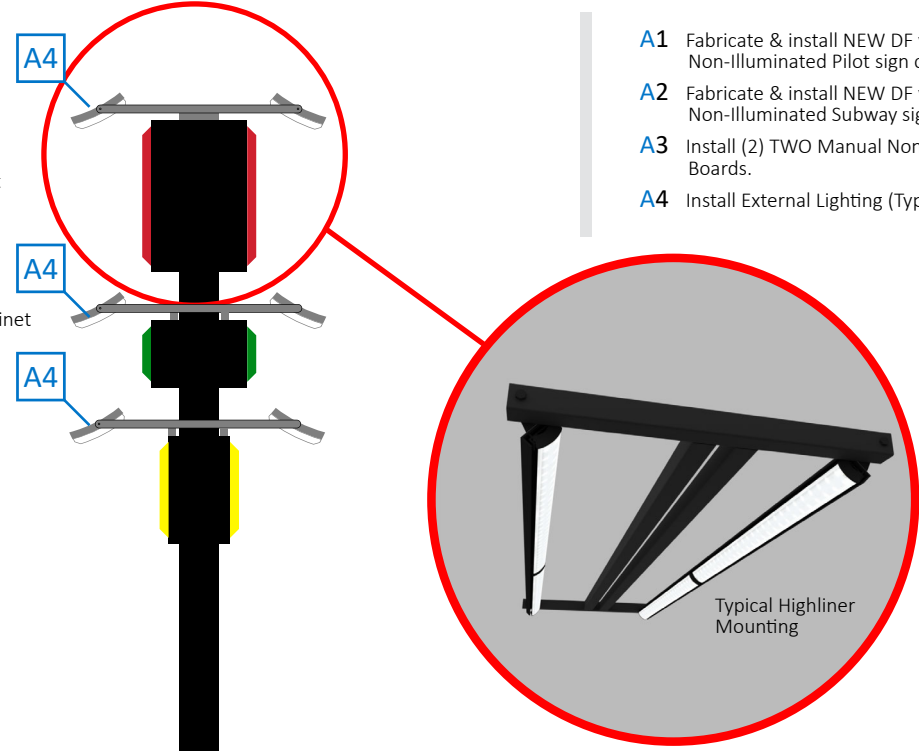
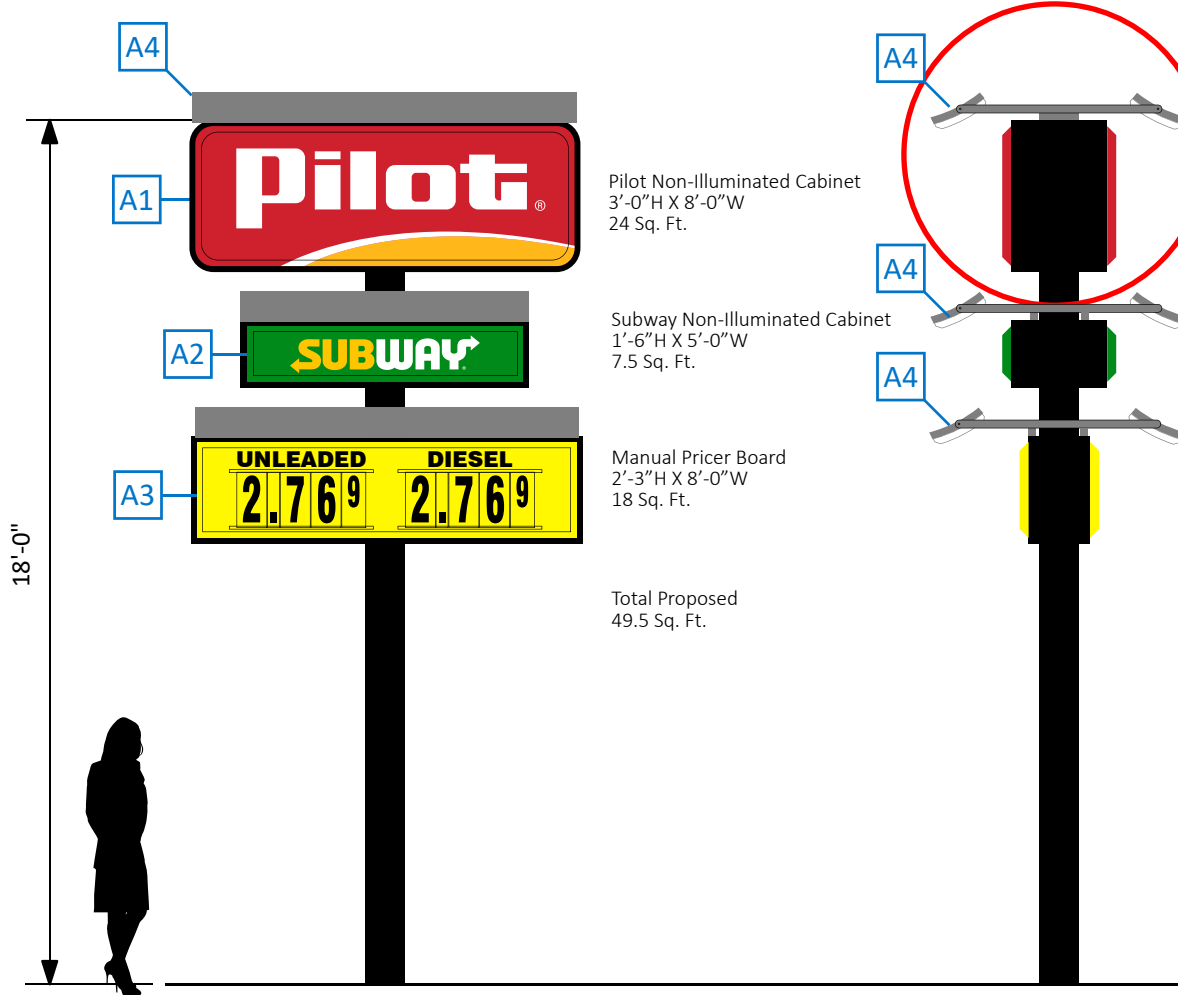

- A1 Fabricate & install NEW DF vacuum formed Non-Illuminated Pilot sign cabinet.
- A2 Fabricate & install NEW DF vacuum formed Non-Illuminated Subway sign cabinet.
- A3 Install (2) Manual Non-Illuminated Pricer Boards.
- A4 Install External Lighting (Typical Highliner shown).

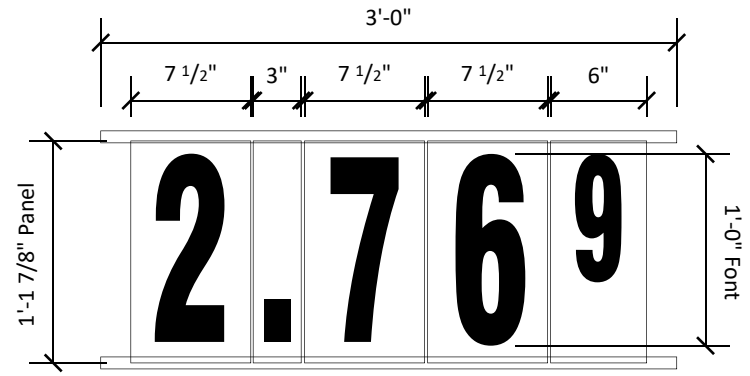

Font Kit Detail



PROPOSED NORTH ELEVATION

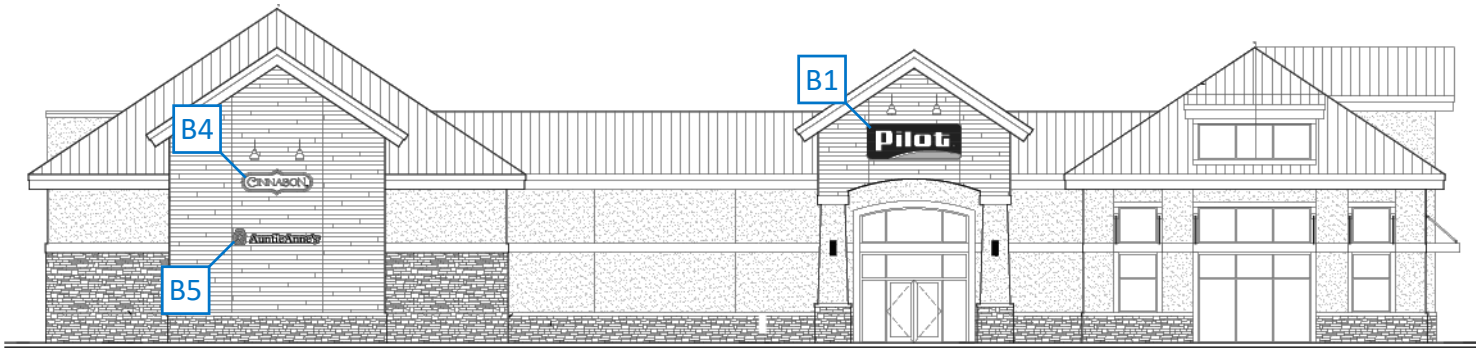

PROPOSED SOUTH ELEVATION



- B1** Replace existing Cabinet with NEW 4'-0" H X 10'-6" SF Pilot Non-illuminated cabinet.
- B2** NEW 10 1/2" H X 12' SF Welcome Drivers Non-Illuminated Channel Letterset
- B4** NEW Cinnabon non-illuminated Wall Sign
- B5** NEW Auntie Anne's Non-illuminated Wall Sign

PROPOSED EAST ELEVATION

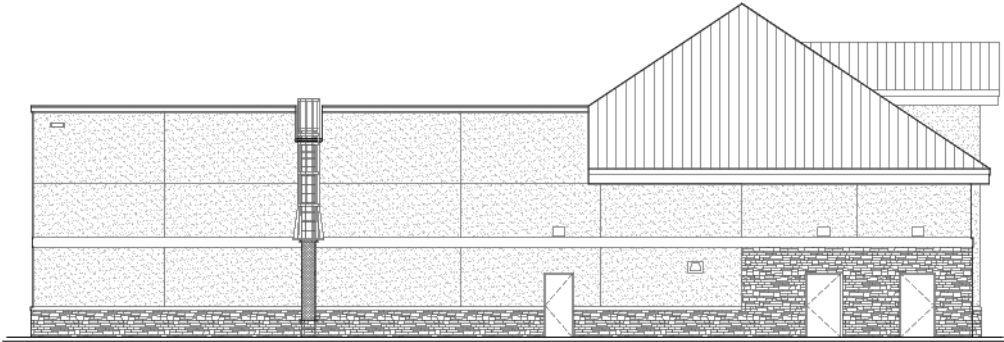

PROPOSED WEST ELEVATION

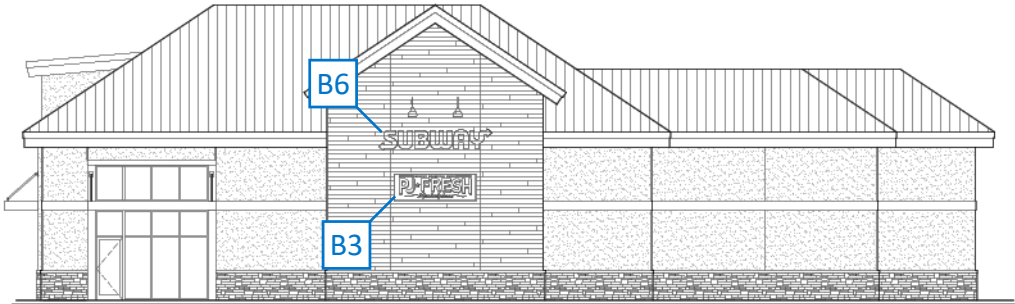

- B3** New Non-illuminated PJ Fresh Vaccum formed Face & Cabinet.  
Cabinet to be painted Semi-gloss Black
- B6** NEW Subway non-illuminated Wall Sign

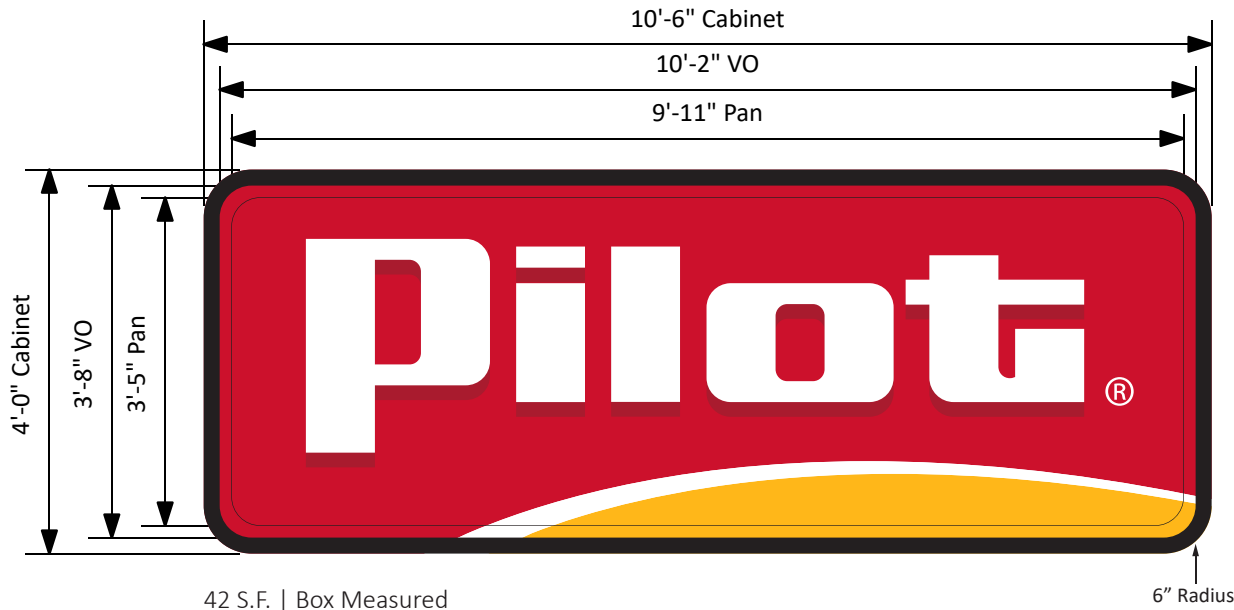

TYPICAL FORMED FACE CROSS SECTION

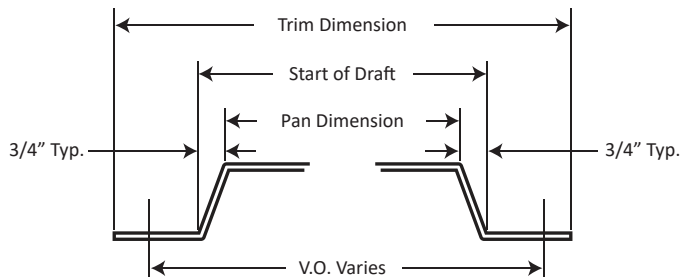

**B1** Replace existing Cabinet with NEW 4'-0" H X 10'-6" SF Pilot Non-illuminated cabinet.

**4X10-6 Pan formed Pilot Face & Cabinet**

**Specifications**

Sign Body to be Constructed out of Extruded Aluminum Frame.

Cabinets and Retainers to be Painted Semi-Gloss Black. Faces to be Vacuum Formed out of 3/16" Solar Grade Polycarbonate.

Graphics to be Printed for Back Lit Application (preferred Color/White/Color Process) on 3M IJ3650-114 Clear Vinyl with 3M 8519 Luster Overlaminate. Applied second surface to polycarbonate.

	Pantone 186		Pantone 187
	Pantone 1235		100% White
	Pantone Process Black		

B2 NEW 12"H Welcome Drivers  
Non-Illuminated Channel Letterset

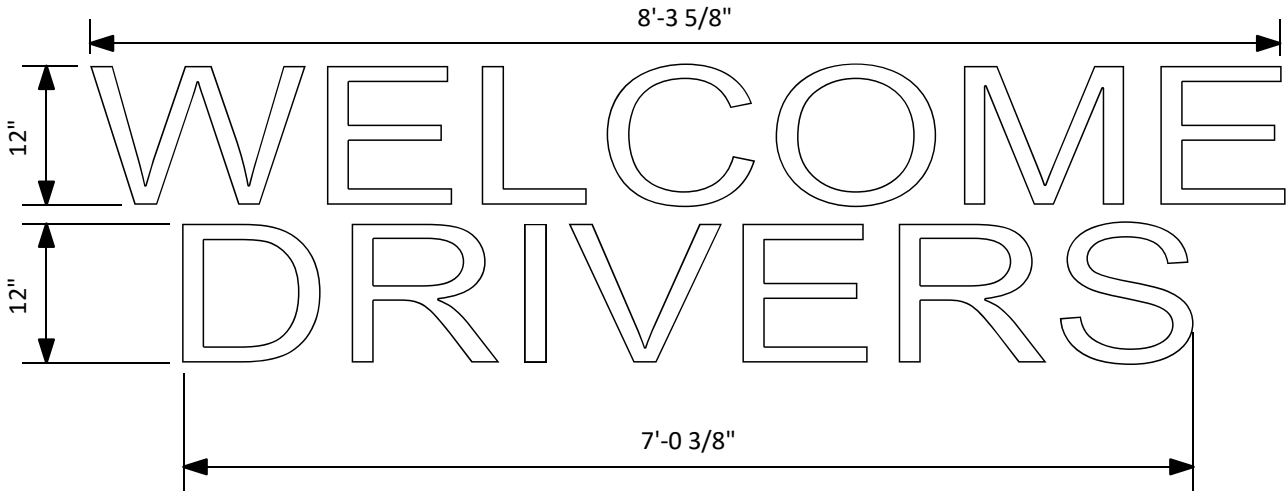
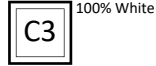

16.00 S.F. | Box Measured





Square Footage: 27.5 S.F.

TYPICAL FORMED FACE CROSS SECTION

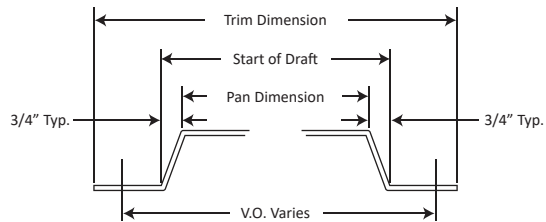

**B3** New Non-illuminated Vacuum formed Face & Cabinet.  
Cabinet to be painted Semi-gloss Black

Sign Body to be Constructed out of Extruded Aluminum Frame  
Cabinets and Retainers to be Painted Semi-Gloss Black  
Faces to be Vacuum Formed out of 3/16" Solar Grade Polycarbonate  
Graphics to be Printed for Back Lit Application (preferred Color/White/Color Process) on 3M IJ3650-114 Clear Vinyl with 3M 8519 Luster Overlamine



B4 NEW Cinnabon non-illuminated Wall Sign

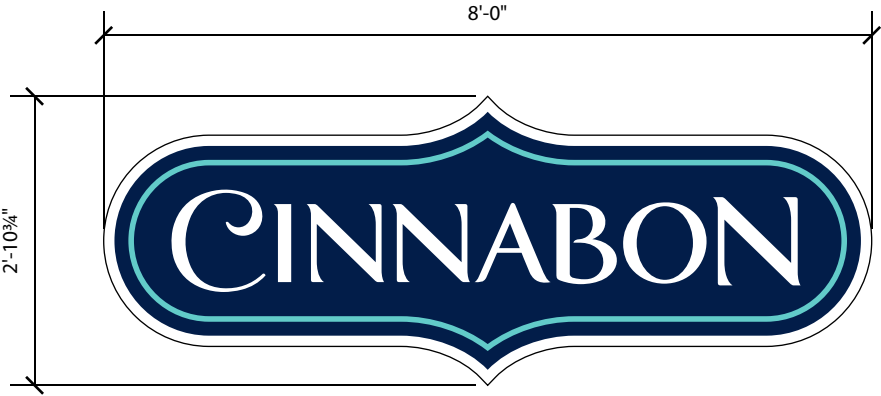

- C1 Pantone 2768
- C2 Pantone 325
- C3 White Plexi

Square Footage: 22.93 S.F.



B5 NEW Auntie Anne's Non-illuminated Wall Sign

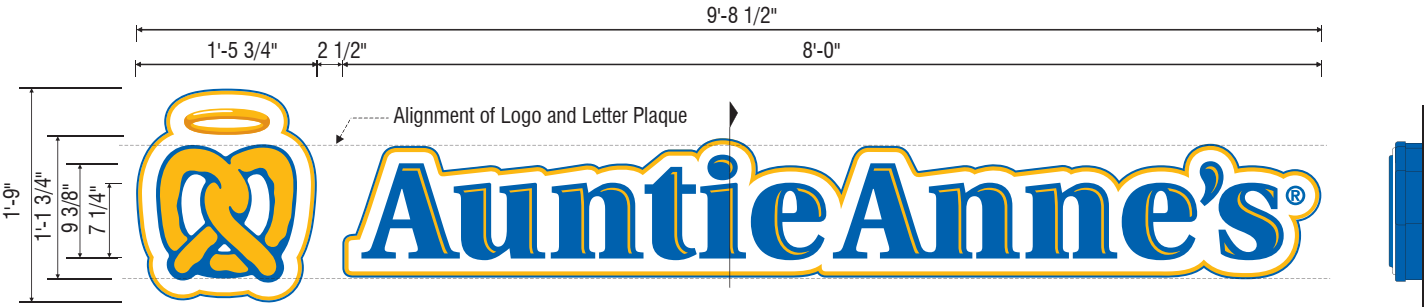

Square Footage: 16.94 S.F.



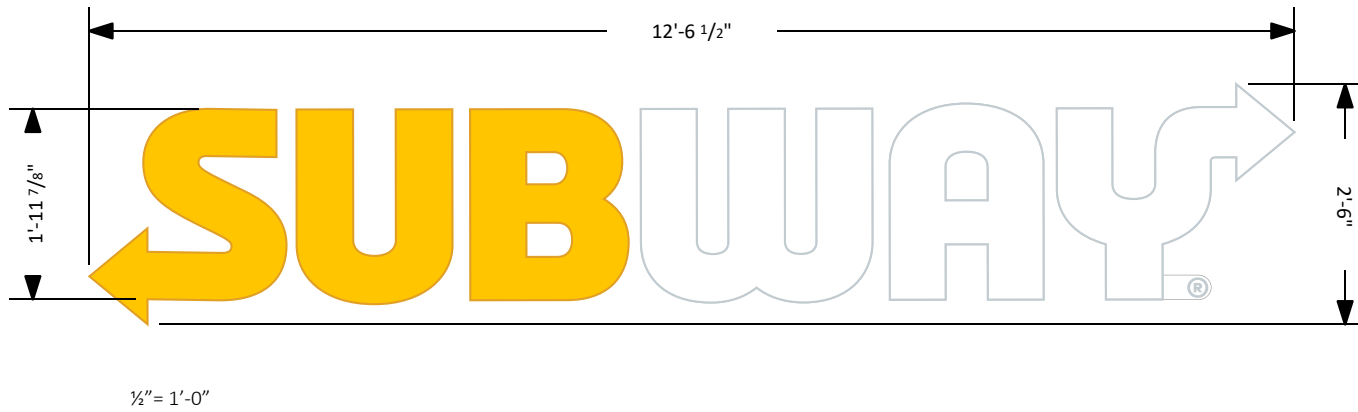

**30" LED Non-Illuminated Channel Letter Set Yellow/White**

**Specifications (SUB):**

- 5" Deep Letter
- Aluminum returns factory paint sprayed Pantone 7548 Yellow
- 7328 White Acrylic Face w/factory paint sprayed Pantone 7548 Yellow Trim Cap
- 3630-75 Yellow vinyl w/3M 3660M Over Laminate

**Specifications (WAY):**

- 5" Deep Letter
- Aluminum returns factory paint sprayed White
- 7328 White Acrylic Face w/White Trim Cap

**Specifications (®):**

White vinyl decal on clear polycarbonate placard attached to "Y" letter back

30.31 Sq. Ft. | Boxed Measured

<b>C1</b>	Pantone 7548 C	<b>C2</b>	3M Trans 3630-75 Yellow	<b>C3</b>	100% White
-----------	----------------	-----------	-------------------------	-----------	------------

C1 Canopy to be branded with with Pilot Auto branding.

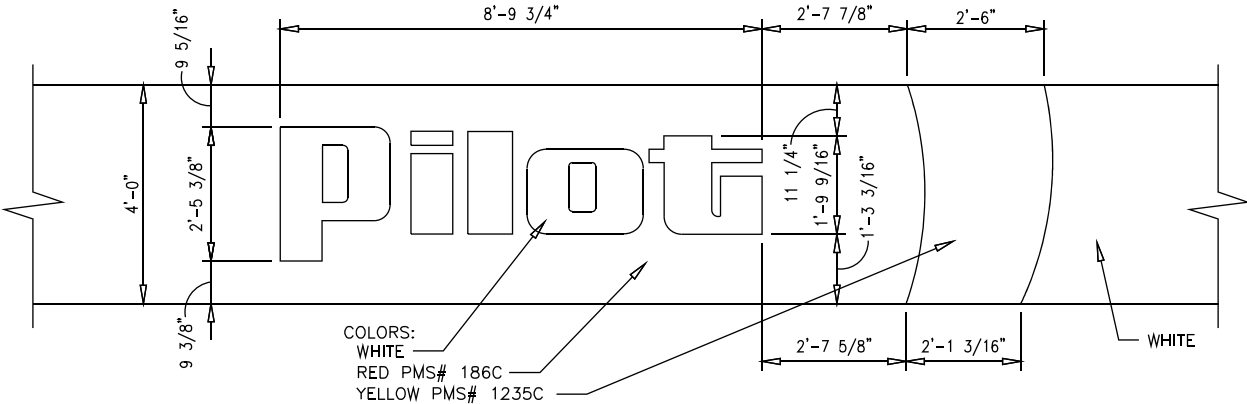

06

SQUARE FOOTAGE: 21.56 SF.



TYPICAL AUTO PRODUCTS CANOPY BRANDING

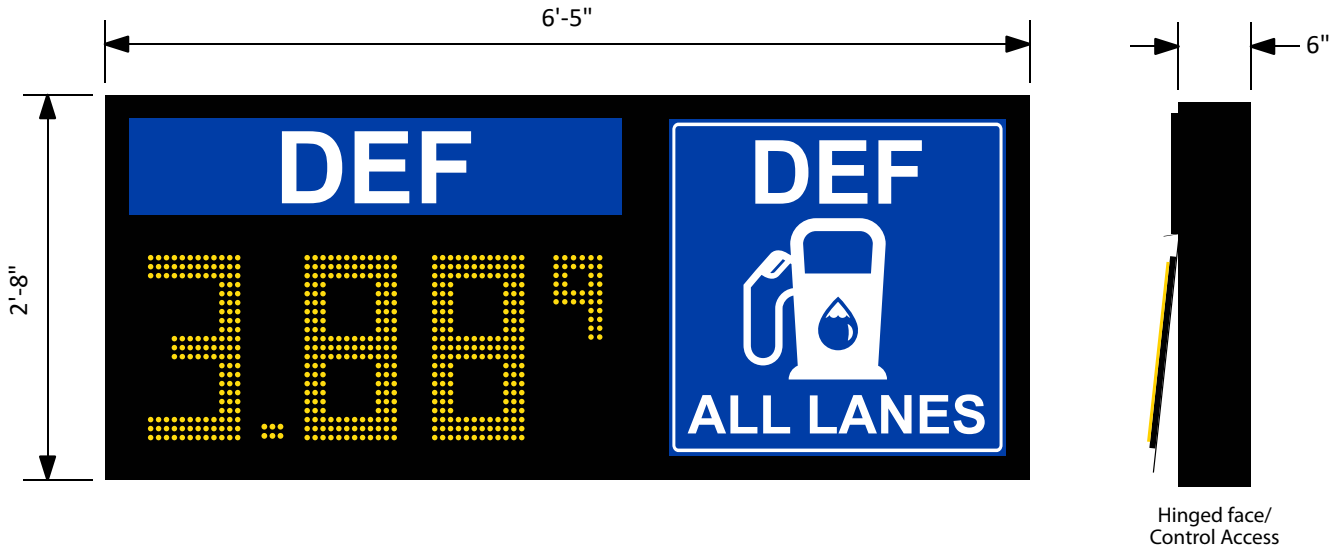

**DEF Pricer**

- 16" H LED Digit Size
- Amber LED Digit Color
- 32"H X 77"W X 6"D Overall Cabinet Size
- Cabinet color to be black.
- Single face canopy mount.
- Product Label Font to be 6" Helvetica Medium
- Label panel color to be 3M 3630-97 Bristol Blue
- Label type color to be White

**DEF Sign**

- Illuminated with White LEDs
- 48"H X 48"W X 6"D Overall Cabinet Size
- Cabinet color to be black.
- Single face canopy mount.
- DEF panel color to be 3M 3630-97 Bristol Blue
- DEF Icon to be White

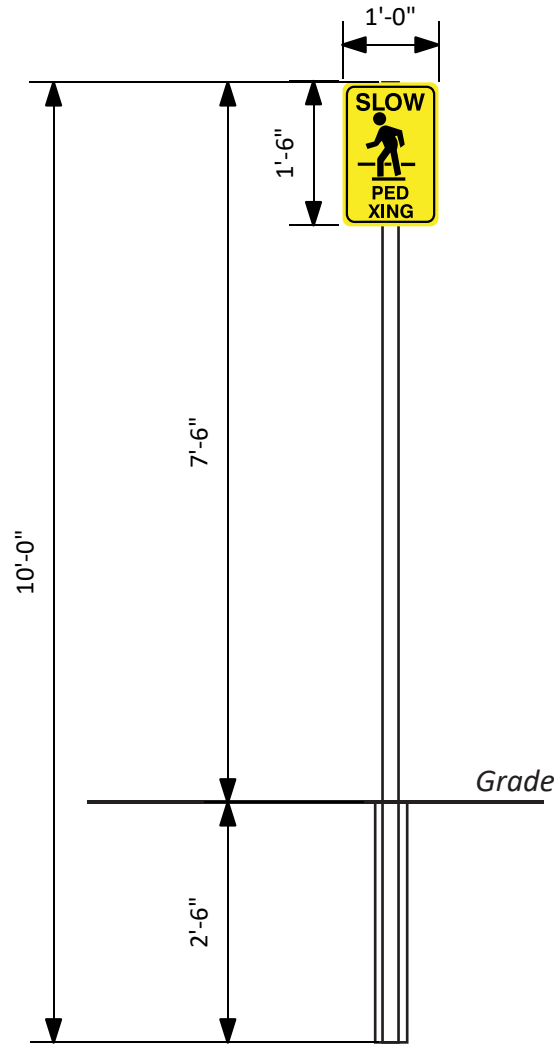
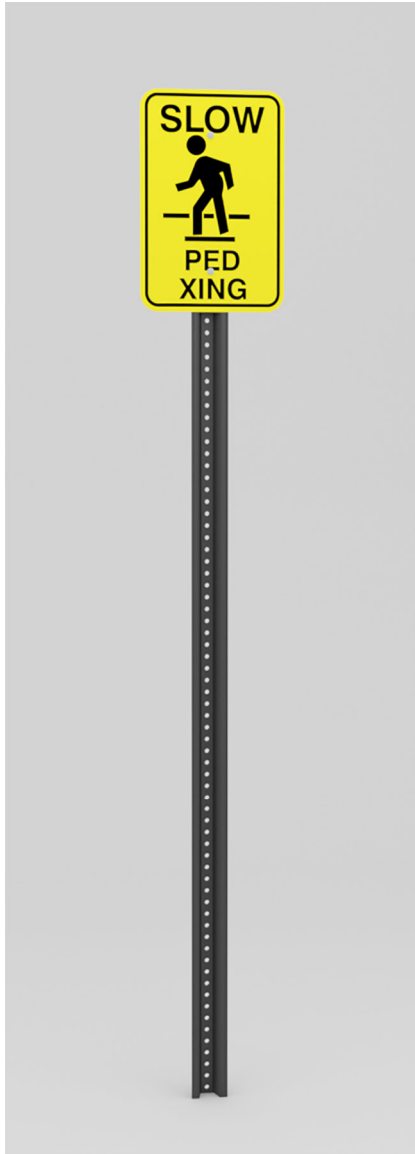

- E1 Supply & install NEW parking signs on U-channel posts.  
Foundation Non-Shrink High Strength grout.

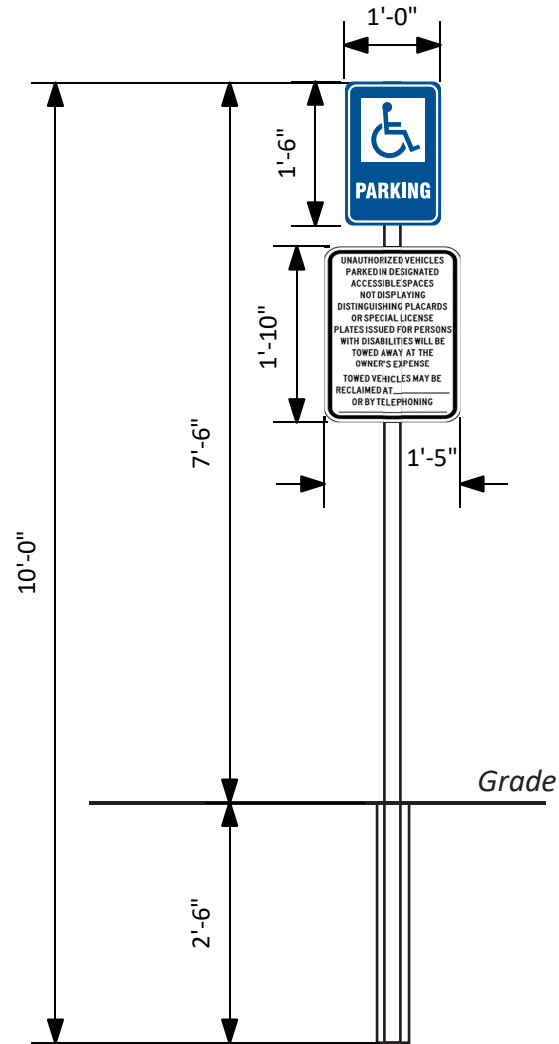

- E2 Supply & install NEW parking signs on U-channel posts.  
Foundation Non-Shrink High Strength grout.

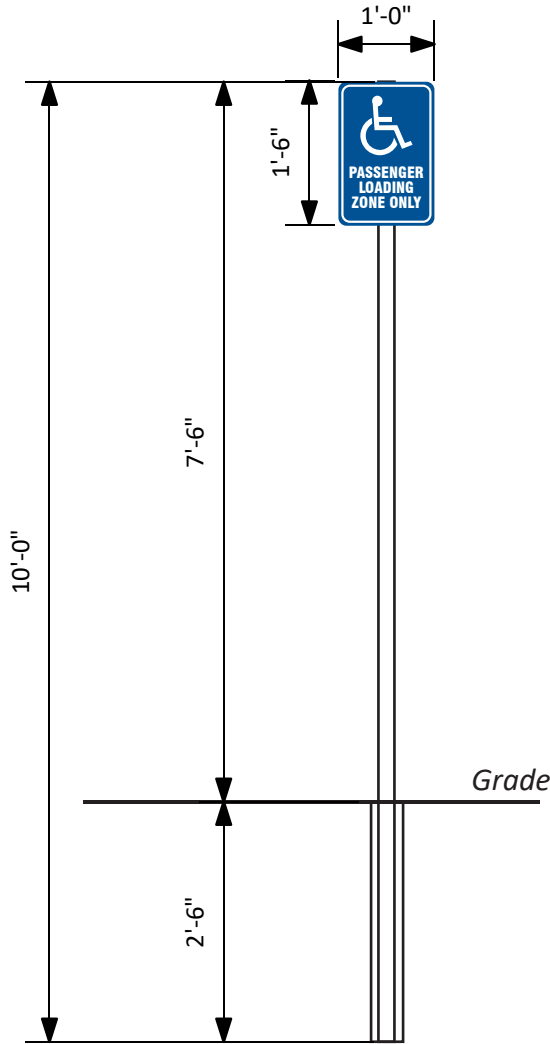

**EE3** Supply & install NEW parking signs on U-channel posts.  
Foundation Non-Shrink High Strength grout.



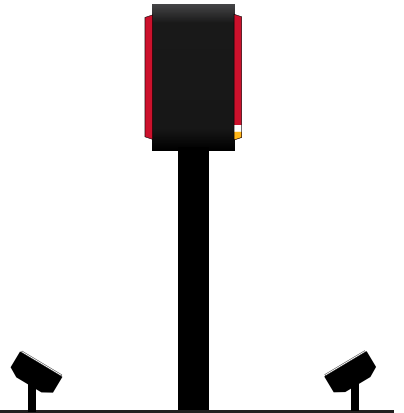
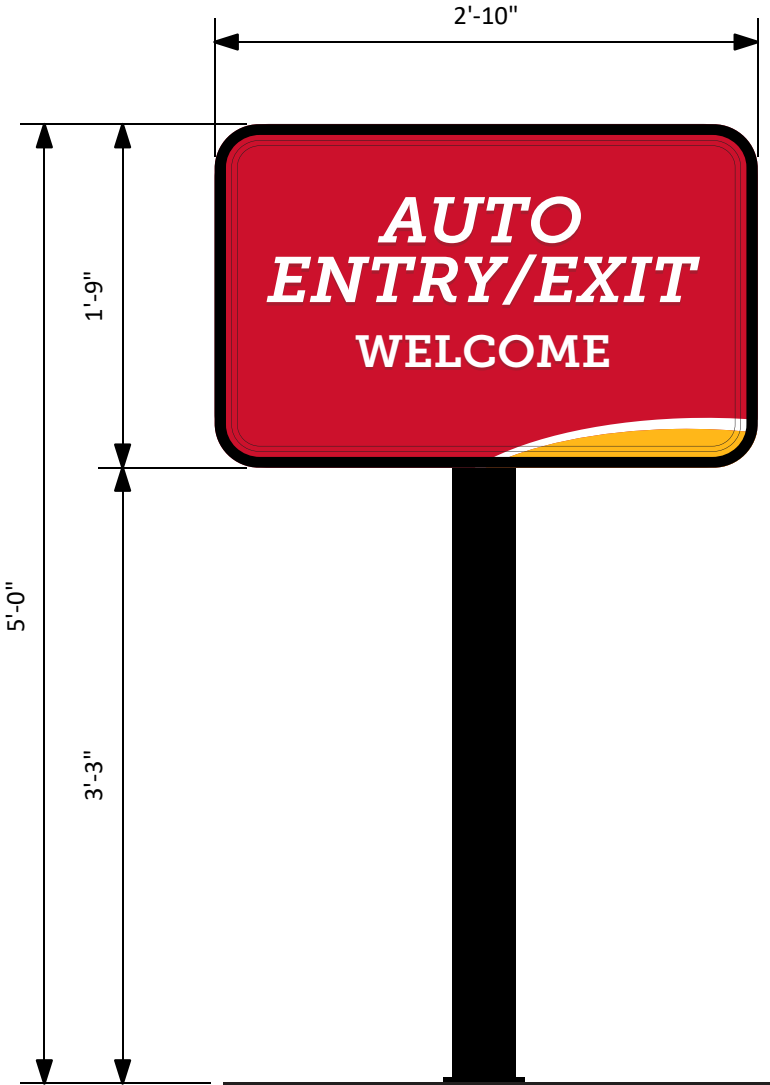

Typical Exterior Lighting Installation

- F1 NEW custom sized Non-Illuminated DF directional.  
Fabricate & Install.  
Foundation Non-Shrink High Strength grout  
Install Exterior flood lighting..

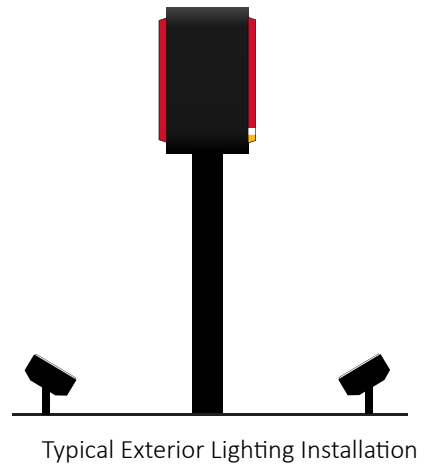
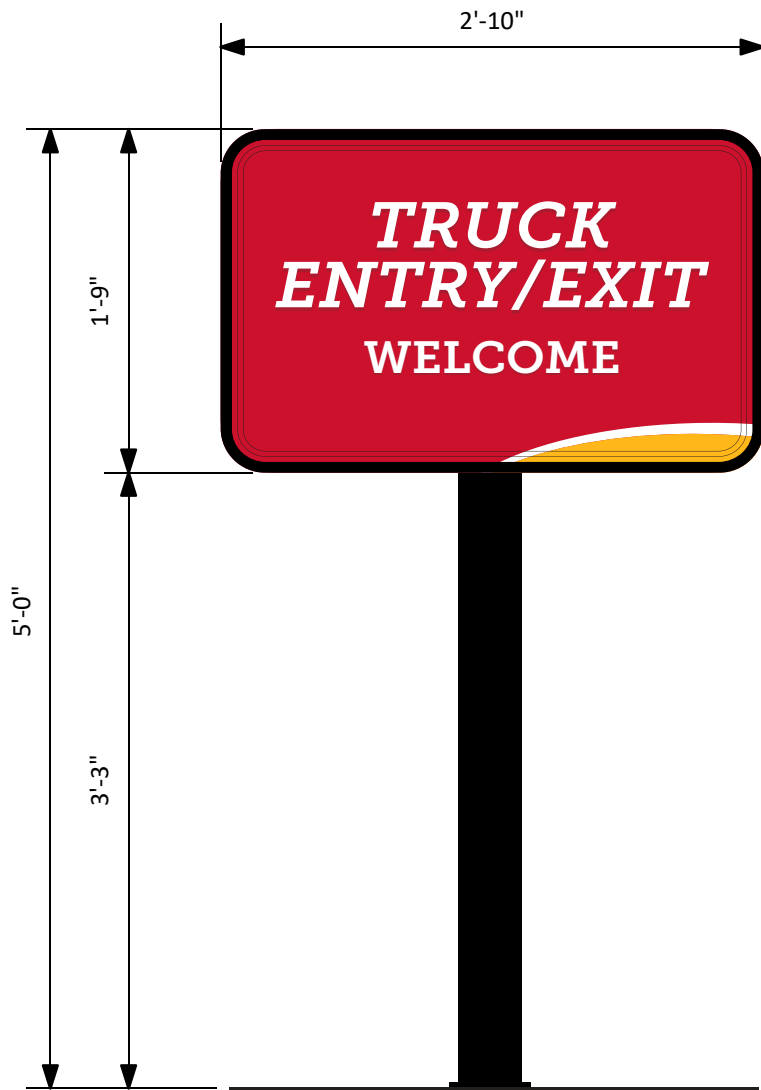

- F2 NEW custom sized Non-Illuminated DF directional.  
Fabricate & Install.  
Foundation Non-Shrink High Strength grout.  
Install Exterior flood lighting.