



**Town of Sturbridge
Conservation Commission
Notice of Intent Application Coversheet/Checklist**

Date	
-------------	--

in all white cells completely

Parcel Address Assessors Map/Plat Book & Page		Applicant name Address Email Phone	
Owner name Address Email Phone		Representative Address Email Phone	

FI

Wetland type		sf/cf affected		Relevant Perf. Standards	10. _____
Wetland type		sf/cf affected		Relevant Perf. Standards	10. _____
Wetland type		sf/cf affected		Relevant Perf. Standards	10. _____

Components of a Complete NOI Application

State Form: NOI Form 3	Included? <input type="checkbox"/> Yes <input type="checkbox"/> No
Engineered Plan	Included? <input type="checkbox"/> Yes <input type="checkbox"/> No
Proof of Mailing to DEP	Included? <input type="checkbox"/> Yes <input type="checkbox"/> No
Narrative	Included? <input type="checkbox"/> Yes <input type="checkbox"/> No
Proof that all relevant perf. standards are met	Included? <input type="checkbox"/> Yes <input type="checkbox"/> No
TOPO Map identifying locus with scale	Included? <input type="checkbox"/> Yes <input type="checkbox"/> No
FIRM Map identifying locus with scale	Included? <input type="checkbox"/> Yes <input type="checkbox"/> No
Natural Heritage Map with WH, PH, & VP data	Included? <input type="checkbox"/> Yes <input type="checkbox"/> No
Delineation lines (backup material)	Included? <input type="checkbox"/> Yes <input type="checkbox"/> No
Tax Form	Included? <input type="checkbox"/> Yes <input type="checkbox"/> No
Fees	
★ Fee Transmittal form	Included? <input type="checkbox"/> Yes <input type="checkbox"/> No
★ Filing Fee Worksheet	Included? <input type="checkbox"/> Yes <input type="checkbox"/> No
★ Town portion of state filing fee	Included? <input type="checkbox"/> Yes <input type="checkbox"/> No
★ Sturbridge local filing fee \$_____	Included? <input type="checkbox"/> Yes <input type="checkbox"/> No
Abutter Information	
★ Certified abutters list (within 200')	Included? <input type="checkbox"/> Yes <input type="checkbox"/> No
★ Abutter notification form	Included? <input type="checkbox"/> Yes <input type="checkbox"/> No
★ Affidavit & proof -- bring to hearing	<i>Present them at the hearing</i>
Other Attachments, e.g.	
Confirmation of submission to NHESP	Included? <input type="checkbox"/> Yes <input type="checkbox"/> No <input type="checkbox"/> Not Applicable
Planting Plan	Included? <input type="checkbox"/> Yes <input type="checkbox"/> No <input type="checkbox"/> Not Applicable
Floodplain analysis	Included? <input type="checkbox"/> Yes <input type="checkbox"/> No <input type="checkbox"/> Not Applicable
Stormwater analysis	Included? <input type="checkbox"/> Yes <input type="checkbox"/> No <input type="checkbox"/> Not Applicable

Components of a Complete NOI Application

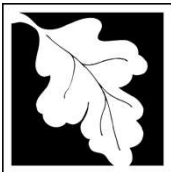

Massachusetts Department of Environmental Protection
 Bureau of Resource Protection - Wetlands

WPA Form 3 – Notice of Intent

Massachusetts Wetlands Protection Act M.G.L. c. 131, §40

Provided by MassDEP:

MassDEP File Number

Document Transaction Number

Sturbridge

City/Town

Important:
 When filling out forms on the computer, use only the tab key to move your cursor - do not use the return key.



Note:
 Before completing this form consult your local Conservation Commission regarding any municipal bylaw or ordinance.

A. General Information

1. Project Location (**Note:** electronic filers will click on button to locate project site):

<u>29, 30 & 31 Mt Dan Road</u>	<u>Fiskdale</u>	<u>01518</u>
a. Street Address	b. City/Town	c. Zip Code
Latitude and Longitude:	<u>42.14124</u>	<u>-72.12412</u>
	d. Latitude	e. Longitude
<u>450</u>	<u>0-1415-029, 0-1415-030 & 0-1415-031</u>	
f. Assessors Map/Plat Number	g. Parcel /Lot Number	

2. Applicant:

<u>Keith & Stephanie</u>	<u>Fiorucci</u>	
a. First Name	b. Last Name	
<u></u>		
c. Organization		
<u>25 Tannery Road</u>		
d. Street Address		
<u>Fiskdale</u>	<u>MA</u>	<u>01518</u>
e. City/Town	f. State	g. Zip Code
<u>508-344-5870</u>	<u>kefiorucci@protonmail.com</u>	
h. Phone Number	i. Fax Number	j. Email Address

3. Property owner (required if different from applicant): Check if more than one owner

(Same as above)

<u></u>	<u></u>	
a. First Name	b. Last Name	
<u></u>		
c. Organization		
<u></u>		
d. Street Address		
<u></u>	<u></u>	<u></u>
e. City/Town	f. State	g. Zip Code
<u></u>	<u></u>	<u></u>
h. Phone Number	i. Fax Number	j. Email address

4. Representative (if any):

<u>Glenn</u>	<u>Krevosky</u>	
a. First Name	b. Last Name	
<u>EBT Environmental Consultants, Inc.</u>		
c. Company		
<u>601 Main Street</u>		
d. Street Address		
<u>North Oxford</u>	<u>MA</u>	<u>01537</u>
e. City/Town	f. State	g. Zip Code
<u>(508) 769-3659</u>	<u>glenn.krevosky@charter.net</u>	
h. Phone Number	i. Fax Number	j. Email address

5. Total WPA Fee Paid (from NOI Wetland Fee Transmittal Form):

<u>\$110.00 (+\$300.00 bylaw)</u>	<u>\$42.50</u>	<u>\$67.50 (+\$300.00 bylaw)</u>
a. Total Fee Paid	b. State Fee Paid	c. City/Town Fee Paid

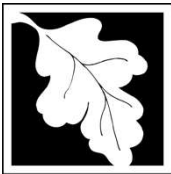

Massachusetts Department of Environmental Protection
Bureau of Resource Protection - Wetlands

WPA Form 3 – Notice of Intent

Massachusetts Wetlands Protection Act M.G.L. c. 131, §40

Provided by MassDEP:

MassDEP File Number

Document Transaction Number

Sturbridge
City/Town

A. General Information (continued)

6. General Project Description:

See attached A.6. General Project Description

7a. Project Type Checklist: (Limited Project Types see Section A. 7b.)

- 1. Single Family Home
- 2. Residential Subdivision
- 3. Commercial/Industrial
- 4. Dock/Pier
- 5. Utilities
- 6. Coastal engineering Structure
- 7. Agriculture (e.g., cranberries, forestry)
- 8. Transportation
- 9. Other

7b. Is any portion of the proposed activity eligible to be treated as a limited project (including Ecological Restoration Limited Project) subject to 310 CMR 10.24 (coastal) or 310 CMR 10.53 (inland)?

1. Yes No If yes, describe which limited project applies to this project. (See 310 CMR 10.24 and 10.53 for a complete list and description of limited project types)

2. Limited Project Type

If the proposed activity is eligible to be treated as an Ecological Restoration Limited Project (310 CMR10.24(8), 310 CMR 10.53(4)), complete and attach Appendix A: Ecological Restoration Limited Project Checklist and Signed Certification.

8. Property recorded at the Registry of Deeds for:

Worcester

a. County

59307

c. Book

b. Certificate # (if registered land)

187

d. Page Number

B. Buffer Zone & Resource Area Impacts (temporary & permanent)

- 1. Buffer Zone Only – Check if the project is located only in the Buffer Zone of a Bordering Vegetated Wetland, Inland Bank, or Coastal Resource Area.
- 2. Inland Resource Areas (see 310 CMR 10.54-10.58; if not applicable, go to Section B.3, Coastal Resource Areas).

Check all that apply below. Attach narrative and any supporting documentation describing how the project will meet all performance standards for each of the resource areas altered, including standards requiring consideration of alternative project design or location.

A.6. General Project Description

Site: 29, 30 & 31 Mt Dan Road, Sturbridge

Applicant: Keith & Stephanie Fiorucci

The applicant proposes to replace 2 sets of steps, replace an existing retaining wall with a boulder wall and construct an 18' by 12' pervious paver patio within 100-foot buffer to Big Alum Pond. A portion of the existing fence replacement and existing asphalt driveway to be replaced with pavers are within the 100' buffer zone (extending to over 100 feet). One set of existing steps to be replaced is within the 50' buffer zone and a small portion of one existing wall to be replaced with boulders is located within the 50' buffer zone. There is no work proposed in the 25' no disturb buffer zone.

The applicant also proposes to replace existing fence, replace existing asphalt driveway with pavers and clear an area for crushed stone parking next to the existing garage (across the street/west of the house) within the 200' bylaw buffer zone to Big Alum Pond.

As a point of mitigation, the applicant proposes to tarp the Japanese Knotweed adjacent to the top of the slope leading out of the lake along the property's northeastern boundary and leave the 40-millimeter tarp in place up to 2 years to kill the Knotweed. The stand of Knotweed is approximately 7 plants partially shaded by a tree canopy. The results of killing Japanese Knotweed without utilizing poison will be shared with the Commission prior to requesting a Certificate of Compliance.

Glenn E. Krevosky of EBT Environmental Consultants, Inc. investigated the site on 2/17/2024 and found the constructed armored slope and large boulders are the limit of the resource area abutting the lake (see Exhibit 9A). Plants upgradient of the wall (~3' above the lake level) are FACU – White Ash, Black Cherry, Japanese Knotweed, Smooth Sumac, Eastern White Pine, Black Birch, Northern Red Oak and Mountain Laurel.

The erosion control measures of staked 9" straw wattles backed by entrenched silt fence, shown on the site plan, shall be placed prior to site work. These measures shall be maintained in good working order throughout the project until all exposed soils are final graded, loamed, seeded and stabilized with well-established soil stabilizing vegetation.



Massachusetts Department of Environmental Protection
Bureau of Resource Protection - Wetlands

WPA Form 3 – Notice of Intent

Massachusetts Wetlands Protection Act M.G.L. c. 131, §40

Provided by MassDEP:
MassDEP File Number
Document Transaction Number
Sturbridge
City/Town

B. Buffer Zone & Resource Area Impacts (temporary & permanent) (cont'd)

For all projects affecting other Resource Areas, please attach a narrative explaining how the resource area was delineated.

Resource Area	Size of Proposed Alteration	Proposed Replacement (if any)
a. <input type="checkbox"/> Bank	1. linear feet	2. linear feet
b. <input type="checkbox"/> Bordering Vegetated Wetland	1. square feet	2. square feet
c. <input type="checkbox"/> Land Under Waterbodies and Waterways	1. square feet	2. square feet
	3. cubic yards dredged	

Resource Area	Size of Proposed Alteration	Proposed Replacement (if any)
d. <input type="checkbox"/> Bordering Land Subject to Flooding	1. square feet	2. square feet
	3. cubic feet of flood storage lost	4. cubic feet replaced
e. <input type="checkbox"/> Isolated Land Subject to Flooding	1. square feet	
	2. cubic feet of flood storage lost	3. cubic feet replaced
f. <input type="checkbox"/> Riverfront Area	1. Name of Waterway (if available) - specify coastal or inland	

2. Width of Riverfront Area (check one):

- 25 ft. - Designated Densely Developed Areas only
- 100 ft. - New agricultural projects only
- 200 ft. - All other projects

3. Total area of Riverfront Area on the site of the proposed project: _____ square feet

4. Proposed alteration of the Riverfront Area:

a. total square feet	b. square feet within 100 ft.	c. square feet between 100 ft. and 200 ft.
----------------------	-------------------------------	--

5. Has an alternatives analysis been done and is it attached to this NOI? Yes No

6. Was the lot where the activity is proposed created prior to August 1, 1996? Yes No

3. Coastal Resource Areas: (See 310 CMR 10.25-10.35)

Note: for coastal riverfront areas, please complete **Section B.2.f.** above.

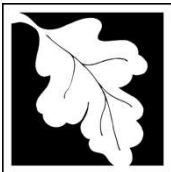

WPA Form 3 – Notice of Intent

Massachusetts Wetlands Protection Act M.G.L. c. 131, §40

Provided by MassDEP:

MassDEP File Number

Document Transaction Number

Sturbridge

City/Town

B. Buffer Zone & Resource Area Impacts (temporary & permanent) (cont'd)

Check all that apply below. Attach narrative and supporting documentation describing how the project will meet all performance standards for each of the resource areas altered, including standards requiring consideration of alternative project design or location.

Online Users:
 Include your document transaction number (provided on your receipt page) with all supplementary information you submit to the Department.

<u>Resource Area</u>	<u>Size of Proposed Alteration</u>	<u>Proposed Replacement (if any)</u>
a. <input type="checkbox"/> Designated Port Areas	Indicate size under Land Under the Ocean, below	
b. <input type="checkbox"/> Land Under the Ocean	_____	
	1. square feet	

	2. cubic yards dredged	
c. <input type="checkbox"/> Barrier Beach	Indicate size under Coastal Beaches and/or Coastal Dunes below	
d. <input type="checkbox"/> Coastal Beaches	_____	_____
	1. square feet	2. cubic yards beach nourishment
e. <input type="checkbox"/> Coastal Dunes	_____	_____
	1. square feet	2. cubic yards dune nourishment

	<u>Size of Proposed Alteration</u>	<u>Proposed Replacement (if any)</u>
f. <input type="checkbox"/> Coastal Banks	_____	
	1. linear feet	
g. <input type="checkbox"/> Rocky Intertidal Shores	_____	
	1. square feet	
h. <input type="checkbox"/> Salt Marshes	_____	_____
	1. square feet	2. sq ft restoration, rehab., creation
i. <input type="checkbox"/> Land Under Salt Ponds	_____	
	1. square feet	

	2. cubic yards dredged	
j. <input type="checkbox"/> Land Containing Shellfish	_____	
	1. square feet	
k. <input type="checkbox"/> Fish Runs	Indicate size under Coastal Banks, inland Bank, Land Under the Ocean, and/or inland Land Under Waterbodies and Waterways, above	

	1. cubic yards dredged	
l. <input type="checkbox"/> Land Subject to Coastal Storm Flowage	_____	
	1. square feet	

4. Restoration/Enhancement
 If the project is for the purpose of restoring or enhancing a wetland resource area in addition to the square footage that has been entered in Section B.2.b or B.3.h above, please enter the additional amount here.

a. square feet of BVW

b. square feet of Salt Marsh

5. Project Involves Stream Crossings

a. number of new stream crossings

b. number of replacement stream crossings

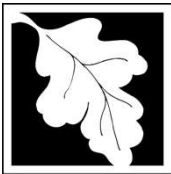

Massachusetts Department of Environmental Protection
Bureau of Resource Protection - Wetlands

WPA Form 3 – Notice of Intent

Massachusetts Wetlands Protection Act M.G.L. c. 131, §40

Provided by MassDEP:

MassDEP File Number

Document Transaction Number

Sturbridge

City/Town

C. Other Applicable Standards and Requirements

- This is a proposal for an Ecological Restoration Limited Project. Skip Section C and complete Appendix A: Ecological Restoration Limited Project Checklists – Required Actions (310 CMR 10.11).

Streamlined Massachusetts Endangered Species Act/Wetlands Protection Act Review

1. Is any portion of the proposed project located in **Estimated Habitat of Rare Wildlife** as indicated on the most recent Estimated Habitat Map of State-Listed Rare Wetland Wildlife published by the Natural Heritage and Endangered Species Program (NHESP)? To view habitat maps, see the *Massachusetts Natural Heritage Atlas* or go to http://maps.massgis.state.ma.us/PRI_EST_HAB/viewer.htm.

- a. Yes No **If yes, include proof of mailing or hand delivery of NOI to:**

**Natural Heritage and Endangered Species Program
Division of Fisheries and Wildlife
1 Rabbit Hill Road
Westborough, MA 01581**

Current
MassMapper _____

If yes, the project is also subject to Massachusetts Endangered Species Act (MESA) review (321 CMR 10.18). To qualify for a streamlined, 30-day, MESA/Wetlands Protection Act review, please complete Section C.1.c, and include requested materials with this Notice of Intent (NOI); *OR* complete Section C.2.f, if applicable. *If MESA supplemental information is not included with the NOI, by completing Section 1 of this form, the NHESP will require a separate MESA filing which may take up to 90 days to review (unless noted exceptions in Section 2 apply, see below).*

- c. Submit Supplemental Information for Endangered Species Review*

1. Percentage/acreage of property to be altered:
 - (a) within wetland Resource Area _____ percentage/acreage
 - (b) outside Resource Area _____ percentage/acreage

2. Assessor's Map or right-of-way plan of site

2. Project plans for entire project site, including wetland resource areas and areas outside of wetlands jurisdiction, showing existing and proposed conditions, existing and proposed tree/vegetation clearing line, and clearly demarcated limits of work **
 - (a) Project description (including description of impacts outside of wetland resource area & buffer zone)
 - (b) Photographs representative of the site

* Some projects **not** in Estimated Habitat may be located in Priority Habitat, and require NHESP review (see <https://www.mass.gov/endangered-species-act-mesa-regulatory-review>).

Priority Habitat includes habitat for state-listed plants and strictly upland species not protected by the Wetlands Protection Act.

** MESA projects may not be segmented (321 CMR 10.16). The applicant must disclose full development plans even if such plans are not required as part of the Notice of Intent process.

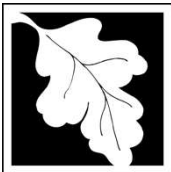

Massachusetts Department of Environmental Protection
Bureau of Resource Protection - Wetlands

WPA Form 3 – Notice of Intent

Massachusetts Wetlands Protection Act M.G.L. c. 131, §40

Provided by MassDEP:	
MassDEP File Number	
Document Transaction Number	
Sturbridge	
City/Town	

C. Other Applicable Standards and Requirements (cont'd)

(c) MESA filing fee (fee information available at <https://www.mass.gov/how-to/how-to-file-for-a-mesa-project-review>).

Make check payable to "Commonwealth of Massachusetts - NHESP" and **mail to NHESP** at above address

Projects altering 10 or more acres of land, also submit:

(d) Vegetation cover type map of site

(e) Project plans showing Priority & Estimated Habitat boundaries

(f) OR Check One of the Following

1. Project is exempt from MESA review.
Attach applicant letter indicating which MESA exemption applies. (See 321 CMR 10.14, <https://www.mass.gov/service-details/exemptions-from-review-for-projectsactivities-in-priority-habitat>; the NOI must still be sent to NHESP if the project is within estimated habitat pursuant to 310 CMR 10.37 and 10.59.)

2. Separate MESA review ongoing. a. NHESP Tracking # _____ b. Date submitted to NHESP _____

3. Separate MESA review completed.
Include copy of NHESP "no Take" determination or valid Conservation & Management Permit with approved plan.

3. For coastal projects only, is any portion of the proposed project located below the mean high water line or in a fish run?

a. Not applicable – project is in inland resource area only b. Yes No

If yes, include proof of mailing, hand delivery, or electronic delivery of NOI to either:

South Shore - Cohasset to Rhode Island border, and the Cape & Islands:

North Shore - Hull to New Hampshire border:

Division of Marine Fisheries -
Southeast Marine Fisheries Station
Attn: Environmental Reviewer
836 South Rodney French Blvd.
New Bedford, MA 02744
Email: dmf.envreview-south@mass.gov

Division of Marine Fisheries -
North Shore Office
Attn: Environmental Reviewer
30 Emerson Avenue
Gloucester, MA 01930
Email: dmf.envreview-north@mass.gov

Also if yes, the project may require a Chapter 91 license. For coastal towns in the Northeast Region, please contact MassDEP's Boston Office. For coastal towns in the Southeast Region, please contact MassDEP's Southeast Regional Office.

c. Is this an aquaculture project? d. Yes No

If yes, include a copy of the Division of Marine Fisheries Certification Letter (M.G.L. c. 130, § 57).

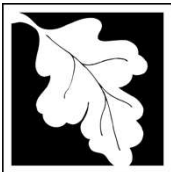

Massachusetts Department of Environmental Protection
Bureau of Resource Protection - Wetlands

WPA Form 3 – Notice of Intent

Massachusetts Wetlands Protection Act M.G.L. c. 131, §40

Provided by MassDEP:
MassDEP File Number
Document Transaction Number
Sturbridge
City/Town

Online Users:
Include your document transaction number (provided on your receipt page) with all supplementary information you submit to the Department.

C. Other Applicable Standards and Requirements (cont'd)

4. Is any portion of the proposed project within an Area of Critical Environmental Concern (ACEC)?
 a. Yes No If yes, provide name of ACEC (see instructions to WPA Form 3 or MassDEP Website for ACEC locations). **Note:** electronic filers click on Website.
 b. ACEC
5. Is any portion of the proposed project within an area designated as an Outstanding Resource Water (ORW) as designated in the Massachusetts Surface Water Quality Standards, 314 CMR 4.00?
 a. Yes No
6. Is any portion of the site subject to a Wetlands Restriction Order under the Inland Wetlands Restriction Act (M.G.L. c. 131, § 40A) or the Coastal Wetlands Restriction Act (M.G.L. c. 130, § 105)?
 a. Yes No
7. Is this project subject to provisions of the MassDEP Stormwater Management Standards?
 a. Yes. Attach a copy of the Stormwater Report as required by the Stormwater Management Standards per 310 CMR 10.05(6)(k)-(q) and check if:
 1. Applying for Low Impact Development (LID) site design credits (as described in Stormwater Management Handbook Vol. 2, Chapter 3)
 2. A portion of the site constitutes redevelopment
 3. Proprietary BMPs are included in the Stormwater Management System.
 b. No. Check why the project is exempt:
 1. Single-family house
 2. Emergency road repair
 3. Small Residential Subdivision (less than or equal to 4 single-family houses or less than or equal to 4 units in multi-family housing project) with no discharge to Critical Areas.

D. Additional Information

- This is a proposal for an Ecological Restoration Limited Project. Skip Section D and complete Appendix A: Ecological Restoration Notice of Intent – Minimum Required Documents (310 CMR 10.12).

Applicants must include the following with this Notice of Intent (NOI). See instructions for details.

Online Users: Attach the document transaction number (provided on your receipt page) for any of the following information you submit to the Department.

1. USGS or other map of the area (along with a narrative description, if necessary) containing sufficient information for the Conservation Commission and the Department to locate the site. (Electronic filers may omit this item.)
2. Plans identifying the location of proposed activities (including activities proposed to serve as a Bordering Vegetated Wetland [BVW] replication area or other mitigating measure) relative to the boundaries of each affected resource area.



Massachusetts Department of Environmental Protection
Bureau of Resource Protection - Wetlands

WPA Form 3 – Notice of Intent

Massachusetts Wetlands Protection Act M.G.L. c. 131, §40

Provided by MassDEP:
MassDEP File Number
Document Transaction Number
Sturbridge
City/Town

D. Additional Information (cont'd)

3. Identify the method for BVW and other resource area boundary delineations (MassDEP BVW Field Data Form(s), Determination of Applicability, Order of Resource Area Delineation, etc.), and attach documentation of the methodology.

4. List the titles and dates for all plans and other materials submitted with this NOI.

Conservation Commission Plan

a. Plan Title

DC Engineering & Surveying, Inc.

Jason D. Dubois

b. Prepared By

c. Signed and Stamped by

3/6/2024

1"=10'

d. Final Revision Date

e. Scale

See attached D.4. Additional Information

f. Additional Plan or Document Title

g. Date

5. If there is more than one property owner, please attach a list of these property owners not listed on this form.

6. Attach proof of mailing for Natural Heritage and Endangered Species Program, if needed.

7. Attach proof of mailing for Massachusetts Division of Marine Fisheries, if needed.

8. Attach NOI Wetland Fee Transmittal Form

9. Attach Stormwater Report, if needed.

E. Fees

1. Fee Exempt: No filing fee shall be assessed for projects of any city, town, county, or district of the Commonwealth, federally recognized Indian tribe housing authority, municipal housing authority, or the Massachusetts Bay Transportation Authority.

Applicants must submit the following information (in addition to pages 1 and 2 of the NOI Wetland Fee Transmittal Form) to confirm fee payment:

1119 (1120 bylaw)

2/27/2024

2. Municipal Check Number

3. Check date

1118

2/27/2024

4. State Check Number

5. Check date

Keith & Stephanie

Fiorucci

6. Payor name on check: First Name

7. Payor name on check: Last Name

D.4. Additional Information

Project Location: 29, 30 & 31 Mt Dan Road, Fiskdale

Applicant: Kieth & Stephanie Fiorucci

- 1A. Conservation Commission Plan: prepared for Keith Fiorucci by DC Engineering & Surveying Inc., dated 6/6/2024
- 2A. East Brookfield USGS Quad, dated 2021
- 3A. Sturbridge GIS Map, dated 3/5/2024
- 4A. Fee Transmittal Form, Local Fee Sheet & Check Copies
- 5A. Town of Sturbridge Abutters' Lists, dated 2/16/2024 & 2/20/2024
- 6A. Abutters Notification
- 7A. Affidavit of Service
- 8A. Tax Sign-Off, dated 2/14/2024
- 9A. Photo Exhibit, dated 2/17/2024
- 10A. MassMapper with Layers, dated 3/5/2024



WPA Form 3 – Notice of Intent

Massachusetts Wetlands Protection Act M.G.L. c. 131, §40

Provided by MassDEP:

MassDEP File Number

Document Transaction Number

City/Town

F. Signatures and Submittal Requirements

I hereby certify under the penalties of perjury that the foregoing Notice of Intent and accompanying plans, documents, and supporting data are true and complete to the best of my knowledge. I understand that the Conservation Commission will place notification of this Notice in a local newspaper at the expense of the applicant in accordance with the wetlands regulations, 310 CMR 10.05(5)(a).

I further certify under penalties of perjury that all abutters were notified of this application, pursuant to the requirements of M.G.L. c. 131, § 40. Notice must be made by Certificate of Mailing or in writing by hand delivery or certified mail (return receipt requested) to all abutters within 100 feet of the property line of the project location.

K E Fulmer

1. Signature of Applicant

2.25.24

2. Date

3. Signature of Property Owner (if different)

Glenn E. Mewsky

4. Date

3/7/2024

5. Signature of Representative (if any)

6. Date

For Conservation Commission:

Two copies of the completed Notice of Intent (Form 3), including supporting plans and documents, two copies of the NOI Wetland Fee Transmittal Form, and the city/town fee payment, to the Conservation Commission by certified mail or hand delivery.

For MassDEP:

One copy of the completed Notice of Intent (Form 3), including supporting plans and documents, one copy of the NOI Wetland Fee Transmittal Form, and a **copy** of the state fee payment to the MassDEP Regional Office (see Instructions) by certified mail or hand delivery.

Other:

If the applicant has checked the "yes" box in any part of Section C, Item 3, above, refer to that section and the Instructions for additional submittal requirements.

The original and copies must be sent simultaneously. Failure by the applicant to send copies in a timely manner may result in dismissal of the Notice of Intent.

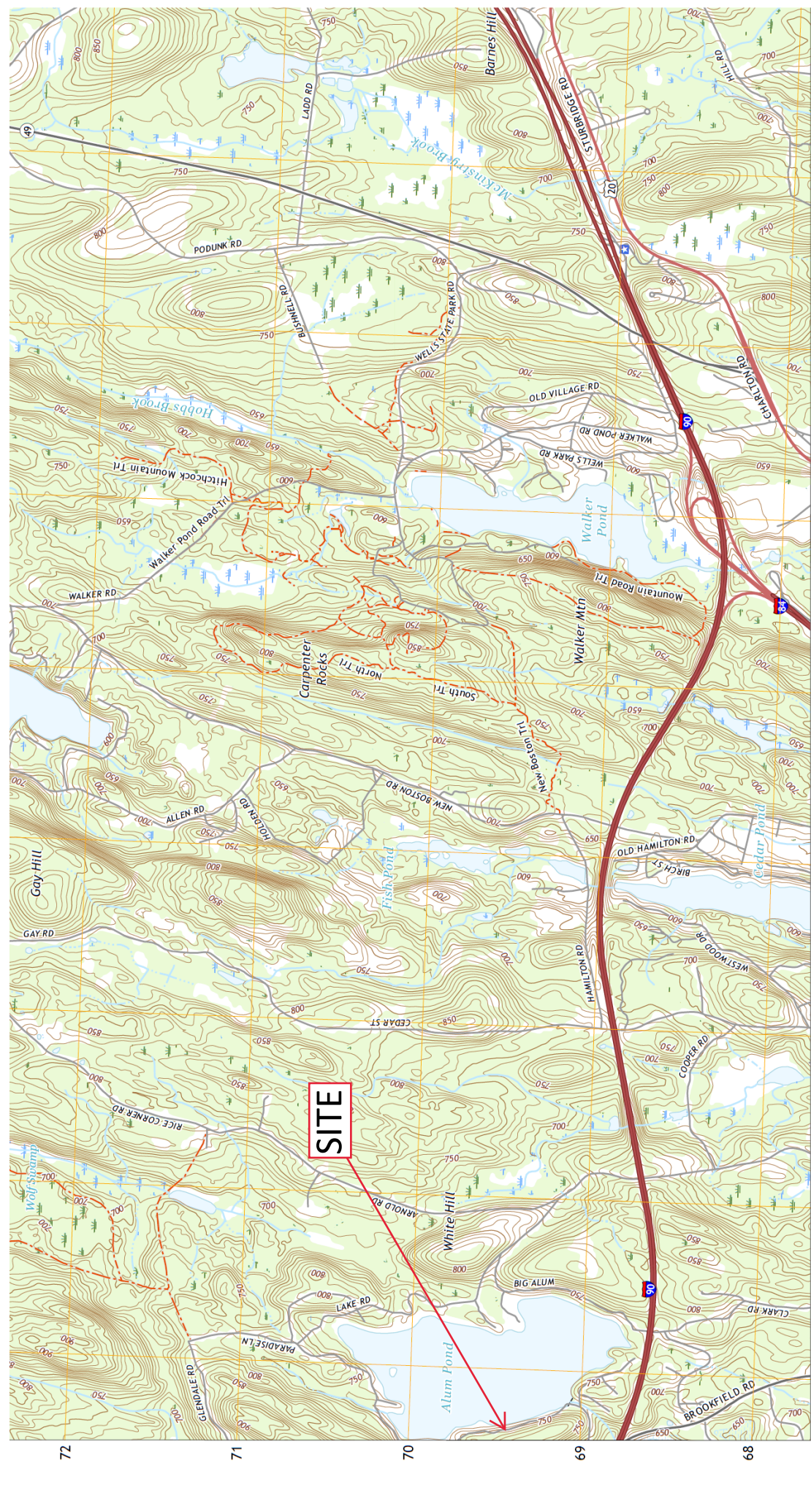

East Brookfield USGS Quad 2021

QUADRANGLE LOCATION

1	2	3	4	5	6	7	8
---	---	---	---	---	---	---	---

ADJACENT QUADRANGLES

- 1 Ware
- 2 North Brookfield
- 3 Paxton
- 4 Warren
- 5 Leicester
- 6 Wales
- 7 Southbridge
- 8 Webster

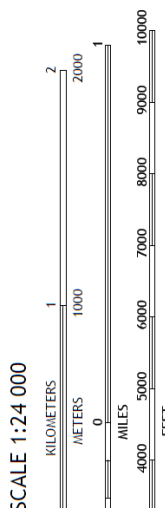

CONTOUR INTERVAL 10 FEET
NORTH AMERICAN VERTICAL DATUM OF 1988

This map was produced to conform with the National Geospatial Program US Topo Product Standard.

14° 0' 148'

248 MILLS 35 MILLS

UTM GRID AND 1983 MAGNETIC NORTH DECLINATION AT CENTER OF SHEET

U.S. National Grid	100,000 - m Square ID
YM	BG
Grid Zone Designation	18T
	19T

Produced by the United States Geological Survey
 North American Datum of 1983 (NAD83)
 World Geodetic System of 1984 (WGS84). Projection and 1 000-meter grid: Universal Transverse Mercator, Zone 18T
 This map is not a legal document. Boundaries may be generalized for this map scale. Private lands within government reservations may not be shown. Obtain permission before entering private lands.

Imagery:NAIP, October 2018 - October 2018
 U.S. Census Bureau, 2018
 GNS, 1974 - 2020
 National Hydrography Dataset, 2004 - 2021
 National Elevation Dataset, 2019
 Multiple sources; see metadata file 2018 - 2019

.....FWS National Wetlands Inventory 2008

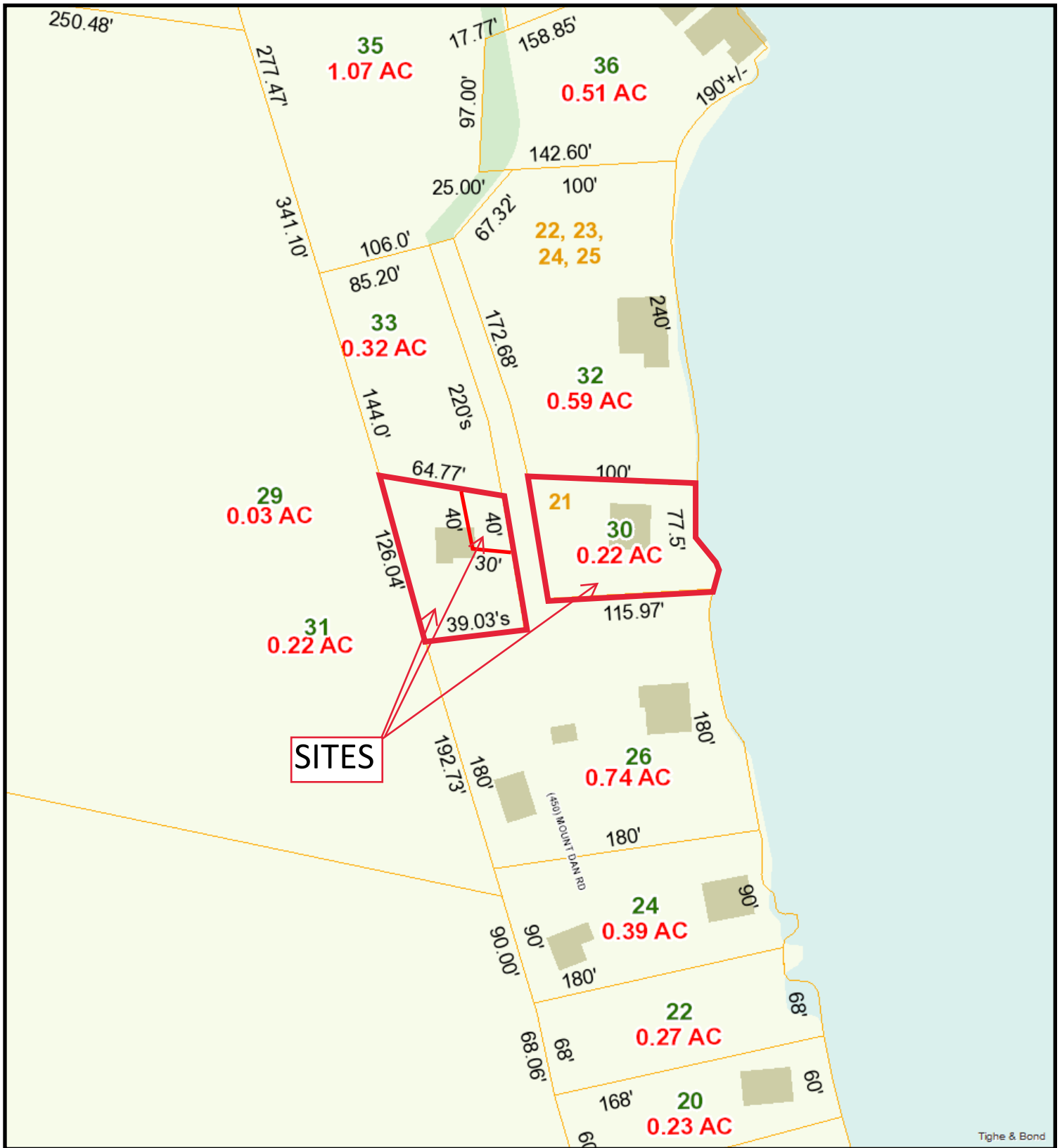

Mt Dan Road

3/5/2024 10:17:54 AM

Scale: 1"=100'

Scale is approximate

The information depicted on this map is for planning purposes only. It is not adequate for legal boundary definition, regulatory interpretation, or parcel-level analyses.



Tighe & Bond

3A

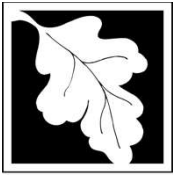

Massachusetts Department of Environmental Protection
 Bureau of Resource Protection - Wetlands
NOI Wetland Fee Transmittal Form
 Massachusetts Wetlands Protection Act M.G.L. c. 131, §40

Important: When filling out forms on the computer, use only the tab key to move your cursor - do not use the return key.



A. Applicant Information

1. Location of Project:

<u>29, 30 & 31 Mt Dan Road</u>	<u>Sturbridge</u>
a. Street Address	b. City/Town
<u>1118 (1119 municipal & 1120 bylaw)</u>	<u>\$42.50 (\$67.50 municipal & \$300.00 bylaw)</u>
c. Check number	d. Fee amount

2. Applicant Mailing Address:

<u>Keith & Stephanie</u>	<u>Fiorucci</u>	
a. First Name	b. Last Name	
<u></u>		
c. Organization		
<u>25 Tannery Road</u>		
d. Mailing Address		
<u>Fiskdale</u>	<u>MA</u>	<u>01518</u>
e. City/Town	f. State	g. Zip Code
<u></u>	<u></u>	<u></u>
h. Phone Number	i. Fax Number	j. Email Address

3. Property Owner (if different):

<u>(Same as above)</u>	
a. First Name	b. Last Name
<u></u>	
c. Organization	
<u></u>	
d. Mailing Address	
<u></u>	<u></u>
e. City/Town	g. Zip Code
<u></u>	<u></u>
h. Phone Number	i. Fax Number
<u></u>	<u></u>
j. Email Address	
<u></u>	

B. Fees

Fee should be calculated using the following process & worksheet. **Please see Instructions before filling out worksheet.**

Step 1/Type of Activity: Describe each type of activity that will occur in wetland resource area and buffer zone.

Step 2/Number of Activities: Identify the number of each type of activity.

Step 3/Individual Activity Fee: Identify each activity fee from the six project categories listed in the instructions.

Step 4/Subtotal Activity Fee: Multiply the number of activities (identified in Step 2) times the fee per category (identified in Step 3) to reach a subtotal fee amount. Note: If any of these activities are in a Riverfront Area in addition to another Resource Area or the Buffer Zone, the fee per activity should be multiplied by 1.5 and then added to the subtotal amount.

Step 5/Total Project Fee: Determine the total project fee by adding the subtotal amounts from Step 4.

Step 6/Fee Payments: To calculate the state share of the fee, divide the total fee in half and subtract \$12.50. To calculate the city/town share of the fee, divide the total fee in half and add \$12.50.

To calculate filing fees, refer to the category fee list and examples in the instructions for filling out WPA Form 3 (Notice of Intent).



Massachusetts Department of Environmental Protection
 Bureau of Resource Protection - Wetlands
NOI Wetland Fee Transmittal Form
 Massachusetts Wetlands Protection Act M.G.L. c. 131, §40

B. Fees (continued)

Step 1/Type of Activity	Step 2/Number of Activities	Step 3/Individual Activity Fee	Step 4/Subtotal Activity Fee
Category 1.a.	1	\$110.00	\$110.00
_____	_____	_____	_____
_____	_____	_____	_____
_____	_____	_____	_____
_____	_____	_____	_____
_____	_____	_____	_____
_____	_____	_____	_____
_____	_____	_____	_____
Step 5/Total Project Fee:			\$110.00 (+\$300 bylaw)
Step 6/Fee Payments:			
Total Project Fee:			\$110.00 (+\$300 bylaw)
State share of filing Fee:			\$42.50
City/Town share of filing Fee:			\$67.50 (+\$300 bylaw)
			a. Total Fee from Step 5
			b. 1/2 Total Fee less \$12.50
			c. 1/2 Total Fee plus \$12.50

C. Submittal Requirements

- a.) Complete pages 1 and 2 and send with a check or money order for the state share of the fee, payable to the Commonwealth of Massachusetts.

Department of Environmental Protection
 Box 4062
 Boston, MA 02211

- b.) **To the Conservation Commission:** Send the Notice of Intent or Abbreviated Notice of Intent; a **copy** of this form; and the city/town fee payment.

To MassDEP Regional Office (see Instructions): Send a copy of the Notice of Intent or Abbreviated Notice of Intent; a **copy** of this form; and a **copy** of the state fee payment. (E-filers of Notices of Intent may submit these electronically.)

STURBRIDGE WETLANDS PROTECTION BY-LAW AND REGULATIONS

WETLANDS FILING FEE CALCULATION WORKSHEET

Application Type	Qty	Town Filing Fee	TOTAL
Notice of Intent (NOI):			
Residential – Single Family:			
Accessory (Deck, Shed, Pool Septic)	<input type="text" value="2"/>	\$150	<input type="text" value="\$300.00"/>
Shoreline Work	<input type="text"/>	\$150	<input type="text"/>
New Construction	<input type="text"/>	\$300	<input type="text"/>
Residential – Other:			
Subdivision/Multi-Unit	<input type="text"/>	\$750	<input type="text"/>
Commercial/Industrial:			
New	<input type="text"/>	\$1500	<input type="text"/>
Redevelopment	<input type="text"/>	\$1000	<input type="text"/>
Limited Project (as defined in SWB & WPA)	<input type="text"/>	Equal to full WPA fee	<input type="text"/>
Alterations – located within Riverfront Area	<input type="text"/>	Additional 50% of Fee	<input type="text"/>
Application filed after Enforcement Order		Double the Municipal fee	<input type="text"/>
Request for Amended Order of Conditions	<input type="text"/>	50% of initial fee	<input type="text"/>
Request for Determination of Applicability (RDA):			
No Wetland Boundary Confirmation Residential:	<input type="text"/>	\$100	<input type="text"/>
No Wetland Boundary Confirmation All Other:	<input type="text"/>	\$200	<input type="text"/>
For Wetland Boundary Confirmation File ANRAD or NOI			
Abbreviated Notice of Resource Area Delineation (ANRAD):			
Residential – Single Family:	<input type="text"/>	\$100	<input type="text"/>
All Other:			
Base Review	<input type="text"/>	\$300	<input type="text"/>
Resource Area Boundary			

Certificate of Compliance (COC):

Residential:			
Single Family	<input type="checkbox"/>	\$50	<input type="text"/>
Subdivision or Multi-Unit	<input type="checkbox"/>	\$150	<input type="text"/>
Commercial or Industrial:	<input type="checkbox"/>	\$150	<input type="text"/>
If Order of Conditions has Expired	<input type="checkbox"/>	Add an additional \$150	<input type="text"/>
OOO Extension Request	<input type="checkbox"/>	\$50	<input type="text"/>
Emergency Certification (NOI may be required to be filed following issuance of Emergency Cert)	<input type="checkbox"/>	\$50	<input type="text"/>

Local Bylaw Fee (includes Town Filing Fee)	\$ <input type="text" value="300.00"/>
State Filing Fee (from DEP Wetland Transmittal Form)	\$ <input type="text" value="67.50"/>
<u>Total Payable to "Town of STURBRIDGE"</u>	\$ <input type="text" value="367.50"/>

*Additional Consultant Fee may be required for reasons which may include:

- Significant amount of wetland impact;
- Extensive resource areas on a site;
- Lack of information supplied;
- Incomplete plans, reports, forms submitted;
- Supplemental information submitted.

Parcel ID	Owner	Owner Address	Owner City	State	Zip	Property Address
173-01413-230	FIORUCCI KEITH E	25 TANNERY ROAD	FISKDALE	MA	01518	230 BROOKFIELD ROAD
450-01415-029	FIORUCCI KEITH E	25 TANNERY ROAD	FISKDALE	MA	01518	29 MT DAN ROAD
450-01415-031	FIORUCCI KEITH E	25 TANNERY ROAD	FISKDALE	MA	01518	31 MT DAN ROAD
450-01415-033	HOWLETT JANE F	865 HOPE STREET	BRISTOL	RI	02809	33 MT DAN ROAD
450-01415-035	HOWLETT JEFFREY R	32 MT DAN ROAD	STURBRIDGE	MA	01566	35 MT DAN ROAD
450-01415-032	HOWLETT JEFFREY R	32 MT DAN ROAD	FISKDALE	MA	01518	32 MT DAN ROAD
450-01415-026	NUNHEIMER MARK J	45 JOHN MYRICK CIRCLE	BREWSTER	MA	02631	26 MT DAN ROAD
450-01415-024	WALLINGFORD MACKENZIE SCOTT	PO BOX 264	EAST LONGMEADOW	MA	01028	24 MT DAN ROAD
	BOARD OF ASSESSORS					
Above persons listed are record owners as they appear on the most recent applicable tax list.						
Assessors are not responsible for errors or omissions. RE: M.G.L. - Chapter 40A, Section 11						
Abutters List -	Conservation Commission - 200'					
RE: 30 MT DAN ROAD						
Certified Copy						
Assessor:	<i>Don P. Murphy</i>					
Date:	<i>2-16-2024</i>					

Parcel ID	Owner	Owner Address	Owner City	State	Zip	Property Address
173-01413-230	FIORUCCI KEITH E	25 TANNERY ROAD	FISKDALE	MA	01518	230 BROOKFIELD ROAD
450-01415-030	FIORUCCI KEITH E	25 TANNERY ROAD	FISKDALE	MA	01518	30 MT DAN ROAD
450-01415-029	FIORUCCI KEITH E	25 TANNERY ROAD	FISKDALE	MA	01518	29 MT DAN ROAD
450-01415-033	HOWLETT JANE F	865 HOPE STREET	BRISTOL	RI	02809	33 MT DAN ROAD
450-01415-035	HOWLETT JEFFREY R	32 MT DAN ROAD	STURBRIDGE	MA	01566	35 MT DAN ROAD
450-01415-032	HOWLETT JEFFREY R	32 MT DAN ROAD	FISKDALE	MA	01518	32 MT DAN ROAD
450-01415-026	NUNHEIMER MARK J	45 JOHN MYRICK CIRCLE	BREWSTER	MA	02631	26 MT DAN ROAD
640-01435-336	RENO ANTHONY P	336 THE TRAIL	FISKDALE	MA	01518	336 THE TRAIL
450-01415-024	WALLINGFORD MACKENZIE SCOTT	PO BOX 264	E LONGMEADOW	MA	01028	24 MT DAN ROAD
	BOARD OF ASSESSORS					
Above persons listed are record owners as they appear on the most recent applicable tax list.						
Assessors are not responsible for errors or omissions. RE: M.G.L. - Chapter 40A, Section 11						
Abutters List -	Conservation Commission - 200'					
RE: 31 MT DAN ROAD						
Certified Copy						
Assessor:						
Date:	2-20-2024					

AFFIDAVIT OF SERVICE

UNDER THE MASSACHUSETTS WETLANDS PROTECTION ACT AND TOWN OF STURBRIDGE WETLAND PROTECTION BYLAW

(To be submitted to the Massachusetts Department of Environmental Protection & the Conservation Commission when filing a Notice of Intent)

I, Glenn E. Krevosky, hereby certify under the pains and penalties of perjury that on **March xx, 2024**, I gave notification to abutters within 200 feet of the proposed project in compliance with the second paragraph of the Massachusetts General Laws, Chapter 131, Section 40 and the DEP Guide to Abutter Notification, dated April 8, 1994, in connection with the following matter:

A Notice of Intent (NOI) application filed under the Massachusetts Wetlands Protection Act and The Town of Sturbridge Wetland Protection Bylaw by EBT Environmental Consultants, Inc., 601 Main Street, North Oxford, MA 01537, with the Sturbridge Conservation Commission on March 7, 2024 for a property located at, 29, 30 & 31 Mt Dan Road, Fiskdale.

The form of the notification and the list of the abutters to whom it was given and their addresses are attached to this Affidavit of Service.

Signature

3-xx-2024

Date



Town of Sturbridge

Barbara A. Barry, Finance Director

Department/Board/Committee:

Please verify outstanding tax/fee status for the following property owner:

Property Owner:

Property Location:

- The license/permit may be released.
 The license/permit may not be released.

For Wendy MacGregor
Finance Director

2/14/24
Date



Photo 1 taken by EBT, Inc. on 2/17/2024 – Standing at the existing dock facing south showing the limit of the land under water body and the bank. There is no BVW.



Photo 2 taken by EBT, Inc. on 2/17/2024 – Standing at the existing dock facing north showing the limit of the land under water body and the bank. There is no BVW. Some of the limits of the Japanese Knotweed can be seen in the photo.

- > Conservation / Recreation
- > Cultural Resources
- > Environmental Monitoring (testing/monitoring sites)
- > Images
- > Index (grids/tiling schemes for certain layers)
- > Infrastructure
- > Physical Resources
- > Political / Administrative Boundaries
- > Regulated Areas
- > Status / Availability (maps showing where data is available or date of data)
- > Tiled Layers

- [FEMA National Flood Hazard Layer Polygons](#)
- 1% Annual Chance Flood Hazard
- Regulatory Floodway
- Area of Undetermined Flood Hazard
- 0.2% Annual Chance Flood Hazard
- Area with Reduced Risk Due to Levee
- Area Not Included
- [NHESP Estimated Habitats of Rare Wildlife](#)
- [NHESP Priority Habitats of Rare Species](#)
- [Potential Vernal Pools](#)
- [NHESP Certified Vernal Pools](#)
- [Property Tax Parcels](#)

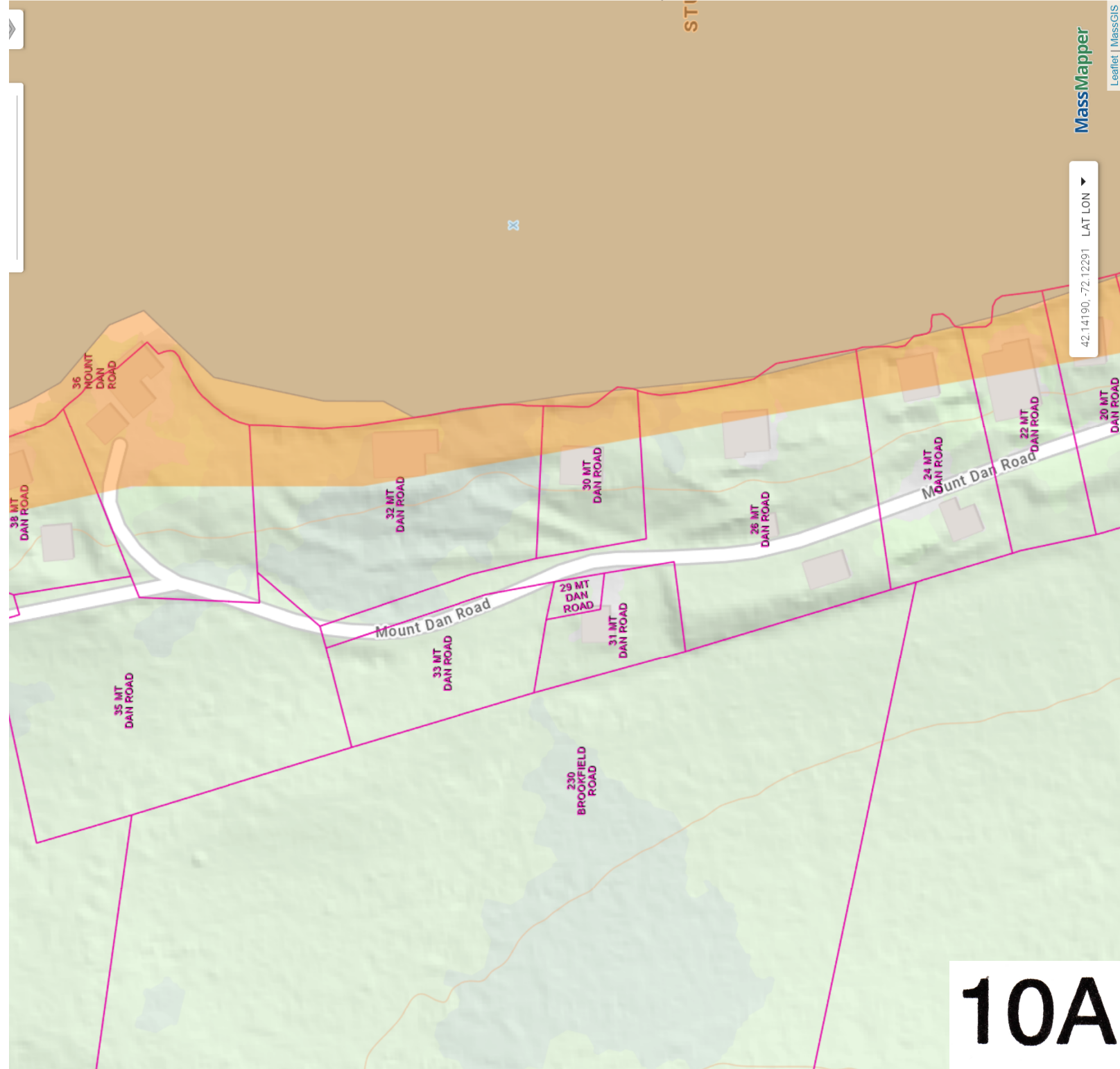

10A