

FORM B – BUILDING

MASSACHUSETTS HISTORICAL COMMISSION
MASSACHUSETTS ARCHIVES BUILDING
220 MORRISSEY BOULEVARD
BOSTON, MASSACHUSETTS 02125

Assessor's Number USGS Quad Area(s) Form Number

665-04311-116

Southbridge

STU.311

Town/City: Sturbridge

Place: (*neighborhood or village*): Westville

Photograph



Locus Map

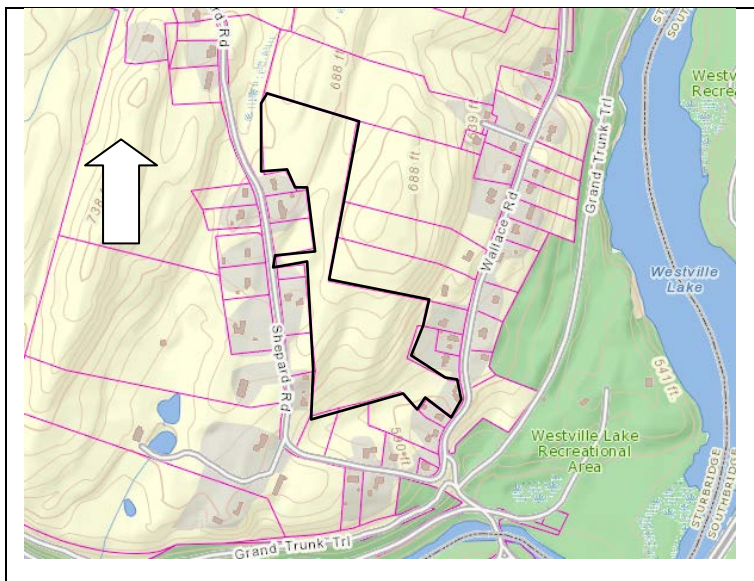

Address: 116 Wallace Road

Historic Name: Plimpton Farm

Uses: Present: Single Family Dwelling

Original: Single Family Dwelling/Agricultural

Date of Construction: Prior to 1857

Source: 1857 Map; 1888 and 1893 Deeds

Style/Form: Altered

Architect/Builder: Unknown

Exterior Material:

Foundation: Appears to be stone, not all visible

Wall/Trim: Clapboard, Asphalt and Wood Shingle/Wood

Roof: Asphalt Shingle

Outbuildings/Secondary Structures:

None

Major Alterations (*with dates*):

Exterior Siding (dates unknown)

Some window alterations (date unknown)

Condition: Fair

Moved: no ☒ yes ☐ **Date:**

Acreage: 11.77 acres

Setting: Large, irregularly shaped parcel on the western side of Wallace Road. Residential building is towards the southeastern corner of the parcel. Near the intersection of Wallace and Shepard Roads and to the west of the Grand Trunk Trail and the Westville Lake Recreational Area.

Recorded by: Shannon Walsh, PVPC

Organization: Sturbridge Historical Commission

Date (*month / year*): March 2017

INVENTORY FORM B CONTINUATION SHEET

STURBRIDGE

116 WALLACE ROAD

MASSACHUSETTS HISTORICAL COMMISSION

220 MORRISSEY BOULEVARD, BOSTON, MASSACHUSETTS 02125

Area(s) Form No.

STU.311

☐ Recommended for listing in the National Register of Historic Places.

If checked, you must attach a completed National Register Criteria Statement form.

Use as much space as necessary to complete the following entries, allowing text to flow onto additional continuation sheets.

ARCHITECTURAL DESCRIPTION:

Describe architectural features. Evaluate the characteristics of this building in terms of other buildings within the community.

The Plimpton Farm, constructed by the mid-nineteenth century, was probably a Georgian style single family dwelling, with later alterations, representative of the time period's residential and agricultural growth and development in the Westville area of Sturbridge. This two and a half story high building has what appears to be a stone foundation. The exterior is a mix of clapboard, asphalt shingle, and wood shingle siding with wood trim, to include two-story cornerboards. The side gable, asphalt shingle roof has overhanging eaves on the northern and southern facing elevations and eave returns at the gable ends. A central, interior brick chimney is set slightly off center, along the roof ridge and a second, exterior brick chimney is on the western facing side of the main section of the building. Windows are generally 6/6 and appear to be wood sash, with the exception of some alterations.

The northern, eastern, and southern elevations each have off-centered entries, so it is difficult to determine which one was the original main façade. The central section of the residence is three bays by four bays, and there is a one story ell off of the western elevation, which connects to a one story north/south aligned, rectangular plan ell, with wood shingle siding, which has rolling doors at the northeastern corner, with upper divided lights. The eastern facing elevation of this ell also has two 6/6 windows.

The eastern facing elevation first story of the central residential section has a paneled door with sidelights at the northeastern corner, and two 6/6 windows towards the southeastern corner. The second story has three, asymmetrically spaced 6/6 windows, and there are two, 6/6 windows in the upper half story gable.

The southern facing elevation of this section has three, asymmetrically spaced, 6/6 first story windows, and a paneled entry with a simple, unpedimented entablature and side lights. The second story has three 6/6 windows, with lintels up to the cornice line and eaves, as well as a smaller, slider window with infill below towards the southwestern upper corner.

HISTORICAL NARRATIVE

Discuss the history of the building. Explain its associations with local (or state) history. Include uses of the building, and the role(s) the owners/occupants played within the community.

The Globe Village waterfront area in Southbridge (bordering the Westville section of Sturbridge) was first utilized beginning in 1750 to power mills, and by the early nineteenth century, by various enterprises which led to the formal incorporation of the James Wolcott Woolen Company in 1819, operated by James Wolcott, Jr., Perez B. Wolcott (agent in 1820) and Samuel A. Groves.^{1 2}

A dam, constructed by the company in 1827, broke in 1829, and the loss caused the Wolcotts to sell the business. New owners were Boston-based Tiffany, (Willard) Sayles and (Samuel A.) Hitchcock who formed the Hamilton Woolen Company in 1831, proclaimed to be "one of the most successful establishments in the country" by 1856.^{3 4}

¹ E. Woodward and S. Ceccacci. "Hamilton Woolen Company District." (MHC Inventory # SBD.W), 1986. <http://mhc-macris.net/Details.aspx?Mhclid=SBD.W>, accessed November 2017.

² Hamilton Hurd, ed. "Early Manufacturers and Extinct Corporations and Companies." *History of Worcester County* ("Sturbridge, Levi Chase), 1899. *Archive.org* Accessed on-line July 2017, <https://archive.org/stream/historyofworcest01hurdd/page/n275/mode/2up/search/Sturbridge>

³ E. Woodward and S. Ceccacci, *Ibid.*

⁴ George Davis. *A Historical Sketch of Sturbridge and Southbridge*. West Brookfield: Power Press of O.S. Cooke and Co., 1856. *Archive.org*, <https://archive.org/details/historicalskech00davisgeo>, accessed November, 2017.

INVENTORY FORM B CONTINUATION SHEET

STURBRIDGE

116 WALLACE ROAD

MASSACHUSETTS HISTORICAL COMMISSION

220 MORRISSEY BOULEVARD, BOSTON, MASSACHUSETTS 02125

Area(s) Form No.

STU.311

The growth of this industry led to the development of worker housing on Wallace and Shepherd Roads in Westville during the late eighteenth to early nineteenth century, which mixed with what were probably preexisting residences, such as this property.⁵

The Plimpton family, whose ancestors came to the area from Medfield, "were among the first settlers in the southern part of town."⁶ The genealogy research is complex, as there were numerous Plimptons (last name also spelled "Plympton" and "Plymton") who settled in the area and several references to property owned under this name appears on historic maps of Sturbridge.

This property on Wallace Street was originally developed by the time of and in close proximity to the aforementioned area of rapid industrial growth in Westville. A late nineteenth century deed refers to this land along Wallace Road as "Plimpton Farm."⁷ Earlier maps corroborate this as Sally W. Plimpton (1799-1887), daughter of Captain Elias Plimpton (ca. 1749-1813) and Anna W. Plimpton (ca. 1759-1844), is listed as the owner in an 1855 census and on 1857 and 1870 maps. (Figures 1 and 2)

Deeds from 1888 and 1893 show the transfer of ownership to Marcelina St. Germain (born ca. 1859).⁸ Marcelina was of French Canadian ancestry and her husband, Flavien L. St. Germain (1847-1914), was a farmer and French Canadian immigrant who arrived in the United States in 1869.⁹ (Figure 3)

In the early 1930s, Louis Lataille (born ca. 1890) and Anna G. Lataille (born ca. 1891) were the owners. In the 1920s, Louis worked as a solderer for the American Optical Company.^{10 11}

BIBLIOGRAPHY and/or REFERENCES

Ancestry.com (see footnotes)

Davis, George. *A Historical Sketch of Sturbridge and Southbridge*. West Brookfield: Power Press of O.S. Cooke and Co., 1856. *Archive.org*, <https://archive.org/details/historicalskech00davisgeo>, accessed November, 2017.

FindaGrave.com

Hurd, Hamilton, ed. "Early Manufacturers and Extinct Corporations and Companies." *History of Worcester County* ("Sturbridge, Levi Chase), 1899. *Archive.org* Accessed on-line July 2017, <https://archive.org/stream/historyofworcest01hurdd/page/n275/mode/2up/search/Sturbridge>

Massachusetts Historical Commission. "MHC Reconnaissance Survey Town Report: Sturbridge." 1984. <https://www.sec.state.ma.us/mhc/mhcpdf/townreports/Cent-Mass/stu.pdf>, accessed October 2017.

Masslandrecords.com (see footnotes)

Woodward, E. and S. Ceccacci. "Hamilton Woolen Company District." (MHC Inventory # SBD.W), 1986. <http://mhc-macris.net/Details.aspx?Mhclid=SBD.W>, accessed November 2017.

Figure 1: Walling, H.F. *Map of Worcester County*, Boston: Wm. E. Baker, 1857, <https://www.loc.gov/resource/g3763w.la000320/>

Figure 2: *Atlas of Worcester County*, F. W. Beers & Co. 1870, <https://www.digitalcommonwealth.org/search/commonwealth:x059cb92c>

⁵ Massachusetts Historical Commission. "MHC Reconnaissance Survey Town Report: Sturbridge." 1984. <https://www.sec.state.ma.us/mhc/mhcpdf/townreports/Cent-Mass/stu.pdf>, accessed October 2017.

⁶ Ibid.

⁷ Book 1260 Page 296 (1888); Book 1413 Page 234 (1893), *Masslandrecords.com*

⁸ Ibid.

⁹ "Flavien L. St. Germaine," *United States Federal Census*, 1900. *Ancestry.com*

¹⁰ "Louis Lataille," *United States Federal Census*, 1920. *Ancestry.com*

¹¹ "Lataille, Louis," *Sturbridge Directory*, 1919 (page 268). *Ancestry.com*

INVENTORY FORM B CONTINUATION SHEET

STURBRIDGE

116 WALLACE ROAD

MASSACHUSETTS HISTORICAL COMMISSION
220 MORRISSEY BOULEVARD, BOSTON, MASSACHUSETTS 02125

Area(s)	Form No.
	STU.311

Figure 3: Richards, L.J. "Charlton-Sturbridge-Southbridge-Dudley Towns." *Topographical Atlas of the County of Worcester*, 1898. *HistoricMapWorks.com* (site). Accessed on-line October 2017.
<http://www.historicmapworks.com/Atlas.php?cat=Maps&c=US&a=6717>



Photo 1: Southern elevation



Photo 2: Southern and eastern facing elevations

INVENTORY FORM B CONTINUATION SHEET

STURBRIDGE

116 WALLACE ROAD

MASSACHUSETTS HISTORICAL COMMISSION
220 MORRISSEY BOULEVARD, BOSTON, MASSACHUSETTS 02125

Area(s)	Form No.
	STU.311



Photo 3: Eastern elevation



Photo 4: Northern elevation of residence and eastern facing elevation of

INVENTORY FORM B CONTINUATION SHEET

STURBRIDGE

116 WALLACE ROAD

MASSACHUSETTS HISTORICAL COMMISSION
220 MORRISSEY BOULEVARD, BOSTON, MASSACHUSETTS 02125

Area(s)	Form No.
	STU.311



Photo 5: Eastern and northern elevations of attached ell

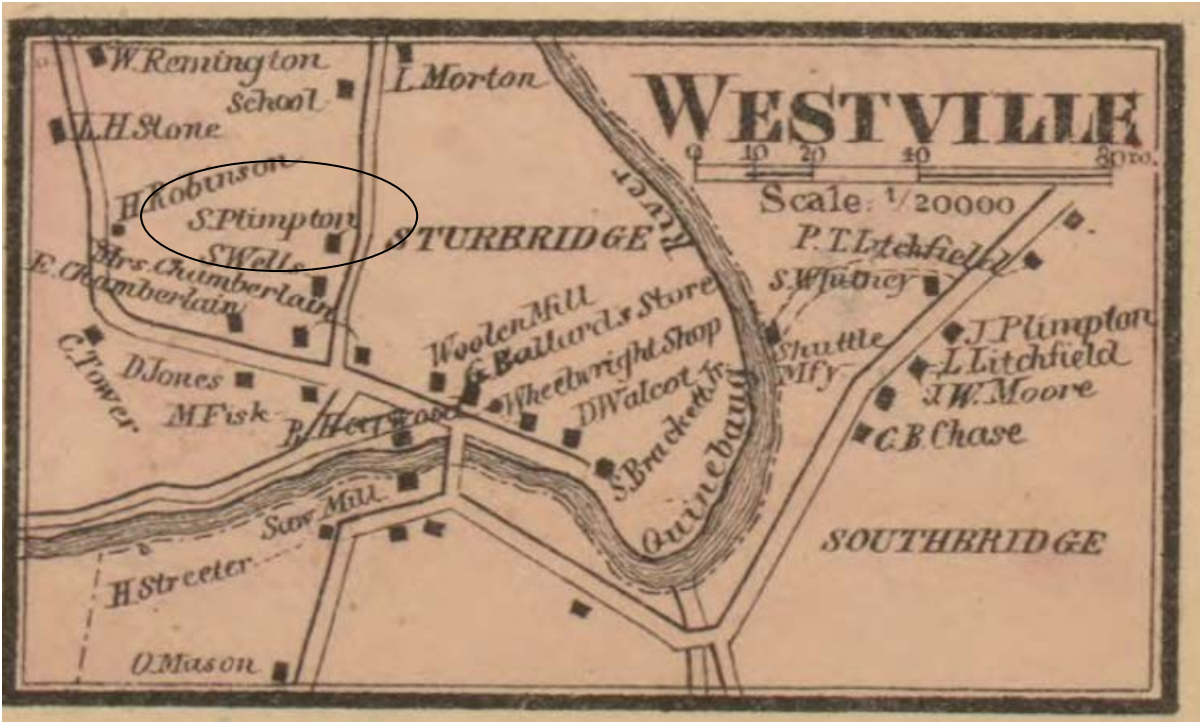

Figure 1: 1857 Map

MASSACHUSETTS HISTORICAL COMMISSION
220 MORRISSEY BOULEVARD, BOSTON, MASSACHUSETTS 02125

Area(s) Form No.

STU.311

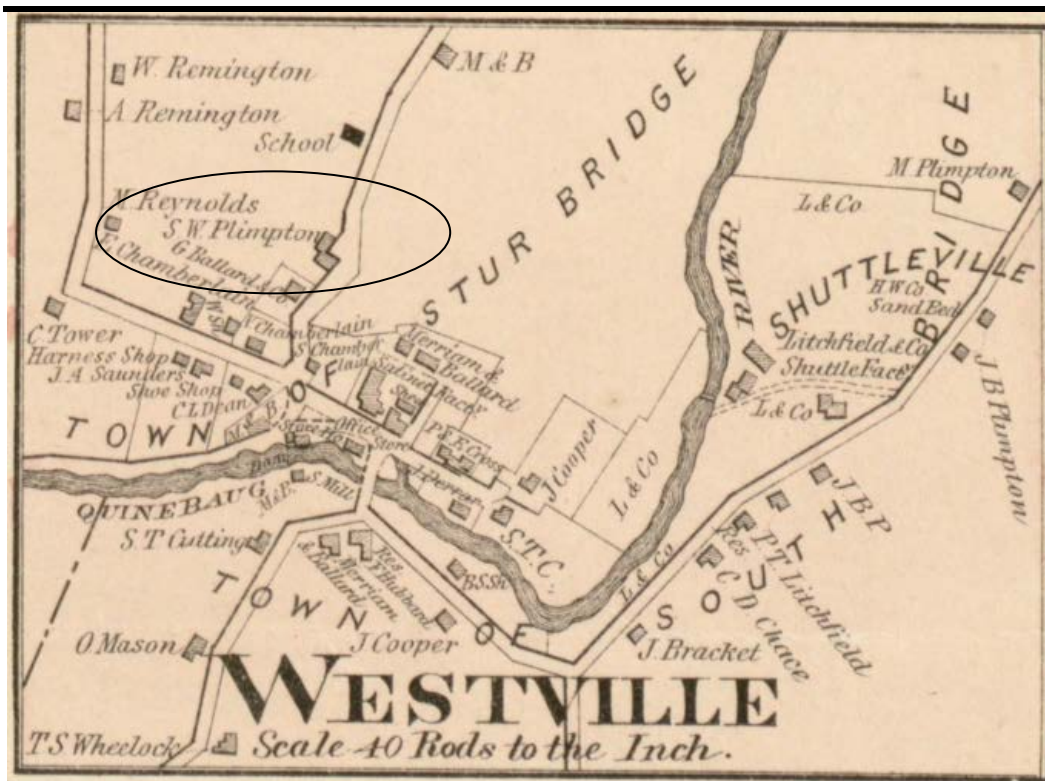

Figure 2: 1870 Map

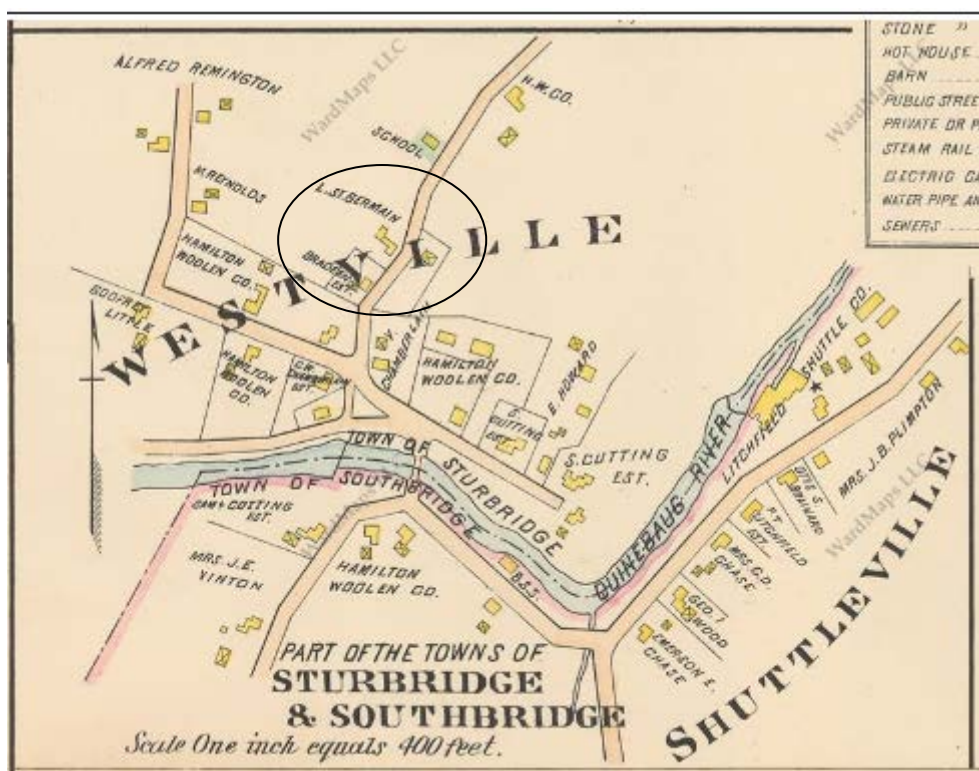

Figure 3: 1898 Map