

## FORM B – BUILDING

MASSACHUSETTS HISTORICAL COMMISSION  
MASSACHUSETTS ARCHIVES BUILDING  
220 MORRISSEY BOULEVARD  
BOSTON, MASSACHUSETTS 02125

### Photograph



### Locus Map

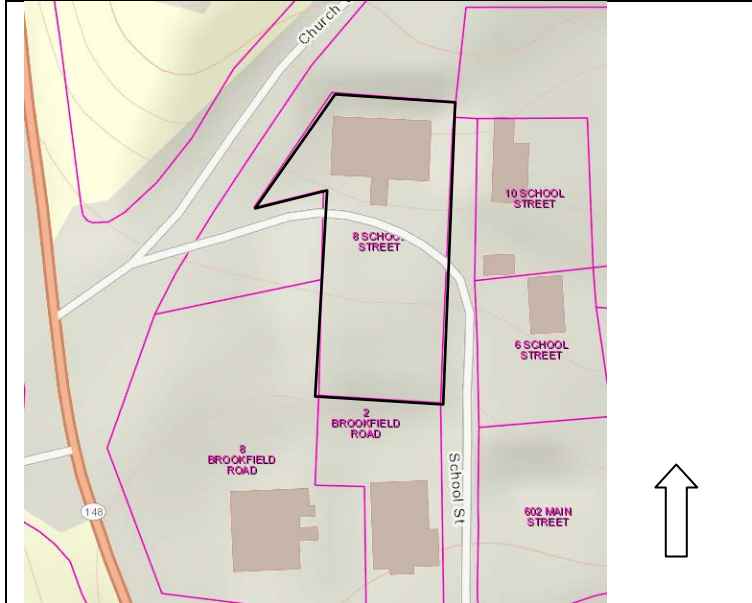

**Recorded by:** Shannon Walsh, PVPC

**Organization:** Sturbridge Historical Commission

**Date** (*month / year*): March 2017

Assessor's Number USGS Quad Area(s) Form Number

565-02327-008

Southbridge

STU.E

STU.165

**Town/City:** Fiskdale

**Place:** (*neighborhood or village*): Fiskdale

**Address:** 8 School Street

**Historic Name:** Fiskdale School

**Uses:** Present: Apartment House

Original: School

**Date of Construction:** 1896

**Source:** Date is on building façade

**Style/Form:** Italianate, altered

**Architect/Builder:** Julia A. or Henry D. Haynes/Calvin Claflin

**Exterior Material:**

Foundation: Appears to be Granite

Wall/Trim: Brick, Wood, Vinyl/Wood, Appears to be Granite

Roof: Asphalt Shingle

**Outbuildings/Secondary Structures:**

None

**Major Alterations** (*with dates*):

Replacement windows (date unknown)

Added portico and vestibule (date unknown)

Skylights (date unknown)

**Condition:** Fair due to alterations

**Moved:** no ☒ yes ☐ **Date:**

**Acreage:** .68 acres

**Setting:** Large, irregularly shaped parcel intersected by School Street. Residential building faces south along School Street, near the intersection of School with Brookfield Road and just off of Main Street (Route 20)

# INVENTORY FORM B CONTINUATION SHEET

STURBRIDGE

8 SCHOOL STREET

## MASSACHUSETTS HISTORICAL COMMISSION

220 MORRISSEY BOULEVARD, BOSTON, MASSACHUSETTS 02125

Area(s) Form No.

STU.E

STU.165

☐ Recommended for listing in the National Register of Historic Places.

*If checked, you must attach a completed National Register Criteria Statement form.*

*Use as much space as necessary to complete the following entries, allowing text to flow onto additional continuation sheets.*

### ARCHITECTURAL DESCRIPTION:

*Describe architectural features. Evaluate the characteristics of this building in terms of other buildings within the community.*

The Fiskdale School, at 8 School Street, is a late nineteenth century institutional building, formerly used as a school, and later adapted for reuse as a multi-unit apartment building. It provides evidence of the growth and development of Fiskdale during the late 1800s. This two and a half story building is seven bays wide by three bays deep, with an east/west aligned rectangular plan. The foundation is granite, the exterior is primarily brick, with some vinyl details on the portico, and there is also stone and wood trim. It has an asphalt shingle, hipped roof with a cross gable dormer, pronounced, overhanging eaves and a bracketed cornice. Modern skylights are set within the roof. Windows are 1/1 replacements, but were formerly arched, typical of Italianate style and similar to the Snellville School at 480 Main Street (STU.113). Raised brick detailing, reminiscent of a belt course, is present between the sills and arched lintels of the windows, as well as near the roof eaves.

The main, southern facing façade has 18 single windows and one paired window, all with arched, brick lintels. Sills on the first and second stories are granite and windows are 1/1. Ground level slider windows are divided vertically into two lights. There is a circular window with four divided lights set within the upper story, front gable dormer. Beneath this window, is a stone rectangle with the date, 1896. Paired, elaborate, carved wood brackets are set at intervals beneath the eaves. (Photo 3) The main entry, which has been altered, is accessed by concrete stairs and metal railings and has a one and a half story pedimented portico, with slender support columns. (Figure 2) An enclosed vestibule with double glass doors and a transom light covers the original entry.

The eastern and western side elevations each have a single 1/1 window and two, paired 1/1 windows on the first and second stories.

### HISTORICAL NARRATIVE

*Discuss the history of the building. Explain its associations with local (or state) history. Include uses of the building, and the role(s) the owners/occupants played within the community.*

By the late 1800s, the Fiskdale area had developed as an institutional and commercial center, due to the presence of the Fiskdale mills and the Snell Manufacturing Company. Main Street development continued with further expansion into that area from the center of Sturbridge, as well as into the neighboring area of Southbridge. (Figure 1)

By 1896, a new, "more pleasant" location was sought for the Fiskdale School, to replace District School No. 13, with "a woman architect...at work on the plan, which will provide a four-room building of the semi-colonial style," presumed to be able "to meet the needs of Fiskdale for the next 75 years."<sup>1</sup> Julia A. Haynes (1863-1951), teacher and daughter of school committee member, Henry D. Haynes (1837-1922), and Lizzie M. Haynes (1837-1875), was related to the construction of this building in previous research so she may have been the referenced female architect.<sup>2 3</sup> Calvin Claflin (1844-1900) of Southbridge is said to have done the brickwork.<sup>4</sup>

By the early 1970s, the building was owned by St. Anne's Shrine for use as a Social Center.<sup>5</sup> Since then, it has been rehabilitated for adaptive reuse as a multi-unit apartment house.

<sup>1</sup> "Sturbridge. Town Meeting Warrant." *Worcester Daily Spy*, March 28, 1896. [Genealogybank.com](http://www.genealogybank.com)

<sup>2</sup> Helen G. Holley, "8 School Street" (MHC Inventory Form # STU.165), 1973. <http://mhc-macris.net/Details.aspx?MhclId=STU.165>, accessed July 2017.

<sup>3</sup> "Haynes, Julia Anna." *Massachusetts State Census*, 1865. [Ancestry.com](http://www.ancestry.com)

<sup>4</sup> Helen G. Holley, "8 School Street," *Ibid.*

<sup>5</sup> Helen G. Holley, "Snellville." (MHC Inventory Form #STU.C), 1973. <http://mhc-macris.net/Details.aspx?MhclId=STU.C>, accessed July 2017.

# INVENTORY FORM B CONTINUATION SHEET

STURBRIDGE

8 SCHOOL STREET

MASSACHUSETTS HISTORICAL COMMISSION

220 MORRISSEY BOULEVARD, BOSTON, MASSACHUSETTS 02125

Area(s) Form No.

STU.E

STU.165

## BIBLIOGRAPHY and/or REFERENCES

*Ancestry.com* (see footnotes)

*Genealogybank.com* (see footnotes)

Holley, Helen G. "8 School Street" (MHC Inventory Form # STU.165), 1973. <http://mhc-macris.net/Details.aspx?MhclId=STU.165>, accessed July 2017.

Holley, Helen G. "Snellville." (MHC Inventory Form #STU.C), 1973. <http://mhc-macris.net/Details.aspx?MhclId=STU.C>, accessed July 2017.

Massachusetts Historical Commission, "MHC Reconnaissance Survey Town Report, Sturbridge," 1984, *Sec.State.MA.US*, Accessed on-line July, 2017, <https://www.sec.state.ma.us/mhc/mhcpdf/townreports/Cent-Mass/stu.pdf>

Figure 1: Richards, L.J. "Charlton, Sturbridge, Southbridge, Dudley Towns, Worcester County, 1898, <http://www.wardmaps.com/viewasset.php?aid=12391>

Figure 2: Holley, Helen G. "8 School Street" (MHC Inventory Form # STU.165), 1973. <http://mhc-macris.net/Details.aspx?MhclId=STU.165>, accessed July 2017.



Photo 1: Southern facing main façade and glimpse of eastern side elevation



INVENTORY FORM B CONTINUATION SHEET

STURBRIDGE

8 SCHOOL STREET

MASSACHUSETTS HISTORICAL COMMISSION  
220 MORRISSEY BOULEVARD, BOSTON, MASSACHUSETTS 02125

Area(s)    Form No.

STU.E	STU.165
-------	---------



Photo 2: Southern facing main facade



Photo 3: Bracketed cornice and roof eave detailing, southern facing main façade

INVENTORY FORM B CONTINUATION SHEET

STURBRIDGE

8 SCHOOL STREET

MASSACHUSETTS HISTORICAL COMMISSION  
220 MORRISSEY BOULEVARD, BOSTON, MASSACHUSETTS 02125

Area(s)	Form No.
STU.E	STU.165

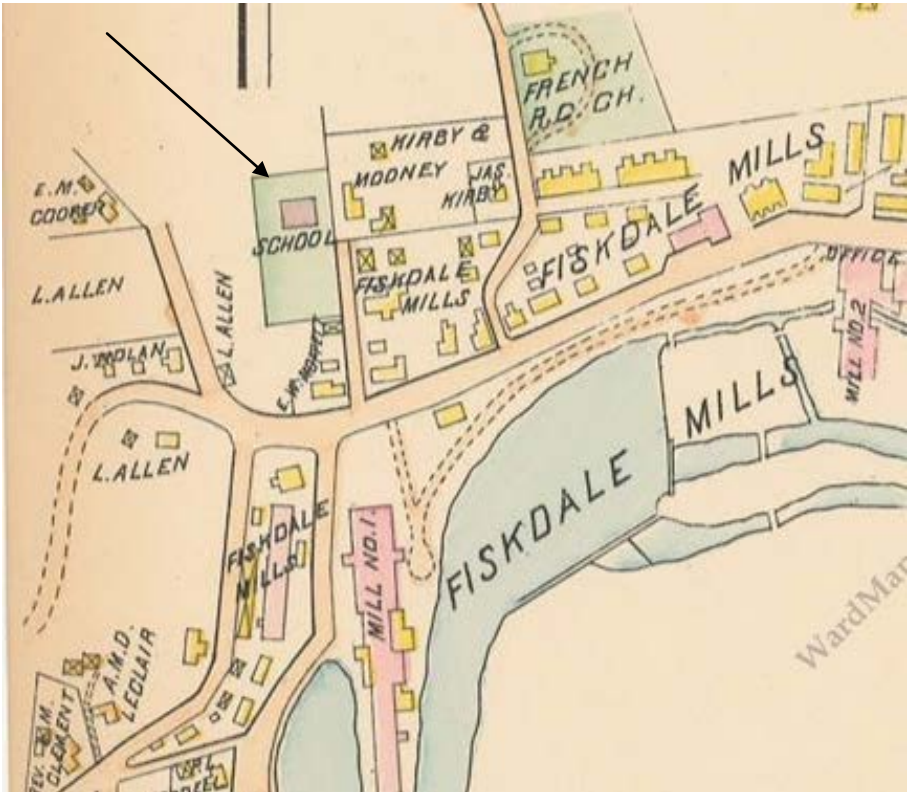

Figure 1: 1898 Map showing new Fiskdale School and proximity to mills



Figure 2: 1973 exterior photo