

# FORM B – BUILDING

MASSACHUSETTS HISTORICAL COMMISSION  
MASSACHUSETTS ARCHIVES BUILDING  
220 MORRISSEY BOULEVARD  
BOSTON, MASSACHUSETTS 02125

## Photograph



## Locus Map

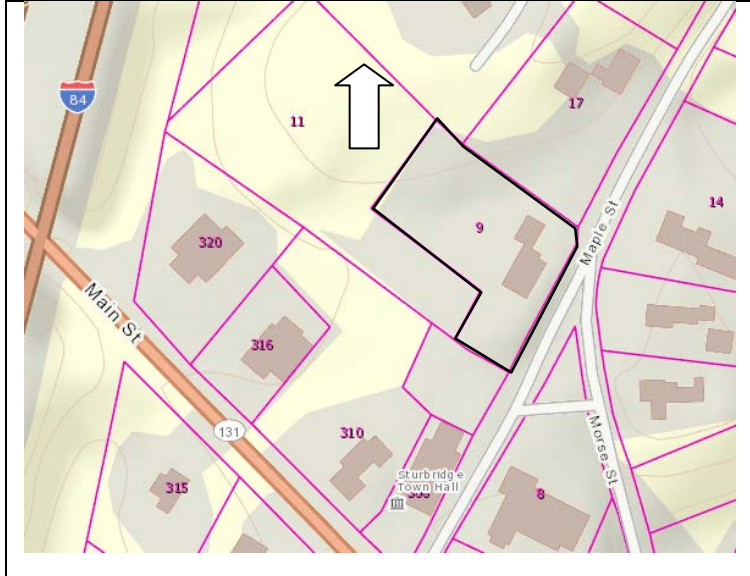

Assessor's Number USGS Quad Area(s) Form Number

417-02913-009

Southbridge

STU.A

STU.5

**Town/City:** Sturbridge

**Place:** (*neighborhood or village*): Sturbridge Center  
(Sturbridge Common Historic District)

**Address:** 9 Maple Street (Formerly High Street)

**Historic Name:** Thomas Lyon/J.E. Purdy House

**Uses:** Present: Single Family Dwelling

Original: Single Family Dwelling/ Blacksmith Shop

**Date of Construction:** circa 1835-1845

**Source:** 1845, 1870, 1898 Maps

**Style/Form:** Possibly Greek Revival/Altered

**Architect/Builder:** Unknown

**Exterior Material:**

Foundation: Stone

Wall/Trim: Aluminum, Clapboard/Aluminum, Wood

Roof: Asphalt Shingle

**Outbuildings/Secondary Structures:**

Attached barn

**Major Alterations** (*with dates*):

Synthetic siding

Replacement Windows

Alterations to form

**Condition:** Fair

**Moved:** no ☒ yes ☐ **Date:**

**Acreage:** .77 acres, will confirm

**Setting:** Just off of Main Street (Route 20), on an irregularly shaped parcel, building is set on a hill and the main façade faces east on Maple Street near the intersection of Maple with Morse Street.

**Recorded by:** Shannon Walsh, PVPC

**Organization:** Sturbridge Historical Commission

**Date** (*month / year*): March 2017

# INVENTORY FORM B CONTINUATION SHEET

STURBRIDGE

9 MAPLE STREET

## MASSACHUSETTS HISTORICAL COMMISSION

220 MORRISSEY BOULEVARD, BOSTON, MASSACHUSETTS 02125

Area(s) Form No.

STU.A

STU.5

☐ Recommended for listing in the National Register of Historic Places.

*If checked, you must attach a completed National Register Criteria Statement form.*

*Use as much space as necessary to complete the following entries, allowing text to flow onto additional continuation sheets.*

### ARCHITECTURAL DESCRIPTION:

*Describe architectural features. Evaluate the characteristics of this building in terms of other buildings within the community.*

The James E. Purdy House is an example of a mid-nineteenth century building which has remained on site near the Sturbridge town center but has received alterations to its form and exterior materials over time. This one and a half story residence and two and a half story attached barn are just off of Main Street and in proximity to the Town Hall and represent the nineteenth century and later community growth and development of Sturbridge. It is considered to be a contributing building within the Sturbridge Common Historic District, listed on the National Register of Historic Places in 1977.

Constructed on a hill, the one and a half story main block is five bays wide by three bays deep. It has a stone foundation, aluminum siding and aluminum and wood trim, and a side gable, moderately pitched asphalt shingle roof with an interior, brick chimney. The eastern façade has four, 6/6 replacement windows and a paneled door with a transom with divided lights. There are two gabled dormers with 6/6 windows. The southern side elevation of this portion of the building has a first story 6/6 window, comparable in size to the windows on the main façade, and a smaller first story window with divided lights. There is also a secondary entrance at the southwestern corner of this elevation. The upper half story has an off-set, 6/6 window set within the gable and close to the southwestern upper corner of the roofline. From this perspective, a shed-roof ell is visible off of the western rear elevation.

A two-bay wide side gabled ell is to the north of the main block, with an entry and 8/8 window on the same level as the fenestrations on the attached central block facade, as well as a lower, ground level secondary entry due to the slope of the hill. The door on this lower level is paneled with an upper light. There is also an interior chimney, centered on the roof ridge, on this ell. An additional two-story, flat-roofed portion connects the main block and ell to the barn.

The two and a half story barn has a clapboard exterior and a front gabled, moderately pitched roof with a slight eave overhang and an eave return. There are offset, double, wood paneled doors with upper divided lights to the southeastern corner of this façade, and second and upper half story windows (possibly casement windows, six divided lights and four divided lights, respectively), and a small board-and-batten hay loft door set within the gable. A one-story, shed roof ell is off of the barn's northern elevation. A rear shed roof ell is visible off of the building's northwestern corner.

### HISTORICAL NARRATIVE

*Discuss the history of the building. Explain its associations with local (or state) history. Include uses of the building, and the role(s) the owners/occupants played within the community.*

Previous research has noted that Levine's Map of 1845 lists this property as belonging to Thomas Lyon (1772-1858), who married Achsah Richardson (1773-1846) in 1807.<sup>1 2</sup> In the 1855 United States Census, Lyon's occupation is listed as farmer.<sup>3</sup>

The building may be best remembered as the residence of James E. Purdy (1828-1919) and his wife Sarah Clemence (1825-1893), who were married in 1858 and presumably bought the property after Lyon's death.<sup>4</sup> Born in Nova Scotia, James became a United States citizen in 1884.<sup>5</sup> He is shown as the property owner on an 1870 map and his occupation is listed as blacksmith

<sup>1</sup> Sturbridge Historical Commission. "STU.5 Maple Street." *Massachusetts Historical Commission, MACRIS*.

<sup>2</sup> "Achshah Richardson." *Vital Records*, 1807. *Ancestry.com*

<sup>3</sup> "Thomas Lyon," *Massachusetts State Census*, 1855 *Ancestry.com*

<sup>4</sup> "James E. Purdy." *Massachusetts, Marriage Records*, 1858. *Ancestry.com*

<sup>5</sup> "James E. Purdy." *Massachusetts, State and Federal Naturalization Records*, 1884. *Ancestry.com*

# INVENTORY FORM B CONTINUATION SHEET

STURBRIDGE

9 MAPLE STREET

## MASSACHUSETTS HISTORICAL COMMISSION

220 MORRISSEY BOULEVARD, BOSTON, MASSACHUSETTS 02125

Area(s) Form No.

STU.A

STU.5

in the 1855, 1880, 1900 and 1910 United States Federal Census reports.<sup>6</sup> An 1899 Sturbridge Directory notes that blacksmith James. E. Purdy has his business on High Street, near Main, and that his house is next door.<sup>7</sup>

At some point towards the mid-twentieth century, this section of High Street was renamed Maple Street.

Ella L. Cunneen, born circa 1862 and listed as Purdy's housekeeper in the 1910 census, inherited the property upon Purdy's death and later sold the main building in 1935.<sup>8</sup> She is noted to have then lived in the former blacksmith shop, which has since been demolished.<sup>9</sup>

## BIBLIOGRAPHY and/or REFERENCES

*Ancestry.com* (see footnotes)

*Find a Grave.Com* (used to determine birth and death dates)

Mallory, Blaine and Joseph Orfant. "Sturbridge Common Historic District." *National Register of Historic Places Inventory—Nomination Form*. United States Department of the Interior, National Park Service, 1977. *MACRIS* (site). Accessed on-line October, 2017, <http://mhc-macris.net/Details.aspx?Mhcid=STU.A>

*Masslandrecords.com* (see footnotes)

Sturbridge Historical Commission. "STU.5 Maple Street." 1972. *Massachusetts Historical Commission, MACRIS*, (site), Accessed on-line October, 2017. <http://mhc-macris.net/Details.aspx?Mhcid=STU.5>

Figure 1: Atlas of Worcester County, F. W. Beers & Co. 1870  
<https://www.digitalcommonwealth.org/search/commonwealth:x059cb92c>

Figure 2: Unknown Author, "Sturbridge and Fiskdale" 1892. <http://archives.lib.state.ma.us/handle/2452/116152>

<sup>6</sup> "James E. Purdy." *United States Federal Census Reports*, 1855, 1880, 1900, 1910. *Ancestry.com*

<sup>7</sup> "Purdy, James E." *Sturbridge Directory*, 1899, *Ancestry.com*

<sup>8</sup> Worcester County Registry of Deeds, Book 2647, Page 196. *MassLandRecords.com*

<sup>9</sup> Sturbridge Historical Commission. "STU.5 Maple Street." *Massachusetts Historical Commission, MACRIS*.



INVENTORY FORM B CONTINUATION SHEET

STURBRIDGE

9 MAPLE STREET

MASSACHUSETTS HISTORICAL COMMISSION  
220 MORRISSEY BOULEVARD, BOSTON, MASSACHUSETTS 02125

Area(s)    Form No.

STU.A	STU.5
-------	-------



Photo 1: Maple Street streetscape, 9 Maple Street on left, camera facing north



Photo 2: Southern side elevation and eastern facing main façade



INVENTORY FORM B CONTINUATION SHEET

STURBRIDGE

9 MAPLE STREET

MASSACHUSETTS HISTORICAL COMMISSION  
220 MORRISSEY BOULEVARD, BOSTON, MASSACHUSETTS 02125

Area(s)    Form No.

STU.A	STU.5
-------	-------



Photo 3: Northern side elevation and eastern facing main facade



Photo 4: Eastern facing main façade



INVENTORY FORM B CONTINUATION SHEET

STURBRIDGE

9 MAPLE STREET

MASSACHUSETTS HISTORICAL COMMISSION  
220 MORRISSEY BOULEVARD, BOSTON, MASSACHUSETTS 02125

Area(s)    Form No.

STU.A	STU.5
-------	-------



Photo 5: Eastern façade of attached barn

**INVENTORY FORM B CONTINUATION SHEET**

STURBRIDGE

9 MAPLE STREET

MASSACHUSETTS HISTORICAL COMMISSION

220 MORRISSEY BOULEVARD, BOSTON, MASSACHUSETTS 02125

Area(s)      Form No.

STU.A

STU.5



Figure 1: 1870 Map showing J. E. Purdy's property on High Street (later Maple Street)



INVENTORY FORM B CONTINUATION SHEET

STURBRIDGE

9 MAPLE STREET

MASSACHUSETTS HISTORICAL COMMISSION  
220 MORRISSEY BOULEVARD, BOSTON, MASSACHUSETTS 02125

Area(s)	Form No.
STU.A	STU.5

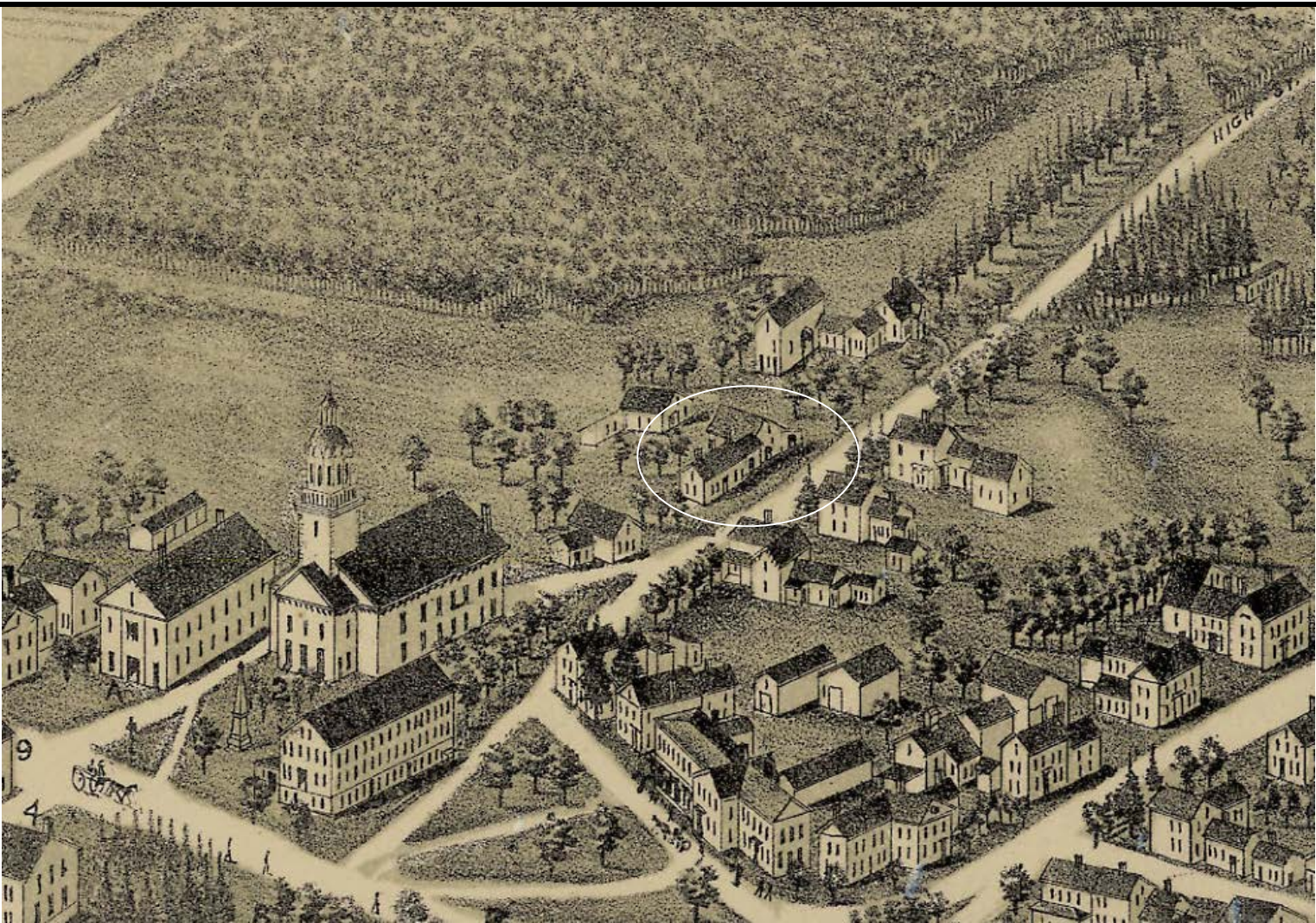

Figure 2: 1892 Bird's Eye View showing Town Hall, Congregational Church, and residences on High St (now Maple St). Purdy property is circled.