

FORM B – BUILDING

MASSACHUSETTS HISTORICAL COMMISSION
MASSACHUSETTS ARCHIVES BUILDING
220 MORRISSEY BOULEVARD
BOSTON, MASSACHUSETTS 02125

Photograph



Locus Map

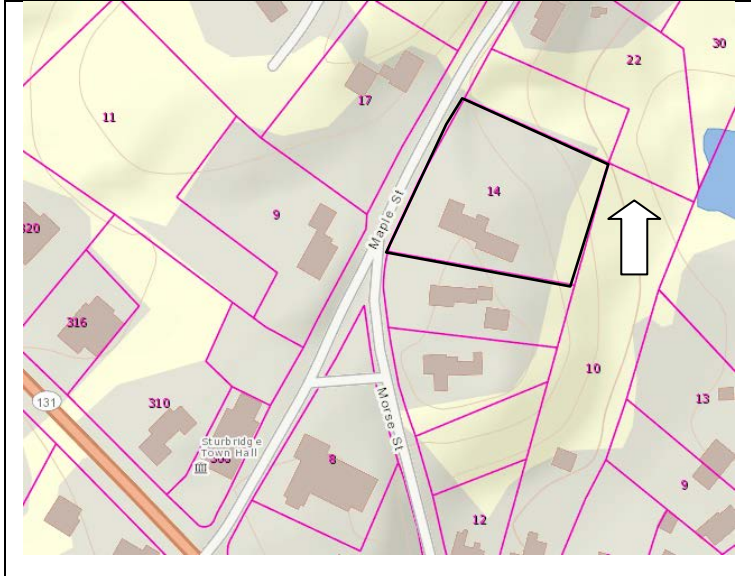

Recorded by: Shannon Walsh, PVPC

Organization: Sturbridge Historical Commission

Date (month / year): March 2017

Assessor's Number USGS Quad Area(s) Form Number

417-02554-014

Southbridge

STU.A

STU.7

Town/City: Sturbridge

Place: (*neighborhood or village*): Sturbridge Center

Address: 14 Maple Street (formerly High Street)

Historic Name: Chester H. Walker House

Uses: Present: Single Family Dwelling

Original: Single Family Dwelling

Date of Construction: prior to 1870

Source: 1870 Map

Style/Form: Greek Revival with Italianate details

Architect/Builder: Unknown

Exterior Material:

Foundation: Brick

Wall/Trim: Clapboard/Wood

Roof: Asphalt Shingle

Outbuildings/Secondary Structures:

None

Major Alterations (*with dates*):

Ell connector between house and barn appears to have been enlarged

Possibly replacement windows

Condition: Fair to good

Moved: no ☒ yes ☐ **Date:**

Acreage: 1.08 acres

Setting: Building is towards the southwestern corner of the parcel, and faces west along Maple Street. Setting is near the intersection of Maple and Morse Streets, and just off of Main Street (Route 131).

INVENTORY FORM B CONTINUATION SHEET

STURBRIDGE

14 MAPLE STREET

MASSACHUSETTS HISTORICAL COMMISSION

220 MORRISSEY BOULEVARD, BOSTON, MASSACHUSETTS 02125

Area(s) Form No.

STU.A

STU.7

☐ Recommended for listing in the National Register of Historic Places.

If checked, you must attach a completed National Register Criteria Statement form.

Use as much space as necessary to complete the following entries, allowing text to flow onto additional continuation sheets.

ARCHITECTURAL DESCRIPTION:

Describe architectural features. Evaluate the characteristics of this building in terms of other buildings within the community.

The Chester H. Walker House, at 14 Maple Street, is a good example of a late nineteenth century single family dwelling, constructed in proximity to the developing town center of Sturbridge, and one of three similar residences built at the time. It also provides evidence of the transition between Greek Revival and Italianate architecture as it has characteristics of both styles. This two and a half story building is three bays wide by six bays deep and has a brick foundation, clapboard siding, and wood trim, and a front gabled asphalt shingle roof with an interior, brick chimney, centered on the roof ridge. The roof has pronounced, overhanging eaves and eave returns at the gable ends. Windows are 2/2, common to Italianate style, but may be replacements. This building contributes to the Sturbridge Common Historic District, listed on the National Register of Historic Places in 1977.

The main, western facing façade has a wood entry door towards the first floor northwestern corner, with paneling on the lower 1/3 and twin, narrow lights on the upper 2/3rds. A flat roof portico with overhanging eaves protects the main entry and is supported by two classical columns (Greek Revival). The first story also has a flat-roofed, semi-octagonal bay to the south of the entry with four narrow windows. The second story has two 2/2 windows and the upper half story has two narrow, arched 1/1 windows set within the gable, with the window shape reminiscent of Italianate style. Trim detailing includes wide, flat cornice boards (often seen with Greek Revival design) and a full height corner board pilaster on the southwestern corner and similar trim from the gable return to the flat roof of a one-story ell, located off the northwestern corner. This ell has a one story, projecting ell to the north, with four, narrow, 2/2 windows, on the western side, similar to the bay to the south of the entry. There is a grouping of four 2/2 windows on the ell's northern elevation.

The southern side elevation contains the side of the main block, a two story connector wing, and an attached two and a half story front gabled section (resembling a barn) with a large, garage style opening at the southwest corner. The main block has a first story 2/2 window and another semi-octagonal bay with a slightly pitched roof. The second story has two evenly spaced 2/2 windows. The two-story connector has a recessed secondary entrance, covered by a sloped roof portico with classical columns. There is a single, 2/2 window to the east of the entry on this floor. The second story has six 2/2 windows, protected by overhanging roof eaves. There is an interior brick chimney on the connector, positioned closer to the eastern gable of the main block.

What is visible of the western façade and southern side elevation of the easternmost portion of the building gives the appearance of a barn which may have been converted into a garage. The western facing exterior is clapboard and there are wood shingles covering the southern side elevation. There is also a 6/6 window which sits just above the opening and an entry door near the southwestern corner on the southern side elevation. A shed roof ell can be seen off of the eastern rear elevation.

HISTORICAL NARRATIVE

Discuss the history of the building. Explain its associations with local (or state) history. Include uses of the building, and the role(s) the owners/occupants played within the community.

Chester H. Walker (1802-1889) and his wife, Sarah H. Walker (1805-1889), married in 1828, were probably the first residents of this house, based upon an 1870 map.¹ (Figure 2) Chester's grandfather, Josiah Walker (1741-1812), was one of the early settlers of Sturbridge, and his father, Captain Perez Walker (1770-1851), "bore arms in the French War" and was "an active and useful townsman."² Perez is also noted to have owned property around this area, prior to its development. (Figure 1) Before

¹ "Chester Walker, Sarah Hamant." 5 November 1828. Massachusetts, Town Marriage Records 1620-1850. *Ancestry.com*

² Davis, George. "Capt. Perez Walker." *A Historical Sketch of Sturbridge and Southbridge*. West Brookfield: O. S. Cooke and Co., (1856) 47-49. *HathiTrust Digital Library* (site). Accessed on-line October, 2017. <https://babel.hathitrust.org/cgi/pt?id=hvd.32044051702470;view=1up;seq=59>

INVENTORY FORM B CONTINUATION SHEET

STURBRIDGE

14 MAPLE STREET

MASSACHUSETTS HISTORICAL COMMISSION

220 MORRISSEY BOULEVARD, BOSTON, MASSACHUSETTS 02125

Area(s) Form No.

STU.A

STU.7

moving to 14 Maple Street, Chester lived on the family homestead of his great-grandfather, Nathaniel Walker (1708-1783).³ In the 1865 Massachusetts State Census, Chester is listed as a farmer.⁴ In the 1870 United States Federal Census, he is listed as having no occupation, with real estate valued at \$4500 and a personal estate value of \$5500.⁵ In 1883, he provided the funding for a barn next door at the parsonage for the First Congregational Church (Photo 4, 10 Maple Street, STU.8).⁶

An 1892 Bird's Eye View map provides a perspective which suggests that the form of this building has remained essentially unaltered, except for the ell connector between the main block of the house and the barn style outbuilding. (Figure 3)

BIBLIOGRAPHY and/or REFERENCES

Ancestry.com (see footnotes)

Davis, George. "Capt. Perez Walker." *A Historical Sketch of Sturbridge and Southbridge*. West Brookfield: O. S. Cooke and Co., (1856) 47. *HathiTrust Digital Library* (site). Accessed on-line October, 2017.

<https://babel.hathitrust.org/cgi/pt?id=hvd.32044051702470;view=1up;seq=59>

FindaGrave.com (birth and death dates)

Genealogybank.com (see footnotes)

Haynes, George H. *Historical Sketch of the First Congregational Church, Sturbridge, Massachusetts*. Worcester: The Davies Press, 1910. *Archive.org* (site). Accessed October 2017, <https://archive.org/details/historicalskech01hayn>

Figure 1: Haynes, George H. *Historical Sketch of the First Congregational Church, Sturbridge, Massachusetts*. Worcester: The Davies Press, 1910. *Archive.org* (site). Accessed October 2017, <https://archive.org/details/historicalskech01hayn>

Figure 2: Atlas of Worcester County, F. W. Beers & Co. 1870

<https://www.digitalcommonwealth.org/search/commonwealth:x059cb92c>

Figure 3: Unknown Author, "Sturbridge and Fiskdale" 1892. <http://archives.lib.state.ma.us/handle/2452/116152>

³ Davis, George. Ibid.

⁴ "Chester Walker." *Massachusetts State Census*, 1865. *Ancestry.com*

⁵ "Walker, Chester." *1870 United States Federal Census*. *Ancestry.com*

⁶ Haynes, George H. *Historical Sketch of the First Congregational Church, Sturbridge, Massachusetts*. Worcester: The Davies Press, 1910. *Archive.org* (site). Accessed October 2017, <https://archive.org/details/historicalskech01hayn>

INVENTORY FORM B CONTINUATION SHEET

STURBRIDGE

14 MAPLE STREET

MASSACHUSETTS HISTORICAL COMMISSION
220 MORRISSEY BOULEVARD, BOSTON, MASSACHUSETTS 02125

Area(s) Form No.

STU.A	STU.7
-------	-------



Photo 1: Main, western facing facade



Photo 2: Northwestern corner perspective

INVENTORY FORM B CONTINUATION SHEET

STURBRIDGE

14 MAPLE STREET

MASSACHUSETTS HISTORICAL COMMISSION
220 MORRISSEY BOULEVARD, BOSTON, MASSACHUSETTS 02125

Area(s) Form No.

STU.A	STU.7
-------	-------



Photo 3: Southern facing side elevation



Photo 4: Streetscape showing 14 and 10 Maple Street (Parsonage at 10 Maple Street, STU.8). Camera is facing southeast.

INVENTORY FORM B CONTINUATION SHEET

STURBRIDGE

14 MAPLE STREET

MASSACHUSETTS HISTORICAL COMMISSION

220 MORRISSEY BOULEVARD, BOSTON, MASSACHUSETTS 02125

Area(s) Form No.

STU.A

STU.7

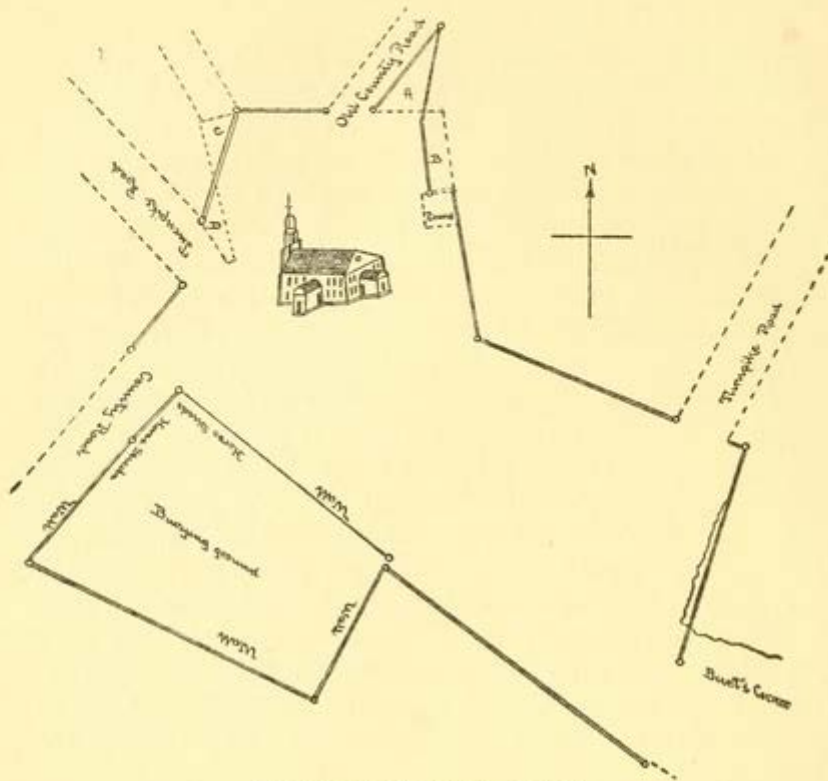

STURBRIDGE COMMON. IN 1821.

This plot of the Common is here reproduced, on a reduced scale, from the sketch on p. 465, of the Sturbridge Town Records, 1798-1824. It gives an idea of the appearance and position of the Meeting-house when it had three entrance porches, and before it was turned, in 1864, until it faced southwest, instead of northwest, as in this sketch.

The inscription upon the chart is as follows:

"References.

- A. Land of Abijah Prouty Containing 12 square rods, which he proposes to exchange for the Lot B Containing 11 square rods, belonging to the town.
- D. Land of Capt. Perez Walker Containing 6 square rods, which he proposes to exchange for the lot C Containing 7 square rods belonging to the town.

This Survey was made May 3d 1821, by a Committee appointed by the town for that purpose and exhibits a view of the Common and Burying Ground in the Town of Sturbridge. The Common lying North of the Burying Ground Contains Six acres and Seventy rods including all roads passing over it. This Plat was Laid down by a scale of Eight rods to an inch.

Samuel Freeman Surveyor."

Figure 1: 1821 Land Survey, taken from 1910 *Historical Sketch of the First Congregational Church, Sturbridge, Massachusetts*. Note reference to land owned by Capt. Perez Walker and proposed exchange.

MASSACHUSETTS HISTORICAL COMMISSION
220 MORRISSEY BOULEVARD, BOSTON, MASSACHUSETTS 02125

Area(s)	Form No.
STU.A	STU.7

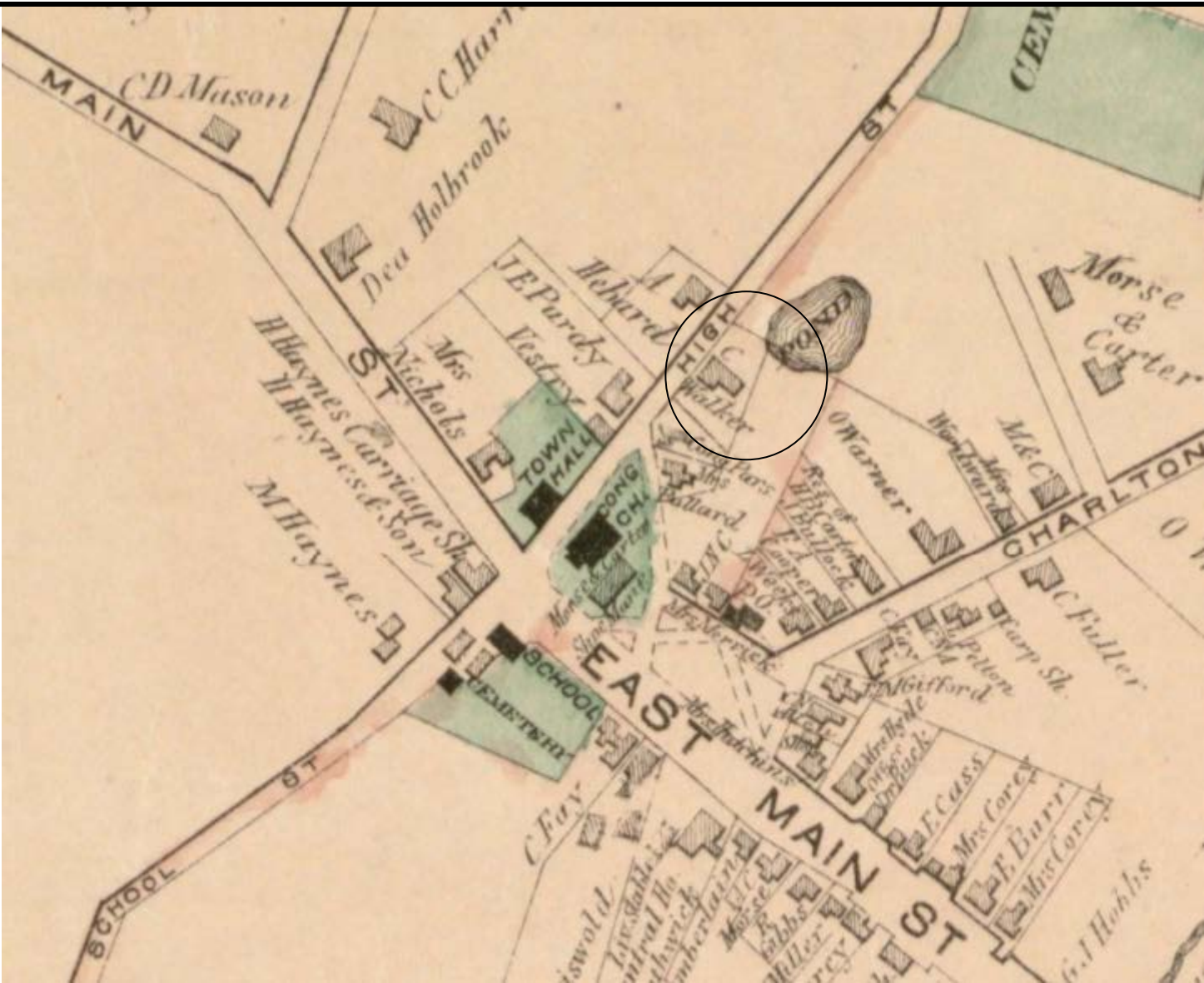

Figure 2: 1870 Map of High Street (later Maple Street) showing C. Walker's residence

INVENTORY FORM B CONTINUATION SHEET

STURBRIDGE

14 MAPLE STREET

MASSACHUSETTS HISTORICAL COMMISSION
220 MORRISSEY BOULEVARD, BOSTON, MASSACHUSETTS 02125

Area(s) Form No.

STU.A	STU.7
-------	-------

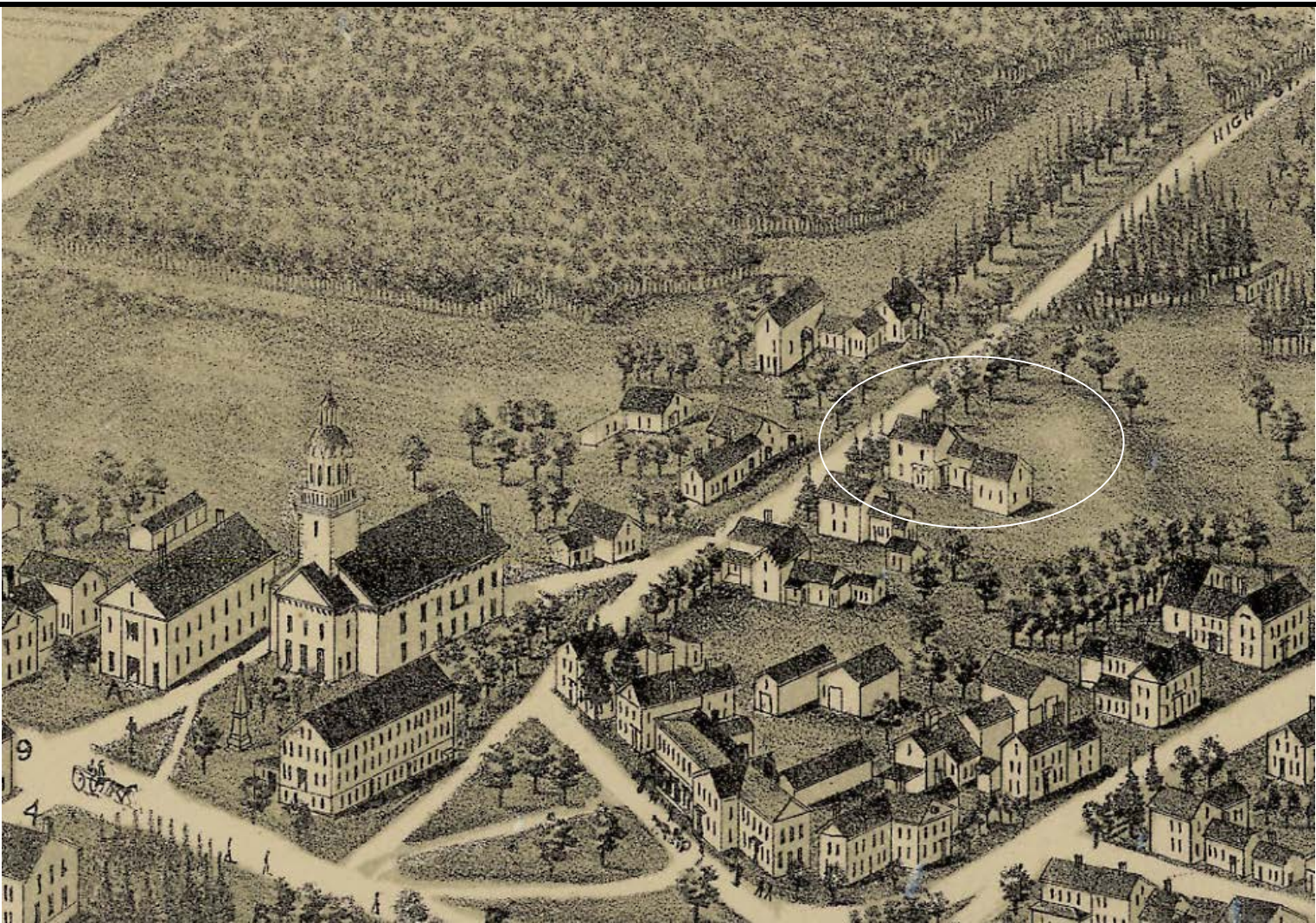

Figure 3: 1892 Bird's Eye View showing Town Hall, Congregational Church, and residences on High St (now Maple St)