

# FORM B – BUILDING

MASSACHUSETTS HISTORICAL COMMISSION  
MASSACHUSETTS ARCHIVES BUILDING  
220 MORRISSEY BOULEVARD  
BOSTON, MASSACHUSETTS 02125

## Photograph



## Locus Map

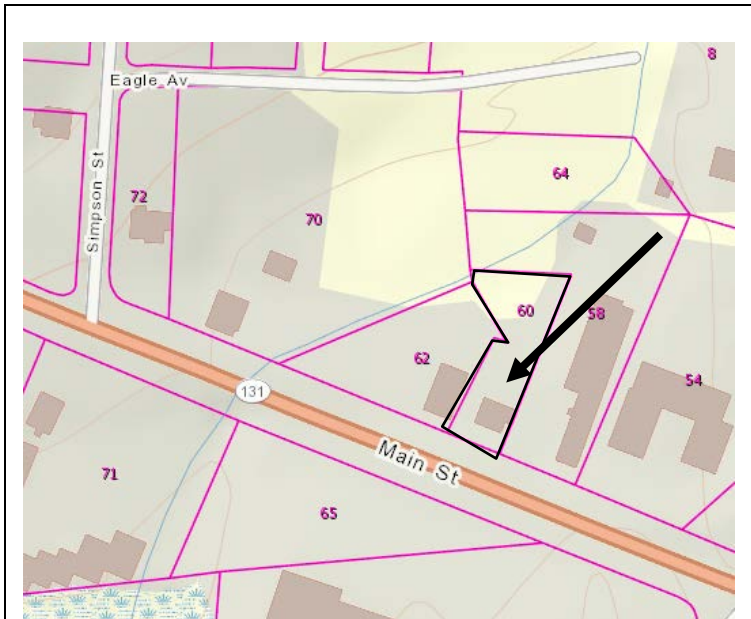

Assessor's Number USGS Quad Area(s) Form Number

415-03552-060

Southbridge

STU.273

**Town/City:** Sturbridge

**Place:** (*neighborhood or village*):

**Address:** 60 Main Street

**Historic Name:** Arthur and Eileen Atwood House

**Uses:** Present: single-family residence

Original: single-family residence

**Date of Construction:** 1946

**Source:** Registry of Deeds

**Style/Form:** Minimal Traditional

**Architect/Builder:** unknown

**Exterior Material:**

Foundation: concrete

Wall/Trim: stucco over concrete

Roof: asphalt shingles

**Outbuildings/Secondary Structures:**  
none

**Major Alterations** (*with dates*):  
Vinyl windows added, ca. 2000.

**Condition:** good

**Moved:** no ☒ yes ☐ **Date:**

**Acreage:** .33 acres

**Setting:** Building faces south along Main Street (Route 131). A row of evergreens shields the house from the roadside, as it is set close to the road.

**Recorded by:** Shannon Walsh

**Organization:** Pioneer Valley Planning Commission

**Date** (*month / year*): November/2017

# INVENTORY FORM B CONTINUATION SHEET

STURBRIDGE

60 MAIN STREET

## MASSACHUSETTS HISTORICAL COMMISSION

220 MORRISSEY BOULEVARD, BOSTON, MASSACHUSETTS 02125

Area(s) Form No.

STU.273

☐ Recommended for listing in the National Register of Historic Places.

*If checked, you must attach a completed National Register Criteria Statement form.*

*Use as much space as necessary to complete the following entries, allowing text to flow onto additional continuation sheets.*

### ARCHITECTURAL DESCRIPTION:

*Describe architectural features. Evaluate the characteristics of this building in terms of other buildings within the community.*

This house is representative of the post-World War II housing that went up in Sturbridge and surrounding towns. Minimal Traditional in style, it is constructed in stucco-covered concrete, a material touted at the time for being fireproof. Minimal Traditional style was one that took traditional forms, in this case a Cape form, and reduced its scale and ornament to create a modest and economical house that would yet be familiar to potential buyers. It was a style that grew out of the lack of available building materials. One-story in height, the house is under a side-gable roof with a center chimney behind its ridge. There are exposed rafters in the gable ends of the roof hinting at the Craftsman style. The south-facing house is three bays wide and two bays deep and has a one-story wing on the east that is one-by-one bay. The house sits on a lot that slopes down to the north east, so that the basement level of the wing is exposed on those elevations. An entry to the basement is located in the east side of the wing. A concrete block deck with iron pipe railing fills the angle between the main block or the house and the wing. The façade of the house has a center entry flanked by half-sized windows. On the west the window has 6/6 sash and on the east by a pair of 6/6 sash windows. The eastern half of the façade is covered in PermaStone, an artificial siding that added a note of traditional masonry. Adding also to the traditional aspect of the house is the wood shingle siding in its gable ends.

### HISTORICAL NARRATIVE

*Discuss the history of the building. Explain its associations with local (or state) history. Include uses of the building, and the role(s) the owners/occupants played within the community.*

The Atwood House is part of the suburban development that took place in eastern Sturbridge, as the neighboring town of Southbridge's population expanded in the 1920s through the 1940s. Adding to the potential for development of the eastern section of town was the paving and re-routing of Route 131 (Main Street) from Sturbridge Center to Southbridge in the mid-1930s, which made commuting into Southbridge by automobile convenient. This house was built in 1946 on several lots of a development known as Bellevue Plat that had been laid out in 1919 by Eagle Realty from Rhode Island. Bellevue Plat was laid out with several hundred lots on the north side of Route 131 and many were bought up by Pierre Lataille in 1921 as part of his plan to develop the area. Pierre was not a developer or contractor, but was a machinist at American Optical Company in Southbridge and buying land in Bellevue Plat represented an investment for a single, skilled workman. Pierre sold a portion of the land he bought to Arthur and Eileen Atwood in 1946. They would have built this house in 1946 and then lived here for the next dozen years. John and Gladys Santelli bought the house in 1958 from the Atwoods, who moved to Florida. John was a sheet metal machinist in Southbridge and the couple maintained the house until selling it in 1970. It was long-term family ownership of houses like the Atwoods and Santellis, the Pinels at 75 Main Street, and the Remians at 70 Main Street that kept Main Street a mixed use neighborhood rather than converting completely to commercial use.

### BIBLIOGRAPHY and/or REFERENCES

#### Maps

Bailey, O. H. & Co. Bird's eye view *Sturbridge and Fiskdale*, Massachusetts, 1892.

Beers, F. W. *Plan of Towns of Sturbridge and Southbridge*, 1870.

Walling, H. F. *Map of Worcester County*, Wm. E. Baker, Boston, 1857.

#### Primary Sources

Chase, Nelly M. *Photograph Album*, Joshua Hyde Public Library, Sturbridge.

#### Secondary Sources

Briere, Robert J. *Recalling Main Street, Sturbridge*, transcript of oral history, 1994.

# INVENTORY FORM B CONTINUATION SHEET

STURBRIDGE

60 MAIN STREET

MASSACHUSETTS HISTORICAL COMMISSION

220 MORRISSEY BOULEVARD, BOSTON, MASSACHUSETTS 02125

Area(s) Form No.

	STU.273
--	---------

---

Burns, Brian. *Sturbridge: A Pictorial History*, Norfolk, 1988.

Clark, Joseph. *Historical Sketch of Sturbridge, Massachusetts*, Brookfield, Massachusetts, 1838.

Corey, Charles F. "Old Houses in Sturbridge" Quinebaug Historical Society Leaflets, vol.1, no. 5, 1900.

Davis, George. *A Historical Sketch of Sturbridge and Southbridge*, West Brookfield, 1856.

Hurd, D. Hamilton. *History of Worcester County, Massachusetts*, vol. 1, Philadelphia 1889.

Izard, Holly. *Old Houses of Sturbridge*, scrapbook, n.d., Joshua Hyde Public Library, Sturbridge.

Massachusetts Historical Commission. *Reconnaissance Survey Report*, "Sturbridge", typescript, 1984

## Digital Resources

[www.Ancestry.com](http://www.Ancestry.com) for federal censuses 1790-1940 and Massachusetts State Censuses 1855, 1865.

<https://dp.la/> Digital Public Library of America

[www.masslandrecords.com](http://www.masslandrecords.com) for deeds