

FORM B – BUILDING

MASSACHUSETTS HISTORICAL COMMISSION
MASSACHUSETTS ARCHIVES BUILDING
220 MORRISSEY BOULEVARD
BOSTON, MASSACHUSETTS 02125

Assessor's Number USGS Quad Area(s) Form Number

280-03522-055

Southbridge

STU.F

STU.255

Town/City: Sturbridge

Place: (*neighborhood or village*): Fiske Hill

Photograph



Address: 55 Fiske Hill Road

Historic Name: Harry G. Estabrook House

Uses: Present: Single Family Dwelling

Original: Single Family Dwelling

Date of Construction: circa 1940

Source: 1939, 1940 deeds

Style/Form: Colonial Revival

Architect/Builder: Unknown

Exterior Material:

Foundation: Concrete

Wall/Trim: Clapboard/Wood

Roof: Asphalt Shingle

Outbuildings/Secondary Structures:

None

Major Alterations (*with dates*):

Overall, unknown

Possibly some replacement windows (date unknown)

Condition: Appears Good

Moved: no ☒ yes ☐ **Date:**

Acreage: 1.19 acres

Setting: This residence faces east on Fiske Hill Road with Fox Run to the north and Williams Road to the south.

Locus Map

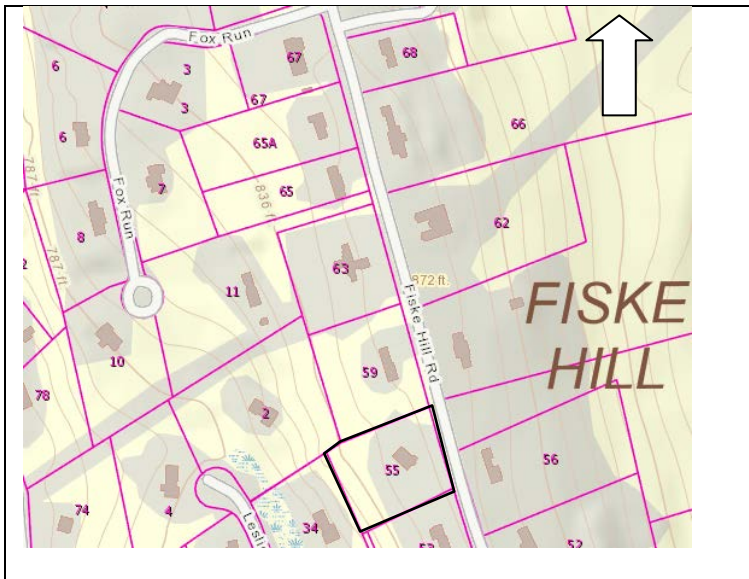

Recorded by: Shannon Walsh, PVPC

Organization: Sturbridge Historical Commission

Date (*month / year*): March 2017

INVENTORY FORM B CONTINUATION SHEET

STURBRIDGE

55 FISKE HILL ROAD

MASSACHUSETTS HISTORICAL COMMISSION

220 MORRISSEY BOULEVARD, BOSTON, MASSACHUSETTS 02125

Area(s) Form No.

STU.F

STU.255

☐ Recommended for listing in the National Register of Historic Places.

If checked, you must attach a completed National Register Criteria Statement form.

Use as much space as necessary to complete the following entries, allowing text to flow onto additional continuation sheets.

ARCHITECTURAL DESCRIPTION:

Describe architectural features. Evaluate the characteristics of this building in terms of other buildings within the community.

The Harry G. Estabrook House, at 55 Fiske Hill Road, is an early twentieth century example of a Colonial Revival style single family dwelling, representative of the area's residential growth and development during that time period, when former agricultural property and undeveloped land was being converted to smaller, residential parcels. This one and a half story building has a concrete foundation, a clapboard exterior and wood trim, and a side gable, steeply pitched, asphalt shingle roof. The top of an off-center brick chimney is visible over the roof ridge. Windows have wood sills and lintels.

The main, eastern facing façade is dominated by the steeply pitched roofline, which extends to the first story. The section near the southeastern corner extends out from the foundation line and has overhanging eaves and a window towards the corner, obscured by landscaping but with at least 18 visible lights. There is a second, prominent window towards the center of this façade, also obscured. The central, wood paneled door is emphasized with squared pilasters and a transom with divided lights. An off-centered dormer, with a hipped roof, is within the main roofline and positioned above the first story window (near the entry). There is also a shed roof dormer with a rectangular window and eight divided lights, to the south. The incorporated two-car garage, with upper divided lights, was an adaptation of Colonial Revival style introduced by 1940.¹

The southern side elevation has a first story ell, towards the southeastern corner, and additional first story windows towards the southwestern corner. Two upper story windows, which appear to be casements, each have a total of 12 divided lights.

HISTORICAL NARRATIVE

Discuss the history of the building. Explain its associations with local (or state) history. Include uses of the building, and the role(s) the owners/occupants played within the community.

Fiske Hill refers to the "first permanent European agricultural settlement after circa 1725" which was established in the Eastern Upland area of Sturbridge.² In 1731, brothers Henry and Daniel Fiske settled on the hill, prior to the 1738 incorporation of the town of Sturbridge. These men and their descendants "were important not only on the hill as farmers and founders of the Baptist church there, but also in town government and, by the 1800s, in industrial enterprises in Globe Village, Westville, and Fiskdale."³ Fertile soil made this area ideal for agriculture and by the late eighteenth century, Fiske Hill had also developed as a stagecoach road with a Baptist Meeting House, School, and Inn. By the early to mid-twentieth century, development shifted from agricultural towards higher-end residential growth.

In 1939 and 1940, Harry G. Estabrook (1884-1972) and Grace L. Estabrook (1882-1977), purchased two tracts of land along Fiske Hill Road and presumably constructed this building on the property.⁴ Harry was employed as an export manager for the Southbridge-based American Optical Company. Grace Estabrook retained the house until 1973.⁵

BIBLIOGRAPHY and/or REFERENCES

Ancestry.com (see footnotes)

Massachusetts Historical Commission. "MHC Reconnaissance Survey Town Report: Sturbridge." 1984.

Masslandrecords.com (see footnotes)

¹ Virginia McAlester, *A Field Guide to American Houses*, New York: Alfred A. Knopf, 2013.

² Massachusetts Historical Commission. "MHC Reconnaissance Survey Town Report: Sturbridge." 1984.

³ Wilkins, Agnes S. "Fiske Hill," (MHC Inventory Form STU.F, 1973), <http://mhc-macris.net/Details.aspx?Mhcid=STU.F>, accessed October 2017.

⁴ From Jacob K. Edwards and Helen W. Edwards, Book 2753, Page 37 (1939); A. Turner Wells, Book 2798, Page 348 (1940). *Masslandrecords.com*

⁵ Book 5317, Page 191 (1973), *Masslandrecords.com*

INVENTORY FORM B CONTINUATION SHEET

STURBRIDGE

55 FISKE HILL ROAD

MASSACHUSETTS HISTORICAL COMMISSION

220 MORRISSEY BOULEVARD, BOSTON, MASSACHUSETTS 02125

Area(s) Form No.

STU.F

STU.255

McAlester, Virginia S. *A Field Guide to American Houses*, New York: Alfred A. Knopf, 2013.

Wilkins, Agnes S. "Fiske Hill," (MHC Inventory Form STU.F, 1973), <http://mhc-macris.net/Details.aspx?MhclId=STU.F>, accessed October 2017.



Photo 1: Main, eastern facing façade



Photo 2: Southern side elevation