

FORM B – BUILDING

MASSACHUSETTS HISTORICAL COMMISSION
MASSACHUSETTS ARCHIVES BUILDING
220 MORRISSEY BOULEVARD
BOSTON, MASSACHUSETTS 02125

Photograph



Locus Map

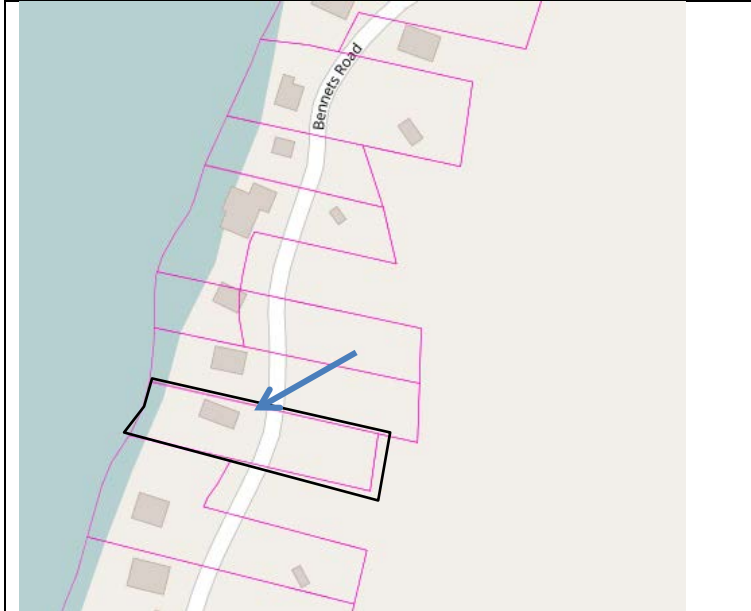

Recorded by: Bonnie Parsons, PVPC

Organization: Sturbridge Historical Commission

Date (*month / year*): October/2017

Assessor's Number USGS Quad Area(s) Form Number

145-04415-051

Southbridge

STU.223

Town/City: Sturbridge

Place: (*neighborhood or village*): Leadmine Pond

Address: 51 Bennetts Road

Historic Name: Eunice Maloney Cottage

Uses: Present: single-family dwelling

Original: single-family dwelling

Date of Construction: 1935

Source: Registry of Deeds

Style/Form: front-gabled cottage

Architect/Builder: unknown

Exterior Material:

Foundation: concrete block, poured concrete, and brick

Wall/Trim: clapboard and vinyl

Roof: asphalt shingle

Outbuildings/Secondary Structures:
none

Major Alterations (*with dates*):

Vinyl siding added, ca. 2000.

Condition: good

Moved: no ☒ yes ☐ **Date:**

Acreage: .32 acres

Setting: Rectangular shaped parcel with residence facing east towards Bennetts Road among a row of waterfront residences on Leadmine Pond. Property stretches to the east across Bennetts Road.

INVENTORY FORM B CONTINUATION SHEET

STURBRIDGE

51 BENNETTS ROAD

MASSACHUSETTS HISTORICAL COMMISSION

220 MORRISSEY BOULEVARD, BOSTON, MASSACHUSETTS 02125

Area(s) Form No.

STU.223

☐ Recommended for listing in the National Register of Historic Places.

If checked, you must attach a completed National Register Criteria Statement form.

Use as much space as necessary to complete the following entries, allowing text to flow onto additional continuation sheets.

ARCHITECTURAL DESCRIPTION:

Describe architectural features. Evaluate the characteristics of this building in terms of other buildings within the community.

The Eunice Maloney Cottage, 51 Bennetts Road, is a one-and-a-half story, lakeside cottage on low brick and concrete foundations. Under its front-gable roof the simple house is two bays wide with a side hall entry and a single window that is centered under the gable peak. The east façade has a full-width shed roof porch on slender posts. The house is four bays long and it has a shed-roofed ell two bays deep and two bays wide on the west elevation (lake-facing). A through-eaves chimney is on the north elevation and has at each side a small, diamond pane window in Queen Ann fashion. Window sash is vinyl 1/1. Set on a sloping lot, the house's ell is supported on pattern-pressed, concrete block footings, which were popular at the turn-of-the-century. The ell has fixed, 9-light windows on its three elevations for the effect of a glassed-in porch. .

HISTORICAL NARRATIVE

Discuss the history of the building. Explain its associations with local (or state) history. Include uses of the building, and the role(s) the owners/occupants played within the community.

The lot on which this house was built was farmland belonging to Edwin and Marietta Wallace in the early 1900s. Edwin died in 1915 leaving the farm to Marietta. By the 1920s when cars were affordable by many families, traveling to weekend cottages became more attainable and developers started buying up attractive land to develop for second home use and cottage development was strong in Sturbridge. Consequently, Marietta sold 200 acres to Clifton L. Gould who laid out forty-three lots along the waterfront in 1925. Gould was a developer who lived in Springfield (on Crystal Road) with his wife Mary. He sold many of the lots to Springfield residents and took back mortgages on them mainly between 1925 and 1927. Lot 28, a quarter acre lot, he sold to Howard and Mattie Roberts of Springfield. Howard was a furniture store credit manager who then turned around and sold the lot to his stepson, Clifford E. Wilson in 1928. Clifford Wilson bought an additional lot in the following year across the road from Lot 28 from Gould. Wilson worked for the same Springfield furniture company as his stepfather, in his case as an upholsterer. In 1935 he couldn't pay his \$25 real estate taxes, so the two lots were put up at auction by the Town and sold to Eunice Maloney. No buildings were mentioned in any of the documents, so it appears that the two lots were likely unbuilt upon until 1935. At 36 years of age in that year, Eunice lived with her elderly Irish immigrant parents, Timothy and Mary, in Fiskdale where she worked as a stenographer in the Sturbridge cotton mill. Timothy Maloney, by then retired, had worked as a blacksmith. Eunice was active in Sturbridge affairs and was secretary for the auxiliary of the American Legion. Unlike many of those who bought in the development, Eunice kept the cottage until 1963 when she sold to Georgianna Prescott from Tolland, Connecticut.

BIBLIOGRAPHY and/or REFERENCES

Maps

Bailey, O. H. & Co. Bird's eye view *Sturbridge and Fiskdale*, Massachusetts, 1892.

Beers, F. W. *Plan of Towns of Sturbridge and Southbridge*, 1870.

Walling, H. F. *Map of Worcester County*, Wm. E. Baker, Boston, 1857.

Primary Sources

Chase, Nelly M. *Photograph Album*, Joshua Hyde Public Library, Sturbridge.

Secondary Sources

Burns, Brian. *Sturbridge: A Pictorial History*, Norfolk, 1988.

Clark, Joseph. *Historical Sketch of Sturbridge, Massachusetts*, Brookfield, Massachusetts, 1838.

Corey, Charles F. "Old Houses in Sturbridge" Quinebaug Historical Society Leaflets, vol.1, no. 5, 1900.

Continuation sheet 1

INVENTORY FORM B CONTINUATION SHEET

STURBRIDGE

51 BENNETTS ROAD

MASSACHUSETTS HISTORICAL COMMISSION

220 MORRISSEY BOULEVARD, BOSTON, MASSACHUSETTS 02125

Area(s) Form No.

STU.223

Davis, George. *A Historical Sketch of Sturbridge and Southbridge*, West Brookfield, 1856.
Hurd, D. Hamilton. *History of Worcester County, Massachusetts*, vol. 1, Philadelphia 1889.
Izard, Holly. *Old Houses of Sturbridge*, scrapbook, n.d., Joshua Hyde Public Library, Sturbridge.

Digital Resources

www.Ancestry.com for federal censuses 1790-1940 and Massachusetts State Censuses 1855, 1865.

<https://dp.la/> Digital Public Library of America

www.masslandrecords.com for deeds:



Photo 1: Eastern facing façade



Photo 2: Eastern façade and northern elevation

INVENTORY FORM B CONTINUATION SHEET

STURBRIDGE

51 BENNETTS ROAD

MASSACHUSETTS HISTORICAL COMMISSION
220 MORRISSEY BOULEVARD, BOSTON, MASSACHUSETTS 02125

Area(s) Form No.

	STU.223
--	---------



Photo 3: Eastern façade and southern elevation